



ORIGINAL

# EXHIBITS

Cause No. 535

Docket No. 1007-SP-20

## **Gary V. Green**

508 W Wall, Suite 500, Midland, Texas 79701

### **EXPERIENCE**

- \* 35 years with major and independent companies and as an independent landman
- \* Land management, lease acquisitions, contract negotiations and Broker supervision
- \* Areas worked Permian Basin, Rocky Mountains, Mid-Continent and California
- \* Expert witness in New Mexico and civil court hearings in Texas

### **EMPLOYMENT POSITIONS**

- \* Corporate Land Manager, Land Manager, Division Land Manager, District Land Manager, Landman, Land Administration Manager, Division Order/Lease Analyst

### **CAREER HISTORY**

04/04 – Present	Rubicon Oil & Gas, LLC	Midland, TX
01/98 – 04/04	Independent Landman	Midland, TX
04/95 – 01/98	Monterey Resources, Inc	Bakersfield, CA
03/82 – 04/95	Santa Fe Energy, Inc	Amarillo, TX, Houston, TX, Midland, TX
01/81 – 03/82	Coquina Oil & Gas, Inc	Midland, TX
06/75 – 01/81	Texaco, Inc	Midland, TX

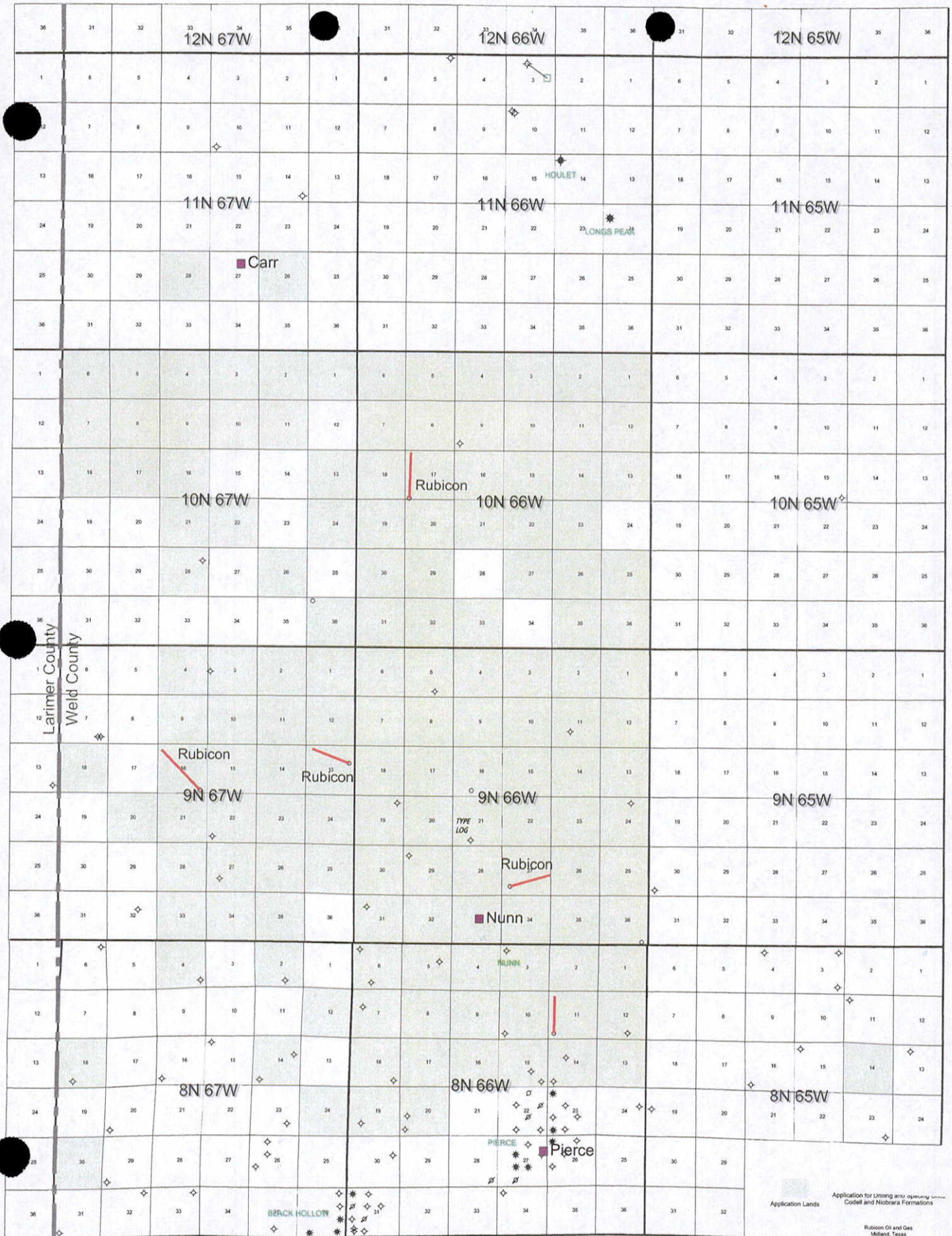

## EXHIBIT 2

Cause No. 535

Docket No. 1007-SP-20



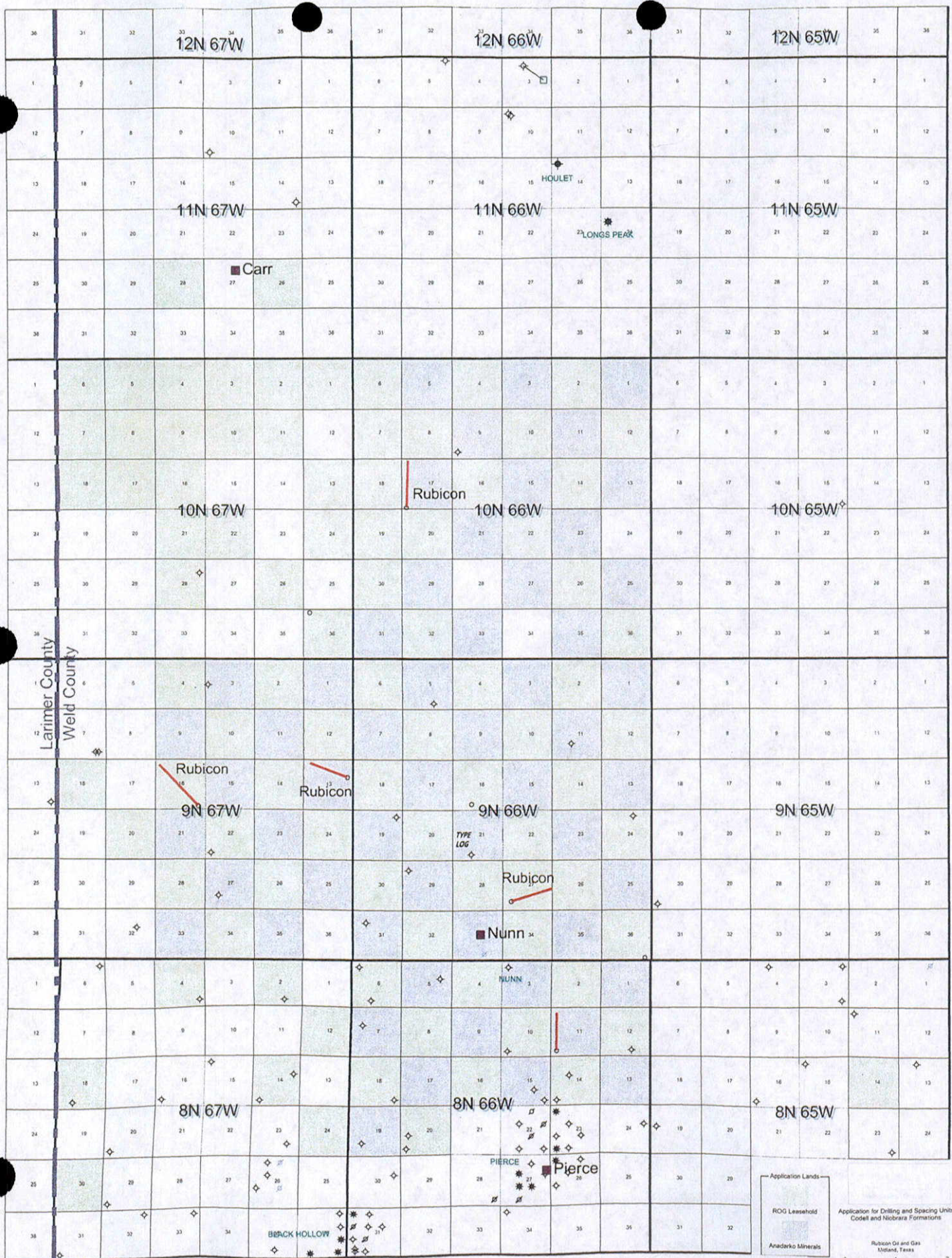

**EXHIBIT 3**  
Cause No. 535  
Docket No. 1007-SP-20



WRITTEN STATEMENTS UNDER RULE 510

Name Anadarko Petroleum Corporation  
Mailing Address 1099 18th Street  
Suite 1800  
Denver, Colorado 80202  
Phone Number 720-929-6498  
E-Mail Address [duane.haley@anadarko.com](mailto:duane.haley@anadarko.com)  
Cause Number 535 Docket Number 1007-SP-20

STATEMENT

Anadarko Land Corp, a wholly owned subsidiary of Anadarko Petroleum Corporation, is the owner of approximately 30,000 acres of mineral fee in Weld County, Colorado that is located within the area described on the Application to the Oil and Gas Conservation Commission of the State of Colorado for an order establishing approximately 640 acre drilling and spacing units and establishing existing well location rules applicable to the drilling and producing of wells from the Codell and Niobrara formations. Please be advised that Anadarko Land Corp supports this Application by Rubicon Oil & Gas, LLC and that approval of this Application would promote (i) efficient drainage within the Codell and Niobrara formations, (ii) protect correlative rights and avoid waste, and (iii) assure the greatest ultimate recovery of oil, gas and associated hydrocarbon substances from the reservoirs.

By signing this statement, I am verifying under oath that the information contained in it is true and correct.

Duane Haley  
Duane Haley  
Project Land Advisor  
Anadarko Petroleum Corporation

STATE OF COLORADO }  
CITY AND COUNTY OF DENVER } ss.

On this 23rd day of July, 2010, before me personally appeared Duane Haley who is known to me to be the person whose name is subscribed to the foregoing Statement and acknowledged to me that he executed the said instrument

Witness my hand and official seal

My commission expires 11/12/2013

Beth A Beck  
Notary Public



## **MICHAEL D. HAYES**

3608 Meadowridge Lane, Midland, Texas 79707 (432) 689-2906

### **EXPERIENCE**

- ◆ 25+ years with major and independent companies
- ◆ Exploration, production, acquisition and operations geology in the Permian, Denver, and Williston Basin
- ◆ Development of fields under primary, secondary, and tertiary (CO<sub>2</sub>) recovery
- ◆ Reservoir and Surveillance Engineer for Exxon in the Permian Basin
- ◆ Expert witness New Mexico and Nebraska

### **EDUCATION**

- |                              |      |                 |
|------------------------------|------|-----------------|
| ◆ UNIVERSITY OF NORTH DAKOTA | 5/84 | Grand Forks, ND |
| ◆ MS/Geology                 |      |                 |
| ◆ ST LAWRENCE UNIVERSITY     | 5/81 | Canton, NY      |
| ◆ BS/Geology with Honors     |      |                 |

### **CAREER HISTORY**

11/00 – PRESENT	RUBICON OIL & GAS, LLC	Midland, TX
3/98 – 10/00	SANTA FE SNYDER CORP	Midland, TX
5/96 – 3/98	YATES PETROLEUM CORP	Artesia, NM
1/91 – 4/96	CHI ENERGY, INC	Midland, TX
7/85 – 1/91	EXXON COMPANY, USA	Midland & Andrews, TX
6/84 – 6/85	CONSULTING GEOLOGIST	Denver, CO







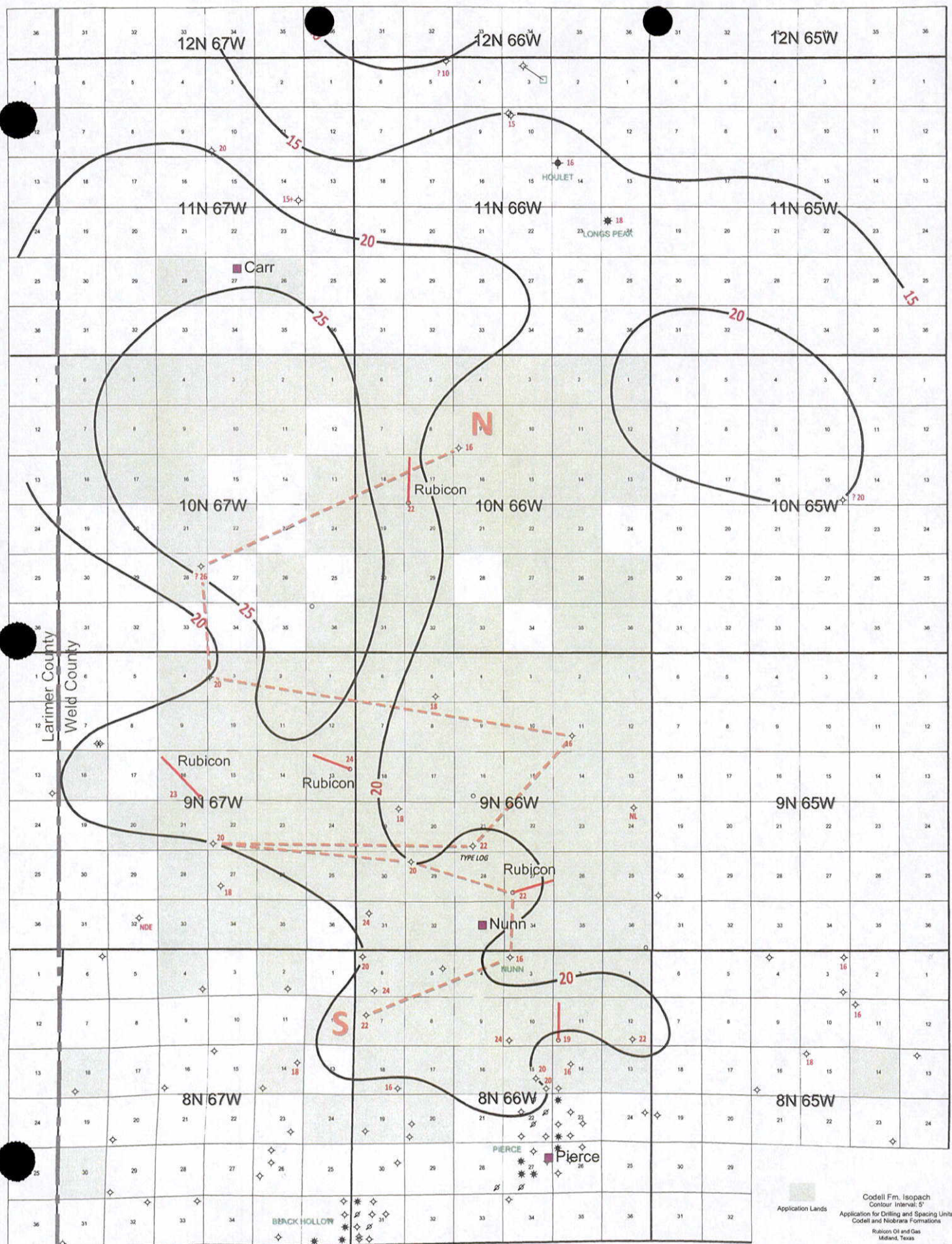
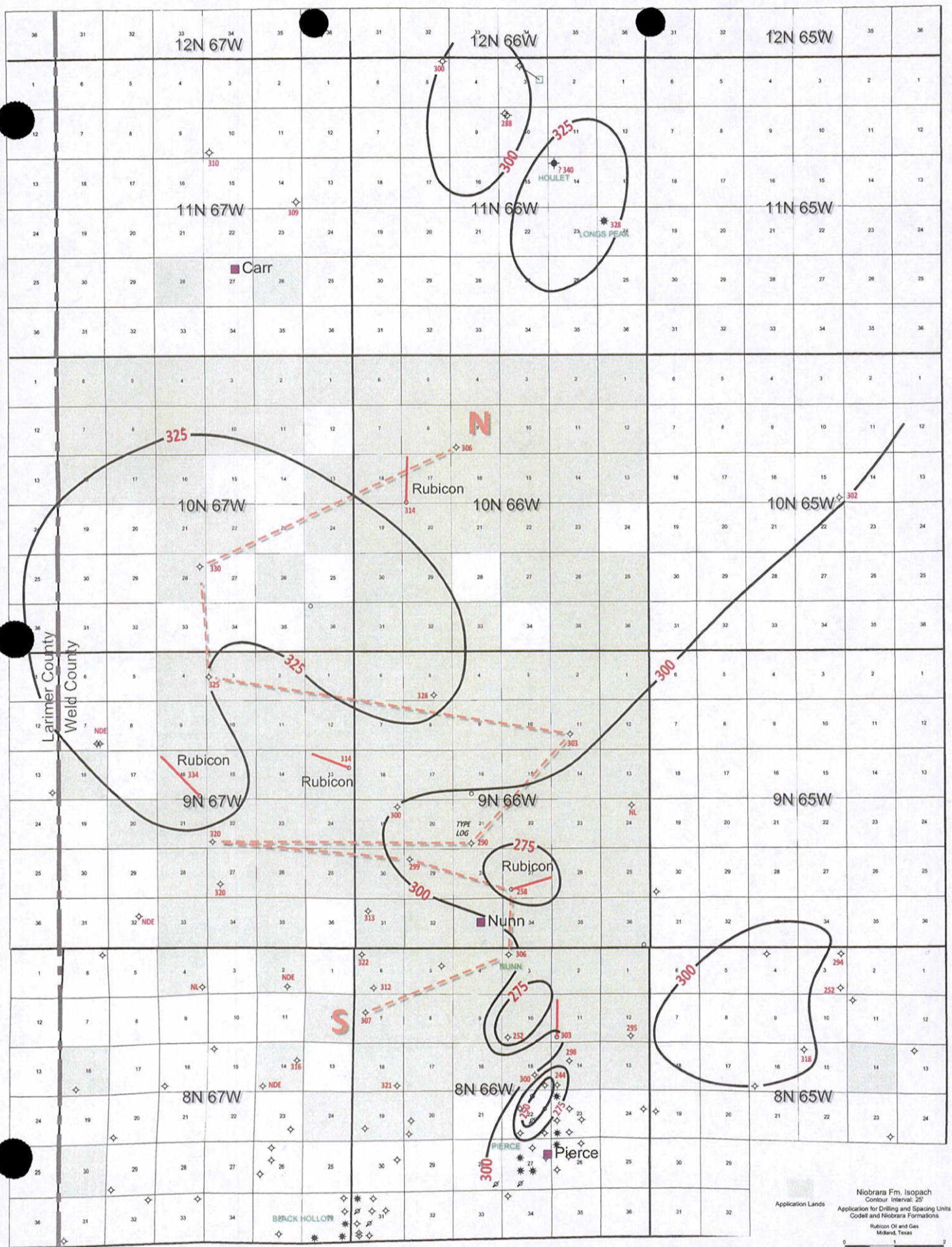

EXHIBIT 8  
Cause No. 535  
Docket No. 1007-SP-20





# EXHIBIT 9

Cause No. 535

Docket No. 1007-SP-20

**ANDREW B. BURLESON**  
**500 W Texas Ave Suite 1100, MIDLAND, TEXAS 79701 (432) 682 - 7818**  
**Email aburleson@t3mid.com**

**EXPERIENCE**

**Independent Petroleum Engineer (May, 1995 - Present)**

Engaged by multiple clients to provide petroleum engineering and management expertise in property acquisitions and divestitures, exploitation projects, exploration programs, production and drilling operations, economic analysis and finance, and expert witness testimony. Individual property evaluations include but are not limited to general field performance studies, primary recovery enhancement through recompletions, stimulation and artificial lift applications, definition of drilling locations, secondary and tertiary recovery applications and surveillance. Manage semi-annual reserve reporting functions with third party engineering consulting firms and prepared capital budget forecasts for utilization in borrowing base determinations. Also conduct asset valuation for acquisitions, divestitures, estate planning and settlement, and damage assessment to support litigation. Provide documentation and presentations to support valuations of divestiture of energy assets.

Generate drilling and acquisition prospects for personal participation and placement with industry investors. Manage a Texas General Partnership containing a portfolio of working interest and overriding royalty interest ownership in oil and gas properties. President of Arena Production Company, an oil and gas property operating company.

**Engineering and Production Manager (1991 - April, 1995) and Senior Petroleum Engineer (1988 - 1991)**

Responsible for all reservoir, completion, and production engineering activities for Clayton Williams Energy, Inc. during a growth period for the company which included one of the largest domestic horizontal drilling programs and resulted in the recovery of more than 20 million barrels of oil equivalent. Performed field studies for the consideration of Company involvement in new projects such as 3-D seismic exploration programs and South American exploitation projects. Coordinated activities of a 6-8 member technical staff in a production operation which consisted of 200 + wells, 5000 BOPD, and 35 MMCFGD. Developed in-house reserve and budget reporting systems and directed outside consultant activities for application to company financing arrangements, including an Initial Public Offering of stock in 1993. Directed all regulatory compliance efforts including technical/legal team coordination in hearing cases before the Railroad Commission of Texas.

**Petroleum Engineer (1984 - 1988)** Employed with Mabey Petroleum Corp., a Midland-Tulsa based independent exploration and production company, with responsibilities including drilling, production and reservoir engineering. Provided engineering design and wellsite supervision in all phases of operations. Responsible for surveillance of company's non-operated interests in Wasson and Seminole San Andres Tertiary Recovery Projects. Coordinated and assisted in preparation of annual capital budget requirements and reserve reporting, property acquisition and exploration prospect evaluations, and presentations for board of directors meetings.

**Petroleum Production Engineer (1981 - 1984)** Responsible for production engineering for 138 oil and gas wells in Southeast New Mexico while employed with Occidental Petroleum/Cities Service Oil and Gas Corp. Responsible for initiating workover recommendations, monitoring secondary recovery operations, design and onsite supervision of completion operations in frontier areas. Presented testimony in regulatory matters at the NMOCD and in a legal hearing within New Mexico.

**Other Petroleum Industry Experience** - Employed and involved in family owned oil field service business in South Texas from 1974 - 1978. Employed with Halliburton Services during summers of 1979 and 1980 while attending college.

**EDUCATION & PERSONAL**

Bachelor of Science - Petroleum Engineering, Texas A & M University, 1981. Member of Society of Petroleum Engineers since 1977. Married (1982) with four adult children (birth dates 1984 - 1988). Birth date September 27, 1958.



**ANDREW B. BURLESON**  
**500 W Texas Ave. Suite 1100; MIDLAND, TEXAS 79701 (432) 682 - 7818**  
**Email aburleson@t3mid.com**

**AREAS OF EXPERIENCE INCLUDED WITH WORK HISTORY**

**West Texas and New Mexico -**

Central Basin Platform (Yates, Queen, Grayburg-San Andres, Clearfork, Devonian)  
Delaware Basin (Delaware Mtn Group, Bone Springs, Wolfcamp, Penn , and Ellenberger)  
Northwest Shelf (Grayburg-San Andres, Abo, Pennsylvanian, Siluro-Devonian)  
Midland Basin (Spraberry-Dean, Wolfcamp, Siluro-Devonian)  
Horseshoe Atoll (Clearfork, Canyon, Ellenberger)  
Eastern Shelf (Pennsylvanian Age Carbonates and Clastics, Ellenberger)

**South, Central, East, and North Texas -**

Cretaceous Trend (Austin Chalk, Buda, Edwards, Wilcox, Glenrose, Woodbine)  
Lower Gulf Coast Frio/Miocene (Willmar, Stratton/Agua Dulce, and Mcfaddin Fields)  
South Texas Wilcox Trend (Lobo, Moca, Hostetter Fields)  
Hugh Fitzsimons San Miguel and Olmos  
East Texas Woodbine Field  
East Texas Cotton Valley & Travis Peak Trend  
Hardeman and Fort Worth Basins – Mississippian Chappel Reef & Barnett Shale, and  
Pennsylvanian Bend Conglomerate, Canyon, and Strawn

**Louisiana and S E USA -**

N W Frisco and Fordouche Sparta Fields  
West Cameron Block 1 Miocene  
Bay Marchand - Timbalier Bay Salt Dome Area  
Mobile Bay Norplet Sand Unit

**Mid-Continent USA**

Arkoma Basin (Arbuckle, Pennsylvanian Overthrust Sands)  
Anadarko Basin (Simpson and Pennsylvanian Clastics)  
Cherokee Platform (Mississippian and Pennsylvanian Carbonates and Clastics)  
Ardmore Basin

**Four Corners and Rocky Mountains -**

S Central Utah (Devonian and Mississippian Carbonates)  
San Juan Basin Tite Gas and Coalbed Methane Area  
Wind River Basin, Wyoming  
Bravo Dome CO2 Reservoir

**International -**

South America - Argentina, Venezuela, and Peru

Codell and Niobrara Drilling and Spacing Unit Application  
Checkerboard Field Area T 8N 9N & 10N and R-65W 66W 67W Weld County Colorado  
Drainage Calculations

	Operator	Wellname	API No	Well Orientation	Field,ST	Sec	TWP	RNG	EUR Oil (STB)	OOIP (STB)	Formation Height h -(ft)	Formation Porosity Por (%)	Calculated Drainage Area (Acres)
Codell SS Formation													
Depth Range 7700 - 8600													
	Ment Energy Company	K&N Farms 1	05-123-12192	Vertical	Eaton CO	32	7N	65W	13,464	269,280	12	8 0%	68
	Merit Energy Company	Eaton Development 1	05-123-11168	Vertical	Eaton CO	36	7N	66W	32,126	642,520	12	8 0%	163
	Rubicon Oil and Gas LLC	Pawnee 27 1	05-123-30662	Horizontal	Checkerboard, CO	27	9N	66W	128,500	2,570,000	22	8 0%	356
Niobrara Lm Formation													
Depth Range 7400 - 8300													
	Rubicon Oil and Gas LLC	Pawnee 27-1	05-123 30662	Horizontal	Checkerboard, CO	27	9N	66W	156,250	3,125,000	24	11 0%	289
	Rubicon Oil and Gas LLC	Pawnee 4-11-1	05 123 31001	Horizontal	Checkerboard CO	11	8N	66W	187,500	3 750,000	22	11 0%	378
	Rubicon Oil and Gas LLC	Pawnee 2 13-1	05-123 30996	Horizontal	Checkerboard CO	13	9N	67W	187 500	3 750 000	24	11 0%	346
	Rubicon Oil and Gas LLC	Pawnee 1 17-1	05 123-31241	Horizontal	Checkerboard CO	17	10N	66W	193 750	3,875 000	22	11 0%	391
	Rubicon Oil and Gas LLC	Pawnee 2 16-1	05-123-31432	Horizontal	Checkerboard CO	16	9N	67W	203,125	4,062,500	38	11 0%	237
From COGCC													
Docket No 1002-SP-06													
Cause No 421													
	EOG Resources	Jake 2-01H	05 123 30574	Horizontal	Hereford CO	1	11N	63W	250,000	5,000,000	80	10 0%	152
	Silo Field Wyoming	Lemaster St 12-32 1H	49-021-20451	Horizontal	Silo WY	32	16N	64W	625,000	12,500,000	80	10 0%	381
	Silo Field Wyoming	Epler S E	49-021 20354	Horizontal	Silo, WY	31	16N	64W	92,000	1,840,000	80	10 0%	56

Input Volumetric Parameters

Bo= 1.2  
Sw= 35.0%  
Vertical Well - Rf 5.0%  
Horizontal Well - Rf 5.0%

Equations Utilized in Tables Above

OOIP= EUR Oil/Rf  
Area = OOIP\*Bo/(7758\*h\*Por\*(1 Sw))

Where

OOIP= Original Oil in Place (STB)  
EUR= Estimated Ultimate Oil Recovery (STB)  
RF= Recovery Factor as % of OOIP  
Area= Drainage Area (Acres)  
Bo= Oil Formation Volume Factor (Rvb/STB)  
h= Formation Height or Thickness (ft)  
Por= Formation Porosity (% of Bulk Volume Rock)  
Sw= Water Saturation (% of Pore Space)

Codell and Niobrara Drilling and Spacing Unit Application  
Checkerboard Field Area, T-8N 9N & 10N and R-65W 66W 67W Weld County Colorado  
Economic Performance Calculations

		Operator	Wellname	API No	Well Orientation	Field,ST	EUR Oil (MSTB)	EUR Gas (MMCF)	Oil Price \$/BBL	Gas Price \$MCF	CAPEX \$M	Annual LOE \$M	Net Revenue Interest	Tax Rate	Oil Recovery Volume to Payout MBO	Simple ROI Calc
Codell SS Formation																
	Depth Range 7700 - 8600															
		Rubicon Oil and Gas LLC	Pawnee 27-1	05-123-30662	Horizontal	Checkerboard CO	128.5	183	\$ 70.00	\$ 5.00	\$ 4,000	\$ 36	80%	10.0%	79.4	1.6
Niobrara Lm Formation																
	Depth Range 7400 - 8300															
		Rubicon Oil and Gas LLC	Pawnee 2 13-1	05-123-31432	Horizontal	Checkerboard CO	187.5	125	\$ 70.00	\$ 5.00	\$ 4,000	\$ 36	80%	10.0%	79.4	2.4