

Critter Creek 24-30H
Sec. 30-T11N-R63W
Weld County, CO

Surface Location

NAD 1927 (NADCON CONUS) Colorado North 501
Ground Elevation: 5263.00 Rig @ 5285.00ft (TBD)
Northing Easting Latitude Longitude
567671.35 2285473.59 40°53' 13.544 N 104°28' 3.303 W

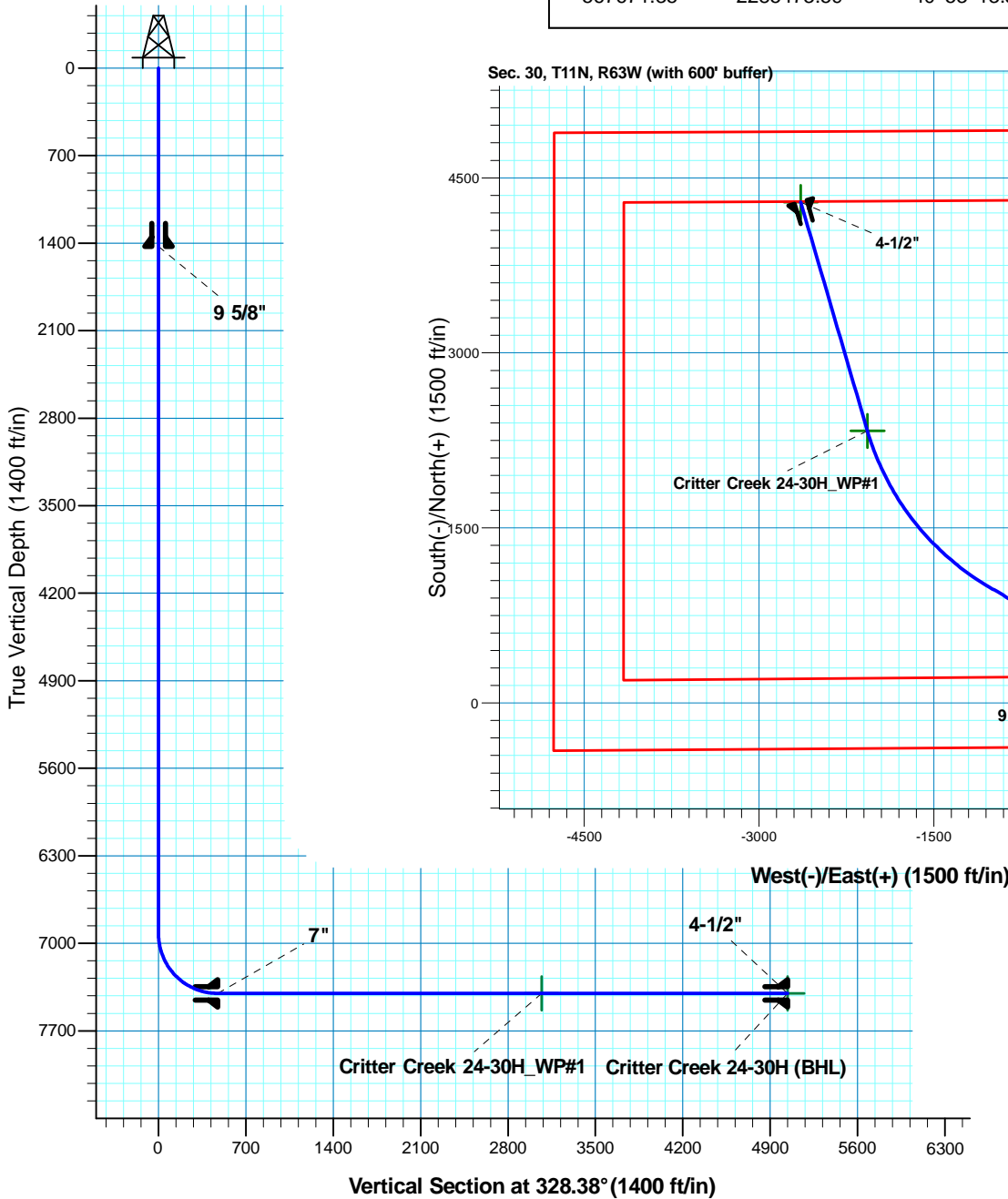

Project: DJ-Hereford Ranch
Site: Critter Creek 24-30H
Well: Critter Creek 24-30H
Plan: APD Directional Plan



Azimuths to True North
Magnetic North: 8.80°
Magnetic Field
Strength: 53508.9snT
Dip Angle: 67.53°
Date: 9/24/2010
Model: IGRF200510

SECTION DETAILS										
Sec	MD	Inc	Azi	TVD	+N/-S	+E/-W	Dleg	TFace	VSect	Target
1	0.00	0.00	0.00	0.00	0.00	0.00	0.00	0.00	0.00	
2	1525.00	0.00	0.00	1525.00	0.00	0.00	0.00	0.00	0.00	
3	6923.54	0.00	0.00	6923.54	0.00	0.00	0.00	0.00	0.00	
4	7673.54	90.00	322.10	7401.00	376.76	-293.30	12.00	322.10	474.60	Critter Creek 24-30H_WP#1
5	8590.51	90.00	299.18	7401.00	969.99	-984.50	2.50	-90.00	1342.16	
6	10374.80	90.00	343.70	7401.00	2330.34	-2069.00	2.50	90.00	3069.16	Critter Creek 24-30H_WP#1
7	12417.91	90.00	343.70	7401.00	4291.32	-2642.45	0.00	0.00	5039.64	Critter Creek 24-30H (BHL)
TARGET DETAILS										
Name	TVD	+N/-S	+E/-W	Northing	Easting	Latitude	Longitude	Shape		
Critter Creek 24-30H (BHL)	7401.00	4291.32	-2642.45	571931.61	2282781.37	40°53' 55.944 N	104°28' 37.712 W	Point		
Critter Creek 24-30H_WP#1	7401.00	2330.34	-2069.00	569977.44	2283377.61	40°53' 36.569 N	104°28' 30.242 W	Point		

EOG Resources, Inc.

**DJ-Hereford Ranch
Crittter Creek 24-30H
Crittter Creek 24-30H**

Original Wellbore

Plan: APD Directional Plan

Standard Planning Report

26 October, 2010

Halliburton Company

Planning Report

Database:	EOG Database	Local Co-ordinate Reference:	Well Critter Creek 24-30H
Company:	EOG Resources, Inc.	TVD Reference:	Rig @ 5285.00ft (TBD)
Project:	DJ-Hereford Ranch	MD Reference:	Rig @ 5285.00ft (TBD)
Site:	Critter Creek 24-30H	North Reference:	True
Well:	Critter Creek 24-30H	Survey Calculation Method:	Minimum Curvature
Wellbore:	Original Wellbore		
Design:	APD Directional Plan		

Project	DJ-Hereford Ranch		
Map System:	US State Plane 1927 (Exact solution)	System Datum:	Mean Sea Level
Geo Datum:	NAD 1927 (NADCON CONUS)		
Map Zone:	Colorado North 501		

Site	Critter Creek 24-30H, Section 30, T11N, R63W		
Site Position:		Northing:	567,671.36 usft
From:	Map	Easting:	2,285,473.59 usft
Position Uncertainty:	0.00 ft	Slot Radius:	13.200 in
		Latitude:	40° 53' 13.544 N
		Longitude:	104° 28' 3.303 W
		Grid Convergence:	0.67 °

Well	Critter Creek 24-30H		
Well Position	+N/-S	0.00 ft	Northing: 567,671.36 usft
	+E/-W	0.00 ft	Easting: 2,285,473.59 usft
Position Uncertainty	0.00 ft	Wellhead Elevation:	Latitude: 40° 53' 13.544 N
			Longitude: 104° 28' 3.303 W
			Ground Level: 5,263.00 ft

Wellbore	Original Wellbore				
Magnetics	Model Name	Sample Date	Declination (°)	Dip Angle (°)	Field Strength (nT)
	IGRF200510	9/24/2010	8.80	67.53	53,509

Design	APD Directional Plan			
Audit Notes:				
Version:	1.0	Phase:	PLAN	Tie On Depth: 0.00
Vertical Section:	Depth From (TVD)	+N/-S	+E/-W	Direction
	(ft)	(ft)	(ft)	(°)
	0.00	0.00	0.00	328.38

Plan Sections										
Measured Depth (ft)	Inclination (°)	Azimuth (°)	Vertical Depth (ft)	+N/-S (ft)	+E/-W (ft)	Dogleg Rate (°/100ft)	Build Rate (°/100ft)	Turn Rate (°/100ft)	TFO (°)	Target
0.00	0.00	0.00	0.00	0.00	0.00	0.00	0.00	0.00	0.00	
1,525.00	0.00	0.00	1,525.00	0.00	0.00	0.00	0.00	0.00	0.00	
6,923.54	0.00	0.00	6,923.54	0.00	0.00	0.00	0.00	0.00	0.00	
7,673.54	90.00	322.10	7,401.00	376.76	-293.30	12.00	12.00	-5.05	322.10	Critter Creek 24-30H_
8,590.51	90.00	299.18	7,401.00	969.99	-984.50	2.50	0.00	-2.50	-90.00	
10,374.80	90.00	343.70	7,401.00	2,330.34	-2,069.00	2.50	0.00	2.50	90.00	Critter Creek 24-30H_
12,417.91	90.00	343.70	7,401.00	4,291.32	-2,642.45	0.00	0.00	0.00	0.00	Critter Creek 24-30H_

Halliburton Company

Planning Report

Database:	EOG Database	Local Co-ordinate Reference:	Well Critter Creek 24-30H
Company:	EOG Resources, Inc.	TVD Reference:	Rig @ 5285.00ft (TBD)
Project:	DJ-Hereford Ranch	MD Reference:	Rig @ 5285.00ft (TBD)
Site:	Critter Creek 24-30H	North Reference:	True
Well:	Critter Creek 24-30H	Survey Calculation Method:	Minimum Curvature
Wellbore:	Original Wellbore		
Design:	APD Directional Plan		

Planned Survey									
Measured Depth (ft)	Inclination (°)	Azimuth (°)	Vertical Depth (ft)	+N/-S (ft)	+E/-W (ft)	Vertical Section (ft)	Dogleg Rate (°/100ft)	Build Rate (°/100ft)	Turn Rate (°/100ft)
0.00	0.00	0.00	0.00	0.00	0.00	0.00	0.00	0.00	0.00
100.00	0.00	0.00	100.00	0.00	0.00	0.00	0.00	0.00	0.00
200.00	0.00	0.00	200.00	0.00	0.00	0.00	0.00	0.00	0.00
300.00	0.00	0.00	300.00	0.00	0.00	0.00	0.00	0.00	0.00
400.00	0.00	0.00	400.00	0.00	0.00	0.00	0.00	0.00	0.00
500.00	0.00	0.00	500.00	0.00	0.00	0.00	0.00	0.00	0.00
600.00	0.00	0.00	600.00	0.00	0.00	0.00	0.00	0.00	0.00
700.00	0.00	0.00	700.00	0.00	0.00	0.00	0.00	0.00	0.00
800.00	0.00	0.00	800.00	0.00	0.00	0.00	0.00	0.00	0.00
900.00	0.00	0.00	900.00	0.00	0.00	0.00	0.00	0.00	0.00
1,000.00	0.00	0.00	1,000.00	0.00	0.00	0.00	0.00	0.00	0.00
1,100.00	0.00	0.00	1,100.00	0.00	0.00	0.00	0.00	0.00	0.00
1,200.00	0.00	0.00	1,200.00	0.00	0.00	0.00	0.00	0.00	0.00
1,300.00	0.00	0.00	1,300.00	0.00	0.00	0.00	0.00	0.00	0.00
1,400.00	0.00	0.00	1,400.00	0.00	0.00	0.00	0.00	0.00	0.00
1,425.00	0.00	0.00	1,425.00	0.00	0.00	0.00	0.00	0.00	0.00
9 5/8"									
1,500.00	0.00	0.00	1,500.00	0.00	0.00	0.00	0.00	0.00	0.00
1,525.00	0.00	0.00	1,525.00	0.00	0.00	0.00	0.00	0.00	0.00
1,600.00	0.00	0.00	1,600.00	0.00	0.00	0.00	0.00	0.00	0.00
1,700.00	0.00	0.00	1,700.00	0.00	0.00	0.00	0.00	0.00	0.00
1,800.00	0.00	0.00	1,800.00	0.00	0.00	0.00	0.00	0.00	0.00
1,900.00	0.00	0.00	1,900.00	0.00	0.00	0.00	0.00	0.00	0.00
2,000.00	0.00	0.00	2,000.00	0.00	0.00	0.00	0.00	0.00	0.00
2,100.00	0.00	0.00	2,100.00	0.00	0.00	0.00	0.00	0.00	0.00
2,200.00	0.00	0.00	2,200.00	0.00	0.00	0.00	0.00	0.00	0.00
2,300.00	0.00	0.00	2,300.00	0.00	0.00	0.00	0.00	0.00	0.00
2,400.00	0.00	0.00	2,400.00	0.00	0.00	0.00	0.00	0.00	0.00
2,500.00	0.00	0.00	2,500.00	0.00	0.00	0.00	0.00	0.00	0.00
2,600.00	0.00	0.00	2,600.00	0.00	0.00	0.00	0.00	0.00	0.00
2,700.00	0.00	0.00	2,700.00	0.00	0.00	0.00	0.00	0.00	0.00
2,800.00	0.00	0.00	2,800.00	0.00	0.00	0.00	0.00	0.00	0.00
2,900.00	0.00	0.00	2,900.00	0.00	0.00	0.00	0.00	0.00	0.00
3,000.00	0.00	0.00	3,000.00	0.00	0.00	0.00	0.00	0.00	0.00
3,100.00	0.00	0.00	3,100.00	0.00	0.00	0.00	0.00	0.00	0.00
3,200.00	0.00	0.00	3,200.00	0.00	0.00	0.00	0.00	0.00	0.00
3,300.00	0.00	0.00	3,300.00	0.00	0.00	0.00	0.00	0.00	0.00
3,400.00	0.00	0.00	3,400.00	0.00	0.00	0.00	0.00	0.00	0.00
3,500.00	0.00	0.00	3,500.00	0.00	0.00	0.00	0.00	0.00	0.00
3,600.00	0.00	0.00	3,600.00	0.00	0.00	0.00	0.00	0.00	0.00
3,700.00	0.00	0.00	3,700.00	0.00	0.00	0.00	0.00	0.00	0.00
3,800.00	0.00	0.00	3,800.00	0.00	0.00	0.00	0.00	0.00	0.00
3,900.00	0.00	0.00	3,900.00	0.00	0.00	0.00	0.00	0.00	0.00
4,000.00	0.00	0.00	4,000.00	0.00	0.00	0.00	0.00	0.00	0.00
4,100.00	0.00	0.00	4,100.00	0.00	0.00	0.00	0.00	0.00	0.00
4,200.00	0.00	0.00	4,200.00	0.00	0.00	0.00	0.00	0.00	0.00
4,300.00	0.00	0.00	4,300.00	0.00	0.00	0.00	0.00	0.00	0.00
4,400.00	0.00	0.00	4,400.00	0.00	0.00	0.00	0.00	0.00	0.00
4,500.00	0.00	0.00	4,500.00	0.00	0.00	0.00	0.00	0.00	0.00
4,600.00	0.00	0.00	4,600.00	0.00	0.00	0.00	0.00	0.00	0.00
4,700.00	0.00	0.00	4,700.00	0.00	0.00	0.00	0.00	0.00	0.00
4,800.00	0.00	0.00	4,800.00	0.00	0.00	0.00	0.00	0.00	0.00
4,900.00	0.00	0.00	4,900.00	0.00	0.00	0.00	0.00	0.00	0.00
5,000.00	0.00	0.00	5,000.00	0.00	0.00	0.00	0.00	0.00	0.00

Halliburton Company

Planning Report

Database:	EOG Database	Local Co-ordinate Reference:	Well Critter Creek 24-30H
Company:	EOG Resources, Inc.	TVD Reference:	Rig @ 5285.00ft (TBD)
Project:	DJ-Hereford Ranch	MD Reference:	Rig @ 5285.00ft (TBD)
Site:	Critter Creek 24-30H	North Reference:	True
Well:	Critter Creek 24-30H	Survey Calculation Method:	Minimum Curvature
Wellbore:	Original Wellbore		
Design:	APD Directional Plan		

Planned Survey									
Measured Depth (ft)	Inclination (°)	Azimuth (°)	Vertical Depth (ft)	+N/-S (ft)	+E/-W (ft)	Vertical Section (ft)	Dogleg Rate (°/100ft)	Build Rate (°/100ft)	Turn Rate (°/100ft)
5,100.00	0.00	0.00	5,100.00	0.00	0.00	0.00	0.00	0.00	0.00
5,200.00	0.00	0.00	5,200.00	0.00	0.00	0.00	0.00	0.00	0.00
5,300.00	0.00	0.00	5,300.00	0.00	0.00	0.00	0.00	0.00	0.00
5,400.00	0.00	0.00	5,400.00	0.00	0.00	0.00	0.00	0.00	0.00
5,500.00	0.00	0.00	5,500.00	0.00	0.00	0.00	0.00	0.00	0.00
5,600.00	0.00	0.00	5,600.00	0.00	0.00	0.00	0.00	0.00	0.00
5,700.00	0.00	0.00	5,700.00	0.00	0.00	0.00	0.00	0.00	0.00
5,800.00	0.00	0.00	5,800.00	0.00	0.00	0.00	0.00	0.00	0.00
5,900.00	0.00	0.00	5,900.00	0.00	0.00	0.00	0.00	0.00	0.00
6,000.00	0.00	0.00	6,000.00	0.00	0.00	0.00	0.00	0.00	0.00
6,100.00	0.00	0.00	6,100.00	0.00	0.00	0.00	0.00	0.00	0.00
6,200.00	0.00	0.00	6,200.00	0.00	0.00	0.00	0.00	0.00	0.00
6,300.00	0.00	0.00	6,300.00	0.00	0.00	0.00	0.00	0.00	0.00
6,400.00	0.00	0.00	6,400.00	0.00	0.00	0.00	0.00	0.00	0.00
6,500.00	0.00	0.00	6,500.00	0.00	0.00	0.00	0.00	0.00	0.00
6,600.00	0.00	0.00	6,600.00	0.00	0.00	0.00	0.00	0.00	0.00
6,700.00	0.00	0.00	6,700.00	0.00	0.00	0.00	0.00	0.00	0.00
6,800.00	0.00	0.00	6,800.00	0.00	0.00	0.00	0.00	0.00	0.00
6,900.00	0.00	0.00	6,900.00	0.00	0.00	0.00	0.00	0.00	0.00
6,923.54	0.00	0.00	6,923.54	0.00	0.00	0.00	0.00	0.00	0.00
7,000.00	9.18	322.10	6,999.67	4.82	-3.75	6.07	12.00	12.00	0.00
7,100.00	21.18	322.10	7,096.01	25.44	-19.80	32.05	12.00	12.00	0.00
7,200.00	33.18	322.10	7,184.81	61.41	-47.81	77.36	12.00	12.00	0.00
7,300.00	45.18	322.10	7,262.19	111.17	-86.54	140.04	12.00	12.00	0.00
7,400.00	57.18	322.10	7,324.77	172.53	-134.31	217.34	12.00	12.00	0.00
7,500.00	69.18	322.10	7,369.81	242.82	-189.03	305.88	12.00	12.00	0.00
7,600.00	81.18	322.10	7,395.35	318.96	-248.31	401.80	12.00	12.00	0.00
7,673.54	90.00	322.10	7,401.00	376.76	-293.30	474.60	12.00	12.00	0.00
7"									
7,700.00	90.00	321.44	7,401.00	397.55	-309.68	500.89	2.50	0.00	-2.50
7,800.00	90.00	318.94	7,401.00	474.36	-373.70	599.86	2.50	0.00	-2.50
7,900.00	90.00	316.44	7,401.00	548.30	-441.01	698.12	2.50	0.00	-2.50
8,000.00	90.00	313.94	7,401.00	619.24	-511.48	795.48	2.50	0.00	-2.50
8,100.00	90.00	311.44	7,401.00	687.03	-584.98	891.74	2.50	0.00	-2.50
8,200.00	90.00	308.94	7,401.00	751.56	-661.37	986.74	2.50	0.00	-2.50
8,300.00	90.00	306.44	7,401.00	812.69	-740.50	1,080.28	2.50	0.00	-2.50
8,400.00	90.00	303.94	7,401.00	870.31	-822.22	1,172.20	2.50	0.00	-2.50
8,500.00	90.00	301.44	7,401.00	924.32	-906.37	1,262.31	2.50	0.00	-2.50
8,590.51	90.00	299.18	7,401.00	969.99	-984.50	1,342.16	2.50	0.00	-2.50
8,600.00	90.00	299.41	7,401.00	974.63	-992.78	1,350.46	2.50	0.00	2.50
8,700.00	90.00	301.91	7,401.00	1,025.62	-1,078.80	1,438.98	2.50	0.00	2.50
8,800.00	90.00	304.40	7,401.00	1,080.31	-1,162.51	1,529.44	2.50	0.00	2.50
8,900.00	90.00	306.90	7,401.00	1,138.59	-1,243.76	1,621.67	2.50	0.00	2.50
9,000.00	90.00	309.39	7,401.00	1,200.35	-1,322.40	1,715.49	2.50	0.00	2.50
9,100.00	90.00	311.89	7,401.00	1,265.48	-1,398.27	1,810.73	2.50	0.00	2.50
9,200.00	90.00	314.38	7,401.00	1,333.85	-1,471.24	1,907.21	2.50	0.00	2.50
9,300.00	90.00	316.88	7,401.00	1,405.33	-1,541.16	2,004.74	2.50	0.00	2.50
9,400.00	90.00	319.38	7,401.00	1,479.79	-1,607.90	2,103.13	2.50	0.00	2.50
9,500.00	90.00	321.87	7,401.00	1,557.08	-1,671.34	2,202.21	2.50	0.00	2.50
9,600.00	90.00	324.37	7,401.00	1,637.06	-1,731.35	2,301.78	2.50	0.00	2.50
9,700.00	90.00	326.86	7,401.00	1,719.58	-1,787.82	2,401.66	2.50	0.00	2.50
9,800.00	90.00	329.36	7,401.00	1,804.48	-1,840.65	2,501.65	2.50	0.00	2.50
9,900.00	90.00	331.85	7,401.00	1,891.59	-1,889.73	2,601.56	2.50	0.00	2.50

Halliburton Company

Planning Report

Database:	EOG Database	Local Co-ordinate Reference:	Well Critter Creek 24-30H
Company:	EOG Resources, Inc.	TVD Reference:	Rig @ 5285.00ft (TBD)
Project:	DJ-Hereford Ranch	MD Reference:	Rig @ 5285.00ft (TBD)
Site:	Critter Creek 24-30H	North Reference:	True
Well:	Critter Creek 24-30H	Survey Calculation Method:	Minimum Curvature
Wellbore:	Original Wellbore		
Design:	APD Directional Plan		

Planned Survey									
Measured Depth (ft)	Inclination (°)	Azimuth (°)	Vertical Depth (ft)	+N/-S (ft)	+E/-W (ft)	Vertical Section (ft)	Dogleg Rate (°/100ft)	Build Rate (°/100ft)	Turn Rate (°/100ft)
10,000.00	90.00	334.35	7,401.00	1,980.77	-1,934.97	2,701.22	2.50	0.00	2.50
10,100.00	90.00	336.84	7,401.00	2,071.82	-1,976.29	2,800.42	2.50	0.00	2.50
10,200.00	90.00	339.34	7,401.00	2,164.59	-2,013.60	2,898.98	2.50	0.00	2.50
10,300.00	90.00	341.83	7,401.00	2,258.90	-2,046.84	2,996.71	2.50	0.00	2.50
10,374.80	90.00	343.70	7,401.00	2,330.34	-2,069.00	3,069.16	2.50	0.00	2.50
Critter Creek 24-30H_WP#1									
10,400.00	90.00	343.70	7,401.00	2,354.52	-2,076.07	3,093.46	0.00	0.00	0.00
10,500.00	90.00	343.70	7,401.00	2,450.50	-2,104.14	3,189.91	0.00	0.00	0.00
10,600.00	90.00	343.70	7,401.00	2,546.48	-2,132.21	3,286.35	0.00	0.00	0.00
10,700.00	90.00	343.70	7,401.00	2,642.47	-2,160.27	3,382.80	0.00	0.00	0.00
10,800.00	90.00	343.70	7,401.00	2,738.45	-2,188.34	3,479.24	0.00	0.00	0.00
10,900.00	90.00	343.70	7,401.00	2,834.43	-2,216.41	3,575.69	0.00	0.00	0.00
11,000.00	90.00	343.70	7,401.00	2,930.41	-2,244.48	3,672.13	0.00	0.00	0.00
11,100.00	90.00	343.70	7,401.00	3,026.39	-2,272.54	3,768.58	0.00	0.00	0.00
11,200.00	90.00	343.70	7,401.00	3,122.37	-2,300.61	3,865.02	0.00	0.00	0.00
11,300.00	90.00	343.70	7,401.00	3,218.35	-2,328.68	3,961.47	0.00	0.00	0.00
11,400.00	90.00	343.70	7,401.00	3,314.33	-2,356.75	4,057.91	0.00	0.00	0.00
11,500.00	90.00	343.70	7,401.00	3,410.31	-2,384.81	4,154.36	0.00	0.00	0.00
11,600.00	90.00	343.70	7,401.00	3,506.29	-2,412.88	4,250.80	0.00	0.00	0.00
11,700.00	90.00	343.70	7,401.00	3,602.27	-2,440.95	4,347.25	0.00	0.00	0.00
11,800.00	90.00	343.70	7,401.00	3,698.25	-2,469.02	4,443.69	0.00	0.00	0.00
11,900.00	90.00	343.70	7,401.00	3,794.23	-2,497.08	4,540.14	0.00	0.00	0.00
12,000.00	90.00	343.70	7,401.00	3,890.21	-2,525.15	4,636.58	0.00	0.00	0.00
12,100.00	90.00	343.70	7,401.00	3,986.19	-2,553.22	4,733.03	0.00	0.00	0.00
12,200.00	90.00	343.70	7,401.00	4,082.17	-2,581.29	4,829.48	0.00	0.00	0.00
12,300.00	90.00	343.70	7,401.00	4,178.15	-2,609.35	4,925.92	0.00	0.00	0.00
12,400.00	90.00	343.70	7,401.00	4,274.13	-2,637.42	5,022.37	0.00	0.00	0.00
12,417.91	90.00	343.70	7,401.00	4,291.32	-2,642.45	5,039.64	0.00	0.00	0.00
Critter Creek 24-30H (BHL)									

Design Targets									
Target Name	Dip Angle (°)	Dip Dir. (°)	TVD (ft)	+N/-S (ft)	+E/-W (ft)	Northing (usft)	Easting (usft)	Latitude	Longitude
- hit/miss target									
- Shape									
Critter Creek 24-30H_W	0.00	0.00	7,401.00	2,330.34	-2,069.00	569,977.45	2,283,377.61	40° 53' 36.569 N	104° 28' 30.242 W
- plan hits target center									
- Point									
Critter Creek 24-30H (BHL)	0.00	0.00	7,401.00	4,291.32	-2,642.45	571,931.61	2,282,781.37	40° 53' 55.944 N	104° 28' 37.712 W
- plan hits target center									
- Point									

Casing Points					
Measured Depth (ft)	Vertical Depth (ft)	Name	Casing Diameter (in)	Hole Diameter (in)	
1,425.00	1,425.00	9 5/8"	9.625	13.500	
7,673.54	7,401.00	7"	7.000	8.750	
12,417.91	7,401.00	4-1/2"	4.500	6.000	

Halliburton Company

Planning Report

Database:	EOG Database	Local Co-ordinate Reference:	Well Critter Creek 24-30H
Company:	EOG Resources, Inc.	TVD Reference:	Rig @ 5285.00ft (TBD)
Project:	DJ-Hereford Ranch	MD Reference:	Rig @ 5285.00ft (TBD)
Site:	Critter Creek 24-30H	North Reference:	True
Well:	Critter Creek 24-30H	Survey Calculation Method:	Minimum Curvature
Wellbore:	Original Wellbore		
Design:	APD Directional Plan		

Formations						
Measured Depth (ft)	Vertical Depth (ft)	Name	Lithology	Dip (°)	Dip Direction (°)	
0.00	0.00	WHITE RIVER		0.00		
851.00	851.00	FOX HILLS		0.00		
1,137.00	1,137.00	PIERRE SHALE		0.00		
3,597.00	3,597.00	TERRY SS	Sandstone	0.00		
4,232.00	4,232.00	HYGIENE	Sandstone	0.00		
7,294.10	7,258.00	SHARON SPRINGS		0.00		
7,396.76	7,323.00	NIOBRARA	Shale	0.00		
7,439.96	7,345.00	B1 CHALK		0.00		
7,534.85	7,381.00	B CHALK	Chalk	0.00		
7,673.54	7,401.00	TARGET ZONE		0.00		