

SHL GM 434-22 LAT./LONG. (NAD83)
N39°29'58.97483" (N39.499715°)
W108°05'15.86435" (W108.087740°)
CSP (NAD 83)
N=1617299.51
E=2269875.82

BHL GM 434-22 LAT./LONG. (NAD83)
N39°30'17.28510" (N39.504801°)
W108°05'41.29700" (W108.094805°)
CSP (NAD 83)
N=1619208.20
E=2267936.00

EXXON-MOBIL
GM 434-22
WELL PAD MV 23-27
GRADED ELEVATION: 5769.50'

- LEGEND**
- FOUND MONUMENT
 - CALCULATED MONUMENT
 - ⊙ WELL LOCATION
 - BOTTOM HOLE
 - SHL - SURFACE HOLE LOCATION
 - BHL - BOTTOM HOLE LOCATION
 - BC - BRASS CAP
 - GLO - GENERAL LAND OFFICE SURVEY

- NOTES:**
- 1) GPS OPERATOR GEOFFREY PAPPAS OBSERVED A PDOP OF 3.063.
 - 2) ALL GPS OBSERVATIONS ARE IN COMPLIANCE WITH COGCC RULE 215
 - 3) ALL DISTANCES ARE NAD83 COLORADO STATE PLANE, CENTRAL ZONE (SEA LEVEL)
 - 4) THIS PLAT COMPLIES WITH COGCC RULE 303c.
 - 5) NO VISIBLE IMPROVEMENTS WITHIN 400' OF WELL HEAD.
 - 6) VEGETATION: SCRUB OAK, SAGE, NATIVE SHRUBS & GRASSES
 - 7) BOTTOM HOLE LOCATION COORDINATES PROVIDED BY WILLIAMS PRODUCTION, RMT.

BASIS OF BEARING/DATUM
A GPS OBSERVATION FROM NGS PID
AJ3465 (FABER)

BASIS OF ELEVATION
A GPS OBSERVATION FROM NGS PID
AJ3465 (FABER) SAID ELEVATION IS
5186.22'.

DIMENSIONAL TIES
ALL DIMENSIONAL TIES TO SECTION
LINES ARE MEASURED PERPENDICULAR
TO THE SECTION LINE.

SURVEYORS CERTIFICATE:

This is to certify that this exhibit was prepared and location as shown was staked on the ground from actual surveys made by me or under my direct supervision.

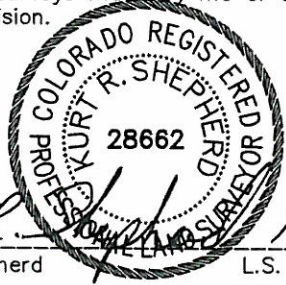

Kurt R. Shepherd
On behalf of
Del-Mont Consultants Inc.
L.S. 28662
DATE REVISED 2010-10-07

DEL-MONT CONSULTANTS IS PROVIDING GRADING DESIGN FOR THIS PROJECT THAT PROVIDES DIMENSIONS AND VOLUME INFORMATION FOR CONSTRUCTION.

DMC DEL-MONT CONSULTANTS, INC. ENGINEERING • SURVEYING • PLANNING 120 Colorado Ave. • Montrose, CO 81401 • (970) 249-2551 • (970) 249-2542 fax www.del-mont.com • service@del-mont.com	
DESIGNED BY MGW	SCALE 1"=800'
CHECKED BY KS	FILE NAME 10030C-MV23-27 PAD SITE

SECTIONS 22,23,26&27, T6S, R96W, 6TH P.M.
WELL LOCATION PLAT
GM 434-22
WELL PAD MV 23-27
GARFIELD COUNTY, CO
WILLIAMS PRODUCTION, RMT

DMC JOB NO.	10030
DATE ISSUED	2008-11-04
DATE SURVEYED	2008-09-29
PLAT	1 of 9