

Building 1453' northwest
Public Road 1620' north
Property Line 328' west
Above Ground Utility 1601' north
Railroad 12,000' northwest

Location Drawing

Existing Well Data:

(Encana Williams 18-16) Latitude: N 40.13416° Longitude: W 105.04021°
FSL: 986' FEL: 988', ELEV: 4924', PDOP: 4.0

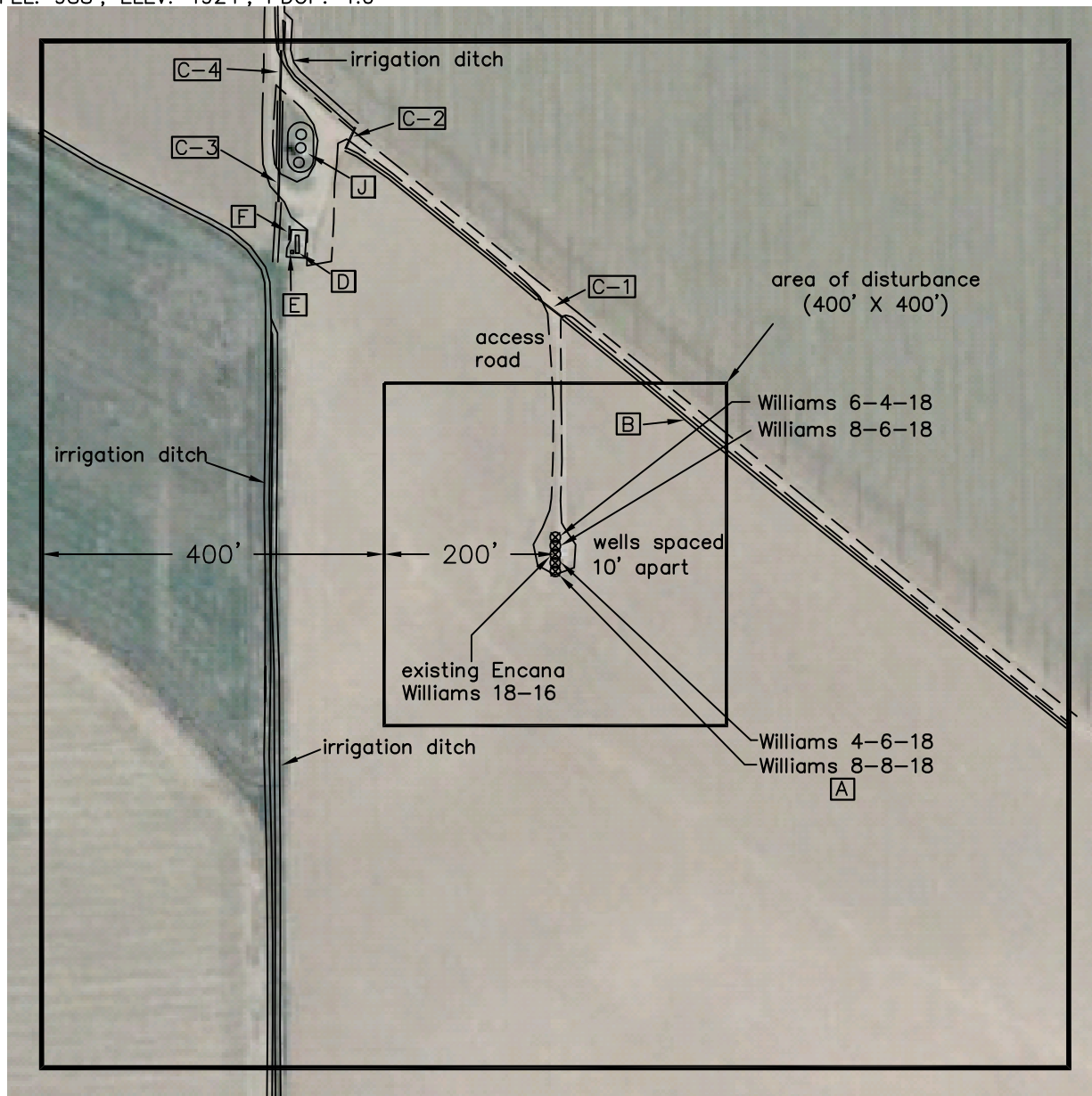

Distances listed below are measured from the existing Williams 18-16

- [A] proposed Williams 8-8-18 20' south
- [B] 4' dirt wide irrigation ditch 218' northeast
- [C] 12" corrugated metal pipe
 - 1: 38' in length-276' northeast
 - 2: 28' in length-533' northwest
 - 3: 40' in length-523' northwest
 - 4: 60' in length-620' northwest
- [D] separator 462' northwest
- [E] vaporizer 466' northwest
- [F] above ground gas 481' northwest
- [G] tanks 541' northwest

Williams 8-8-18, 4-6-18, 8-6-18, 6-4-18

Improvements extending 400' from disturbance

Township 2 North, Range 68 West,
Section 18: SE $\frac{1}{4}$ SE $\frac{1}{4}$
Weld County, Colorado

Scale: 1"=200'

August 9, 2010

Frederick Land Surveying
6760 North Franklin Avenue, Loveland, Colorado 80538
(970) 669-2100 - Fax (970) 669-3725

Project#: 05102.012