

CHEVRON U.S.A., INC.
UP #150X16, UP #151X16, UP #152X16 & UP #153X16
LOCATED IN RIO BLANCO COUNTY, COLORADO
SECTION 16, T2N, R102W, 6th P.M.



PHOTO: VIEW FROM OF LOCATION STAKE

CAMERA ANGLE: SOUTHWESTERLY



PHOTO: VIEW FROM BEGINNING OF PROPOSED ACCESS

CAMERA ANGLE: EASTERLY



U E L S Uintah Engineering & Land Surveying
85 South 200 East Vernal, Utah 84078
(435) 789-1017 * FAX (435) 789-1813

LOCATION PHOTOS

10 21 08
MONTH DAY YEAR

PHOTO
P1

TAKEN BY: J.F.

DRAWN BY: J.J.

REV: J.H. 05-24-10

CHEVRON U.S.A., INC.
UP #150X16, UP #151X16, UP #152X16 & UP #153X16
LOCATED IN RIO BLANCO COUNTY, COLORADO
SECTION 16, T2N, R102W, 6th P.M.

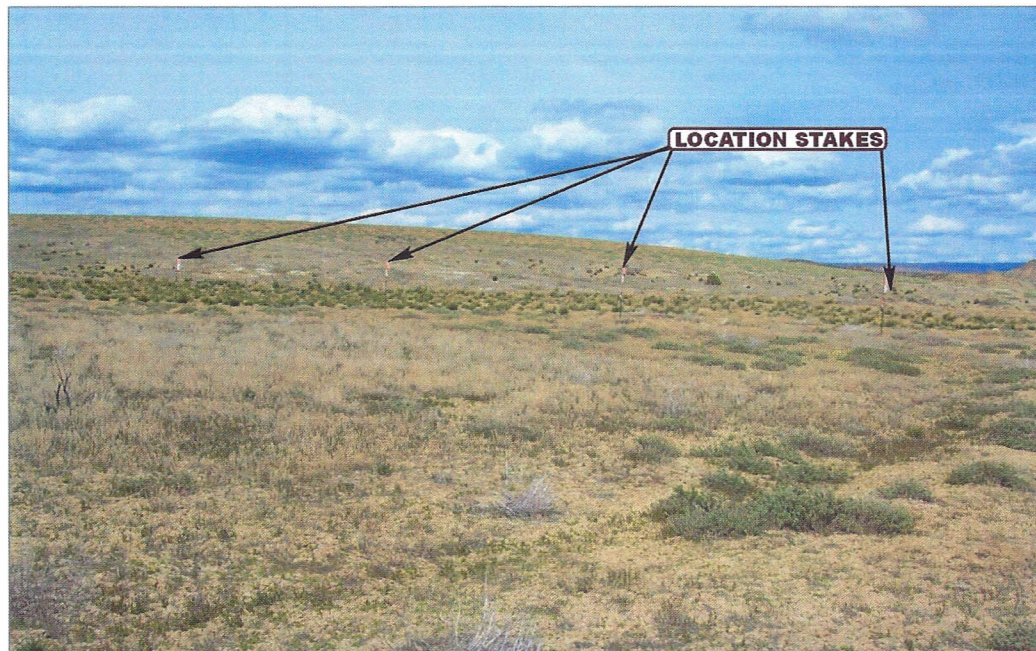

PHOTO: VIEW OF LOCATION STAKES

CAMERA ANGLE: NORTHERLY

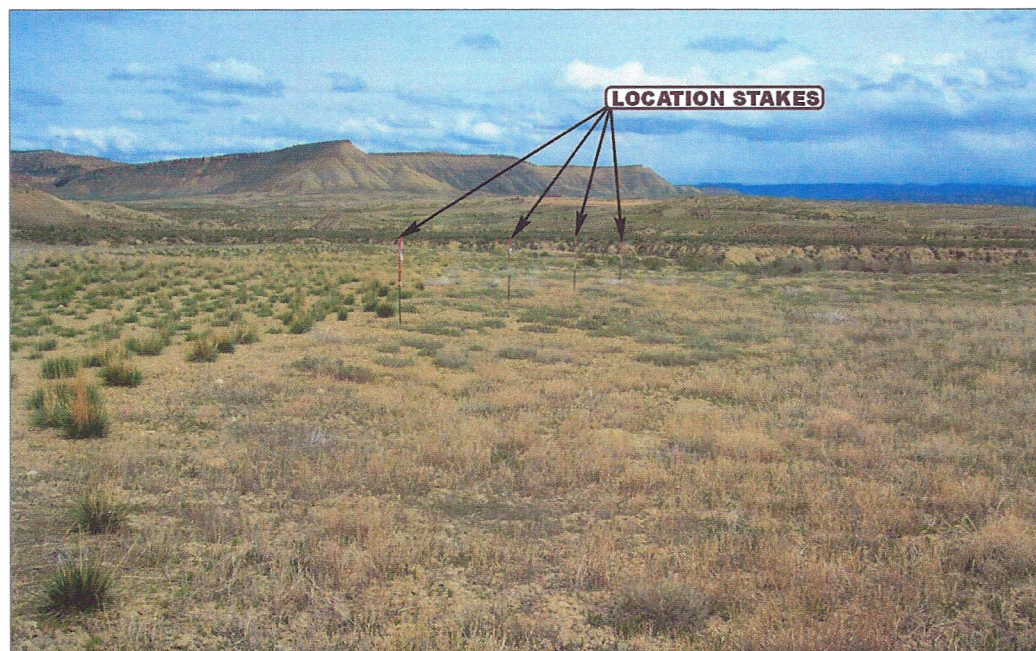

PHOTO: VIEW OF LOCATION STAKES

CAMERA ANGLE: EASTERLY



- Since 1964 -

**U
E
L
S**

Uintah Engineering & Land Surveying
85 South 200 East Vernal, Utah 84078
(435) 789-1017 *FAX (435) 789-1813

LOCATION PHOTOS

10 **21** **08**
MONTH DAY YEAR

TAKEN BY: J.F.

DRAWN BY: J.J.

REV: J.H. 05-24-10

PHOTO
P2

CHEVRON U.S.A., INC.
UP #150X16, UP #151X16, UP #152X16 & UP #153X16
LOCATED IN RIO BLANCO COUNTY, COLORADO
SECTION 16, T2N, R102W, 6th P.M.

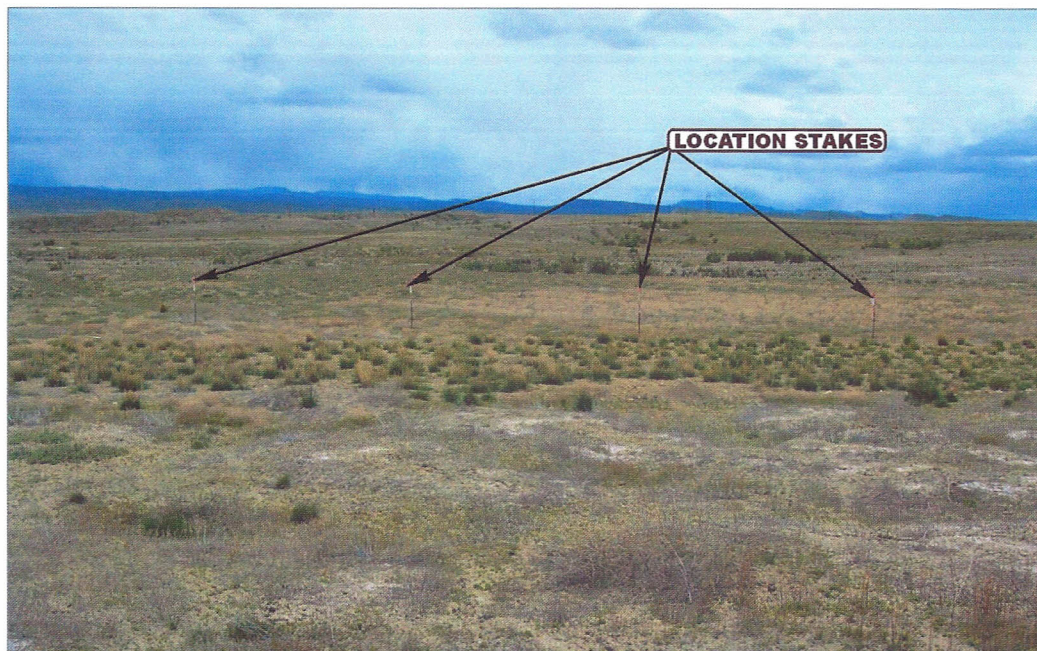

PHOTO: VIEW OF LOCATION STAKES

CAMERA ANGLE: SOUTHERLY



PHOTO: VIEW OF LOCATION STAKES

CAMERA ANGLE: WESTERLY



- Since 1964 -

**U
E
L
S**

Uintah Engineering & Land Surveying
85 South 200 East Vernal, Utah 84078
(435) 789-1017 * FAX (435) 789-1813

LOCATION PHOTOS

10 **21** **08**
MONTH DAY YEAR

PHOTO
P3

TAKEN BY: J.F.

DRAWN BY: J.J.

REV: J.H. 05-24-10