

KERR MCGEE OIL & GAS ONSHORE LP

Location: COLORADO Slot: SLOT#05 STONEBRAKER 8-12 (1805'FNL & 2045'FEL)
 Field: WELD COUNTY (KERR MCGEE) Well: STONEBRAKER 8-12
 Facility: SEC.12-T1N-R68W Wellbore: STONEBRAKER 8-12 PWB

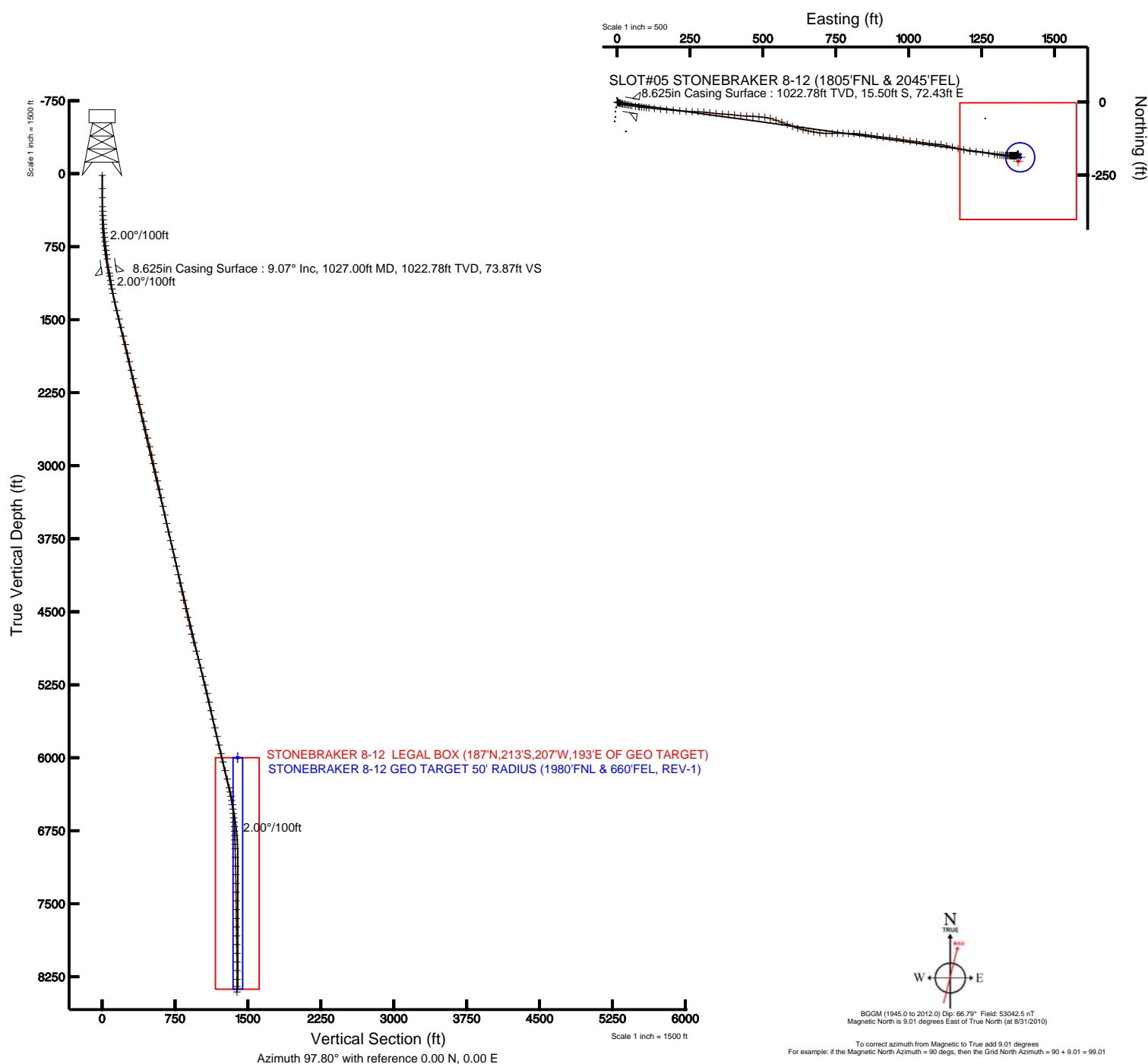

Plot reference wellpath is STONEBRAKER 8-12 (REV-A.0) PWP	
True vertical depths are referenced to XTREME 8 (RT)	Grid System: NAD83 / Lambert Colorado State Planes, Northern Zone (501), US feet
Measured depths are referenced to XTREME 8 (RT)	North Reference: True north
XTREME 8 (RT) to Mean Sea Level: 5093 feet	Scale: True distance
Mean Sea Level to Mud line (Facility: SEC.12-T1N-R68W): 0 feet	Depths are in feet
Coordinates are in feet referenced to Slot	Created by: cookdanm on 10/11/2010





Actual Wellpath Report

STONEBRAKER 8-12 AWP

Page 1 of 5



INTEQ

REFERENCE WELLPATH IDENTIFICATION

Operator	KERR MCGEE OIL & GAS ONSHORE LP	Slot	SLOT#05 STONEBRAKER 8-12 (1805'FNL & 2045'FEL)
Area	COLORADO	Well	STONEBRAKER 8-12
Field	WELD COUNTY (KERR MCGEE)	Wellbore	STONEBRAKER 8-12 AWB
Facility	SEC.12-T1N-R68W		

REPORT SETUP INFORMATION

Projection System	NAD83 / Lambert Colorado State Planes, Northern Zone (501), US feet	Software System	WellArchitect® 2.0
North Reference	True	User	Cookdanm
Scale	0.999962	Report Generated	10/11/2010 at 3:04:55 PM
Convergence at slot	0.36° East	Database/Source file	Denver Server/STONEBRAKER_8-12_AWB.xml

WELLPATH LOCATION

	Local coordinates		Grid coordinates		Geographic coordinates	
	North[ft]	East[ft]	Easting[USft]	Northing[USft]	Latitude	Longitude
Slot Location	65.57	8.40	3154024.58	1268164.71	40°04'05.484"N	104°56'58.776"W
Facility Reference Pt			3154016.59	1268099.09	40°04'04.836"N	104°56'58.884"W
Field Reference Pt			3197771.84	1268891.29	40°04'09.600"N	104°47'36.000"W

WELLPATH DATUM

Calculation method	Minimum curvature	XTREME 8 (RT) to Facility Vertical Datum	5093.00ft
Horizontal Reference Pt	Slot	XTREME 8 (RT) to Mean Sea Level	5093.00ft
Vertical Reference Pt	XTREME 8 (RT)	Facility Vertical Datum to Mud Line (Facility)	0.00ft
MD Reference Pt	XTREME 8 (RT)	Section Origin	N 0.00, E 0.00 ft
Field Vertical Reference	Mean Sea Level	Section Azimuth	97.80°



Actual Wellpath Report

STONEBRAKER 8-12 AWP

Page 2 of 5



REFERENCE WELLPATH IDENTIFICATION

Operator	KERR MCGEE OIL & GAS ONSHORE LP	Slot	SLOT#05 STONEBRAKER 8-12 (1805'FNL & 2045'FEL)
Area	COLORADO	Well	STONEBRAKER 8-12
Field	WELD COUNTY (KERR MCGEE)	Wellbore	STONEBRAKER 8-12 AWB
Facility	SEC.12-T1N-R68W		

WELLPATH DATA (112 stations) † = interpolated/extrapolated station

MD [ft]	Inclination [°]	Azimuth [°]	TVD [ft]	Vert Sect [ft]	North [ft]	East [ft]	DLS [°/100ft]	Comments
0.00†	0.000	333.900	0.00	0.00	0.00	0.00	0.00	
17.00	0.000	333.900	17.00	0.00	0.00	0.00	0.00	
152.00	0.100	333.900	152.00	-0.07	0.11	-0.05	0.07	
245.00	0.800	113.800	245.00	0.51	-0.08	0.51	0.95	
338.00	2.200	114.800	337.96	2.84	-1.09	2.72	1.51	
386.00	2.600	107.100	385.92	4.80	-1.80	4.60	1.07	
429.00	3.100	109.600	428.87	6.90	-2.48	6.63	1.20	
474.00	3.300	109.900	473.80	9.36	-3.33	8.99	0.45	
519.00	3.900	108.900	518.71	12.13	-4.26	11.66	1.34	
564.00	4.800	103.900	563.58	15.50	-5.21	14.93	2.17	
608.00	5.500	102.200	607.40	19.43	-6.10	18.78	1.63	
653.00	6.200	100.400	652.17	24.01	-6.99	23.28	1.61	
698.00	6.500	100.400	696.89	28.98	-7.89	28.17	0.67	
743.00	7.100	101.500	741.57	34.30	-8.91	33.40	1.36	
788.00	7.300	99.700	786.22	39.93	-9.94	38.95	0.67	
833.00	7.600	101.500	830.84	45.76	-11.02	44.68	0.84	
878.00	7.700	99.000	875.44	51.75	-12.08	50.57	0.77	
964.00	8.800	99.000	960.55	64.08	-14.01	62.76	1.28	
1056.00	9.200	98.300	1051.41	78.47	-16.18	76.99	0.45	
1101.00	10.000	97.300	1095.78	85.98	-17.19	84.43	1.82	
1146.00	10.100	94.100	1140.09	93.82	-17.97	92.24	1.26	
1191.00	10.400	95.100	1184.38	101.82	-18.61	100.22	0.78	
1237.00	11.200	97.300	1229.56	110.43	-19.55	108.78	1.96	
1327.00	13.100	98.300	1317.54	129.37	-22.13	127.55	2.12	
1418.00	14.000	95.500	1406.01	150.68	-24.68	148.71	1.22	
1507.00	14.000	93.700	1492.36	172.18	-26.40	170.17	0.49	
1597.00	14.600	95.900	1579.58	194.37	-28.27	192.32	0.90	
1688.00	14.200	92.700	1667.72	216.96	-29.98	214.87	0.98	
1778.00	13.500	94.400	1755.10	238.44	-31.30	236.38	0.90	
1869.00	13.200	93.400	1843.64	259.40	-32.73	257.34	0.42	
1959.00	12.600	90.600	1931.37	279.38	-33.45	277.41	0.96	
2050.00	13.100	94.800	2020.09	299.53	-34.41	297.61	1.16	
2138.00	13.900	98.000	2105.66	320.06	-36.72	318.02	1.24	
2229.00	13.800	94.800	2194.02	341.83	-39.15	339.66	0.85	
2319.00	13.300	94.400	2281.51	362.88	-40.84	360.68	0.57	
2409.00	13.600	93.700	2369.04	383.77	-42.32	381.56	0.38	
2498.00	13.500	96.200	2455.57	404.59	-44.11	402.33	0.67	
2589.00	13.800	98.000	2544.00	426.06	-46.77	423.64	0.57	
2676.00	14.000	89.500	2628.46	446.86	-48.12	444.44	2.36	
2766.00	12.900	94.400	2715.99	467.66	-48.80	465.34	1.76	
2857.00	13.900	94.400	2804.51	488.71	-50.42	486.37	1.10	
2945.00	12.800	96.900	2890.14	509.01	-52.40	506.58	1.41	
3035.00	12.200	105.300	2978.01	528.41	-56.11	525.66	2.13	
3126.00	13.400	108.900	3066.75	548.29	-62.06	544.91	1.58	
3216.00	13.500	110.300	3154.28	568.78	-69.08	564.63	0.38	



Actual Wellpath Report

STONEBRAKER 8-12 AWP

Page 3 of 5



INTEQ

REFERENCE WELLPATH IDENTIFICATION

Operator	KERR MCGEE OIL & GAS ONSHORE LP	Slot	SLOT#05 STONEBRAKER 8-12 (1805'FNL & 2045'FEL)
Area	COLORADO	Well	STONEBRAKER 8-12
Field	WELD COUNTY (KERR MCGEE)	Wellbore	STONEBRAKER 8-12 AWP
Facility	SEC.12-T1N-R68W		

WELLPATH DATA (112 stations)

MD [ft]	Inclination [°]	Azimuth [°]	TVD [ft]	Vert Sect [ft]	North [ft]	East [ft]	DLS [°/100ft]	Comments
3306.00	12.700	111.300	3241.94	588.65	-76.32	583.70	0.92	
3395.00	12.100	110.600	3328.86	607.26	-83.16	601.54	0.69	
3485.00	12.200	107.800	3416.84	625.83	-89.38	619.43	0.66	
3576.00	11.900	103.600	3505.84	644.63	-94.53	637.70	1.02	
3666.00	11.700	102.900	3593.94	662.95	-98.75	655.62	0.27	
3756.00	12.700	99.700	3681.91	681.93	-102.45	674.26	1.34	
3846.00	14.200	96.900	3769.44	702.86	-105.45	694.98	1.82	
3937.00	13.500	92.700	3857.79	724.60	-107.29	716.67	1.35	
4027.00	13.100	86.700	3945.38	745.07	-107.19	737.34	1.60	
4115.00	11.900	89.900	4031.30	763.84	-106.60	756.37	1.57	
4205.00	12.000	92.300	4119.35	782.35	-106.96	775.00	0.56	
4294.00	11.600	92.300	4206.47	800.46	-107.69	793.19	0.45	
4385.00	12.600	90.200	4295.44	819.41	-108.10	812.26	1.20	
4473.00	12.900	96.600	4381.28	838.75	-109.26	831.61	1.64	
4564.00	13.400	98.300	4469.89	859.45	-111.95	852.14	0.69	
4654.00	12.800	99.000	4557.55	879.84	-115.01	872.30	0.69	
4744.00	12.800	97.300	4645.31	899.78	-117.84	892.04	0.42	
4832.00	14.200	95.900	4730.88	920.32	-120.19	912.45	1.63	
4921.00	14.800	96.200	4817.04	942.59	-122.54	934.61	0.68	
5012.00	16.200	99.700	4904.73	966.90	-125.93	958.67	1.85	
5101.00	15.100	99.000	4990.43	990.89	-129.84	982.36	1.25	
5191.00	14.500	97.600	5077.45	1013.88	-133.16	1005.11	0.78	
5281.00	14.000	97.600	5164.68	1036.04	-136.09	1027.07	0.56	
5372.00	14.400	97.600	5252.90	1058.36	-139.04	1049.20	0.44	
5462.00	13.700	96.600	5340.20	1080.21	-141.75	1070.88	0.82	
5553.00	12.700	94.800	5428.80	1100.97	-143.82	1091.55	1.19	
5643.00	12.300	98.700	5516.67	1120.43	-146.10	1110.88	1.04	
5733.00	13.100	105.000	5604.47	1140.14	-150.19	1130.21	1.78	
5824.00	12.500	101.100	5693.21	1160.20	-154.76	1149.84	1.16	
5914.00	13.300	104.300	5780.94	1180.21	-159.19	1169.43	1.19	
6005.00	13.200	102.900	5869.52	1200.96	-164.10	1189.70	0.37	
6096.00	13.700	97.300	5958.02	1222.09	-167.78	1210.52	1.53	
6184.00	14.200	97.300	6043.43	1243.30	-170.48	1231.56	0.57	
6275.00	14.100	94.100	6131.67	1265.52	-172.69	1253.69	0.87	
6366.00	13.000	102.200	6220.14	1286.79	-175.65	1274.75	2.41	
6456.00	13.200	98.700	6307.80	1307.16	-179.34	1294.80	0.91	
6501.00	11.600	98.000	6351.75	1316.82	-180.75	1304.36	3.57	
6546.00	10.300	96.200	6395.93	1325.37	-181.81	1312.84	2.99	
6590.00	8.900	93.400	6439.31	1332.70	-182.44	1320.15	3.35	
6634.00	7.500	91.300	6482.86	1338.94	-182.70	1326.42	3.25	
6680.00	6.300	88.800	6528.53	1344.42	-182.72	1331.94	2.69	
6725.00	5.500	96.200	6573.29	1349.01	-182.90	1336.56	2.45	
6770.00	4.800	92.000	6618.11	1353.04	-183.20	1340.58	1.77	
6815.00	4.100	91.600	6662.97	1356.51	-183.31	1344.07	1.56	
6860.00	3.400	90.200	6707.88	1359.44	-183.36	1347.01	1.57	



Actual Wellpath Report

STONEBRAKER 8-12 AWP

Page 4 of 5



INTEQ

REFERENCE WELLPATH IDENTIFICATION

Operator	KERR MCGEE OIL & GAS ONSHORE LP	Slot	SLOT#05 STONEBRAKER 8-12 (1805'FNL & 2045'FEL)
Area	COLORADO	Well	STONEBRAKER 8-12
Field	WELD COUNTY (KERR MCGEE)	Wellbore	STONEBRAKER 8-12 AWB
Facility	SEC.12-T1N-R68W		

WELLPATH DATA (112 stations)

MD [ft]	Inclination [°]	Azimuth [°]	TVD [ft]	Vert Sect [ft]	North [ft]	East [ft]	DLS [°/100ft]	Comments
6906.00	2.900	86.400	6753.81	1361.93	-183.29	1349.54	1.18	
6951.00	2.500	87.800	6798.76	1364.01	-183.18	1351.66	0.90	
6996.00	2.000	100.100	6843.72	1365.76	-183.28	1353.41	1.54	
7041.00	1.800	95.100	6888.70	1367.25	-183.48	1354.89	0.58	
7086.00	1.400	94.800	6933.68	1368.51	-183.59	1356.14	0.89	
7176.00	1.000	83.500	7023.66	1370.37	-183.60	1358.01	0.51	
7266.00	1.600	108.200	7113.64	1372.36	-183.90	1359.99	0.90	
7353.00	1.200	99.000	7200.61	1374.47	-184.42	1362.04	0.53	
7444.00	0.600	88.100	7291.60	1375.89	-184.55	1363.46	0.68	
7534.00	0.600	85.300	7381.59	1376.82	-184.50	1364.40	0.03	
7623.00	0.700	72.600	7470.59	1377.76	-184.30	1365.38	0.20	
7713.00	0.700	76.900	7560.58	1378.77	-184.01	1366.44	0.06	
7804.00	1.000	73.400	7651.57	1380.02	-183.66	1367.75	0.33	
7892.00	1.100	69.500	7739.56	1381.46	-183.14	1369.27	0.14	
7983.00	1.100	58.900	7830.54	1382.91	-182.38	1370.84	0.22	
8072.00	1.100	68.800	7919.52	1384.32	-181.63	1372.37	0.21	
8162.00	1.000	47.000	8009.51	1385.57	-180.79	1373.75	0.45	
8251.00	0.700	33.300	8098.50	1386.30	-179.80	1374.61	0.40	
8340.00	0.500	16.700	8187.49	1386.59	-178.98	1375.02	0.30	
8431.00	0.400	342.600	8278.49	1386.52	-178.29	1375.04	0.31	
8504.00	0.300	24.100	8351.49	1386.46	-177.88	1375.04	0.36	
8560.00	0.300	24.100	8407.49	1386.54	-177.61	1375.16	0.00	

HOLE & CASING SECTIONS

Ref Wellbore: STONEBRAKER 8-12 AWB Ref Wellpath: STONEBRAKER 8-12 AWP

String/Diameter	Start MD [ft]	End MD [ft]	Interval [ft]	Start TVD [ft]	End TVD [ft]	Start N/S [ft]	Start E/W [ft]	End N/S [ft]	End E/W [ft]
12.25in Open Hole	17.00	1027.00	1010.00	17.00	1022.78	0.00	0.00	-15.50	72.43
8.625in Casing Surface	17.00	1027.00	1010.00	17.00	1022.78	0.00	0.00	-15.50	72.43
7.875in Open Hole	1027.00	8560.00	7533.00	1022.78	8407.49	-15.50	72.43	-177.61	1375.16



Actual Wellpath Report

STONEBRAKER 8-12 AWP

Page 5 of 5



INTEQ

REFERENCE WELLPATH IDENTIFICATION

Operator	KERR MCGEE OIL & GAS ONSHORE LP	Slot	SLOT#05 STONEBRAKER 8-12 (1805'FNL & 2045'FEL)
Area	COLORADO	Well	STONEBRAKER 8-12
Field	WELD COUNTY (KERR MCGEE)	Wellbore	STONEBRAKER 8-12 AWB
Facility	SEC.12-T1N-R68W		

TARGETS

Name	MD [ft]	TVD [ft]	North [ft]	East [ft]	Grid East [srv ft]	Grid North [srv ft]	Latitude	Longitude	Shape
STONEBRAKER 8-12 LEGAL BOX (187'N,213'S,207'W,193'E OF GEO TARGET)		6000.00	-202.39	1375.64	3155401.39	1267970.87	40°04'03.484"N	104°56'41.082"W	square
STONEBRAKER 8-12 GEO TARGET 50' RADIUS (1980'FNL & 660'FEL, REV-1)		6000.00	-189.39	1382.64	3155408.31	1267983.91	40°04'03.612"N	104°56'40.992"W	circle

WELLPATH COMPOSITION Ref Wellbore: STONEBRAKER 8-12 AWB Ref Wellpath: STONEBRAKER 8-12 AWP

Start MD [ft]	End MD [ft]	Positional Uncertainty Model	Log Name/Comment	Wellbore
17.00	964.00	NaviTrak (Standard)	BHI MWD SURVEYS 12.25 HOLE <152-964>	STONEBRAKER 8-12 AWB
964.00	8504.00	NaviTrak (Standard)	BHI MWD SURVEYS 7.875 HOLE <1056-8504>	STONEBRAKER 8-12 AWB
8504.00	8560.00	Blind Drilling (std)	Projection to bit	STONEBRAKER 8-12 AWB