

State of Colorado  
Oil and Gas Conservation Commission

1120 Lincoln Street, Suite 801, Denver, Colorado 80203 Phone: (303)894-2100 Fax: (303)894-2109



|    |    |    |    |
|----|----|----|----|
| DE | ET | OE | ES |
|    |    |    |    |

SUNDRY NOTICE

Submit original plus one copy. This form is to be used for general, technical and environmental sundry information. For proposed or completed operations, describe in full on Technical Information Page (Page 2 of this form.) Identify well or other facility by API Number or by OGCC Facility ID. Operator shall send an informational copy of all sundry notices for wells located in High Density Areas to the Local Government Designee (Rule 603b.)

|  |                                      |  |
|--|--------------------------------------|--|
| 1. OGCC Operator Number: 10081   | 4. Contact Name: Jeff Bull           | Complete the Attachment Checklist<br>OP OGCC |
| 2. Name of Operator: Windsor Energy Group, LLC                                       | Phone: 405-463-6912                  |  |
| 3. Address: 14301 Caliber Drive, Suite 300<br>City Oklahoma City State: Ok Zip 73134 | Fax: 405-850-5741                    |  |
| 5. API Number 05-103-08350   | OGCC Facility ID Number 315353       | 107351                                       |
| 6. Well/Facility Name Federal  | 7. Well/Facility Number N-16-3-101-S | Survey Plat                                  |
| 8. Location (QtrQtr, Sec, Twp, Rng, Meridian): SESW Sec 16 T3S R101W                 |                                      | Directional Survey                           |
| 9. County: Rio Blanco  | 10. Field Name: Cathedral - 10330    | Surface Eqpm Diagram                         |
| 11. Federal, Indian or State Lease Number: 44437                                     |                                      | Technical Info Page X                        |
|  |                                      | Other  |

General Notice

|  |   |
|--|---|
| <input type="checkbox"/> <b>CHANGE OF LOCATION:</b> Attach New Survey Plat (a change of surface qtr/qtr is substantive and requires a new permit)  |   |
| Change of <b>Surface</b> Footage from Exterior Section Lines: <input type="checkbox"/> FNL/FSL <input type="checkbox"/> FEL/FWL<br>Change of <b>Surface</b> Footage to Exterior Section Lines: <input type="checkbox"/> FNL/FSL <input type="checkbox"/> FEL/FWL<br>Change of <b>Bottomhole</b> Footage from Exterior Section Lines: <input type="checkbox"/> FNL/FSL <input type="checkbox"/> FEL/FWL<br>Change of <b>Bottomhole</b> Footage to Exterior Section Lines: <input type="checkbox"/> FNL/FSL <input type="checkbox"/> FEL/FWL | attach directional survey   |
| Bottomhole location Qtr/Qtr, Sec, Twp, Rng, Mer _____<br>Latitude _____ Distance to nearest property line _____ Distance to nearest bldg, public rd, utility or RR _____<br>Longitude _____ Distance to nearest lease line _____ Is location in a High Density Area (rule 603b)? Yes/No <input type="checkbox"/><br>Ground Elevation _____ Distance to nearest well same formation _____ Surface owner consultation date: _____  |   |
| <b>GPS DATA:</b><br>Date of Measurement _____ PDOP Reading _____ Instrument Operator's Name _____  |   |
| <input type="checkbox"/> <b>CHANGE SPACING UNIT</b><br>Formation _____ Formation Code _____ Spacing order number _____ Unit Acreage _____ Unit configuration _____   | <input type="checkbox"/> <b>Remove from surface bond</b><br>Signed surface use agreement attached   |
| <input type="checkbox"/> <b>CHANGE OF OPERATOR (prior to drilling):</b><br>Effective Date: _____<br>Plugging Bond: <input type="checkbox"/> Blanket <input type="checkbox"/> Individual  | <input type="checkbox"/> <b>CHANGE WELL NAME</b> <b>NUMBER</b><br>From: _____<br>To: _____<br>Effective Date: _____   |
| <input type="checkbox"/> <b>ABANDONED LOCATION:</b><br>Was location ever built? <input type="checkbox"/> Yes <input type="checkbox"/> No<br>Is site ready for inspection? <input type="checkbox"/> Yes <input type="checkbox"/> No<br>Date Ready for Inspection: _____   | <input type="checkbox"/> <b>NOTICE OF CONTINUED SHUT IN STATUS</b><br>Date well shut in or temporarily abandoned: _____<br>Has Production Equipment been removed from site? <input type="checkbox"/> Yes <input type="checkbox"/> No<br>MIT required if shut in longer than two years. Date of last MIT _____ |
| <input type="checkbox"/> <b>SPUD DATE:</b> _____   | <input type="checkbox"/> <b>REQUEST FOR CONFIDENTIAL STATUS</b> (6 mos from date casing set)  |
| <input type="checkbox"/> <b>SUBSEQUENT REPORT OF STAGE, SQUEEZE OR REMEDIAL CEMENT WORK</b> *submit cbl and cement job summaries<br>Method used _____ Cementing tool setting/perf depth _____ Cement volume _____ Cement top _____ Cement bottom _____ Date _____  |   |
| <input type="checkbox"/> <b>RECLAMATION:</b> Attach technical page describing final reclamation procedures per Rule 1004.<br>Final reclamation will commence on approximately _____ <input type="checkbox"/> Final reclamation is completed and site is ready for inspection.  |   |

Technical Engineering/Environmental Notice

|   |   |
|---|---|
| <input type="checkbox"/> <b>Notice of Intent</b><br>Approximate Start Date: _____   | <input type="checkbox"/> <b>Report of Work Done</b><br>Date Work Completed: _____   |
| Details of work must be described in full on Technical Information Page (Page 2 must be submitted.)   |   |
| <input type="checkbox"/> Intent to Recomplete (submit form 2)<br><input type="checkbox"/> Change Drilling Plans<br><input type="checkbox"/> Gross Interval Changed?<br><input type="checkbox"/> Casing/Cementing Program Change | <input type="checkbox"/> Request to Vent or Flare<br><input type="checkbox"/> Repair Well<br><input type="checkbox"/> Rule 502 variance requested<br><input checked="" type="checkbox"/> Other: Background Asenic |
| <input type="checkbox"/> E&P Waste Disposal<br><input type="checkbox"/> Beneficial Reuse of E&P Waste<br><input type="checkbox"/> Status Update/Change of Remediation Plans for Spills and Releases                             |   |

I hereby certify that the statements made in this form are, to the best of my knowledge, true, correct and complete.

Signed: Mark E. Mumby Date: 9/13/2010 Email: mmumby@hrccomp.com  
 Print Name: Mark E. Mumby Title: Prog Mgr and agent for Windsor

COGCC Approved: \_\_\_\_\_ Title \_\_\_\_\_ Date: \_\_\_\_\_

CONDITIONS OF APPROVAL, IF ANY:

TECHNICAL INFORMATION PAGE



FOR OGCC USE ONLY

1. OGCC Operator Number: 10081 API Number: 05-103-08350

2. Name of Operator: Windsor energy Group, LLC OGCC Facility ID # 315353

3. Well/Facility Name: Federal Well/Facility Number: N-16-3-101-S

4. Location (QtrQtr, Sec, Twp, Rng, Meridian): SESW Sec 16 T3S R101W

This form is to be completed whenever a Sundry Notice is submitted requiring detailed report of work to be performed or completed. This form shall be transmitted within 30 days of work completed as a "subsequent" report and must accompany Form 4, page 1.

5. DESCRIBE PROPOSED OR COMPLETED OPERATIONS

This request is in accordance with footnote 1 of Table 910-1 which indicates consideration will be given to background levls in native soils and groundwater.

during pit clclosure sampling the anlytical results indictaed higher levles of arsenic in the pit, at depth, than the background samples collected at the surface. Below are the analytical results for arsenic for review and approval to proceed with closure activities.

|                               |                   |  |
|-------------------------------|-------------------|--|
| Pit:                          | Arsenic 6.7 mg/Kg | Depth Collected 5-6 feet (Bottom of the pit) |
| Background Arsenic Location 1 | Arsenic 4.0 mg/Kg | Depth collected 0-12 inches                  |
| Background Arsenic Location 2 | Arsenic 4.2 mg/Kg | Depth collected 0-12 inches                  |
| Background arsenic Location 3 | Arsenic 4.1 mg/Kg | Depth collected 0-12 inches                  |

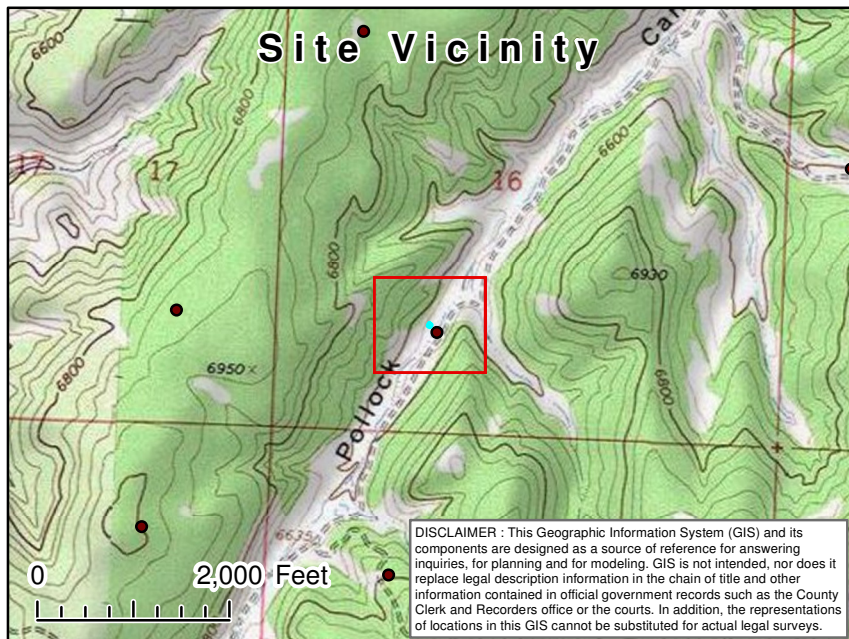

Form 4 Pit and Bkgd As  
Sample Location Map  
**Location: Federal N-16**  
Windsor Energy Group, LLC

**Legend**

**Sample Point (SP)**

- Pit Bottom SP
- Background (Bkgd) SP

**Location Features**

- Well Head Location
- Pit Boundary

- PLSS**
- Township
  - Section

**Hydrographic Features**

- Perennial Stream
- Intermittent Stream

