

BASHOR PC AA17-21 TANK

Steil Surveying Services, LLC

1102 West 19th Street P.O. BOX 2073

Cheyenne, Wyoming 82009

PRODUCTION FACILITY LOCATION DRAWING

FOR THE PROPOSED BASHOR PC AA17-21, 22, 23, 24, 15 & 16 *Pepper PCAA*

SECTION 17
TOWNSHIP 6 NORTH
RANGE 63 WEST

DATE: 06/23/2010

THIS MAP DOES NOT REPRESENT A BOUNDARY SURVEY

17-20

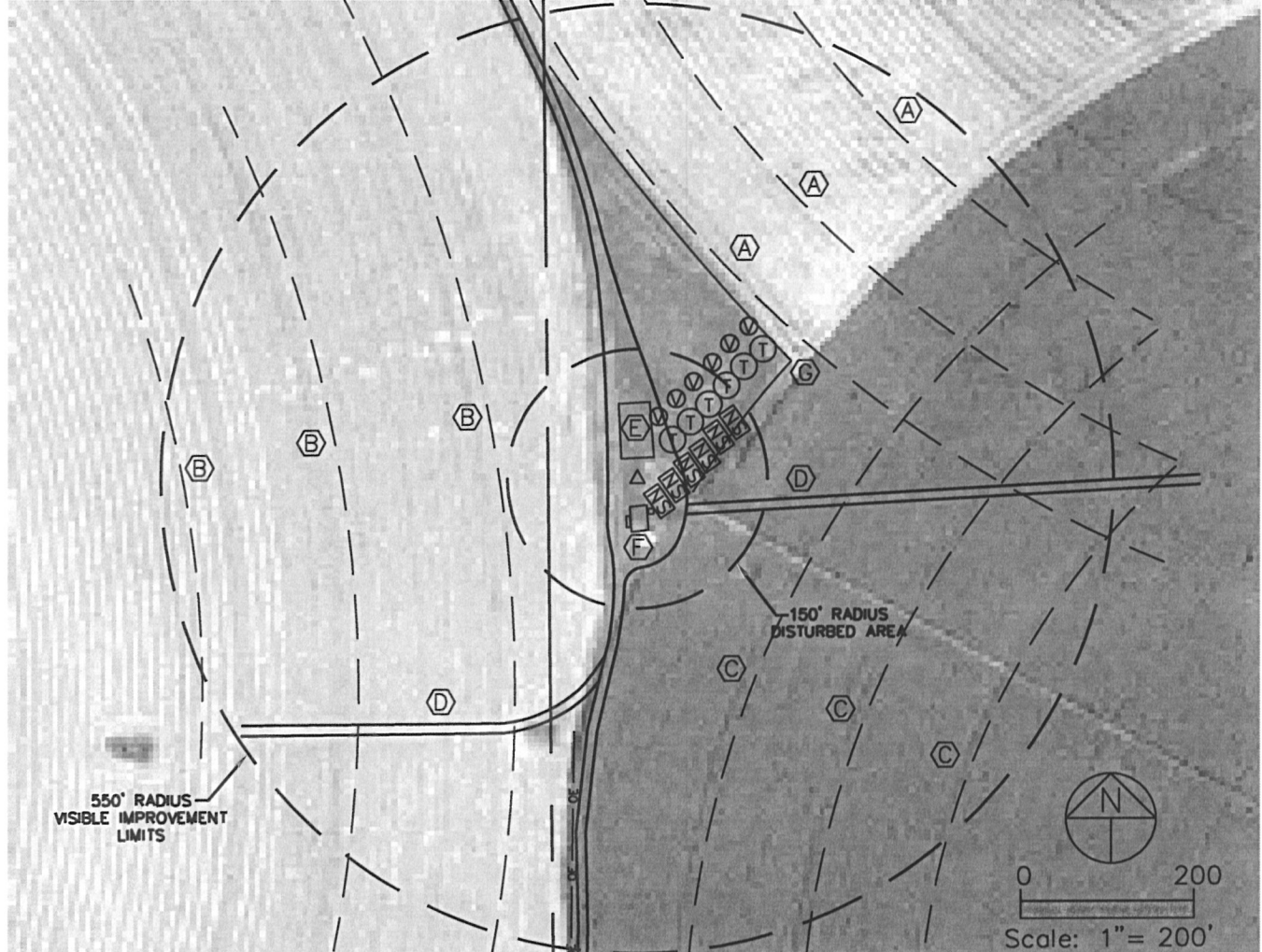

REFERENCE POINT LOCATION:

LAT: N 40.48486
LONG: W 104.46054
PDOP: 3.1, ELEV. 4673'
NW¼SE¼, SEC. 17
2009' FSL, 2517' FEL

ASSOCIATED NEW WELLS:

BASHOR PC AA17-21, 22,
23, 24, 15, 16

Pepper PCAA 17-20

ASSOCIATED EXISTING WELLS:

BASHOR 17-13
BASHOR 17-42

NEAREST PROPERTY LINE:

103' WEST

NEAREST OVERHEAD POWER LINE:

301' SOUTHWEST

IMPROVEMENTS:

- (A) IRRIGATION WHEEL TRACKS - 248', 362' & 498' NORTHEAST
- (B) IRRIGATION WHEEL TRACKS - 158', 338' & 519' WEST
- (C) IRRIGATION WHEEL TRACKS - 221', 355' & 490' SOUTHEAST
- (D) DIRT ROADS - 64' SOUTHEAST & 208' SOUTH
- (E) EXISTING NOBLE ENERGY TANKS - 24' NORTH
- (F) EXISTING NOBLE ENERGY SEPARATOR - 31' SOUTH
- (G) CROP LINE - 100'+/- EAST AND 250'+/- NORTHEAST

LEGEND:

- △ REFERENCE POINT
- ⊙ PROPOSED WATER VAULT
- ⊙ PROPOSED TANK
- ⊞ PROPOSED SEPARATOR

NOTE: Distances shown are to the proposed production facility reference point and were scaled from Weld County aerial photography. Improvements not shown on aerial photography were field verified.