

VISIBLE IMPROVEMENTS
THIS MAP DOES NOT REPRESENT A BOUNDARY SURVEY
Location Drawing

SECTION 33
TOWNSHIP 12 NORTH
RANGE 61 WEST

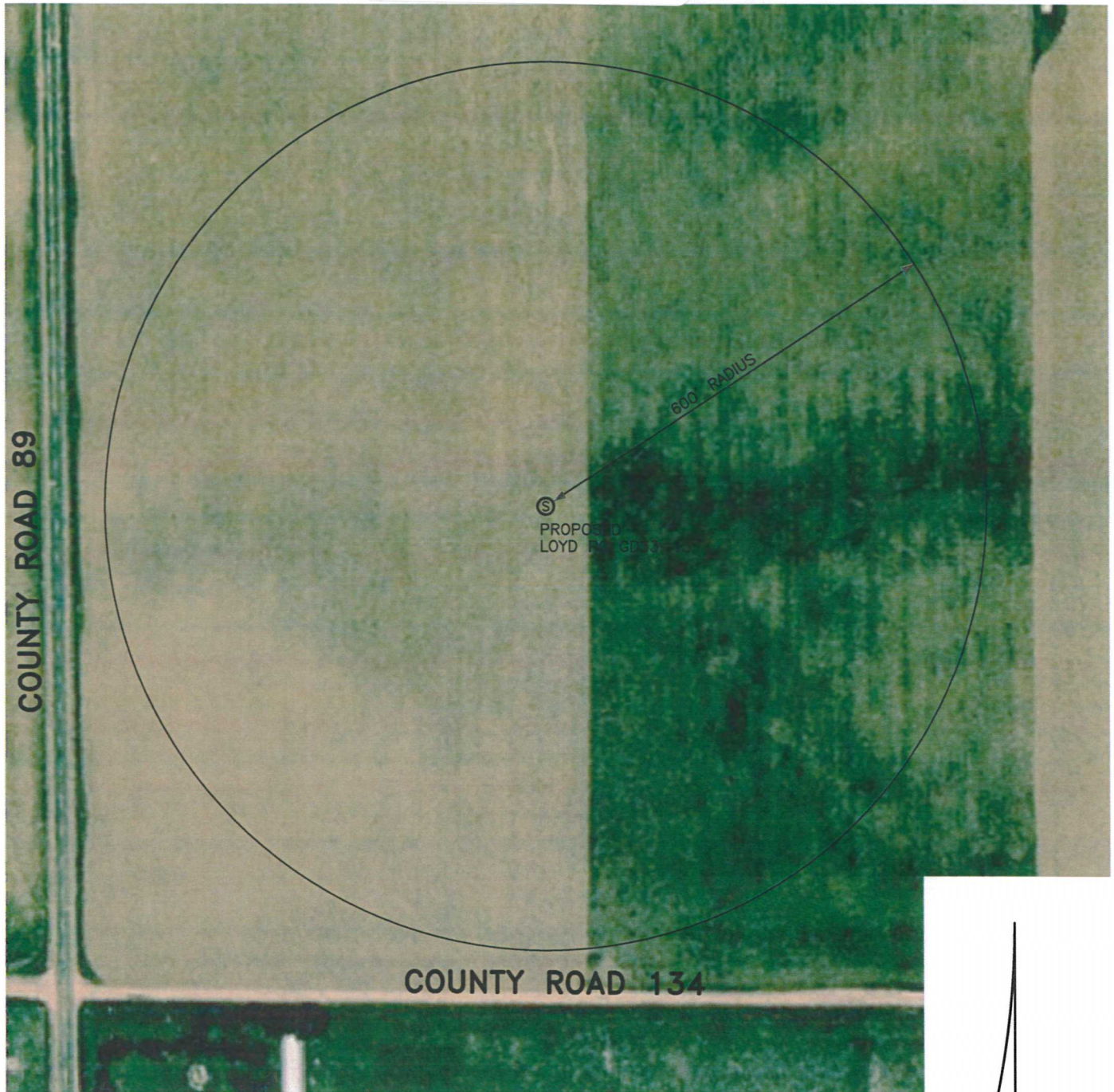

NOTICE: According to Colorado law you MUST commence any legal action based upon any defect in the W.L.C. within three years after you first discover such defect. In no event may only action based upon any defect in this W.L.C. be commenced more than ten years from this sold date of the certification shown hereon.

THE NEAREST OVERHEAD POWER LINE IS 637' WEST.



SCALE: 1"=200'
0 100 200
SCALE IN FEET