

*INJECTION FAC # 159193*

September 22, 2010

Mr. Bob Chesson
Environmental Protection Specialist
Colorado Oil and Gas Conservation Commission (COGCC)
1120 Lincoln Street, Suite 801
Denver, Colorado 80203

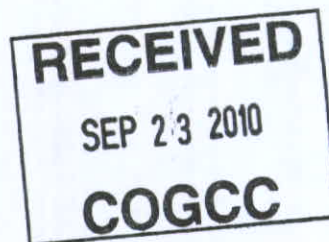

Subject: Quarterly Monitoring Report
Conquest Oil – C6 Facility
Conquest SWD # 1-30 API 05-123-26004 (Section 30 – 3N-65W)
13159 Weld County Road 39
Platteville, Colorado
CGRS Project No. 1-8019-10695aa

159193

Dear Mr. Chesson:

This report is a summary of monitoring activities performed by CGRS, Inc. (CGRS) at the Conquest Oil C6 facility near Platteville, Colorado. Monitoring activities were performed on September 1, 2010, and consisted of measuring depth to groundwater, collecting water quality samples from project groundwater monitoring wells, and contracting analytical testing of the water quality samples. Current site conditions are depicted on Figure 1.

Groundwater elevation data collected during the September 1, 2010, monitoring event are summarized with historical data in Table 1. A review of Table 1 shows that the depth to groundwater for this sampling event varied from 10.14 feet below top of well casing (toc) in monitoring well MW-4 to 22.51 feet below toc in well MW-5. Based on current data, the inferred groundwater flow direction is to the east-southeast at a calculated hydraulic gradient of approximately 0.066 feet per foot (ft/ft), which is consistent with historic data. Inferred groundwater contours are illustrated on Figure 2.

Water quality samples were obtained from four groundwater monitoring wells on September 1, 2010, and submitted to Technology Laboratory (Tech Lab) of Fort Collins, Colorado for analyses of benzene, toluene, ethylbenzene, and xylenes (BTEX), total dissolved solids (TDS), and chlorides. Current and historic analytical results are summarized in Table 1, and a Groundwater Sample Location Map is included as Figure 3. Laboratory data sheets and chain-of-custody documentation are presented in Attachment A.

A review of Table 1 for the most recent sampling event shows that BTEX analytes were not detected above laboratory method detection limits (MDLs) in the four monitoring well water quality samples submitted for analyses, and TDS and chloride concentrations were within ranges similar to historic site background limits. Furthermore, no liquids were discovered in the sub-containment monitoring points, and as such, no water quality samples were collected from them during this sampling event.

CGRS will continue with the quarterly monitoring program, which will consist of obtaining water level measurements and collecting water quality samples from project monitoring wells. Furthermore, water quality samples will be collected from the sub-containment monitoring points on an as-needed basis. The next quarterly monitoring event is scheduled for December 2010.

If you have any questions regarding this letter report, please call Mr. Craig Mulica at (970) 493-7780.

Sincerely,
CGRS, Inc.

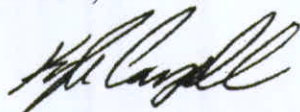

Kyle Campbell
Project Manager/Geologist

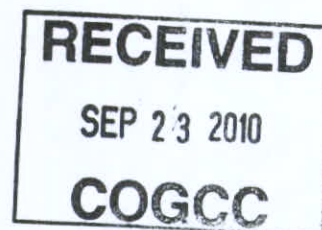

Reviewed by:

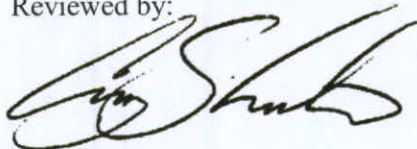

Craig S. Mulica
Project Manager/Geologist

Enclosures:

Figures 1 through 3

Table 1

Attachment A: Laboratory Analysis Reports & Chain-of-Custody Documentation

Ec: Ms. Rae Chrisman - Conquest Oil; raeconques@aol.com
Mr. Troy Swain - Weld County Department of Public Health and Environment;
tswain@co.weld.co.us

RECEIVED
SEP 23 2010
COGCC

FIGURES

RECEIVED
 SEP 23 2010
COGCC

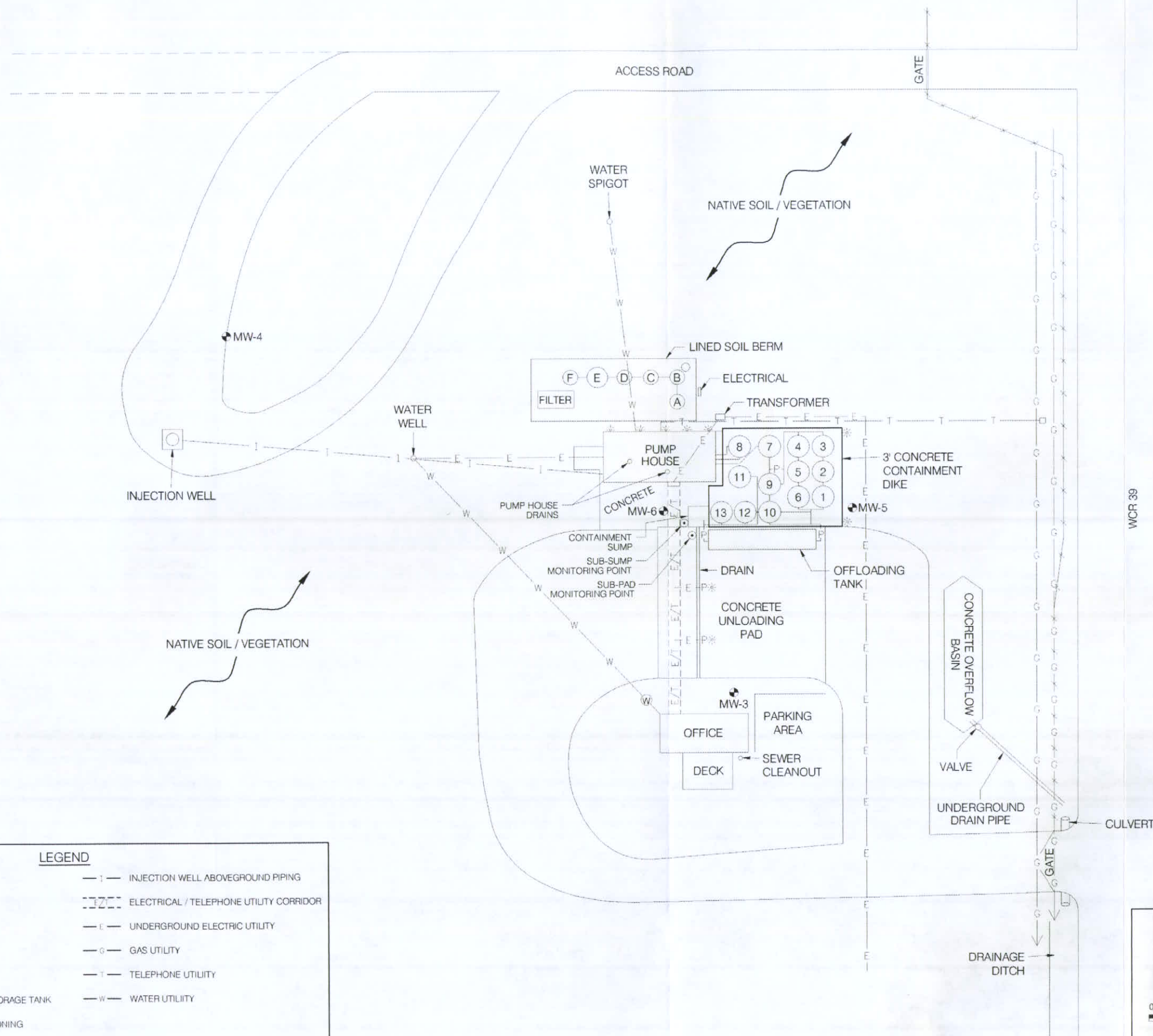

LEGEND

- | | |
|--|---|
| ● MW-3 MONITORING WELL LOCATION | — I — INJECTION WELL ABOVEGROUND PIPING |
| ⊙ SYSTEM MONITORING POINT | — E — UNDERGROUND ELECTRIC UTILITY |
| P PUMP | — G — GAS UTILITY |
| ⊙ OVERHEAD LIGHTING | — T — TELEPHONE UTILITY |
| — X — FENCE | — W — WATER UTILITY |
| 1 PROCESSING ABOVE GROUND STORAGE TANK | |
| A WATER TREATMENT AND CONDITIONING ABOVE GROUND STORAGE TANK | |
| | — E — ELECTRICAL / TELEPHONE UTILITY CORRIDOR |

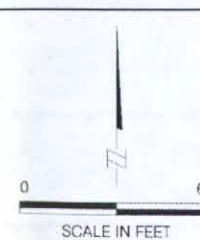

FIGURE 1
 SITE CONDITIONS MAP
 CONQUEST OIL C-6 FACILITY
 13159 WCR 39
 PLATTEVILLE, COLORADO

PROJECT:
 1-8019-10695aa
 DATE:
 03/18/10

DRAFT:
 RACAD
 REVIEW:
 CSM



RECEIVED
SEP 23 2010
COGCC

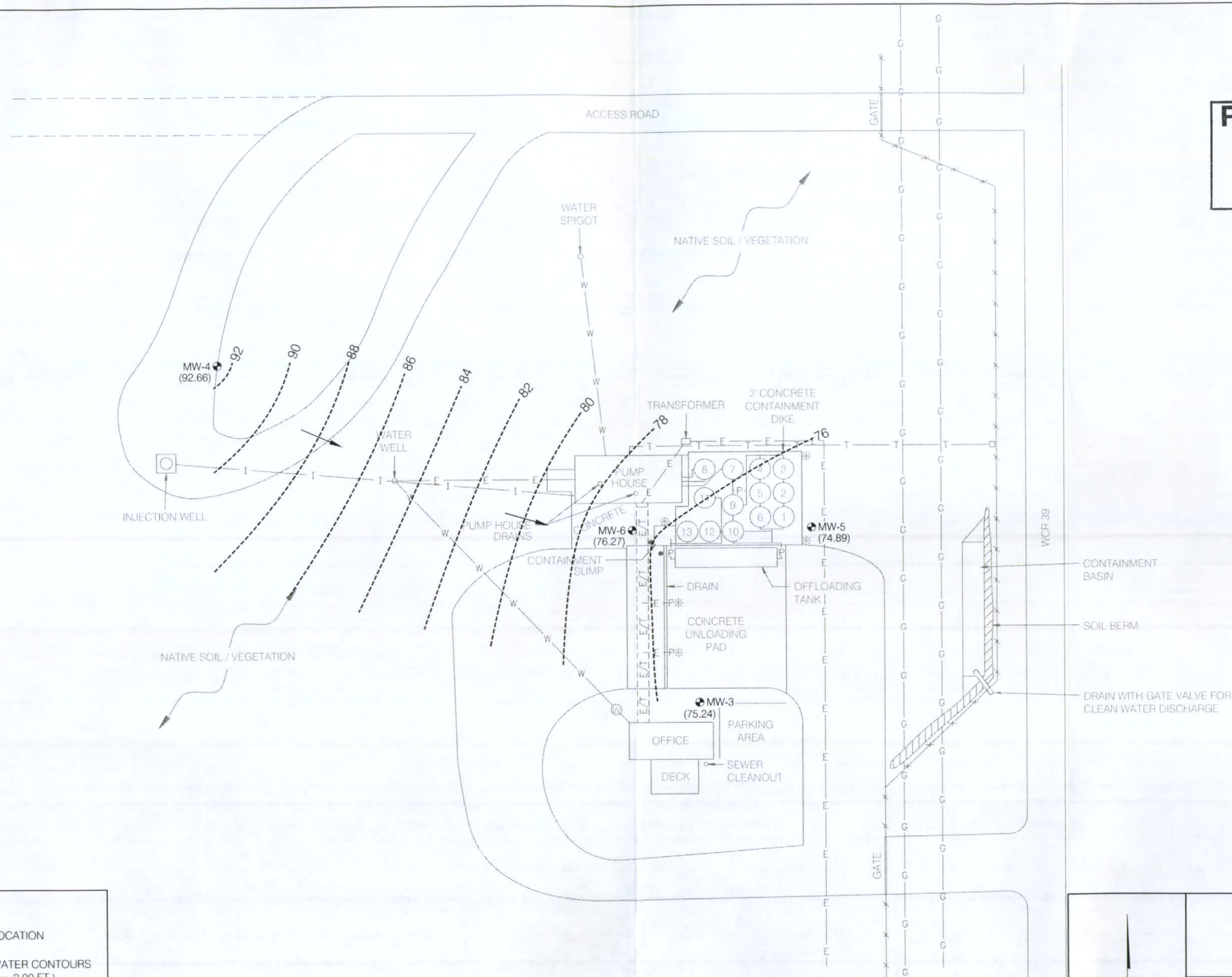

LEGEND

- MW-3 MONITORING WELL LOCATION
- INFERRED GROUNDWATER CONTOURS (CONTOUR INTERVAL = 2.00 FT.)
- (75.24) GROUNDWATER ELEVATION (IN FEET)
- INFERRED FLOW DIRECTION

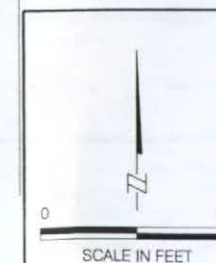

FIGURE 2
GROUNDWATER ELEVATION MAP
 September 1, 2010
 CONQUEST OIL C-6 FACILITY
 13159 WCR 39
 PLATTEVILLE, COLORADO

PROJECT:
 1-8019-10695aa
 DATE:
 09/17/10

DRAFT:
 CLB
 REVIEW:
 CSM



RECEIVED
 SEP 23 2010
COGCC

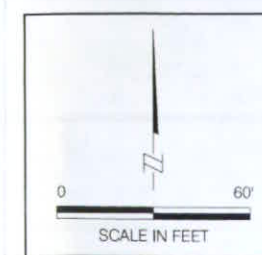
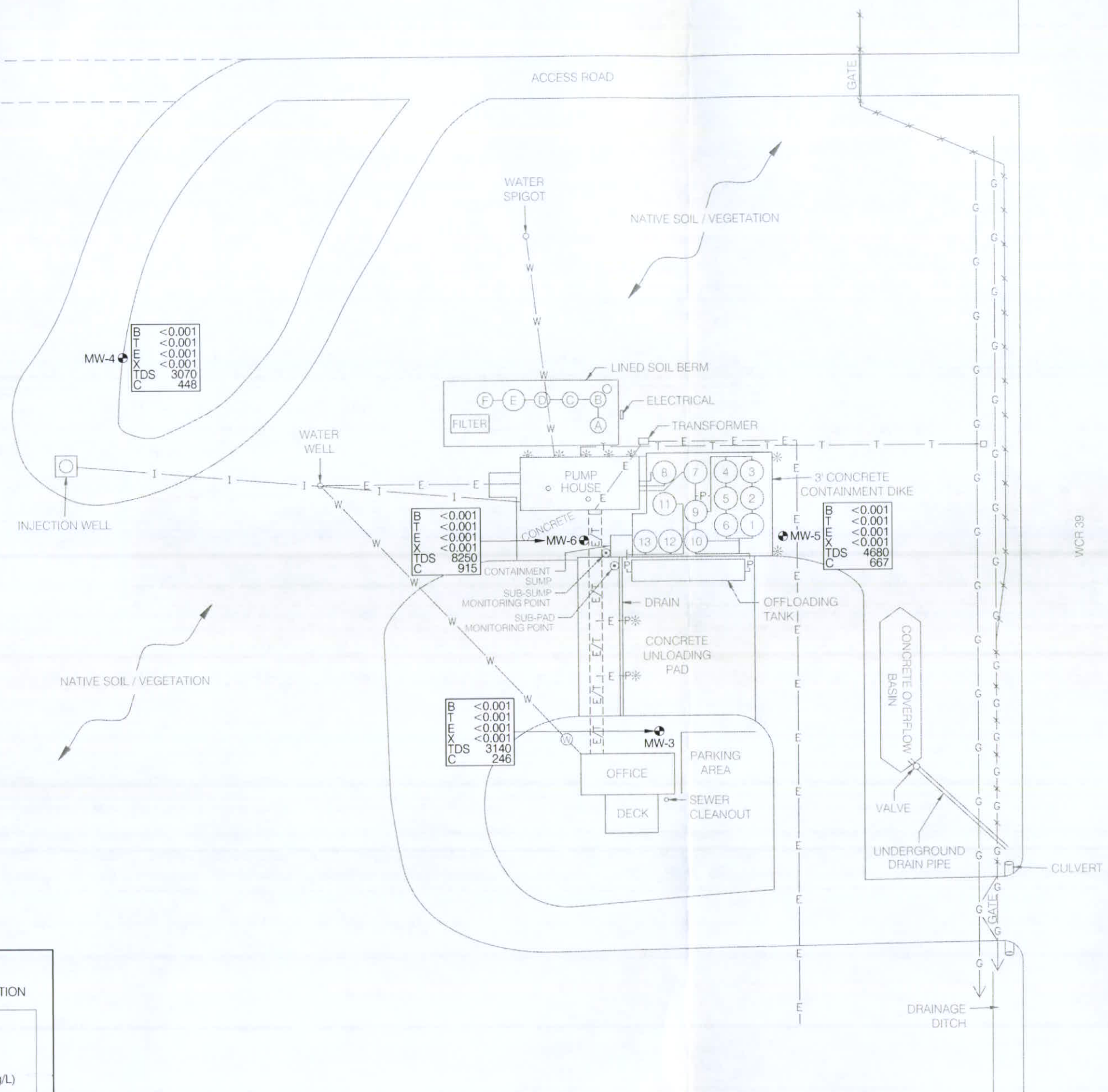

FIGURE 3
 GROUNDWATER SAMPLE LOCATION MAP
 September 1, 2010
 CONQUEST OIL C-6 FACILITY
 13159 WCR 39
 PLATTEVILLE, COLORADO

PROJECT: 1-8019-10695aa	DRAFT: RACAD
DATE: 09/16/10	REVIEW: C.S.M.

CGRS ENVIRONMENTAL CONSTRUCTION COMPLIANCE

RECEIVED

SEP 23 2010

COGCC

TABLES

RECEIVED

SEP 23 2010

COGCC

TABLE 1

Summary of Groundwater Elevation and Analytical data

Conquest Oil C6 Facility
13159 WCR 39
Platteville, Colorado

CGRS Project: 1-8019-10695aa

Sample ID	Date	Benzene (mg/L)	Toluene (mg/L)	Ethyl- Benzene (mg/L)	Xylenes (mg/L)	TVPH (mg/L)	TEPH (mg/L)	TRPH (mg/L)	TDS (mg/L)	Chlorides (mg/L)	Reference Elevation (ft)	Depth To Water (ft)	Groundwater Elevation (ft)
MW-1	04/05/06	<0.0005	<0.0005	<0.0005	<0.0005	<0.0005	<0.0005	NA	NA	NA	NS	17.12	NS
MW-1	04/12/07	NA	NA	NA	NA	NA	NA	NA	NA	NA	NS	17.18	NS
MW-1	11/15/07	NA	NA	NA	NA	NA	NA	NA	NA	NA	NS	16.34	NS
MW-2	04/05/06	NA	NA	NA	NA	NA	NA	NA	NA	NA	NS	DRY	DRY
MW-2	04/12/07	NA	NA	NA	NA	NA	NA	NA	NA	NA	NS	DRY	DRY
SB-4	04/05/06	<0.0005	<0.0005	<0.0005	<0.0005	<0.0005	<0.0005	NA	NA	NA	NS	NS	NS
MW-3	04/12/07	0.0021	0.0025	0.0026	0.008	<0.0005	NA	NA	NA	NA	NS	39.37	NS
MW-3	11/15/07	NA	NA	NA	NA	NA	NA	NA	NA	NA	NS	29.52	NS
MW-3	11/16/07	<0.0005	<0.0005	<0.0005	<0.0005	<0.0005	NA	NA	800	13.4	97.54	29.63	67.91
MW-3	03/04/08	<0.0005	<0.0005	<0.0005	<0.0005	<0.0005	NA	NA	NA	NA	97.54	29.27	68.27
MW-3	09/03/08	<0.001	<0.001	<0.001	<0.001	<0.001	NA	NA	NA	NA	97.54	27.59	69.95
MW-3	03/06/09	<0.001	<0.001	<0.001	<0.001	NA	NA	NA	860	84.7	97.54	26.70	70.84
MW-3	06/10/09	<0.001	<0.001	<0.001	<0.001	NA	NA	NA	1,590	126	97.54	25.48	72.06
MW-3	09/15/09	<0.001	<0.001	<0.001	<0.001	NA	NA	NA	2,820	177	97.54	24.31	73.23
MW-3	12/11/09	<0.001	<0.001	<0.001	<0.001	NA	NA	NA	1,750	144	97.54	23.75	73.79
MW-3	03/16/10	<0.001	<0.001	<0.001	<0.001	NA	NA	NA	970	72.2	97.54	24.47	73.07
MW-3	06/08/10	<0.001	<0.001	<0.001	<0.001	NA	NA	NA	2,880	200	97.54	23.04	74.50
MW-3	09/01/10	<0.001	<0.001	<0.001	<0.001	NA	NA	NA	3,140	246	97.54	22.30	75.24
MW-4	11/16/07	<0.0005	<0.0005	<0.0005	<0.0005	<0.0005	NA	NA	2,520	231	102.80	14.59	88.21
MW-4	03/04/08	<0.0005	<0.0005	<0.0005	<0.0005	<0.0005	NA	NA	NA	NA	102.80	14.17	88.63
MW-4	09/03/08	<0.001	<0.001	<0.001	<0.001	<0.001	NA	NA	NA	NA	102.80	12.78	90.02
MW-4	03/06/09	<0.001	<0.001	<0.001	<0.001	NA	NA	NA	2,630	355	102.80	13.71	89.09
MW-4	06/10/09	<0.001	<0.001	<0.001	<0.001	NA	NA	NA	2,760	291	102.80	11.05	91.75
MW-4	09/15/09	<0.001	<0.001	<0.001	<0.001	NA	NA	NA	2,720	311	102.80	11.37	91.43
MW-4	12/11/09	<0.001	<0.001	<0.001	<0.001	NA	NA	NA	2,780	374	102.80	12.25	90.55
MW-4	03/16/10	<0.001	<0.001	<0.001	<0.001	NA	NA	NA	2,690	379	102.80	13.02	89.78
MW-4	06/08/10	<0.001	<0.001	<0.001	<0.001	NA	NA	NA	3,010	374	102.80	10.64	92.16
MW-4	09/01/10	<0.001	<0.001	<0.001	<0.001	NA	NA	NA	3,070	448	102.80	10.14	92.66
MW-5	11/16/07	<0.0005	0.0019	0.0007	0.0036	<0.0005	NA	NA	9,600	1,028	97.40	31.48	65.92
MW-5	03/04/08	<0.0005	<0.0005	<0.0005	<0.0005	<0.0005	NA	NA	NA	NA	97.40	29.68	67.72
MW-5	09/03/08	<0.001	<0.001	<0.001	<0.001	<0.001	NA	NA	NA	NA	97.40	28.49	68.91
MW-5	03/06/09	<0.001	<0.001	<0.001	<0.001	NA	NA	NA	7,130	887	97.40	26.28	71.12
MW-5	06/10/09	<0.001	<0.001	<0.001	<0.001	NA	NA	NA	6,170	656	97.40	25.71	71.69
MW-5	09/15/09	<0.001	<0.001	<0.001	<0.001	NA	NA	NA	6,660	712	97.40	24.87	72.53
MW-5	12/11/09	<0.001	<0.001	<0.001	<0.001	NA	NA	NA	5,220	652	97.40	23.59	73.81

RECEIVED
SEP 23 2010
COGCC

TABLE 1

Summary of Groundwater Elevation and Analytical data

Conquest Oil C6 Facility
13159 WCR 39
Platteville, Colorado

CGRS Project: 1-8019-10695aa

Sample ID	Date	Benzene	Toluene	Ethyl-Benzene	Xylenes	TVPH	TEPH	TRPH	TDS	Chlorides	Reference Elevation	Depth To Water	Groundwater Elevation
		(mg/L)	(mg/L)	(mg/L)	(mg/L)	(mg/L)	(mg/L)	(mg/L)	(mg/L)	(mg/L)	(ft)	(ft)	(ft)
MW-5	03/16/10	<0.001	<0.001	<0.001	<0.001	NA	NA	NA	4,670	679	97.40	24.20	73.20
MW-5	06/08/10	<0.001	<0.001	<0.001	<0.001	NA	NA	NA	5,880	727	97.40	23.06	74.34
MW-5	09/01/10	<0.001	<0.001	<0.001	<0.001	NA	NA	NA	4,680	667	97.40	22.51	74.89
MW-6	11/16/07	<0.0005	0.0012	<0.0005	0.0019	<0.0005	NA	NA	10,100	880	NS	47.25	NS
MW-6	03/04/08	<0.0005	<0.0005	<0.0005	<0.0005	<0.0005	NA	NA	NA	NA	95.21	25.48	69.73
MW-6	09/03/08	<0.001	<0.001	<0.001	<0.001	<0.001	NA	NA	NA	NA	95.21	25.13	70.08
MW-6	03/06/09	<0.001	<0.001	<0.001	<0.001	NA	NA	NA	8,470	824	95.21	23.12	72.09
MW-6	06/10/09	<0.001	<0.001	<0.001	<0.001	NA	NA	NA	8,350	705	95.21	22.82	72.39
MW-6	09/15/09	<0.001	<0.001	<0.001	<0.001	NA	NA	NA	9,140	779	95.21	21.15	74.06
MW-6	12/11/09	<0.001	<0.001	<0.001	<0.001	NA	NA	NA	8,810	885	95.21	20.09	75.12
MW-6	03/16/10	<0.001	<0.001	<0.001	<0.001	NA	NA	NA	7,990	958	95.21	19.82	75.39
MW-6	06/08/10	<0.001	<0.001	<0.001	<0.001	NA	NA	NA	9,020	854	95.21	19.58	75.63
MW-6	09/01/10	<0.001	<0.001	<0.001	<0.001	NA	NA	NA	8,250	915	95.21	18.94	76.27
Unloading Pad MP	09/15/09	NA	NA	NA	NA	NA	NA	NA	NA	NA	-	DRY	-
Unloading Pad MP	12/11/09	1.17	1.89	0.020	3.55	NA	NA	150	NA	NA	-	NM	-
Unloading Pad MP	03/16/10	NA	NA	NA	NA	NA	NA	NA	NA	NA	-	DRY	-
Unloading Pad MP	06/08/10	NA	NA	NA	NA	NA	NA	NA	NA	NA	-	DRY	-
Unloading Pad MP	09/01/10	NA	NA	NA	NA	NA	NA	NA	NA	NA	-	DRY	-
Sump MP	03/16/10	NA	NA	NA	NA	NA	NA	NA	NA	NA	-	12.84	-
Sump MP	06/08/10	NA	NA	NA	NA	NA	NA	NA	NA	NA	-	DRY	-
Sump MP	09/01/10	NA	NA	NA	NA	NA	NA	NA	NA	NA	-	DRY	-
MCL		0.005	1	0.7	10	-	-	-	-	-	-	-	-
MDL		0.0005	0.0005	0.0005	0.0005	0.5	0.5	0.5	-	-	-	-	-

Notes:

Values in **bold face** exceed MCLs

TVPH = Total Volatile Petroleum Hydrocarbons

TEPH = Total Extractable Petroleum Hydrocarbons

TRPH = Total Recoverable Petroleum Hydrocarbons

MP = Monitoring Point: Monitors the secondary containment liner below the concrete unloading pad and the concrete sump.

MCL = COGCC Maximum Contaminant Level

MDL = Method Detection Limit

NS = Not Surveyed

NA = Not Analyzed

NM = Not measured

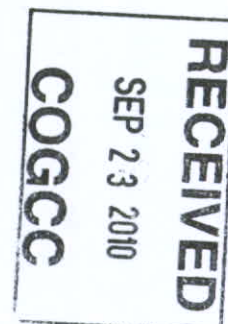

ATTACHMENT A

LABORATORY ANALYSIS REPORTS &
CHAIN-OF-CUSTODY DOCUMENTATION



TECHNOLOGY LABORATORY, INC.

CENTRE PROFESSIONAL PARK

1012 Centre Avenue
Fort Collins, Colorado 80526
(970) 490-1414

CERTIFICATE OF ANALYSIS

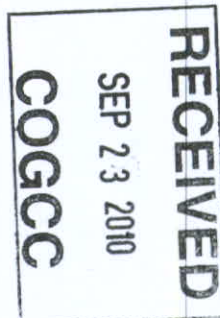

CGRS, INC.
PO Box 1489
Fort Collins, CO 80522

Sample ID: MW-3
Laboratory ID: A2392-01

Sampled: 09/01/10
Received: 09/02/10

Project No.: 1-8019-10695aa
Matrix: Water

CAS Number	Parameter	Result	Units	Method	Date Analyzed
71-43-2	Benzene	< 0.001	mg/L	EPA-8260B	09/04/10
108-88-3	Toluene	< 0.001	mg/L	EPA-8260B	09/04/10
100-41-4	Ethylbenzene	< 0.001	mg/L	EPA-8260B	09/04/10
1330-20-7	Total Xylenes	< 0.001	mg/L	EPA-8260B	09/04/10
16887-00-6	Chloride	246	mg/L	EPA-300.1	09/07/10
	Total Dissolved Solids (TDS)	3140	mg/L	EPA-160.1	09/03/10

QA/QC SURROGATE RECOVERIES

Compound	% Recovery	% Rec. Limits
Dibromofluoromethane	100	68-120
Toluene-d8	94	81-128
Bromofluorobenzene	89	70-113

TECHNOLOGY LABORATORY, INC.

The results contained in this report
relate only to those items tested.

**TECHNOLOGY LABORATORY, INC.****CENTRE PROFESSIONAL PARK**

1012 Centre Avenue
Fort Collins, Colorado 80526
(970) 490-1414

RECEIVED

SEP 23 2010

COGCC**CERTIFICATE OF ANALYSIS**

CGRS, INC.
PO Box 1489
Fort Collins, CO 80522

Sample ID: MW-4
Laboratory ID: A2392-02

Sampled: 09/01/10

Received: 09/02/10

Project No.: 1-8019-10695aa

Matrix: Water

<u>CAS Number</u>	<u>Parameter</u>	<u>Result</u>	<u>Units</u>	<u>Method</u>	<u>Date Analyzed</u>
71-43-2	Benzene	< 0.001	mg/L	EPA-8260B	09/04/10
108-88-3	Toluene	< 0.001	mg/L	EPA-8260B	09/04/10
100-41-4	Ethylbenzene	< 0.001	mg/L	EPA-8260B	09/04/10
1330-20-7	Total Xylenes	< 0.001	mg/L	EPA-8260B	09/04/10
16887-00-6	Chloride	448	mg/L	EPA-300.1	09/07/10
	Total Dissolved Solids (TDS)	3070	mg/L	EPA-160.1	09/03/10

QA/QC SURROGATE RECOVERIES

<u>Compound</u>	<u>% Recovery</u>	<u>% Rec. Limits</u>
Dibromofluoromethane	103	68-120
Toluene-d8	93	81-128
Bromofluorobenzene	88	70-113

TECHNOLOGY LABORATORY, INC.

The results contained in this report
relate only to those items tested.

**TECHNOLOGY LABORATORY, INC.****CENTRE PROFESSIONAL PARK**

1012 Centre Avenue
Fort Collins, Colorado 80526
(970) 490-1414

RECEIVED

SEP 23 2010

COGCC**CERTIFICATE OF ANALYSIS**

CGRS, INC.
PO Box 1489
Fort Collins, CO 80522

Sample ID: MW-5
Laboratory ID: A2392-03

Sampled: 09/01/10

Received: 09/02/10

Project No.: 1-8019-10695aa

Matrix: Water

<u>CAS Number</u>	<u>Parameter</u>	<u>Result</u>	<u>Units</u>	<u>Method</u>	<u>Date Analyzed</u>
71-43-2	Benzene	< 0.001	mg/L	EPA-8260B	09/04/10
108-88-3	Toluene	< 0.001	mg/L	EPA-8260B	09/04/10
100-41-4	Ethylbenzene	< 0.001	mg/L	EPA-8260B	09/04/10
1330-20-7	Total Xylenes	< 0.001	mg/L	EPA-8260B	09/04/10
16887-00-6	Chloride	667	mg/L	EPA-300.1	09/07/10
	Total Dissolved Solids (TDS)	4680	mg/L	EPA-160.1	09/03/10

QA/QC SURROGATE RECOVERIES

<u>Compound</u>	<u>% Recovery</u>	<u>% Rec. Limits</u>
Dibromofluoromethane	104	68-120
Toluene-d8	95	81-128
Bromofluorobenzene	92	70-113

TECHNOLOGY LABORATORY, INC.

The results contained in this report
relate only to those items tested.



TECHNOLOGY LABORATORY, INC.
CENTRE PROFESSIONAL PARK
1012 Centre Avenue
Fort Collins, Colorado 80526
(970) 490-1414

RECEIVED
SEP 23 2010
COGCC

CERTIFICATE OF ANALYSIS

CGRS, INC.
PO Box 1489
Fort Collins, CO 80522

Sample ID: MW-6
Laboratory ID: A2392-04

Sampled: 09/01/10

Received: 09/02/10

Project No.: 1-8019-10695aa

Matrix: Water

<u>CAS Number</u>	<u>Parameter</u>	<u>Result</u>	<u>Units</u>	<u>Method</u>	<u>Date Analyzed</u>
71-43-2	Benzene	< 0.001	mg/L	EPA-8260B	09/04/10
108-88-3	Toluene	< 0.001	mg/L	EPA-8260B	09/04/10
100-41-4	Ethylbenzene	< 0.001	mg/L	EPA-8260B	09/04/10
1330-20-7	Total Xylenes	< 0.001	mg/L	EPA-8260B	09/04/10
16887-00-6	Chloride	915	mg/L	EPA-300.1	09/07/10
	Total Dissolved Solids (TDS)	8250	mg/L	EPA-160.1	09/03/10

QA/QC SURROGATE RECOVERIES

<u>Compound</u>	<u>% Recovery</u>	<u>% Rec. Limits</u>
Dibromofluoromethane	99	68-120
Toluene-d8	95	81-128
Bromofluorobenzene	90	70-113

Bev Batters

TECHNOLOGY LABORATORY, INC.

The results contained in this report
relate only to those items tested.



TECHNOLOGY LABORATORY, INC.

1012 CENTRE AVENUE

FORT COLLINS, CO 80526

Phone: (970) 490-1414 Fax: (970) 472 5488

www.techlabusa.com sales@techlabusa.com

W.O. NUMBER A2392

CHAIN-OF-CUSTODY REPORT

COMPANY NAME <u>CCRS Inc.</u>			ANALYSIS REQUESTED												OTHER						
PROJECT MANAGER <u>Craig Malica</u>			SAMPLE MATRIX: SOIL (S) AIR (A) AQUEOUS (W) OTHER (O)	NUMBER OF CONTAINERS	BTEX / MPB / TPH	TEPH (DRO)	Oil & Grease 413.1 / 1664	VOC 624 / 8260 TOTAL / TCLP	SVOC 625 / 8270 / PAH	pH / TSS	RCRA 8 METALS (TOTAL / TCLP / DISSOLVED)	React. / Ignite. / Corr. / Paint Filter	TO-1 / TO-14 / TO-15 / TVPH	NITRATE / NITRITE / AMMONIA	BOD / COD	FIXED GASES (N ₂ O ₂ CO ₂ CH ₄)	PCBs	TDS / Chlorides	HOLD AFTER ANALYSIS	HOLD, DON'T ANALYZE	
PROJECT NUMBER <u>1-8019-10625aa</u>																					
PROJECT LOCATION OR NAME <u>Conquest 0.1 C-6</u>																					
SAMPLERS SIGNATURE <u>[Signature]</u>																					
LAB #	SAMPLE ID	DATE/TIME SAMPLED																			
1	MW-3	9/1/10	X	3	X	X															
2	MW-4		X	3	X	X															
3	MW-5		X	3	X	X															
4	MW-6		X	3	X	X															
<div style="border: 1px solid black; padding: 5px; display: inline-block;">RECEIVED SEP 23 2010 COGCC</div>																					

PAGE <u>1</u> OF <u>1</u>	COMMENTS: <u>[Signature]</u>	LOGGED IN BY: <u>TR</u>	Sample Preservative: <input checked="" type="checkbox"/> 4°C <input type="checkbox"/> None <input type="checkbox"/> Other
TURNAROUND TIME	RELINQUISHED BY:	DATE: <u>9/2/10</u>	RECEIVED BY: <u>[Signature]</u>
<input checked="" type="checkbox"/> Normal (5-10 working days)	COMPANY:	TIME: <u>1405</u>	COMPANY: <u>TLI</u>
<input type="checkbox"/> 3 day (1.5x Normal Rates)	RELINQUISHED BY:	DATE:	RECEIVED BY:
<input type="checkbox"/> 24 hr (2x Normal Rates)	COMPANY:	TIME:	COMPANY:
<input type="checkbox"/> Same day (4x Normal Rates)			