

WEXPRO COMPANY
JACKS DRAW UNIT #18 & #20
LOCATED IN MOFFAT COUNTY, COLORADO
SECTION 28, T12N, R97W, 6th P.M.

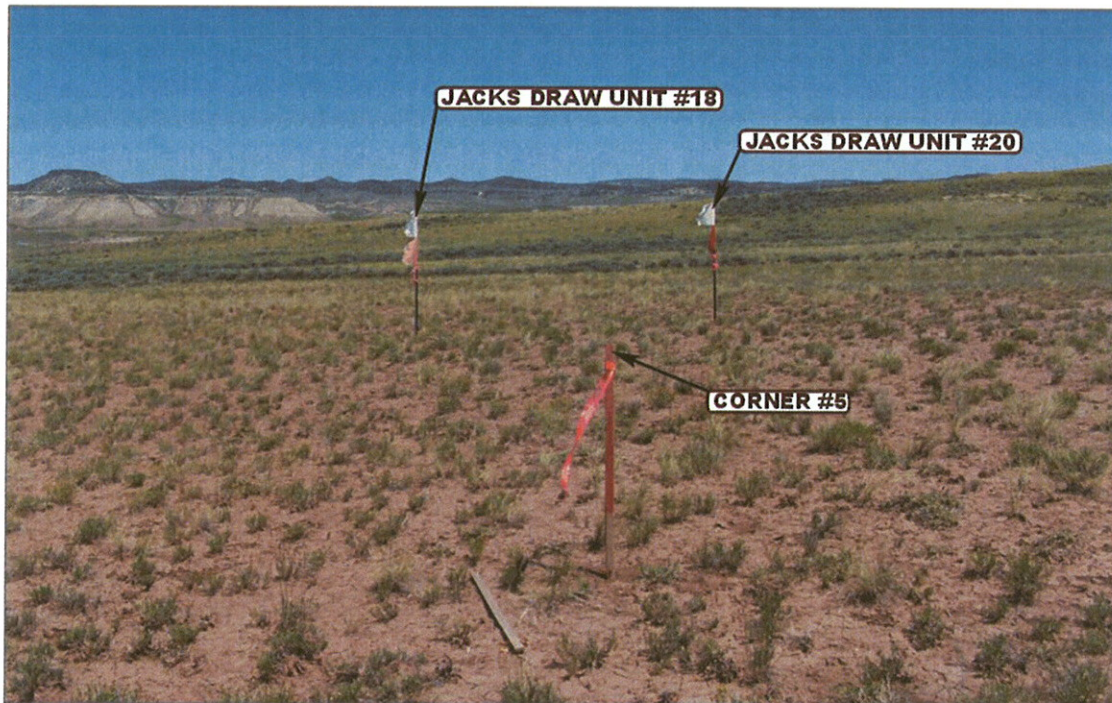

PHOTO: VIEW FROM CORNER #5 TO LOCATION STAKE

CAMERA ANGLE: NORTHERLY



PHOTO: VIEW FROM BEGINNING OF PROPOSED ACCESS

CAMERA ANGLE: NORTHEASTERLY



- Since 1964 -

UELS

Uintah Engineering & Land Surveying

85 South 200 East Vernal, Utah 84078
(435) 789-1017 * FAX (435) 789-1813

LOCATION PHOTOS

09 02 08
MONTH DAY YEAR

TAKEN BY: D.K.

DRAWN BY: J.H.

REV: 07-29-10 J.J.

PHOTO

P 1

WEXPRO COMPANY
JACKS DRAW UNIT #18 & #20
LOCATED IN MOFFAT COUNTY, COLORADO
SECTION 28, T12N, R97W, 6th P.M.



PHOTO: VIEW OF LOCATION STAKES

CAMERA ANGLE: NORTHERLY

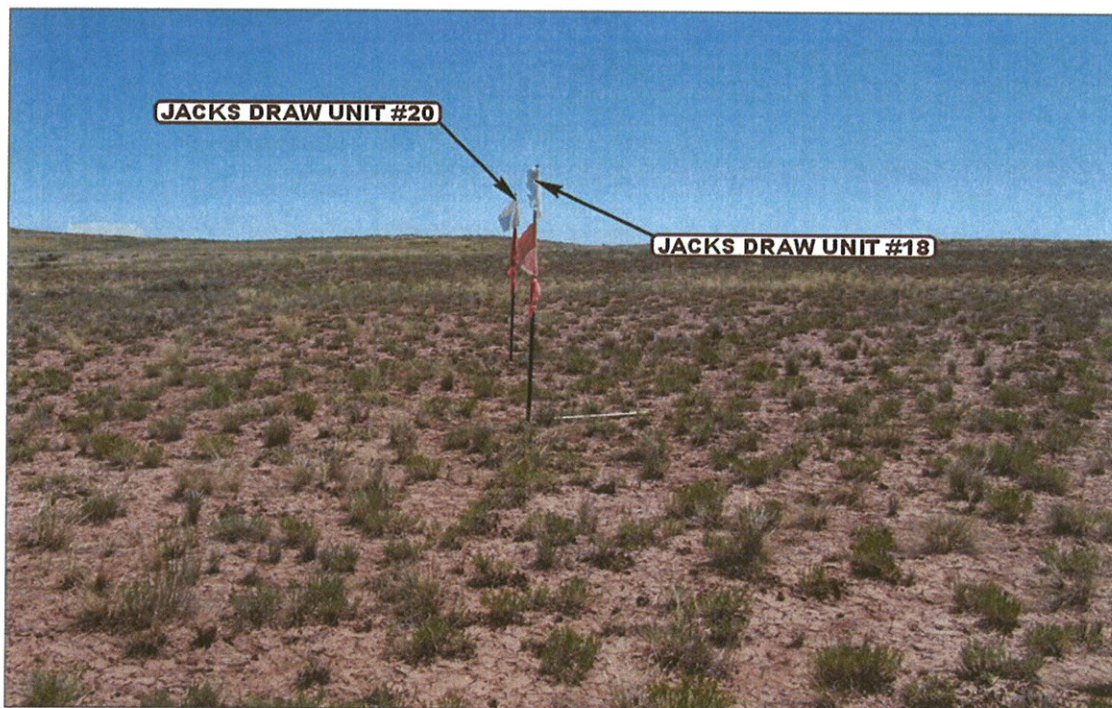

PHOTO: VIEW OF LOCATION STAKES

CAMERA ANGLE: EASTERLY



- Since 1964 -

UELS

Uintah Engineering & Land Surveying
85 South 200 East Vernal, Utah 84078
(435) 789-1017 * FAX (435) 789-1813

LOCATION PHOTOS

09 **09** **09**
MONTH DAY YEAR

TAKEN BY: D.K.

DRAWN BY: Z.L.

REV: 07-29-10 JJ.

PHOTO

P 2

WEXPRO COMPANY
JACKS DRAW UNIT #18 & #20
LOCATED IN MOFFAT COUNTY, COLORADO
SECTION 28, T12N, R97W, 6th P.M.

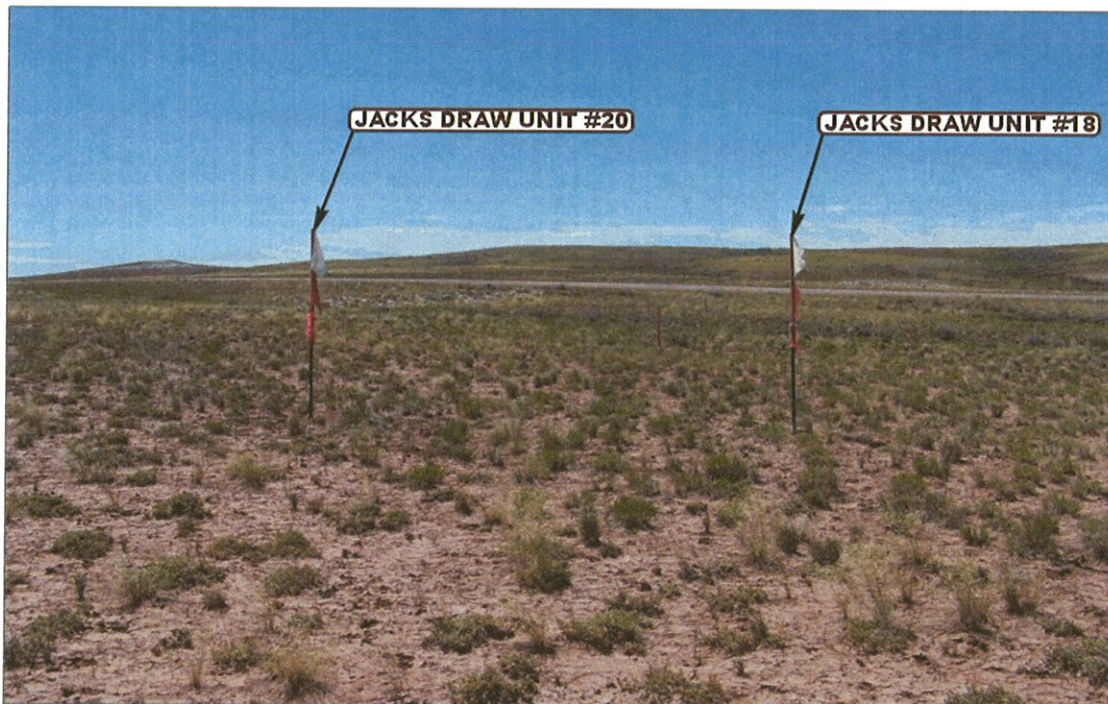

PHOTO: VIEW OF LOCATION STAKES

CAMERA ANGLE: SOUTHERLY

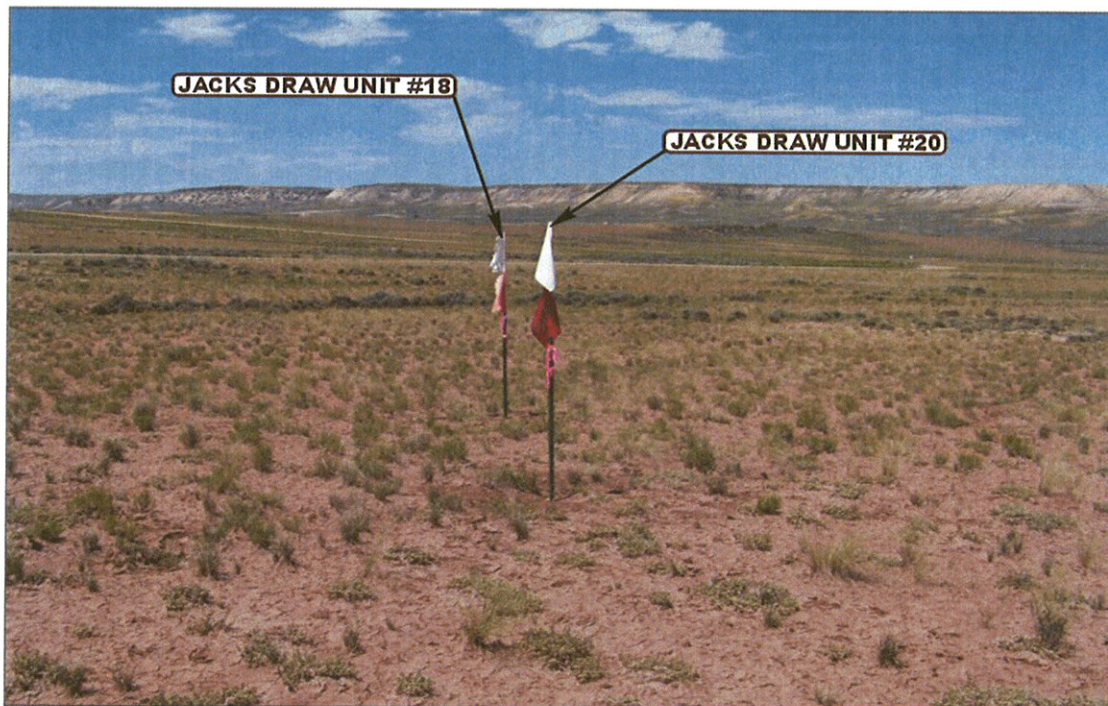

PHOTO: VIEW OF LOCATION STAKES

CAMERA ANGLE: WESTERLY



- Since 1964 -

UELS Uintah Engineering & Land Surveying
85 South 200 East Vernal, Utah 84078
(435) 789-1017 * FAX (435) 789-1813

LOCATION PHOTOS

09 **09** **09**
MONTH DAY YEAR

TAKEN BY: D.K. DRAWN BY: Z.L. REV: 07-29-10 J.J.

PHOTO

P 3