

ENCANA OIL & GAS (USA) INC

T6S, R93W, 6th P.M.

GENERAL MULTI WELL PLAN
SECTION DRILLING MAP

WELL PAD (K28NW) EXPANSION

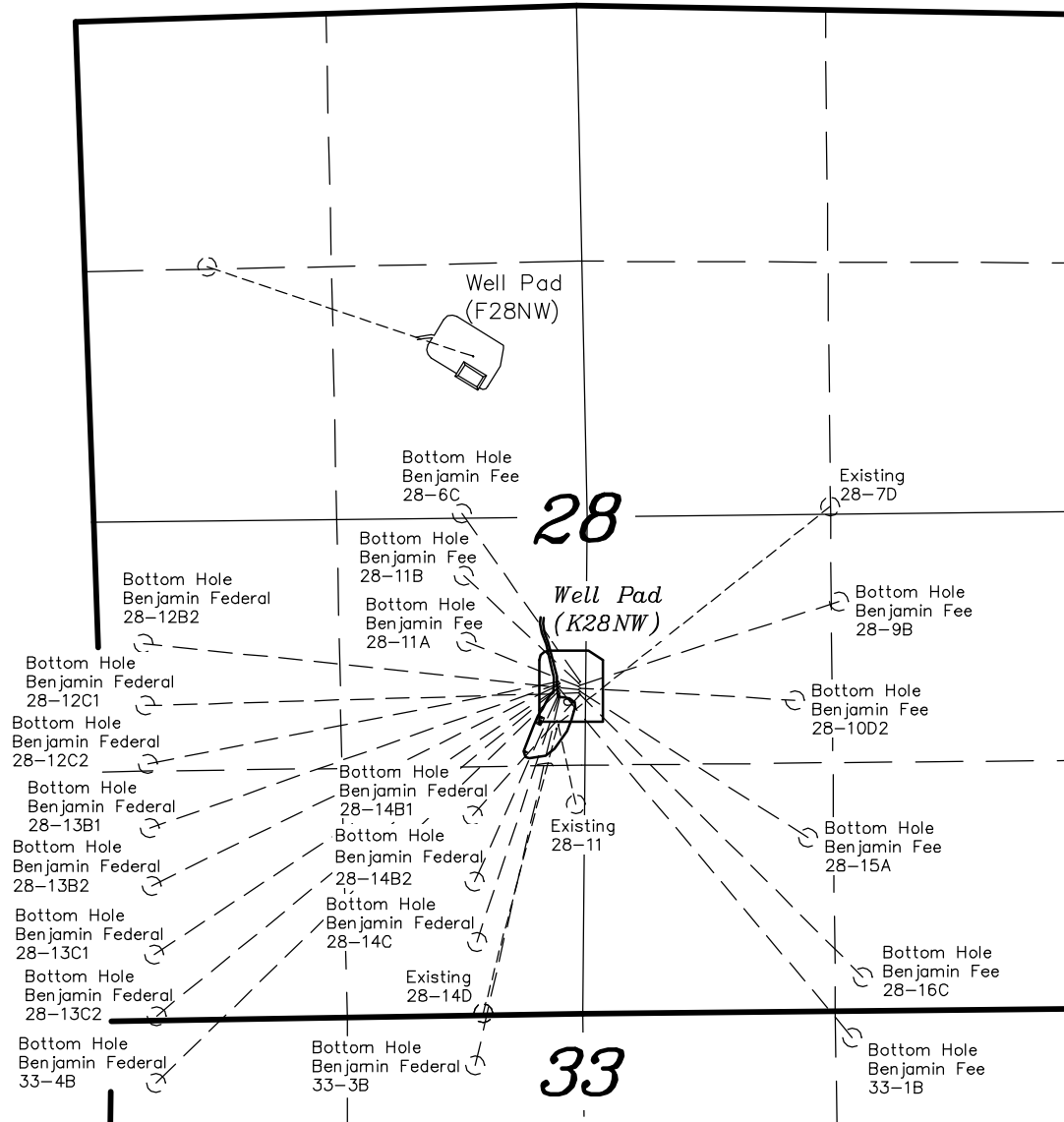

SURVEYED BY: C.D.S.	DATE SURVEYED: 06-11-10
DRAWN BY: L.C.S.	DATE DRAWN: 06-14-10
SCALE: 1" = 1000'	REVISED:

Tri State
Land Surveying, Inc.
180 NORTH VERNAL AVE. VERNAL, UTAH 84078
(435) 781-2501

SHEET
1
OF 11