

Well Details: CC 697-08-52A

TVD Reference: GL 8411' & RKB 30' @ 8441.00ft (H&P) Ground Level: 8411.00

| +N/-S | +E/-W | Northing  | Easting    | Latitude        | Longitude         | Slot |
|-------|-------|-----------|------------|-----------------|-------------------|------|
| 0.00  | 0.00  | 631002.36 | 1226944.34 | 39° 32' 2.033 N | 108° 14' 28.339 W | S    |

**T M** Azimuths to True North  
Magnetic North: 10.54°

Magnetic Field  
Strength: 52328.7snT  
Dip Angle: 65.76°  
Date: 9/1/2010  
Model: IGRF2005-10

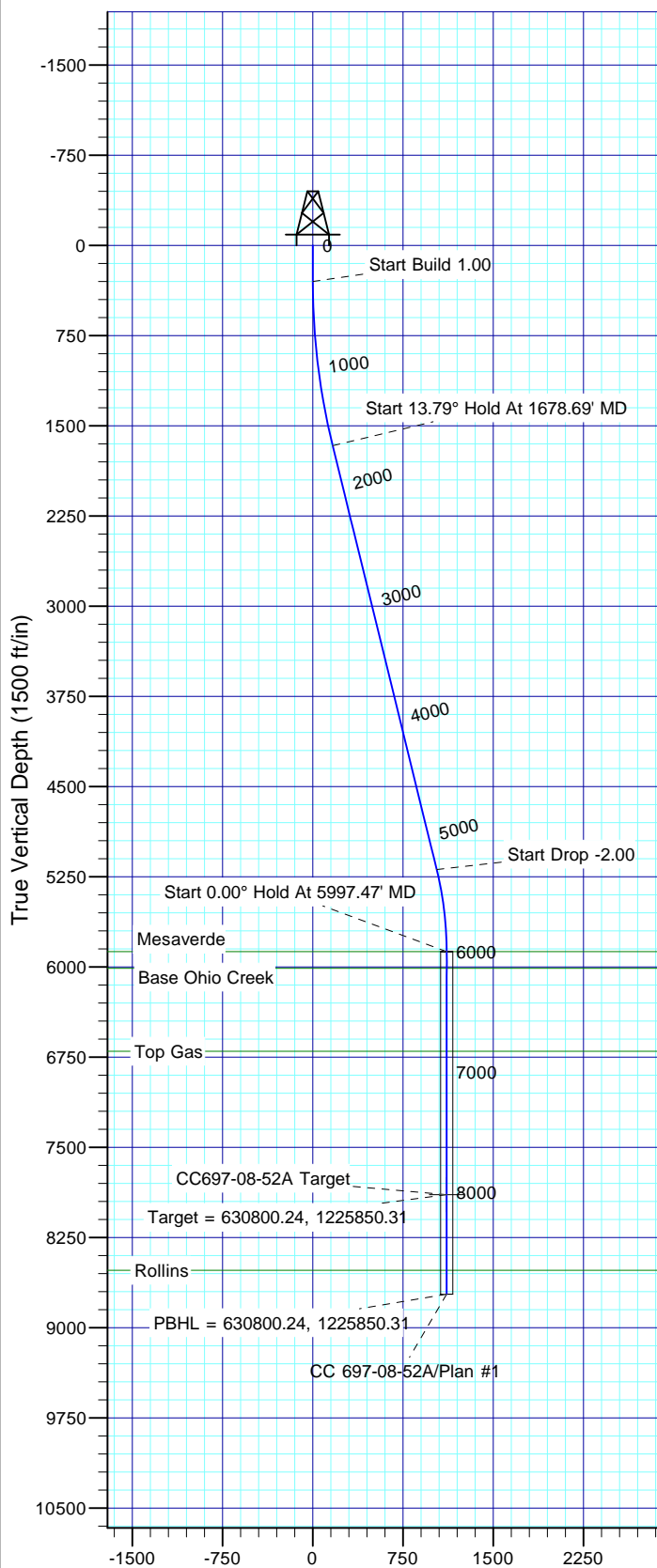

Vertical Section at 257.80° (1500 ft/in)

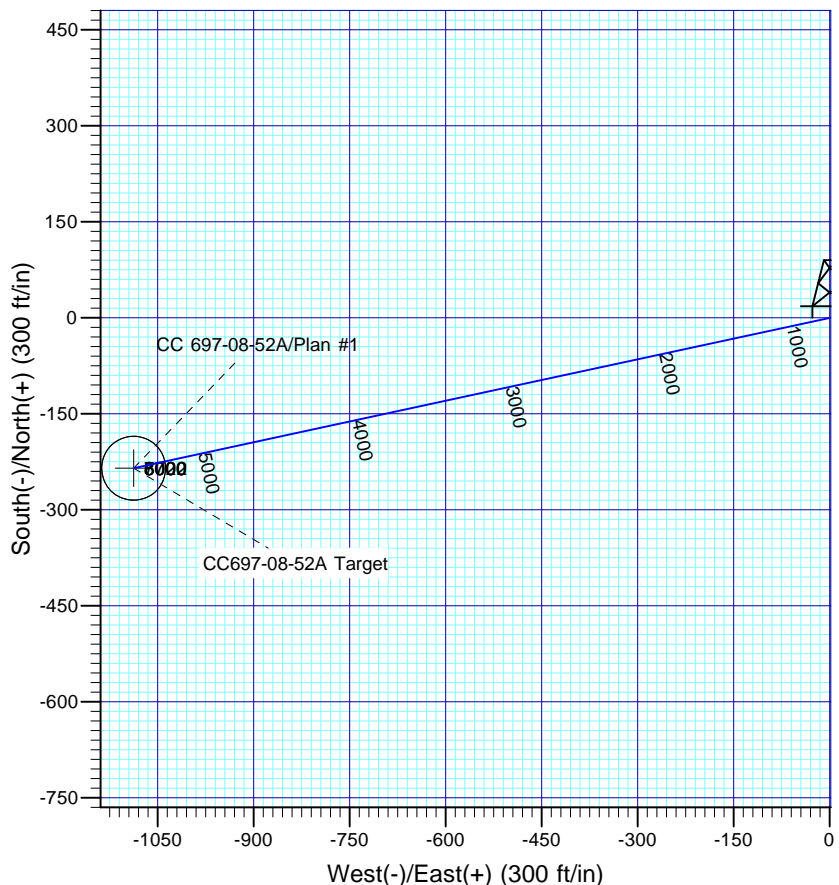

FORMATION TOP DETAILS

| TVDPath | MDPath  | Formation       |
|---------|---------|-----------------|
| 5873.00 | 5997.47 | Mesaverde       |
| 6011.00 | 6135.47 | Base Ohio Creek |
| 6701.00 | 6825.47 | Top Gas         |
| 8522.00 | 8646.47 | Rollins         |

Plan: Plan #1

**3:31, September 02 2010**  
**Created By: Rex Hall**

PROJECT DETAILS: Garfield County, CO NAD27

Geodetic System: US State Plane 1927 (Exact solution)  
Datum: NAD 1927 (NADCON CONUS)  
Ellipsoid: Clarke 1866  
Zone: Colorado Central 502

System Datum: Mean Sea Level

| CC 697-08-52A |             |              |             | Slot       | S |
|---------------|-------------|--------------|-------------|------------|---|
| NAD83         | NAD83       | NAD27        | NAD27       |            |   |
| CO. CENTRAL   | CO. CENTRAL | CO. CENTRAL  | CO. CENTRAL |            |   |
| NORTH (FEET)  | EAST (FEET) | NORTH (FEET) | EAST (FEET) |            |   |
| SHL           | 1631011.77  | 2226783.96   | 631002.36   | 1226944.34 |   |
| Top Gas       | 1630809.67  | 2225689.91   | 630800.24   | 1225850.31 |   |
| BHL           | 1630809.67  | 2225689.91   | 630800.24   | 1225850.31 |   |

SECTION DETAILS

| Sec | MD      | Inc   | Azi    | TVD     | +N/-S   | +E/-W    | Dleg | TFace  | Vsect  | Target              |
|-----|---------|-------|--------|---------|---------|----------|------|--------|--------|---------------------|
| 1   | 0.00    | 0.00  | 0.00   | 0.00    | 0.00    | 0.00     | 0.00 | 0.00   | 0.00   |                     |
| 2   | 300.00  | 0.00  | 0.00   | 300.00  | 0.00    | 0.00     | 0.00 | 0.00   | 0.00   |                     |
| 3   | 1678.69 | 13.79 | 257.80 | 1665.42 | -34.87  | -161.35  | 1.00 | 257.80 | 165.07 |                     |
| 4   | 5308.12 | 13.79 | 257.80 | 5190.29 | -217.60 | -1006.76 | 0.00 | 0.00   | 0.00   |                     |
| 5   | 5997.47 | 0.00  | 0.00   | 5873.00 | -235.03 | -1087.44 | 2.00 | 180.00 | 112.55 |                     |
| 6   | 8018.47 | 0.00  | 0.00   | 7894.00 | -235.03 | -1087.44 | 0.00 | 0.00   | 112.55 | CC697-08-52A Target |
| 7   | 8846.47 | 0.00  | 0.00   | 8722.00 | -235.03 | -1087.44 | 0.00 | 0.00   | 112.55 |                     |



# **OXY USA RMAT**

**Garfield County, CO NAD27  
Cascade Creek 697-08-53 Pad  
CC 697-08-52A - Slot S**

**OH**

**Plan: Plan #1**

## **Standard Planning Report**

**02 September, 2010**



|                  |                             |                                     |                                      |
|------------------|-----------------------------|-------------------------------------|--------------------------------------|
| <b>Database:</b> | Rockies-R5000.1             | <b>Local Co-ordinate Reference:</b> | Well CC 697-08-52A - Slot S          |
| <b>Company:</b>  | OXY USA RMAT                | <b>TVD Reference:</b>               | GL 8411' & RKB 30' @ 8441.00ft (H&P) |
| <b>Project:</b>  | Garfield County, CO NAD27   | <b>MD Reference:</b>                | GL 8411' & RKB 30' @ 8441.00ft (H&P) |
| <b>Site:</b>     | Cascade Creek 697-08-53 Pad | <b>North Reference:</b>             | True                                 |
| <b>Well:</b>     | CC 697-08-52A               | <b>Survey Calculation Method:</b>   | Minimum Curvature                    |
| <b>Wellbore:</b> | OH                          |                                     |                                      |
| <b>Design:</b>   | Plan #1                     |                                     |                                      |

|                    |                                      |                      |                |
|--------------------|--------------------------------------|----------------------|----------------|
| <b>Project</b>     | Garfield County, CO NAD27            |                      |                |
| <b>Map System:</b> | US State Plane 1927 (Exact solution) | <b>System Datum:</b> | Mean Sea Level |
| <b>Geo Datum:</b>  | NAD 1927 (NADCON CONUS)              |                      |                |
| <b>Map Zone:</b>   | Colorado Central 502                 |                      |                |

|                       |         |  |                   |                   |                   |
|-----------------------|---------|--|-------------------|-------------------|-------------------|
| Site                  |         | Cascade Creek 697-08-53 Pad, Sec. 8 T6S R97W |                   |                   |                   |
| Site Position:        |         | Northing:                                    | 630,837.78 usft   | Latitude:         | 39° 32' 0.393 N   |
| From:                 | Map     | Easting:                                     | 1,226,897.42 usft | Longitude:        | 108° 14' 28.874 W |
| Position Uncertainty: | 0.00 ft | Slot Radius:                                 | 0.000 in          | Grid Convergence: | -1.73 °           |

| Well                 |       | CC 697-08-52A - Slot S |                     |                   |               |                   |
|----------------------|-------|------------------------|---------------------|-------------------|---------------|-------------------|
| Well Position        | +N/-S | 165.92 ft              | Northing:           | 631,002.36 usft   | Latitude:     | 39° 32' 2.033 N   |
|                      | +E/-W | 41.93 ft               | Easting:            | 1,226,944.34 usft | Longitude:    | 108° 14' 28.339 W |
| Position Uncertainty |       | 0.00 ft                | Wellhead Elevation: |                   | Ground Level: | 8,411.00 ft       |

|                  |                   |                    |                        |                      |                            |
|------------------|-------------------|--------------------|------------------------|----------------------|----------------------------|
| <b>Wellbore</b>  | OH                |                    |                        |                      |                            |
| <b>Magnetics</b> | <b>Model Name</b> | <b>Sample Date</b> | <b>Declination (°)</b> | <b>Dip Angle (°)</b> | <b>Field Strength (nT)</b> |
|                  | IGRF2005-10       | 9/1/2010           | 10.54                  | 65.76                | 52,329                     |

|                          |                              |                   |                      |                      |
|--------------------------|------------------------------|-------------------|----------------------|----------------------|
| <b>Design</b>            | Plan #1                      |                   |                      |                      |
| <b>Audit Notes:</b>      |                              |                   |                      |                      |
| <b>Version:</b>          | <b>Phase:</b>                | PLAN              | <b>Tie On Depth:</b> | 0.00                 |
| <b>Vertical Section:</b> | <b>Depth From (TVD) (ft)</b> | <b>+N/-S (ft)</b> | <b>+E/-W (ft)</b>    | <b>Direction (°)</b> |
|                          | 0.00                         | 0.00              | 0.00                 | 257.80               |

| <b>Plan Sections</b> |                 |             |                     |            |            |                       |                      |                     |         |                    |
|----------------------|-----------------|-------------|---------------------|------------|------------|-----------------------|----------------------|---------------------|---------|--------------------|
| Measured Depth (ft)  | Inclination (°) | Azimuth (°) | Vertical Depth (ft) | +N/-S (ft) | +E/-W (ft) | Dogleg Rate (°/100ft) | Build Rate (°/100ft) | Turn Rate (°/100ft) | TFO (°) | Target             |
| 0.00                 | 0.00            | 0.00        | 0.00                | 0.00       | 0.00       | 0.00                  | 0.00                 | 0.00                | 0.00    |                    |
| 300.00               | 0.00            | 0.00        | 300.00              | 0.00       | 0.00       | 0.00                  | 0.00                 | 0.00                | 0.00    |                    |
| 1,678.69             | 13.79           | 257.80      | 1,665.42            | -34.87     | -161.35    | 1.00                  | 1.00                 | 0.00                | 257.80  |                    |
| 5,308.12             | 13.79           | 257.80      | 5,190.29            | -217.60    | -1,006.76  | 0.00                  | 0.00                 | 0.00                | 0.00    |                    |
| 5,997.47             | 0.00            | 0.00        | 5,873.00            | -235.03    | -1,087.44  | 2.00                  | -2.00                | 0.00                | 180.00  |                    |
| 8,018.47             | 0.00            | 0.00        | 7,894.00            | -235.03    | -1,087.44  | 0.00                  | 0.00                 | 0.00                | 0.00    | CC697-08-52A Targe |
| 8,846.47             | 0.00            | 0.00        | 8,722.00            | -235.03    | -1,087.44  | 0.00                  | 0.00                 | 0.00                | 0.00    |                    |

|                  |                             |                                     |                                      |
|------------------|-----------------------------|-------------------------------------|--------------------------------------|
| <b>Database:</b> | Rockies-R5000.1             | <b>Local Co-ordinate Reference:</b> | Well CC 697-08-52A - Slot S          |
| <b>Company:</b>  | OXY USA RMAT                | <b>TVD Reference:</b>               | GL 8411' & RKB 30' @ 8441.00ft (H&P) |
| <b>Project:</b>  | Garfield County, CO NAD27   | <b>MD Reference:</b>                | GL 8411' & RKB 30' @ 8441.00ft (H&P) |
| <b>Site:</b>     | Cascade Creek 697-08-53 Pad | <b>North Reference:</b>             | True                                 |
| <b>Well:</b>     | CC 697-08-52A               | <b>Survey Calculation Method:</b>   | Minimum Curvature                    |
| <b>Wellbore:</b> | OH                          |                                     |                                      |
| <b>Design:</b>   | Plan #1                     |                                     |                                      |

| Planned Survey                          |                 |             |                     |            |            |                       |                       |                      |                     |
|---|-----------------|-------------|---------------------|------------|------------|-----------------------|-----------------------|----------------------|---------------------|
| Measured Depth (ft)                     | Inclination (°) | Azimuth (°) | Vertical Depth (ft) | +N/-S (ft) | +E/-W (ft) | Vertical Section (ft) | Dogleg Rate (°/100ft) | Build Rate (°/100ft) | Turn Rate (°/100ft) |
| 0.00                                    | 0.00            | 0.00        | 0.00                | 0.00       | 0.00       | 0.00                  | 0.00                  | 0.00                 | 0.00                |
| 100.00                                  | 0.00            | 0.00        | 100.00              | 0.00       | 0.00       | 0.00                  | 0.00                  | 0.00                 | 0.00                |
| 200.00                                  | 0.00            | 0.00        | 200.00              | 0.00       | 0.00       | 0.00                  | 0.00                  | 0.00                 | 0.00                |
| 300.00                                  | 0.00            | 0.00        | 300.00              | 0.00       | 0.00       | 0.00                  | 0.00                  | 0.00                 | 0.00                |
| <b>Start Build 1.00</b>                 |                 |             |                     |            |            |                       |                       |                      |                     |
| 400.00                                  | 1.00            | 257.80      | 399.99              | -0.18      | -0.85      | 0.87                  | 1.00                  | 1.00                 | 0.00                |
| 500.00                                  | 2.00            | 257.80      | 499.96              | -0.74      | -3.41      | 3.49                  | 1.00                  | 1.00                 | 0.00                |
| 600.00                                  | 3.00            | 257.80      | 599.86              | -1.66      | -7.67      | 7.85                  | 1.00                  | 1.00                 | 0.00                |
| 700.00                                  | 4.00            | 257.80      | 699.68              | -2.95      | -13.64     | 13.96                 | 1.00                  | 1.00                 | 0.00                |
| 800.00                                  | 5.00            | 257.80      | 799.37              | -4.61      | -21.31     | 21.80                 | 1.00                  | 1.00                 | 0.00                |
| 900.00                                  | 6.00            | 257.80      | 898.90              | -6.63      | -30.68     | 31.39                 | 1.00                  | 1.00                 | 0.00                |
| 1,000.00                                | 7.00            | 257.80      | 998.26              | -9.02      | -41.74     | 42.71                 | 1.00                  | 1.00                 | 0.00                |
| 1,100.00                                | 8.00            | 257.80      | 1,097.40            | -11.78     | -54.50     | 55.76                 | 1.00                  | 1.00                 | 0.00                |
| 1,200.00                                | 9.00            | 257.80      | 1,196.30            | -14.90     | -68.95     | 70.54                 | 1.00                  | 1.00                 | 0.00                |
| 1,300.00                                | 10.00           | 257.80      | 1,294.93            | -18.39     | -85.08     | 87.05                 | 1.00                  | 1.00                 | 0.00                |
| 1,400.00                                | 11.00           | 257.80      | 1,393.26            | -22.24     | -102.89    | 105.27                | 1.00                  | 1.00                 | 0.00                |
| 1,500.00                                | 12.00           | 257.80      | 1,491.25            | -26.45     | -122.38    | 125.21                | 1.00                  | 1.00                 | 0.00                |
| 1,600.00                                | 13.00           | 257.80      | 1,588.87            | -31.02     | -143.53    | 146.85                | 1.00                  | 1.00                 | 0.00                |
| 1,678.69                                | 13.79           | 257.80      | 1,665.42            | -34.87     | -161.35    | 165.07                | 1.00                  | 1.00                 | 0.00                |
| <b>Start 13.79° Hold At 1678.69' MD</b> |                 |             |                     |            |            |                       |                       |                      |                     |
| 1,700.00                                | 13.79           | 257.80      | 1,686.12            | -35.95     | -166.31    | 170.15                | 0.00                  | 0.00                 | 0.00                |
| 1,800.00                                | 13.79           | 257.80      | 1,783.24            | -40.98     | -189.61    | 193.99                | 0.00                  | 0.00                 | 0.00                |
| 1,900.00                                | 13.79           | 257.80      | 1,880.36            | -46.02     | -212.90    | 217.82                | 0.00                  | 0.00                 | 0.00                |
| 2,000.00                                | 13.79           | 257.80      | 1,977.48            | -51.05     | -236.19    | 241.65                | 0.00                  | 0.00                 | 0.00                |
| 2,100.00                                | 13.79           | 257.80      | 2,074.60            | -56.08     | -259.49    | 265.48                | 0.00                  | 0.00                 | 0.00                |
| 2,200.00                                | 13.79           | 257.80      | 2,171.71            | -61.12     | -282.78    | 289.31                | 0.00                  | 0.00                 | 0.00                |
| 2,300.00                                | 13.79           | 257.80      | 2,268.83            | -66.15     | -306.07    | 313.14                | 0.00                  | 0.00                 | 0.00                |
| 2,400.00                                | 13.79           | 257.80      | 2,365.95            | -71.19     | -329.37    | 336.97                | 0.00                  | 0.00                 | 0.00                |
| 2,500.00                                | 13.79           | 257.80      | 2,463.07            | -76.22     | -352.66    | 360.80                | 0.00                  | 0.00                 | 0.00                |
| 2,600.00                                | 13.79           | 257.80      | 2,560.19            | -81.26     | -375.95    | 384.63                | 0.00                  | 0.00                 | 0.00                |
| 2,700.00                                | 13.79           | 257.80      | 2,657.31            | -86.29     | -399.25    | 408.47                | 0.00                  | 0.00                 | 0.00                |
| 2,800.00                                | 13.79           | 257.80      | 2,754.43            | -91.33     | -422.54    | 432.30                | 0.00                  | 0.00                 | 0.00                |
| 2,900.00                                | 13.79           | 257.80      | 2,851.55            | -96.36     | -445.83    | 456.13                | 0.00                  | 0.00                 | 0.00                |
| 3,000.00                                | 13.79           | 257.80      | 2,948.67            | -101.40    | -469.13    | 479.96                | 0.00                  | 0.00                 | 0.00                |
| 3,100.00                                | 13.79           | 257.80      | 3,045.78            | -106.43    | -492.42    | 503.79                | 0.00                  | 0.00                 | 0.00                |
| 3,200.00                                | 13.79           | 257.80      | 3,142.90            | -111.46    | -515.71    | 527.62                | 0.00                  | 0.00                 | 0.00                |
| 3,300.00                                | 13.79           | 257.80      | 3,240.02            | -116.50    | -539.01    | 551.45                | 0.00                  | 0.00                 | 0.00                |
| 3,400.00                                | 13.79           | 257.80      | 3,337.14            | -121.53    | -562.30    | 575.28                | 0.00                  | 0.00                 | 0.00                |
| 3,500.00                                | 13.79           | 257.80      | 3,434.26            | -126.57    | -585.59    | 599.11                | 0.00                  | 0.00                 | 0.00                |
| 3,600.00                                | 13.79           | 257.80      | 3,531.38            | -131.60    | -608.88    | 622.94                | 0.00                  | 0.00                 | 0.00                |
| 3,700.00                                | 13.79           | 257.80      | 3,628.50            | -136.64    | -632.18    | 646.78                | 0.00                  | 0.00                 | 0.00                |
| 3,800.00                                | 13.79           | 257.80      | 3,725.62            | -141.67    | -655.47    | 670.61                | 0.00                  | 0.00                 | 0.00                |
| 3,900.00                                | 13.79           | 257.80      | 3,822.74            | -146.71    | -678.76    | 694.44                | 0.00                  | 0.00                 | 0.00                |
| 4,000.00                                | 13.79           | 257.80      | 3,919.85            | -151.74    | -702.06    | 718.27                | 0.00                  | 0.00                 | 0.00                |
| 4,100.00                                | 13.79           | 257.80      | 4,016.97            | -156.77    | -725.35    | 742.10                | 0.00                  | 0.00                 | 0.00                |
| 4,200.00                                | 13.79           | 257.80      | 4,114.09            | -161.81    | -748.64    | 765.93                | 0.00                  | 0.00                 | 0.00                |
| 4,300.00                                | 13.79           | 257.80      | 4,211.21            | -166.84    | -771.94    | 789.76                | 0.00                  | 0.00                 | 0.00                |
| 4,400.00                                | 13.79           | 257.80      | 4,308.33            | -171.88    | -795.23    | 813.59                | 0.00                  | 0.00                 | 0.00                |
| 4,500.00                                | 13.79           | 257.80      | 4,405.45            | -176.91    | -818.52    | 837.42                | 0.00                  | 0.00                 | 0.00                |
| 4,600.00                                | 13.79           | 257.80      | 4,502.57            | -181.95    | -841.82    | 861.26                | 0.00                  | 0.00                 | 0.00                |
| 4,700.00                                | 13.79           | 257.80      | 4,599.69            | -186.98    | -865.11    | 885.09                | 0.00                  | 0.00                 | 0.00                |
| 4,800.00                                | 13.79           | 257.80      | 4,696.81            | -192.02    | -888.40    | 908.92                | 0.00                  | 0.00                 | 0.00                |
| 4,900.00                                | 13.79           | 257.80      | 4,793.92            | -197.05    | -911.70    | 932.75                | 0.00                  | 0.00                 | 0.00                |
| 5,000.00                                | 13.79           | 257.80      | 4,891.04            | -202.09    | -934.99    | 956.58                | 0.00                  | 0.00                 | 0.00                |

|                  |                             |                                     |                                      |
|------------------|-----------------------------|-------------------------------------|--------------------------------------|
| <b>Database:</b> | Rockies-R5000.1             | <b>Local Co-ordinate Reference:</b> | Well CC 697-08-52A - Slot S          |
| <b>Company:</b>  | OXY USA RMAT                | <b>TVD Reference:</b>               | GL 8411' & RKB 30' @ 8441.00ft (H&P) |
| <b>Project:</b>  | Garfield County, CO NAD27   | <b>MD Reference:</b>                | GL 8411' & RKB 30' @ 8441.00ft (H&P) |
| <b>Site:</b>     | Cascade Creek 697-08-53 Pad | <b>North Reference:</b>             | True                                 |
| <b>Well:</b>     | CC 697-08-52A               | <b>Survey Calculation Method:</b>   | Minimum Curvature                    |
| <b>Wellbore:</b> | OH                          |                                     |                                      |
| <b>Design:</b>   | Plan #1                     |                                     |                                      |

| Planned Survey                                     |                 |             |                     |            |            |                       |                       |                      |                     |
|--|-----------------|-------------|---------------------|------------|------------|-----------------------|-----------------------|----------------------|---------------------|
| Measured Depth (ft)                                | Inclination (°) | Azimuth (°) | Vertical Depth (ft) | +N/-S (ft) | +E/-W (ft) | Vertical Section (ft) | Dogleg Rate (°/100ft) | Build Rate (°/100ft) | Turn Rate (°/100ft) |
| 5,100.00   | 13.79           | 257.80      | 4,988.16            | -207.12    | -958.28    | 980.41                | 0.00                  | 0.00                 | 0.00                |
| 5,200.00   | 13.79           | 257.80      | 5,085.28            | -212.15    | -981.58    | 1,004.24              | 0.00                  | 0.00                 | 0.00                |
| 5,300.00   | 13.79           | 257.80      | 5,182.40            | -217.19    | -1,004.87  | 1,028.07              | 0.00                  | 0.00                 | 0.00                |
| 5,308.12   | 13.79           | 257.80      | 5,190.29            | -217.60    | -1,006.76  | 1,030.01              | 0.00                  | 0.00                 | 0.00                |
| <b>Start Drop -2.00</b>                            |                 |             |                     |            |            |                       |                       |                      |                     |
| 5,400.00   | 11.95           | 257.80      | 5,279.86            | -221.92    | -1,026.76  | 1,050.47              | 2.00                  | -2.00                | 0.00                |
| 5,500.00   | 9.95            | 257.80      | 5,378.03            | -225.93    | -1,045.32  | 1,069.46              | 2.00                  | -2.00                | 0.00                |
| 5,600.00   | 7.95            | 257.80      | 5,476.81            | -229.22    | -1,060.53  | 1,085.02              | 2.00                  | -2.00                | 0.00                |
| 5,700.00   | 5.95            | 257.80      | 5,576.07            | -231.78    | -1,072.35  | 1,097.12              | 2.00                  | -2.00                | 0.00                |
| 5,800.00   | 3.95            | 257.80      | 5,675.69            | -233.60    | -1,080.79  | 1,105.74              | 2.00                  | -2.00                | 0.00                |
| 5,900.00   | 1.95            | 257.80      | 5,775.55            | -234.68    | -1,085.82  | 1,110.89              | 2.00                  | -2.00                | 0.00                |
| 5,997.47   | 0.00            | 0.00        | 5,873.00            | -235.03    | -1,087.44  | 1,112.55              | 2.00                  | -2.00                | 104.85              |
| <b>Start 0.00° Hold At 5997.47' MD - Mesaverde</b> |                 |             |                     |            |            |                       |                       |                      |                     |
| 6,000.00   | 0.00            | 0.00        | 5,875.53            | -235.03    | -1,087.44  | 1,112.55              | 0.00                  | 0.00                 | 0.00                |
| 6,100.00   | 0.00            | 0.00        | 5,975.53            | -235.03    | -1,087.44  | 1,112.55              | 0.00                  | 0.00                 | 0.00                |
| 6,135.47   | 0.00            | 0.00        | 6,011.00            | -235.03    | -1,087.44  | 1,112.55              | 0.00                  | 0.00                 | 0.00                |
| <b>Base Ohio Creek</b>                             |                 |             |                     |            |            |                       |                       |                      |                     |
| 6,200.00   | 0.00            | 0.00        | 6,075.53            | -235.03    | -1,087.44  | 1,112.55              | 0.00                  | 0.00                 | 0.00                |
| 6,300.00   | 0.00            | 0.00        | 6,175.53            | -235.03    | -1,087.44  | 1,112.55              | 0.00                  | 0.00                 | 0.00                |
| 6,400.00   | 0.00            | 0.00        | 6,275.53            | -235.03    | -1,087.44  | 1,112.55              | 0.00                  | 0.00                 | 0.00                |
| 6,500.00   | 0.00            | 0.00        | 6,375.53            | -235.03    | -1,087.44  | 1,112.55              | 0.00                  | 0.00                 | 0.00                |
| 6,600.00   | 0.00            | 0.00        | 6,475.53            | -235.03    | -1,087.44  | 1,112.55              | 0.00                  | 0.00                 | 0.00                |
| 6,700.00   | 0.00            | 0.00        | 6,575.53            | -235.03    | -1,087.44  | 1,112.55              | 0.00                  | 0.00                 | 0.00                |
| 6,800.00   | 0.00            | 0.00        | 6,675.53            | -235.03    | -1,087.44  | 1,112.55              | 0.00                  | 0.00                 | 0.00                |
| 6,825.47   | 0.00            | 0.00        | 6,701.00            | -235.03    | -1,087.44  | 1,112.55              | 0.00                  | 0.00                 | 0.00                |
| <b>Top Gas</b>                                     |                 |             |                     |            |            |                       |                       |                      |                     |
| 6,900.00   | 0.00            | 0.00        | 6,775.53            | -235.03    | -1,087.44  | 1,112.55              | 0.00                  | 0.00                 | 0.00                |
| 7,000.00   | 0.00            | 0.00        | 6,875.53            | -235.03    | -1,087.44  | 1,112.55              | 0.00                  | 0.00                 | 0.00                |
| 7,100.00   | 0.00            | 0.00        | 6,975.53            | -235.03    | -1,087.44  | 1,112.55              | 0.00                  | 0.00                 | 0.00                |
| 7,200.00   | 0.00            | 0.00        | 7,075.53            | -235.03    | -1,087.44  | 1,112.55              | 0.00                  | 0.00                 | 0.00                |
| 7,300.00   | 0.00            | 0.00        | 7,175.53            | -235.03    | -1,087.44  | 1,112.55              | 0.00                  | 0.00                 | 0.00                |
| 7,400.00   | 0.00            | 0.00        | 7,275.53            | -235.03    | -1,087.44  | 1,112.55              | 0.00                  | 0.00                 | 0.00                |
| 7,500.00   | 0.00            | 0.00        | 7,375.53            | -235.03    | -1,087.44  | 1,112.55              | 0.00                  | 0.00                 | 0.00                |
| 7,600.00   | 0.00            | 0.00        | 7,475.53            | -235.03    | -1,087.44  | 1,112.55              | 0.00                  | 0.00                 | 0.00                |
| 7,700.00   | 0.00            | 0.00        | 7,575.53            | -235.03    | -1,087.44  | 1,112.55              | 0.00                  | 0.00                 | 0.00                |
| 7,800.00   | 0.00            | 0.00        | 7,675.53            | -235.03    | -1,087.44  | 1,112.55              | 0.00                  | 0.00                 | 0.00                |
| 7,900.00   | 0.00            | 0.00        | 7,775.53            | -235.03    | -1,087.44  | 1,112.55              | 0.00                  | 0.00                 | 0.00                |
| 8,000.00   | 0.00            | 0.00        | 7,875.53            | -235.03    | -1,087.44  | 1,112.55              | 0.00                  | 0.00                 | 0.00                |
| 8,018.47   | 0.00            | 0.00        | 7,894.00            | -235.03    | -1,087.44  | 1,112.55              | 0.00                  | 0.00                 | 0.00                |
| <b>Target = 630800.24, 1225850.31</b>              |                 |             |                     |            |            |                       |                       |                      |                     |
| 8,100.00   | 0.00            | 0.00        | 7,975.53            | -235.03    | -1,087.44  | 1,112.55              | 0.00                  | 0.00                 | 0.00                |
| 8,200.00   | 0.00            | 0.00        | 8,075.53            | -235.03    | -1,087.44  | 1,112.55              | 0.00                  | 0.00                 | 0.00                |
| 8,300.00   | 0.00            | 0.00        | 8,175.53            | -235.03    | -1,087.44  | 1,112.55              | 0.00                  | 0.00                 | 0.00                |
| 8,400.00   | 0.00            | 0.00        | 8,275.53            | -235.03    | -1,087.44  | 1,112.55              | 0.00                  | 0.00                 | 0.00                |
| 8,500.00   | 0.00            | 0.00        | 8,375.53            | -235.03    | -1,087.44  | 1,112.55              | 0.00                  | 0.00                 | 0.00                |
| 8,600.00   | 0.00            | 0.00        | 8,475.53            | -235.03    | -1,087.44  | 1,112.55              | 0.00                  | 0.00                 | 0.00                |
| 8,646.47   | 0.00            | 0.00        | 8,522.00            | -235.03    | -1,087.44  | 1,112.55              | 0.00                  | 0.00                 | 0.00                |
| <b>Rollins</b>                                     |                 |             |                     |            |            |                       |                       |                      |                     |
| 8,700.00   | 0.00            | 0.00        | 8,575.53            | -235.03    | -1,087.44  | 1,112.55              | 0.00                  | 0.00                 | 0.00                |
| 8,800.00   | 0.00            | 0.00        | 8,675.53            | -235.03    | -1,087.44  | 1,112.55              | 0.00                  | 0.00                 | 0.00                |
| 8,846.47   | 0.00            | 0.00        | 8,722.00            | -235.03    | -1,087.44  | 1,112.55              | 0.00                  | 0.00                 | 0.00                |
| <b>PBHL = 630800.24, 1225850.31</b>                |                 |             |                     |            |            |                       |                       |                      |                     |

|                  |                             |                                     |                                      |
|------------------|-----------------------------|-------------------------------------|--------------------------------------|
| <b>Database:</b> | Rockies-R5000.1             | <b>Local Co-ordinate Reference:</b> | Well CC 697-08-52A - Slot S          |
| <b>Company:</b>  | OXY USA RMAT                | <b>TVD Reference:</b>               | GL 8411' & RKB 30' @ 8441.00ft (H&P) |
| <b>Project:</b>  | Garfield County, CO NAD27   | <b>MD Reference:</b>                | GL 8411' & RKB 30' @ 8441.00ft (H&P) |
| <b>Site:</b>     | Cascade Creek 697-08-53 Pad | <b>North Reference:</b>             | True                                 |
| <b>Well:</b>     | CC 697-08-52A               | <b>Survey Calculation Method:</b>   | Minimum Curvature                    |
| <b>Wellbore:</b> | OH                          |                                     |                                      |
| <b>Design:</b>   | Plan #1                     |                                     |                                      |

| Design Targets            |           |          |          |         |           |            |              |                  |                   |
|---------------------------|-----------|----------|----------|---------|-----------|------------|--------------|------------------|-------------------|
| Target Name               | Dip Angle | Dip Dir. | TVD      | +N/-S   | +E/-W     | Northing   | Easting      | Latitude         | Longitude         |
| - hit/miss target         | (°)       | (°)      | (ft)     | (ft)    | (ft)      | (usft)     | (usft)       |                  |                   |
| - Shape                   |           |          |          |         |           |            |              |                  |                   |
| CC697-08-52A Target       | 0.00      | 0.00     | 7,894.00 | -235.03 | -1,087.44 | 630,800.24 | 1,225,850.31 | 39° 31' 59.710 N | 108° 14' 42.218 W |
| - plan hits target center |           |          |          |         |           |            |              |                  |                   |
| - Circle (radius 50.00)   |           |          |          |         |           |            |              |                  |                   |

| Formations     |                |                 |           |      |               |
|----------------|----------------|-----------------|-----------|------|---------------|
| Measured Depth | Vertical Depth | Name            | Lithology | Dip  | Dip Direction |
| (ft)           | (ft)           |                 |           | (°)  | (°)           |
| 5,997.47       | 5,873.00       | Mesaverde       |           | 0.00 |               |
| 6,135.47       | 6,011.00       | Base Ohio Creek |           | 0.00 |               |
| 6,825.47       | 6,701.00       | Top Gas         |           | 0.00 |               |
| 8,646.47       | 8,522.00       | Rollins         |           | 0.00 |               |

| Plan Annotations |                |                   |            |                                  |
|------------------|----------------|-------------------|------------|----------------------------------|
| Measured Depth   | Vertical Depth | Local Coordinates |            | Comment                          |
| (ft)             | (ft)           | +N/-S (ft)        | +E/-W (ft) |                                  |
| 300.00           | 300.00         | 0.00              | 0.00       | Start Build 1.00                 |
| 1,678.69         | 1,665.42       | -34.87            | -161.35    | Start 13.79° Hold At 1678.69' MD |
| 5,308.12         | 5,190.29       | -217.60           | -1,006.76  | Start Drop -2.00                 |
| 5,997.47         | 5,873.00       | -235.03           | -1,087.44  | Start 0.00° Hold At 5997.47' MD  |
| 8,018.47         | 7,894.00       | -235.03           | -1,087.44  | Target = 630800.24, 1225850.31   |
| 8,846.47         | 8,722.00       | -235.03           | -1,087.44  | PBHL = 630800.24, 1225850.31     |