

EOG RESOURCES, INC.
CRITTER CREEK #15-19H
LOCATED IN WELD COUNTY, COLORADO
SECTION 19, T11N, R63W, 6th P.M.

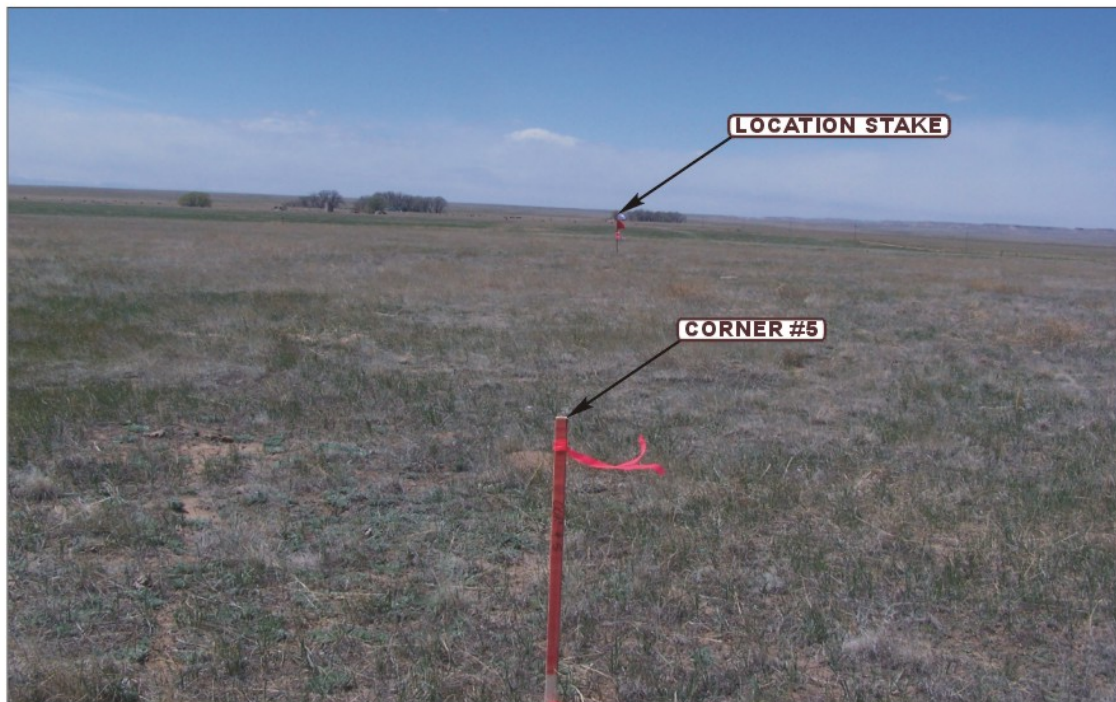

PHOTO: VIEW FROM CORNER #5 TO LOCATION STAKE

CAMERA ANGLE: WESTERLY



PHOTO: VIEW FROM BEGINNING OF PROPOSED ACCESS

CAMERA ANGLE: SOUTHERLY



Uintah Engineering & Land Surveying
85 South 200 East Vernal, Utah 84078
435-789-1017 FAX (435) 789-1813

**LOCATION
PHOTOS**

05 13 10
MONTH DAY YEAR

PHOTO
P 1

TAKEN BY: B.H. DRAWN BY: Z.L. REVISED: 00-00-00

EOG RESOURCES, INC.
CRITTER CREEK #15-19H
LOCATED IN WELD COUNTY, COLORADO
SECTION 19, T11N, R63W, 6th P.M.

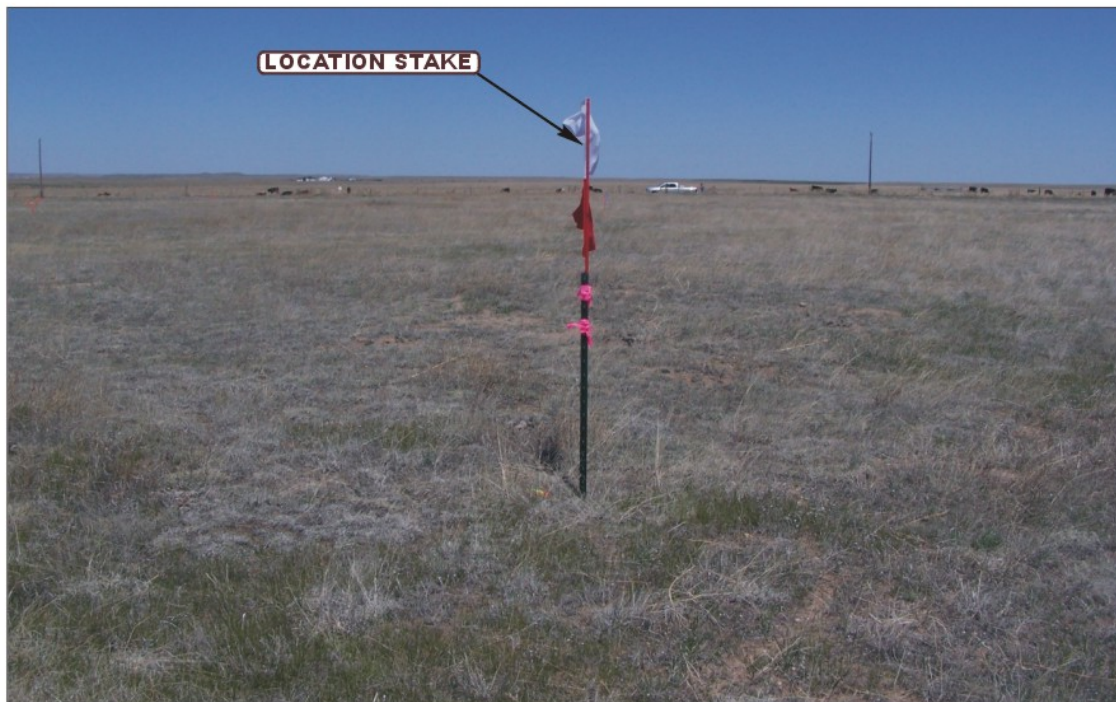

PHOTO: VIEW OF LOCATION STAKE

CAMERA ANGLE: NORTHERLY



PHOTO: VIEW OF LOCATION STAKE

CAMERA ANGLE: EASTERLY



Uintah Engineering & Land Surveying
85 South 200 East Vernal, Utah 84078
435-789-1017 FAX (435) 789-1813

**LOCATION
PHOTOS**

05 13 10
MONTH DAY YEAR

PHOTO
P 2

TAKEN BY: B.H. DRAWN BY: Z.L. REVISED: 00-00-00

EOG RESOURCES, INC.
CRITTER CREEK #15-19H
LOCATED IN WELD COUNTY, COLORADO
SECTION 19, T11N, R63W, 6th P.M.



PHOTO: VIEW OF LOCATION STAKE

CAMERA ANGLE: SOUTHERLY



PHOTO: VIEW OF LOCATION STAKE

CAMERA ANGLE: WESTERLY



- Since 1964 -



Uintah Engineering & Land Surveying
85 South 200 East Vernal, Utah 84078
435-789-1017 FAX (435) 789-1813

**LOCATION
PHOTOS**

05 13 10
MONTH DAY YEAR

**PHOTO
P 3**

TAKEN BY: B.H.

DRAWN BY: Z.L.

REVISED: 00-00-00