

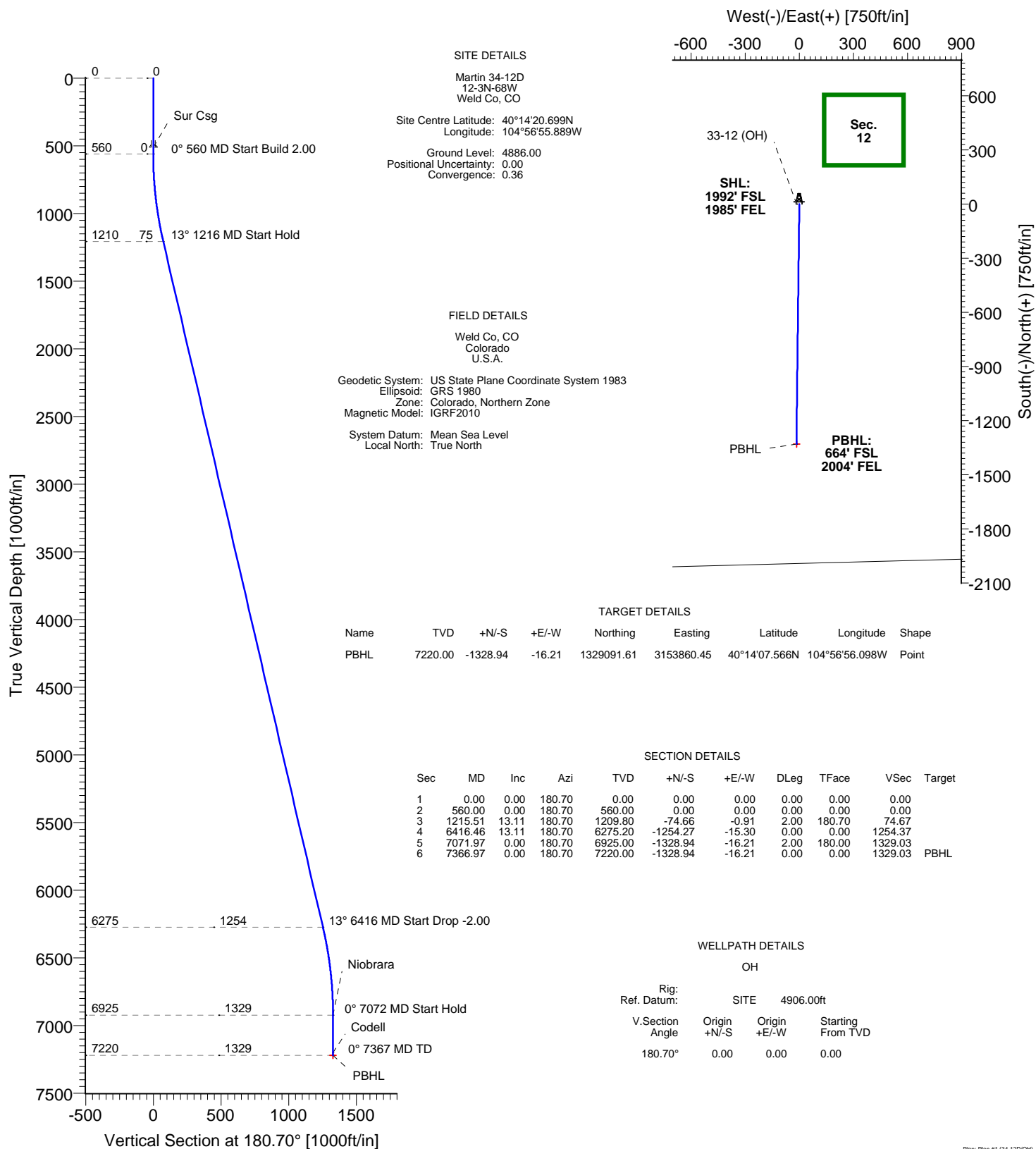

Apollo Operating, LLC.

Field: Weld Co, CO
Site: Martin 34-12D
Well: 34-12D
Wellpath: OH
Plan: Plan #1

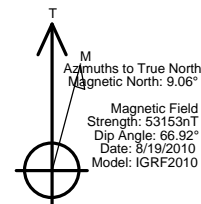



Ryan Energy Technologies

Planning Report



Company: Apollo Operating, LLC.	Date: 8/19/2010	Time: 11:22:59	Page: 1
Field: Weld Co, CO	Co-ordinate(NE) Reference: Site: Martin 34-12D, True North		
Site: Martin 34-12D	Vertical (TVD) Reference: SITE 4906.0		
Well: 34-12D	Section (VS) Reference: Well (0.00N,0.00E,180.70Azi)		
Wellpath: OH	Plan: Plan #1		

Field: Weld Co, CO Colorado U.S.A.	Map Zone: Colorado, Northern Zone
Map System: US State Plane Coordinate System 1983	Coordinate System: Site Centre
Geo Datum: GRS 1980	Geomagnetic Model: IGRF2010
Sys Datum: Mean Sea Level	

Site: Martin 34-12D 12-3N-68W Weld Co, CO	Site Position:	Northing: 1330420.62 ft	Latitude: 40 14 20.699 N
From: Geographic		Easting: 3153868.40 ft	Longitude: 104 56 55.889 W
Position Uncertainty: 0.00 ft			North Reference: True
Ground Level: 4886.00 ft			Grid Convergence: 0.36 deg

Well: 34-12D	Slot Name:
Well Position: +N/-S 0.00 ft	Latitude: 40 14 20.699 N
+E/-W 0.00 ft	Longitude: 104 56 55.889 W
Position Uncertainty: 0.00 ft	

Wellpath: OH	Drilled From: Surface
Current Datum: SITE	Tie-on Depth: 0.00 ft
Magnetic Data: 8/19/2010	Above System Datum: Mean Sea Level
Field Strength: 53153 nT	Declination: 9.06 deg
Vertical Section: Depth From (TVD)	Mag Dip Angle: 66.92 deg
ft	+N/-S
	+E/-W
	Direction
	deg
0.00	180.70

Plan: Plan #1	Date Composed: 8/19/2010
Principal: Yes	Version: 1
	Tied-to: From Surface

Plan Section Information

MD ft	Incl deg	Azim deg	TVD ft	+N/-S ft	+E/-W ft	DLS deg/100ft	Build deg/100ft	Turn deg/100ft	TFO deg	Target
0.00	0.00	180.70	0.00	0.00	0.00	0.00	0.00	0.00	0.00	
560.00	0.00	180.70	560.00	0.00	0.00	0.00	0.00	0.00	0.00	
1215.51	13.11	180.70	1209.80	-74.66	-0.91	2.00	2.00	0.00	180.70	
6416.46	13.11	180.70	6275.20	-1254.27	-15.30	0.00	0.00	0.00	0.00	
7071.97	0.00	180.70	6925.00	-1328.94	-16.21	2.00	-2.00	0.00	180.00	
7366.97	0.00	180.70	7220.00	-1328.94	-16.21	0.00	0.00	0.00	0.00	PBHL

Survey

MD ft	Incl deg	Azim deg	TVD ft	+N/-S ft	+E/-W ft	VS ft	DLS deg/100ft	Build deg/100ft	Turn deg/100ft	Tool/Comment
560.00	0.00	180.70	560.00	0.00	0.00	0.00	0.00	0.00	0.00	
600.00	0.80	180.70	600.00	-0.28	0.00	0.28	2.00	2.00	0.00	
700.00	2.80	180.70	699.94	-3.42	-0.04	3.42	2.00	2.00	0.00	
800.00	4.80	180.70	799.72	-10.05	-0.12	10.05	2.00	2.00	0.00	
900.00	6.80	180.70	899.20	-20.15	-0.25	20.15	2.00	2.00	0.00	
1000.00	8.80	180.70	998.27	-33.72	-0.41	33.72	2.00	2.00	0.00	
1100.00	10.80	180.70	1096.81	-50.74	-0.62	50.74	2.00	2.00	0.00	
1200.00	12.80	180.70	1194.69	-71.19	-0.87	71.19	2.00	2.00	0.00	
1215.51	13.11	180.70	1209.80	-74.66	-0.91	74.67	2.00	2.00	0.00	
1300.00	13.11	180.70	1292.09	-93.83	-1.14	93.83	0.00	0.00	0.00	
1400.00	13.11	180.70	1389.49	-116.51	-1.42	116.52	0.00	0.00	0.00	
1500.00	13.11	180.70	1486.88	-139.19	-1.70	139.20	0.00	0.00	0.00	
1600.00	13.11	180.70	1584.27	-161.87	-1.97	161.88	0.00	0.00	0.00	
1700.00	13.11	180.70	1681.67	-184.55	-2.25	184.56	0.00	0.00	0.00	
1800.00	13.11	180.70	1779.06	-207.23	-2.53	207.25	0.00	0.00	0.00	

Company: Apollo Operating, LLC.
Field: Weld Co, CO
Site: Martin 34-12D
Well: 34-12D
Wellpath: OH

Date: 8/19/2010
Co-ordinate(NE) Reference: Site: Martin 34-12D, True North
Vertical (TVD) Reference: SITE 4906.0
Section (VS) Reference: Well (0.00N,0.00E,180.70Azi)
Plan: Plan #1

Page: 2

Survey

MD ft	Incl deg	Azim deg	TVD ft	+N/-S ft	+E/-W ft	VS ft	DLS deg/100ft	Build deg/100ft	Turn deg/100ft	Tool/Comment
1900.00	13.11	180.70	1876.45	-229.91	-2.80	229.93	0.00	0.00	0.00	
2000.00	13.11	180.70	1973.85	-252.59	-3.08	252.61	0.00	0.00	0.00	
2100.00	13.11	180.70	2071.24	-275.27	-3.36	275.29	0.00	0.00	0.00	
2200.00	13.11	180.70	2168.64	-297.95	-3.63	297.97	0.00	0.00	0.00	
2300.00	13.11	180.70	2266.03	-320.63	-3.91	320.66	0.00	0.00	0.00	
2400.00	13.11	180.70	2363.42	-343.31	-4.19	343.34	0.00	0.00	0.00	
2500.00	13.11	180.70	2460.82	-365.99	-4.46	366.02	0.00	0.00	0.00	
2600.00	13.11	180.70	2558.21	-388.67	-4.74	388.70	0.00	0.00	0.00	
2700.00	13.11	180.70	2655.60	-411.36	-5.02	411.39	0.00	0.00	0.00	
2800.00	13.11	180.70	2753.00	-434.04	-5.29	434.07	0.00	0.00	0.00	
2900.00	13.11	180.70	2850.39	-456.72	-5.57	456.75	0.00	0.00	0.00	
3000.00	13.11	180.70	2947.78	-479.40	-5.85	479.43	0.00	0.00	0.00	
3100.00	13.11	180.70	3045.18	-502.08	-6.12	502.12	0.00	0.00	0.00	
3200.00	13.11	180.70	3142.57	-524.76	-6.40	524.80	0.00	0.00	0.00	
3300.00	13.11	180.70	3239.96	-547.44	-6.68	547.48	0.00	0.00	0.00	
3400.00	13.11	180.70	3337.36	-570.12	-6.95	570.16	0.00	0.00	0.00	
3500.00	13.11	180.70	3434.75	-592.80	-7.23	592.84	0.00	0.00	0.00	
3600.00	13.11	180.70	3532.15	-615.48	-7.51	615.53	0.00	0.00	0.00	
3700.00	13.11	180.70	3629.54	-638.16	-7.78	638.21	0.00	0.00	0.00	
3800.00	13.11	180.70	3726.93	-660.84	-8.06	660.89	0.00	0.00	0.00	
3900.00	13.11	180.70	3824.33	-683.52	-8.34	683.57	0.00	0.00	0.00	
4000.00	13.11	180.70	3921.72	-706.20	-8.61	706.26	0.00	0.00	0.00	
4100.00	13.11	180.70	4019.11	-728.88	-8.89	728.94	0.00	0.00	0.00	
4200.00	13.11	180.70	4116.51	-751.57	-9.17	751.62	0.00	0.00	0.00	
4300.00	13.11	180.70	4213.90	-774.25	-9.44	774.30	0.00	0.00	0.00	
4400.00	13.11	180.70	4311.29	-796.93	-9.72	796.99	0.00	0.00	0.00	
4500.00	13.11	180.70	4408.69	-819.61	-10.00	819.67	0.00	0.00	0.00	
4600.00	13.11	180.70	4506.08	-842.29	-10.27	842.35	0.00	0.00	0.00	
4700.00	13.11	180.70	4603.47	-864.97	-10.55	865.03	0.00	0.00	0.00	
4800.00	13.11	180.70	4700.87	-887.65	-10.83	887.72	0.00	0.00	0.00	
4900.00	13.11	180.70	4798.26	-910.33	-11.10	910.40	0.00	0.00	0.00	
5000.00	13.11	180.70	4895.66	-933.01	-11.38	933.08	0.00	0.00	0.00	
5100.00	13.11	180.70	4993.05	-955.69	-11.66	955.76	0.00	0.00	0.00	
5200.00	13.11	180.70	5090.44	-978.37	-11.93	978.44	0.00	0.00	0.00	
5300.00	13.11	180.70	5187.84	-1001.05	-12.21	1001.13	0.00	0.00	0.00	
5400.00	13.11	180.70	5285.23	-1023.73	-12.49	1023.81	0.00	0.00	0.00	
5500.00	13.11	180.70	5382.62	-1046.41	-12.76	1046.49	0.00	0.00	0.00	
5600.00	13.11	180.70	5480.02	-1069.09	-13.04	1069.17	0.00	0.00	0.00	
5700.00	13.11	180.70	5577.41	-1091.78	-13.32	1091.86	0.00	0.00	0.00	
5800.00	13.11	180.70	5674.80	-1114.46	-13.59	1114.54	0.00	0.00	0.00	
5900.00	13.11	180.70	5772.20	-1137.14	-13.87	1137.22	0.00	0.00	0.00	
6000.00	13.11	180.70	5869.59	-1159.82	-14.15	1159.90	0.00	0.00	0.00	
6100.00	13.11	180.70	5966.99	-1182.50	-14.42	1182.59	0.00	0.00	0.00	
6200.00	13.11	180.70	6064.38	-1205.18	-14.70	1205.27	0.00	0.00	0.00	
6300.00	13.11	180.70	6161.77	-1227.86	-14.98	1227.95	0.00	0.00	0.00	
6400.00	13.11	180.70	6259.17	-1250.54	-15.25	1250.63	0.00	0.00	0.00	
6416.46	13.11	180.70	6275.20	-1254.27	-15.30	1254.37	0.00	0.00	0.00	
6500.00	11.44	180.70	6356.82	-1272.03	-15.51	1272.13	2.00	-2.00	0.00	
6600.00	9.44	180.70	6455.16	-1290.15	-15.74	1290.24	2.00	-2.00	0.00	
6700.00	7.44	180.70	6554.08	-1304.82	-15.91	1304.92	2.00	-2.00	0.00	
6800.00	5.44	180.70	6653.44	-1316.04	-16.05	1316.13	2.00	-2.00	0.00	
6900.00	3.44	180.70	6753.14	-1323.78	-16.15	1323.87	2.00	-2.00	0.00	
7000.00	1.44	180.70	6853.04	-1328.03	-16.20	1328.13	2.00	-2.00	0.00	
7071.97	0.00	180.70	6925.00	-1328.94	-16.21	1329.03	2.00	-2.00	0.00	Niobrara

Company: Apollo Operating, LLC. Field: Weld Co, CO Site: Martin 34-12D Well: 34-12D Wellpath: OH	Date: 8/19/2010 Co-ordinate(NE) Reference: Vertical (TVD) Reference: Section (VS) Reference: Plan:	Time: 11:22:59 Site: Martin 34-12D, True North SITE 4906.0 Well (0.00N,0.00E,180.70Azi) Plan #1	Page: 3
---	---	--	----------------

Survey

MD ft	Incl deg	Azim deg	TVD ft	+N/-S ft	+E/-W ft	VS ft	DLS deg/100ft	Build deg/100ft	Turn deg/100ft	Tool/Comment
7100.00	0.00	180.70	6953.03	-1328.94	-16.21	1329.03	0.00	0.00	0.00	
7200.00	0.00	180.70	7053.03	-1328.94	-16.21	1329.03	0.00	0.00	0.00	
7300.00	0.00	180.70	7153.03	-1328.94	-16.21	1329.03	0.00	0.00	0.00	
7346.97	0.00	180.70	7200.00	-1328.94	-16.21	1329.03	0.00	0.00	0.00	Codell
7366.97	0.00	180.70	7220.00	-1328.94	-16.21	1329.03	0.00	0.00	0.00	PBHL

Targets

Name	Description	Dir.	TVD ft	+N/-S ft	+E/-W ft	Map Northing ft	Map Easting ft	<--- Latitude ---> Deg Min Sec			<--- Longitude ---> Deg Min Sec				
PBHL	-Plan hit target		7220.00	-1328.94	-16.21	1329091.61	3153860.45	40	14	7.566	N	104	56	56.098	W

Casing Points

MD ft	TVD ft	Diameter in	Hole Size in	Name
510.00	510.00	0.000	0.000	Sur Csg

Formations

MD ft	TVD ft	Formations	Lithology	Dip Angle deg	Dip Direction deg
7071.97	6925.00	Niobrara		0.00	0.00
7346.97	7200.00	Codell		0.00	0.00