

VISIBLE IMPROVEMENTS

THIS MAP DOES NOT REPRESENT A BOUNDARY SURVEY

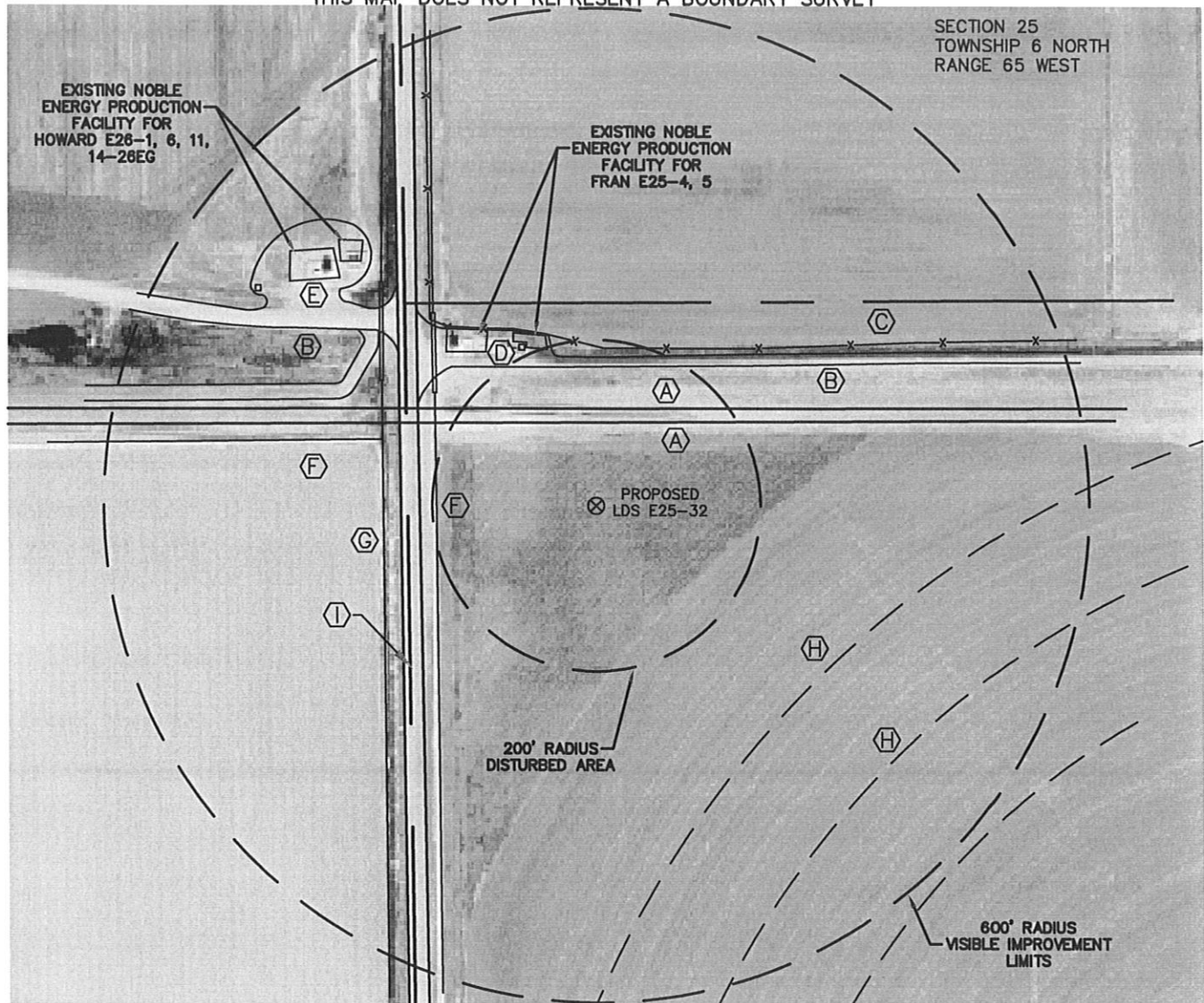

IMPROVEMENTS:

- (A) BURIED GAS LINES - 101' & 116' NORTH
- (B) GRAVEL ROADS - 168' NORTH AND 349' NORTHWEST
- (C) BARBED WIRE FENCE - 190' NORTH
- (D) NOBLE ENERGY PRODUCTION FACILITY FOR FRAN WELLS - 198' NORTHWEST
- (E) NOBLE ENERGY PRODUCTION FACILITY FOR HOWARD WELLS - 424' NORTHWEST
- (F) CONCRETE DITCHES - 195' & 271' WEST
- (G) CREEK/DITCH - 261' WEST
- (H) IRRIGATION WHEEL TRACKS - 338' & 473' SOUTHEAST
- (I) PAVED COUNTY ROAD NO. 47 - 215' WEST

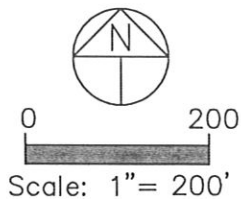

NOTICE: According to Colorado law you MUST commence any legal action based upon any defect in this W.L.C. within three years after you first discover such defect. In no event may any action based upon any defect in this W.L.C. be commenced more than ten years from this sold date of the certification shown hereon.

THE NEAREST OVERHEAD POWER LINE IS 800'+/- SOUTH