

SCHLEPP #32-08 4S-42W

REFERENCE AREA MAP

YUMA COUNTY, COLORADO
MARCH 26, 2010

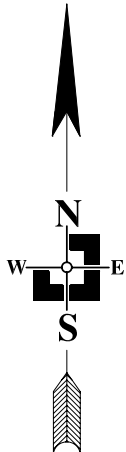
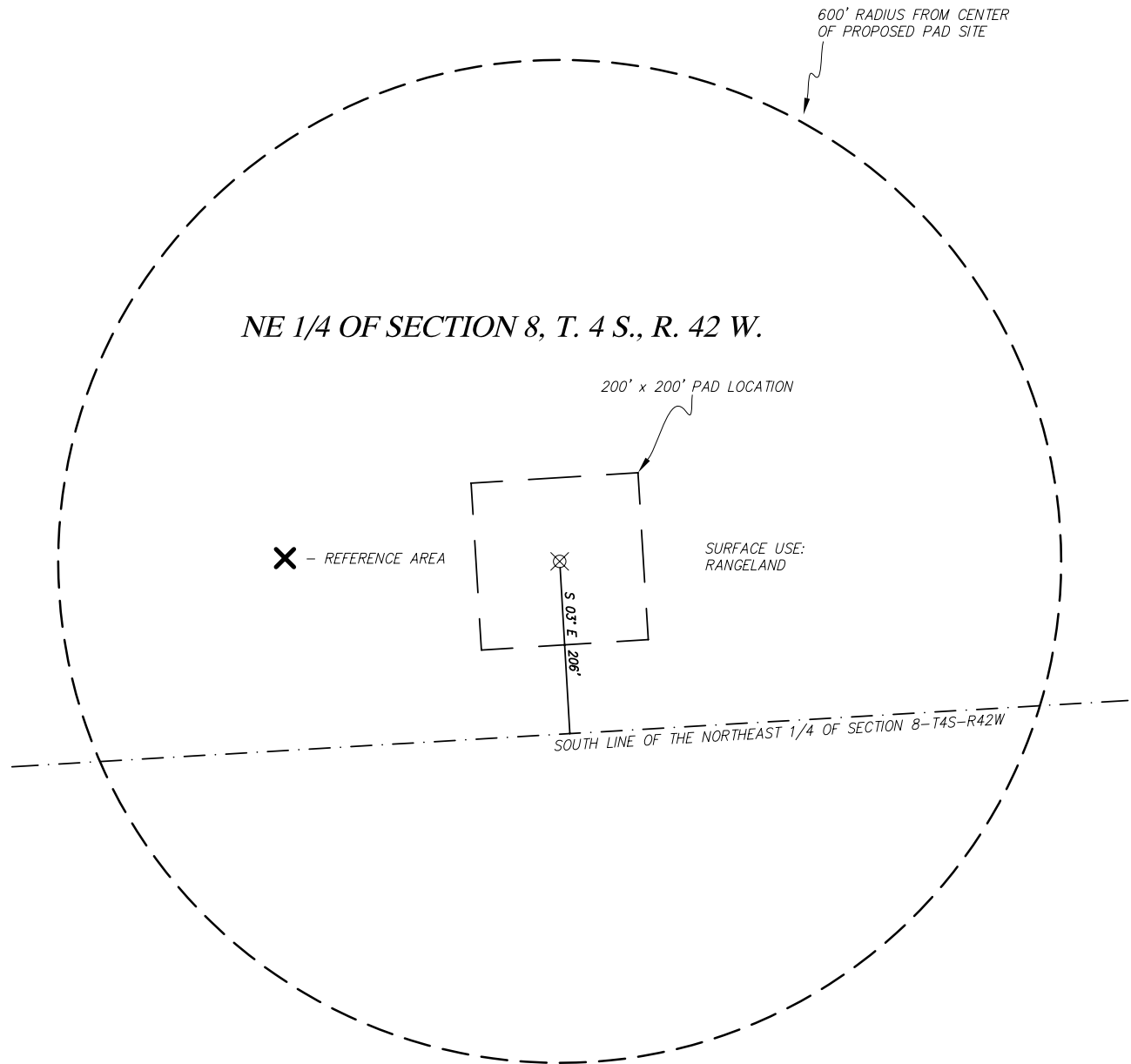

LEGEND

- ⊗ PROPOSED WELL LOCATION
- - - - - SECTION LINE

NOTE:

- NEAREST RAILROAD - 24 +/- MILES TO NORTH
- NEAREST RIVER - SOUTH FORK OF REPUBLICAN RIVER - 5.1 +/- MILES SOUTHEAST
- NEAREST BODY OF WATER - BONNY RESERVOIR - 8.2 MILES SOUTHWEST

SCALE 1" = 200'



THREE CORNERS SURVEYING AND MAPPING, LLC
PO Box 463; 312 Main Street
Wray, CO 80758
970-332-4133
3cornerssurveying@centurytel.net

