

MULTI-WELL PLAN HERBST C22-24 & COLEMAN C22-21D

DALEY LAND SURVEYING, INC. PARKER, CO. 80134 303 953 9841

WELL LOCATION CERTIFICATE COLEMAN C22-21D

SECTION 22, TOWNSHIP 4 NORTH, RANGE 64 WEST OF THE 6TH PRINCIPAL MERIDIAN

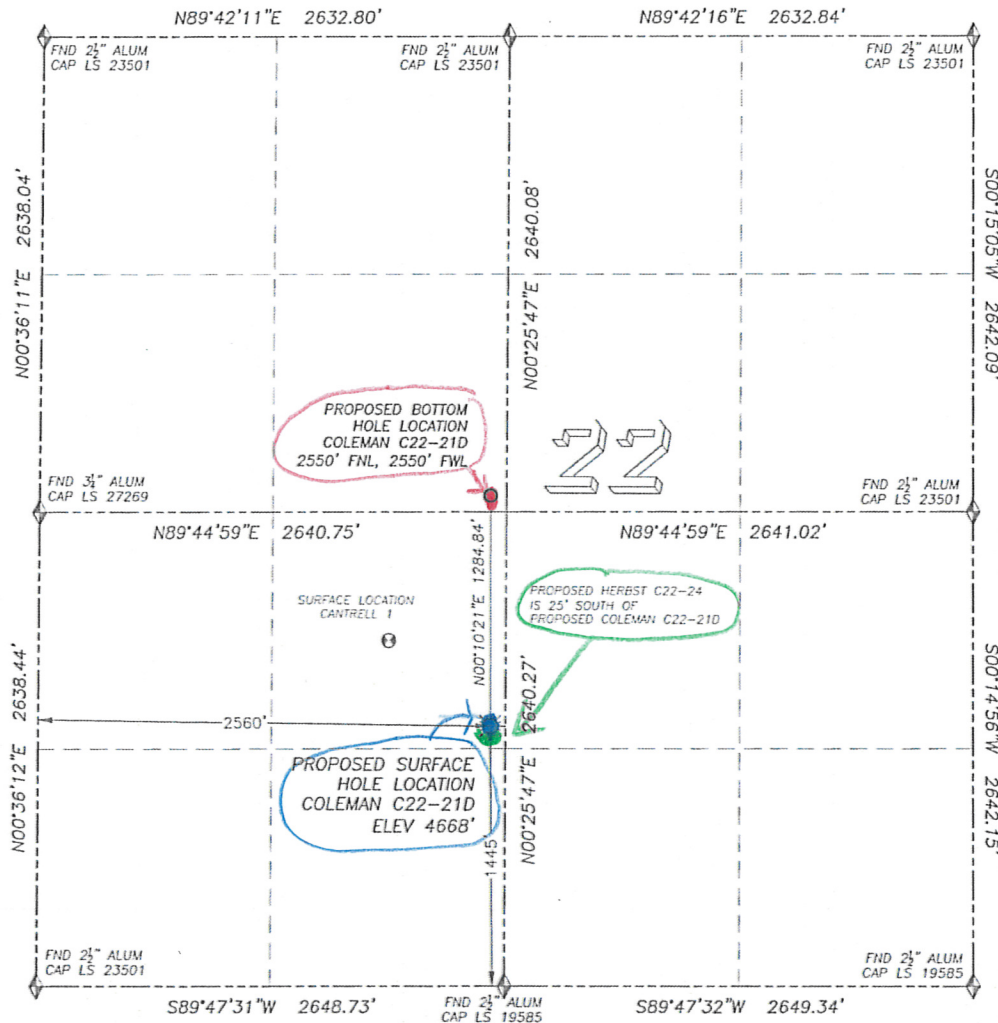

0 500 1000
SCALE: 1" = 1000'

LEGEND
 FOUND MONUMENT AS DESCRIBED
 PROPOSED WELL
 EXISTING WELL
 BOTTOM HOLE
 ABANDONED WELL

NAD 83 LATITUDE AND LONGITUDE COLEMAN C22-21D SURFACE HOLE:

LATITUDE: N40.29466°
 LONGITUDE: W104.53721°
 ELEVATION: 4668'
 PDOP 2.4
 1445' FSL, 2560' FWL
 BOTTOM HOLE:
 LATITUDE: N40.29819°
 LONGITUDE: W104.53719°
 2550' FNL, 2550' FWL SEC. 22

NEAREST EXISTING WELL:

CANTRELL 1 SURFACE HOLE
 LATITUDE: N40.29596°
 LONGITUDE: W104.53927°
 ELEVATION: 4667'
 746' NORTHWEST

QUARTER/QUARTER: NE4/SW4

NEAREST APPARENT PROPERTY LINE:
 125'± SOUTH

IN ACCORDANCE WITH A REQUEST FROM ROBBIE MILLER OF NOBLE ENERGY INC., DALEY LAND SURVEYING, INC. HAS DETERMINED THE SURFACE LOCATION OF THE COLEMAN C22-21D WELL TO BE 1445' FSL, 2560' FWL, AS MEASURED AT NINETY (90) DEGREES FROM THE SECTION LINES OF SECTION 22, TOWNSHIP 4 NORTH, RANGE 64 WEST OF THE 6TH PRINCIPAL MERIDIAN, WELD COUNTY, COLORADO. THE BOTTOM HOLE LOCATION, PROVIDED BY THE CLIENT, IS TO BE 2550' FNL, 2550' FWL OF SEC. 22. I HEREBY CERTIFY THAT THIS WELL LOCATION CERTIFICATE WAS PREPARED BY ME OR UNDER MY DIRECT SUPERVISION, THAT THE WORK WAS COMPLETED ON 3/23/2010 FOR AND ON BEHALF OF NOBLE ENERGY, INC., AND THAT THIS MAP DOES NOT REPRESENT A BOUNDARY SURVEY, IT IS NOT A LAND SURVEY PLAT OR AN IMPROVEMENT SURVEY PLAT AND IT IS NOT TO BE RELIED UPON FOR THE ESTABLISHMENT OF FENCE, BUILDING OR OTHER FUTURE IMPROVEMENT LINES.

NOTES:

- 1) BEARINGS FOR THIS MAP ARE ASSUMED AND BASED UPON GPS OBSERVATIONS MADE BETWEEN MONUMENTS LOCATED AT THE SOUTHWEST AND WEST QUARTER CORNERS OF SECTION 22, T.4N., R.64W.
- 2) HORIZONTAL DATUM IS NAD83.
- 3) VERTICAL DATUM IS NAVD88. ELEVATIONS ARE DERIVED FROM GPS OBSERVATIONS PROCESSED THROUGH OPUS, UTILIZING THE GEOID03 MODEL.
- 4) SEE VISIBLE IMPROVEMENTS EXHIBIT FOR VISIBLE IMPROVEMENTS WITHIN 600' OF PROPOSED SURFACE HOLE LOCATION.
- 5) SURFACE USE: IRRIGATED CROPLAND.

NOTICE: According to Colorado law you MUST commence any legal action based upon any defect in this W.L.C. within three years after you first discover such defect. In no event may any action based upon any such defect in this W.L.C. be commenced more than ten years from the date of the certification shown herein.

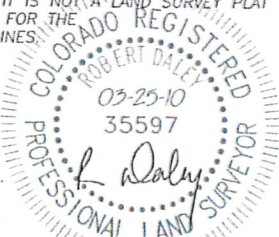

FOR AND ON BEHALF OF:
 DALEY LAND SURVEYING INC.,
 Robert Daley, PLS 35597