

#### LEGEND

- FOUND MONUMENT
- CALCULATED MONUMENT
- ⬢ WELL LOCATION
- BOTTOM HOLE
- SHL - SURFACE HOLE LOCATION
- BHL - BOTTOM HOLE LOCATION
- BC - BRASS CAP
- GLO - GENERAL LAND OFFICE SURVEY

#### NOTES:

- 1) GPS OPERATOR Kurt Shepherd OBSERVED A PDOP OF 2.021.
- 2) ALL GPS OBSERVATIONS ARE IN COMPLIANCE WITH COGCC RULE 215.
- 3) ALL DISTANCES ARE NAD83 COLORADO STATE PLANE, CENTRAL ZONE (SEA LEVEL).
- 4) THIS PLAT COMPLIES WITH COGCC RULE 303c.
- 5) NO VISIBLE IMPROVEMENTS WITHIN 400' OF WELL HEAD.
- 6) VEGETATION: SCRUB OAK, SAGE, NATIVE SHRUBS & GRASSES
- 7) BOTTOM HOLE LOCATION COORDINATES PROVIDED BY WILLIAMS PRODUCTION, RMT.

#### BASIS OF BEARING/DATUM

A GPS OBSERVATION FROM NGS PID AJ3465 (FABER)

#### BASIS OF ELEVATION

A GPS OBSERVATION FROM NGS PID AJ3465 (FABER). SAID ELEVATION IS 5186.22'.

#### DIMENSIONAL TIES

ALL DIMENSIONAL TIES TO SECTION LINES ARE MEASURED AT A 90° ANGLE TO THE SECTION LINE.

#### SURVEYORS CERTIFICATE:

This is to certify that this exhibit was prepared and location as shown was staked on the ground from actual surveys made by me or under my direct supervision.

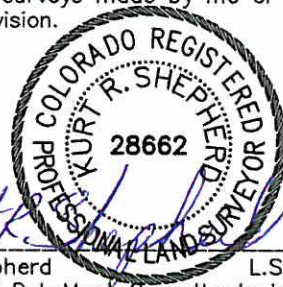

Kurt R. Shepherd L.S. 28662  
On behalf of Del-Mont Consultants Inc.

DATE REVISED: 2010-06-17

DEL-MONT CONSULTANTS IS PROVIDING GRADING DESIGN FOR THIS PROJECT THAT PROVIDES DIMENSIONS AND VOLUME INFORMATION FOR CONSTRUCTION.



DEL-MONT CONSULTANTS, INC.  
ENGINEERING • SURVEYING • PLANNING  
175 Colorado Ave. • Montrose, CO 81401 • (970) 243-2251 • (970) 243-2342 fax  
www.delmontinc.com • www.surveydelmont.com

NW1/4 NE1/4 S34, T6S, R96W, 6TH P.M.

WELL LOCATION PLAT  
GM 341-34

WELL PAD GM 331-34

GARFIELD COUNTY, CO

WILLIAMS PRODUCTION, RMT

DWC JOB NO 10030

DATE ISSUED 2008-12-10

DATE SURVEYED 2008-11-19

PLAT 1 of 9

DESIGNED BY

MGW

SCALE

1"=100'

CHECKED BY

KS

FILE NAME

10030-GM\_331-34-SITE

