



April 1, 2009

Remediation # 4365

Mr. Mike Cox
Environmental Coordinator
Noble Energy, Inc.
804 Grand Avenue
Platteville, Colorado 80651

Mr. Bill Farmer
Foundation Energy Company
444 South 2nd Street
La Salle, Colorado 80645

RE: First Quarter 2009 Remediation and Monitoring Report
Becky #2-6 Natural Gas Wellhead Site
Weld County, Colorado

Dear Mr. Cox and Mr. Farmer:

LT Environmental, Inc. (LTE) was retained by Noble Energy, Inc. (Noble) and Foundation Energy Company (Foundation) to conduct corrective actions at the Becky #2-6 natural gas wellhead site (Site) located approximately 3.5 miles west of the intersection of Interstate 25 and Weld County Road (WCR) 52 in Weld County, Colorado. A Site Map is provided as Figure 1.

LTE, on behalf of Noble, has completed system design, installation, and startup of the air sparging/soil vapor extraction (AS/SVE) remediation system. LTE is continuing to conduct groundwater monitoring at the Site to evaluate previously documented groundwater impact. This correspondence is provided as the first quarter 2009 remediation and monitoring report, and summarizes activities conducted at the Site from January 1, 2009 through March 31, 2009. Activities conducted during the reporting period and summarized in this report include operation and maintenance (O&M) of the remediation system and the results of the groundwater sampling event conducted on February 23, 2009.

Remediation System Description

The AS system is designed to introduce ambient air into the subsurface water column for dissolved hydrocarbon volatilization and to promote aerobic microbial decomposition of petroleum constituents (Figure 2). The SVE system is designed to volatilize petroleum constituents adsorbed onto soil particles and to remove petroleum vapors released from the groundwater by the AS process (Figure 3). AS and SVE wells are connected to a remediation equipment trailer housing the equipment for the AS/SVE systems. The distribution and spacing of these wells are based on site-specific soil analytical data, groundwater quality data, contamination profiles, geological characteristics, experience with similar systems, and the location and influence area of remediation



wells (Figure 4). Additional details of the remediation system design and installation was presented in the previously submitted report *Remediation System Installation, Startup, and Groundwater Sampling Results* dated January 9, 2009. The remediation system began operation at the Site on November 17, 2008.

Remediation System Operation and Maintenance

Following system startup, the AS/SVE remediation system has operated continuously throughout the reporting period with occasional shutdowns due to loss of gas pressure from the separator and routine maintenance activities.

O&M activities conducted in the reporting period included:

- Completion routine, weekly, monthly, and quarterly O&M checks to monitor and adjust system performance;
- Manual cycling of the AS system;
- Field screening the exhaust for air emissions;
- Collecting air samples for emissions analysis;
- Replacement of solenoid valve diaphragms;
- AS and SVE system maintenance, which included changing oil;
- Generator maintenance, which included changing oil and oil filters; and
- System shutdown and transport to another Noble facility (Frick 18 – 2 & 8 natural gas wellhead site) on February 26, 2009. The system is expected to be returned to this Site in May 2009.

Operation of the remediation system will alternate between continuous operation for an approximate three month period and a three month static evaluation with no remediation system operation occurring. This program will allow for continued removal of hydrocarbon impact along with static evaluations to determine which areas of the Site require continued operations.

Groundwater Sampling Procedures

Twenty-one groundwater monitoring wells were sampled at the Site on February 23, 2009 to determine the current plume extent following three months of remediation system operation. Prior to sampling each well, the down well dissolved oxygen (DO) concentration was collected and the depth to groundwater was measured and recorded for calculating purge volumes (Table 1). DO data was collected to evaluate the influence of the remediation system.



Each well was purged of three casing volumes prior to collection of groundwater samples. Groundwater samples were collected from the well points by advancing disposable 3/16-inch diameter polyethylene tubing inside the 1-inch diameter polyvinyl chloride (PVC) well casing and extending the tubing to below the groundwater table. A peristaltic pump was utilized to collect the groundwater samples prior to placement into laboratory prepared sample bottles. Groundwater samples were collected in 40-milliliter vials, placed on ice, and delivered under chain-of-custody (COC) protocol to Origins Laboratory located in Denver, Colorado. Samples were analyzed for benzene, toluene, ethylbenzene, and total xylenes (BTEX) by Environmental Protection Agency Method 8260B.

Hydrogeology

During the February 2009 sampling event, the depths to static groundwater level ranged from 7.25 feet below top of casing (TOC) in MW-11 to 9.98 feet below TOC in MW-17 (Table 1). The groundwater flow direction was to the north with an average hydraulic gradient of approximately 0.0095 feet per foot.

Groundwater Analytical Results

The Colorado Department of Public Health and Environmental (CDPHE) Water Quality Control Commission (WQCC) has established Regulation 41 - The Basic Standards for Groundwater for BTEX of 5.0 micrograms per liter (ug/L), 560 ug/L, 700 ug/L, and 1,400 ug/L, respectively. Table 1 summarizes groundwater analytical results for samples collected during all monitoring events. The laboratory analytical report, laboratory quality assurance/quality control data, and COC documentation are attached.

Twenty-one groundwater samples were collected and submitted to Origins Laboratory for BTEX analysis during the February 23, 2009 sampling event. One monitoring well was found to contain free-phase petroleum product (MW-10). The free-phase product thickness was removed with a 1-inch disposable bailer. Groundwater analytical results indicated that benzene was detected above the CDPHE-WQCC Regulation 41 Groundwater Standards in monitoring wells MW-7, MW-9, MW-13, and MW-25, at concentrations ranging from 5.03 ug/L at MW-7 to 390 ug/L at MW-13. Detectable concentrations of BTEX compounds below the regulatory standards were also found in MW-16 and MW-29. BTEX compounds were not detected above the laboratory method detection limits in the remaining samples. Groundwater analytical results for the February 2009 sampling event are summarized in Table 1 and illustrated on Figure 5.

Summary and Conclusions

Current data suggest the remediation system has successfully decreased benzene concentrations in monitoring wells MW-26 and MW-34 into compliance with groundwater standards. Analytical data indicate that MW-7, MW-9, MW-13, and MW-25 remained above groundwater standards; however, benzene concentrations had decreased below historical highs in all four wells. Figure 6 provides benzene isocontours for the most recent sampling events. Product thickness in wells MW-10 and



MW-16 have also indicated remediation progress and product removal. The change in benzene concentrations and product thickness illustrates that the remediation system is positively influencing the groundwater impact. As seen in the attached Table 1, benzene is still present at the Site and continued remediation system operation is recommended to achieve cleanup goals.

The next groundwater sampling event will be conducted in May 2009. Groundwater monitoring will continue to be conducted at the Site on a quarterly basis until site closure status is received from the COGCC. Active remediation will be re-initiated at the site in May 2009.

LTE appreciates the opportunity to provide environmental services to Noble. Please call us at 303-433-9788 if you have any questions or comments regarding this report.

Sincerely,

LT ENVIRONMENTAL, INC.

A handwritten signature in black ink, reading "Matthew R. Vielhaber".

Matthew R. Vielhaber, P.E.
Project Manager

A handwritten signature in black ink, reading "Steve D. Kahn".

Steve D. Kahn, P.E.
Senior Engineer

Attachments

Table 1: Groundwater Quality Data

Figure 1: Site Map

Figure 2: Air Sparging System Layout

Figure 3: Soil Vapor Extraction System Layout

Figure 4: Radius of Influence Map

Figure 5: Groundwater Analytical Results – February 23, 2009

Figure 6: Groundwater Analytical Summary

Attachment: Laboratory Analytical Report

TABLE



TABLE 1

GROUNDWATER QUALITY DATA

BECKY #2-6

WELD COUNTY, COLORADO

NOBLE ENERGY, INC.

Well ID	Date	Depth to Product (feet btoc)	Depth to Water (feet btoc)	Product Thickness (feet)	DO (mg/L)	PID (ppm)	Benzene (ug/L)	Toluene (ug/L)	Ethylbenzene (ug/L)	Total Xylenes (ug/L)
MW-1	6/24/2008		7.92				3.52	<1.00	55.05	25.16
	11/10/2008		7.66		2.74	0.0	<1.00	<1.00	<1.00	<3.00
	2/23/2009		7.46		1.42		<1.00	<1.00	<1.00	<3.00
MW-2	6/24/2008		8.01				<1.00	<1.00	<1.00	<3.00
MW-3	6/24/2008		8.09				6.43	<1.00	<1.00	5.15
	11/10/2008		7.83		0.28	0.0	1.26	<1.00	<1.00	<3.00
	2/23/2009		7.68		0.18		<1.00	<1.00	<1.00	<3.00
MW-4	6/24/2008		7.88				<1.00	<1.00	<1.00	<3.00
	11/10/2008		7.73		1.20	0.0	<1.00	<1.00	<1.00	<3.00
	2/23/2009		7.59		1.38		<1.00	<1.00	<1.00	<3.00
MW-5	6/24/2008		8.08				<1.00	<1.00	<1.00	<3.00
MW-6	6/24/2008		7.85				<1.00	<1.00	<1.00	<3.00
MW-7	6/24/2008		8.10				358.40	1.02	277.60	3,120.29
	11/10/2008		7.98		0.17	325	725	<1.00	493	6,008.8
	2/23/1009		7.36		0.07		5.03	<1.00	9.04	141
MW-8	6/24/2008		7.60				<1.00	<1.00	<1.00	<3.00
	11/10/2008		7.59		0.36	0.0	<1.00	<1.00	<1.00	<3.00
	2/23/2009		7.34		0.18		<1.00	<1.00	<1.00	<3.00
MW-9	6/24/2008		8.45				430.20	<1.00	35.57	396.80
	11/10/2008		8.32		1.13	94.5	175	<1.00	24.7	77.90
	2/23/2009		8.29		0.10		12.8	<1.00	1.56	3.70
MW-10	6/24/2008		8.26				1,254.2	1.84	223.60	2,373.80
	11/10/2008	8.13	8.63	0.50	NM	305	NA	NA	NA	NA
	11/13/2008	8.21	8.44	0.23	NM		NA	NA	NA	NA
	2/23/2009	8.09	8.01	0.08	NM		NA	NA	NA	NA

TABLE 1

GROUNDWATER QUALITY DATA

BECKY #2-6

WELD COUNTY, COLORADO

NOBLE ENERGY, INC.

Well ID	Date	Depth to Product (feet btoc)	Depth to Water (feet btoc)	Product Thickness (feet)	DO (mg/L)	PID (ppm)	Benzene (ug/L)	Toluene (ug/L)	Ethylbenzene (ug/L)	Total Xylenes (ug/L)
MW-11	6/24/2008		7.52				<1.00	<1.00	1.35	14.70
	11/10/2008		7.48		0.78	0.0	<1.00	<1.00	<1.00	5.00
	2/23/2009		7.25		1.71		<1.00	<1.00	<1.00	<3.00
MW-12	6/24/2008		7.70				<1.00	<1.00	<1.00	<3.00
MW-13	6/24/2008		8.68				1,616.2	<1.00	249.20	3,551.0
	11/10/2008		8.85		0.46	0.0	684	<1.00	84.0	152.11
	2/23/2009		8.72		3.34		390	<1.00	26.7	86.5
MW-14	6/24/2008		9.35				3.66	1.26	1.69	21.65
	11/10/2008		9.56		0.34	0.0	<1.00	<1.00	<1.00	<3.00
	2/23/2009		9.48		0.62		<1.00	<1.00	<1.00	<3.00
MW-15	6/24/2008		9.34				<1.00	<1.00	<1.00	4.31
	11/10/2008		9.89		2.16	0.0	<1.00	<1.00	<1.00	<3.00
	2/23/2009		9.66		1.32		<1.00	<1.00	<1.00	<3.00
MW-16	6/24/2008		9.19				6.28	<1.00	170.65	1,998.36
	11/10/2008	9.83	9.84	0.01	NM	634	NA	NA	NA	NA
	11/13/2008	ND	9.88	0.00			<1.00	<1.00	<1.00	220.86
	2/23/2009	ND	9.62	0.00	0.39		<1.00	<1.00	9.12	89.0
MW-17	6/24/2008		9.16				<1.00	<1.00	<1.00	13.46
	11/10/2008		10.27		4.11	0.0	<1.00	<1.00	<1.00	<3.00
	2/23/2009		9.98		4.18		<1.00	<1.00	<1.00	<3.00
MW-18	6/24/2008		9.37				<1.00	<1.00	<1.00	3.24
	11/10/2008		10.13		0.36	0.0	<1.00	<1.00	<1.00	3.36
	2/23/2009		9.92		2.97		<1.00	<1.00	<1.00	<3.00
MW-19	6/24/2008		8.73				<1.00	<1.00	<1.00	3.53
MW-20	6/24/2008		8.52				<1.00	<1.00	<1.00	<3.00

TABLE 1

GROUNDWATER QUALITY DATA

BECKY #2-6

WELD COUNTY, COLORADO

NOBLE ENERGY, INC.

Well ID	Date	Depth to Product (feet btoc)	Depth to Water (feet btoc)	Product Thickness (feet)	DO (mg/L)	PID (ppm)	Benzene (ug/L)	Toluene (ug/L)	Ethylbenzene (ug/L)	Total Xylenes (ug/L)
MW-21	6/24/2008		8.20				<1.00	<1.00	<1.00	<3.00
MW-22	6/24/2008		8.66				<1.00	<1.00	<1.00	<3.00
MW-23	6/24/2008		9.14				83.13	1.43	164.46	1,283
	11/10/2008		8.95		4.12	1.8	1.46	<1.00	1.54	<3.00
	2/23/2009						WELL DRY			
MW-24	6/24/2008		9.00				<1.00	<1.00	<1.00	<3.00
	11/10/2008		8.85		4.31	0.0	<1.00	<1.00	<1.00	6.27
	2/23/2009		8.84		2.35		<1.00	<1.00	<1.00	<3.00
MW-25	6/24/2008		8.86				120.95	<1.00	17.52	602.10
	11/10/2008		8.85		4.12	0.0	47.5	<1.00	7.73	28.8
	2/23/2009		8.71		1.10		20.3	<1.00	1.64	3.86
MW-26	6/24/2008		8.35				75.72	<1.00	71.24	598.70
	11/10/2008		8.47		0.60	0.0	57.4	<1.00	36.4	47.60
	2/23/2009		8.26		1.23		<1.00	<1.00	<1.00	<3.00
MW-27	6/24/2008		8.73				<1.00	<1.00	<1.00	<3.00
	11/10/2008		9.07		0.87	0.0	1.72	<1.00	<1.00	18.4
	2/23/2009		8.87		2.70		<1.00	<1.00	<1.00	<3.00
MW-28	6/24/2008		8.85				<1.00	<1.00	<1.00	2.97
MW-29	6/24/2008		8.89				<1.00	<1.00	<1.00	<3.00
	11/10/2008		9.69		0.17	0.0	<1.00	<1.00	<1.00	<3.00
	2/23/2009		9.46		0.46		<1.00	<1.00	4.18	5.23
MW-30	6/24/2008		8.57				<1.00	<1.00	<1.00	<3.00
	11/10/2008		8.56		1.52	0.0	<1.00	<1.00	<1.00	2.88
	2/23/2009		8.46		1.76		<1.00	<1.00	<1.00	<3.00
MW-31	6/24/2008		7.94				<1.00	<1.00	<1.00	<3.00

TABLE 1

GROUNDWATER QUALITY DATA
BECKY #2-6
WELD COUNTY, COLORADO
NOBLE ENERGY, INC.

Well ID	Date	Depth to Product (feet btoc)	Depth to Water (feet btoc)	Product Thickness (feet)	DO (mg/L)	PID (ppm)	Benzene (ug/L)	Toluene (ug/L)	Ethylbenzene (ug/L)	Total Xylenes (ug/L)
MW-32	7/7/2008						<1.0	<1.0	<1.0	<1.0
	11/10/2008		9.57		0.86	0.0	<1.00	<1.00	<1.00	<3.00
	2/23/2009		9.42		1.54		<1.00	<1.00	<1.00	<3.00
MW-33	7/7/2008						1.4	<1.0	10	5.9
	11/10/2008						WELL DESTROYED			
MW-34	7/7/2008						160	<1.00	370	2,800
	11/10/2008		8.13		0.71	215	85.7	<1.00	89.4	108
	2/23/2009		7.98		0.68		<1.00	<1.00	<1.00	<3.00
CDPHE-WQCC Regulation 41 Groundwater Standards							5.0	560	700	1,400

NOTES:

CDPHE-WQCC - Colorado Department of Public Health and Environmental Water Quality Control Commission

Benzene, toluene, ethylbenzene, total xylenes analyzed by EPA Method 8260B

btoc - below top of casing

mg/L - milligrams per liter

ppm - parts per million

ug/L - micrograms per liter

DO - dissolved oxygen

PID - photoionization detector

< indicates result is less than the stated laboratory method detection limit

NA - not analyzed

NM - not measured due to free-phase hydrocarbons in monitoring well

FIGURES



COUNTY ROAD 52

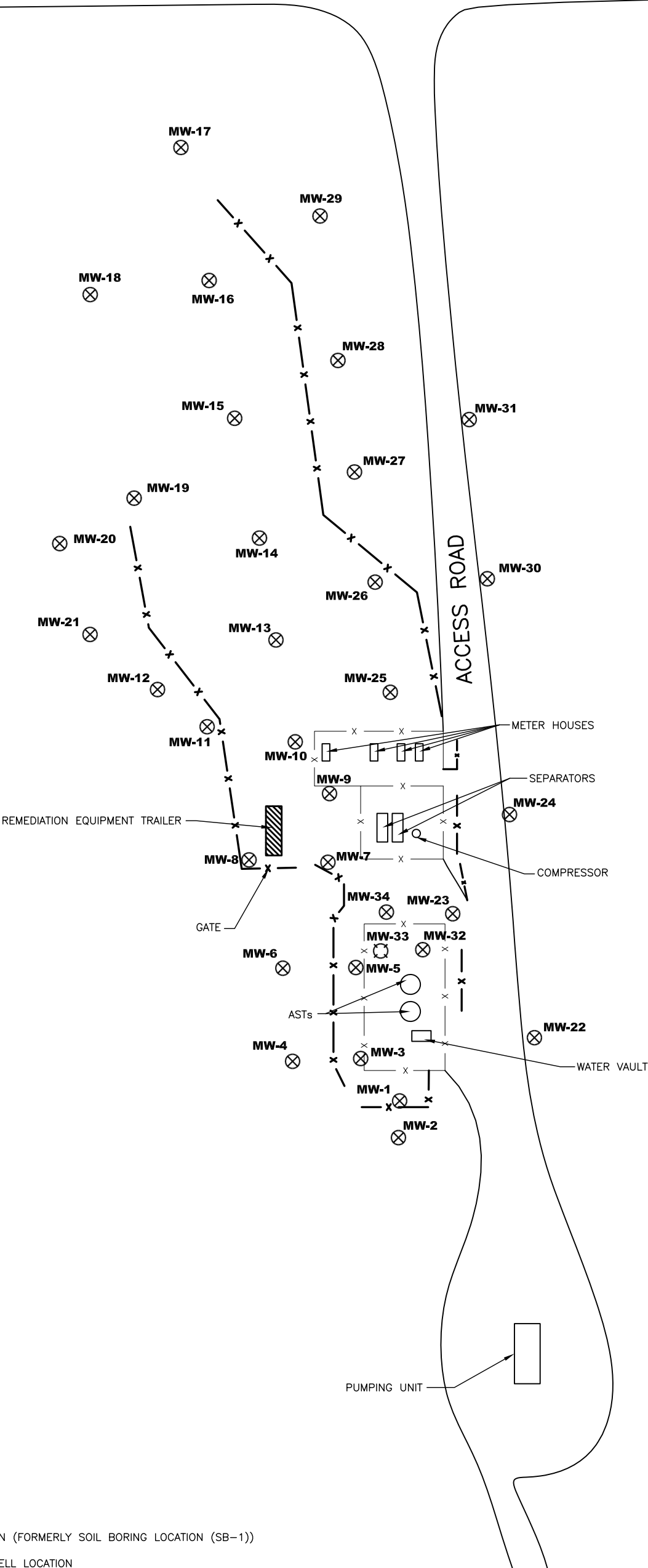

LEGEND

- MW-1** MONITORING WELL LOCATION (FORMERLY SOIL BORING LOCATION (SB-1))
- MW-33** DESTROYED MONITORING WELL LOCATION
- EXISTING FENCE
- NEW FENCE
- AST ABOVEGROUND STORAGE TANK

SOURCE:
LTE SITE SKETCH

FIGURE 1
SITE MAP
BECKY #2-6
WELD COUNTY, COLORADO
NOBLE ENERGY, INC.

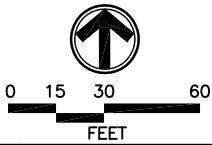

COUNTY ROAD 52

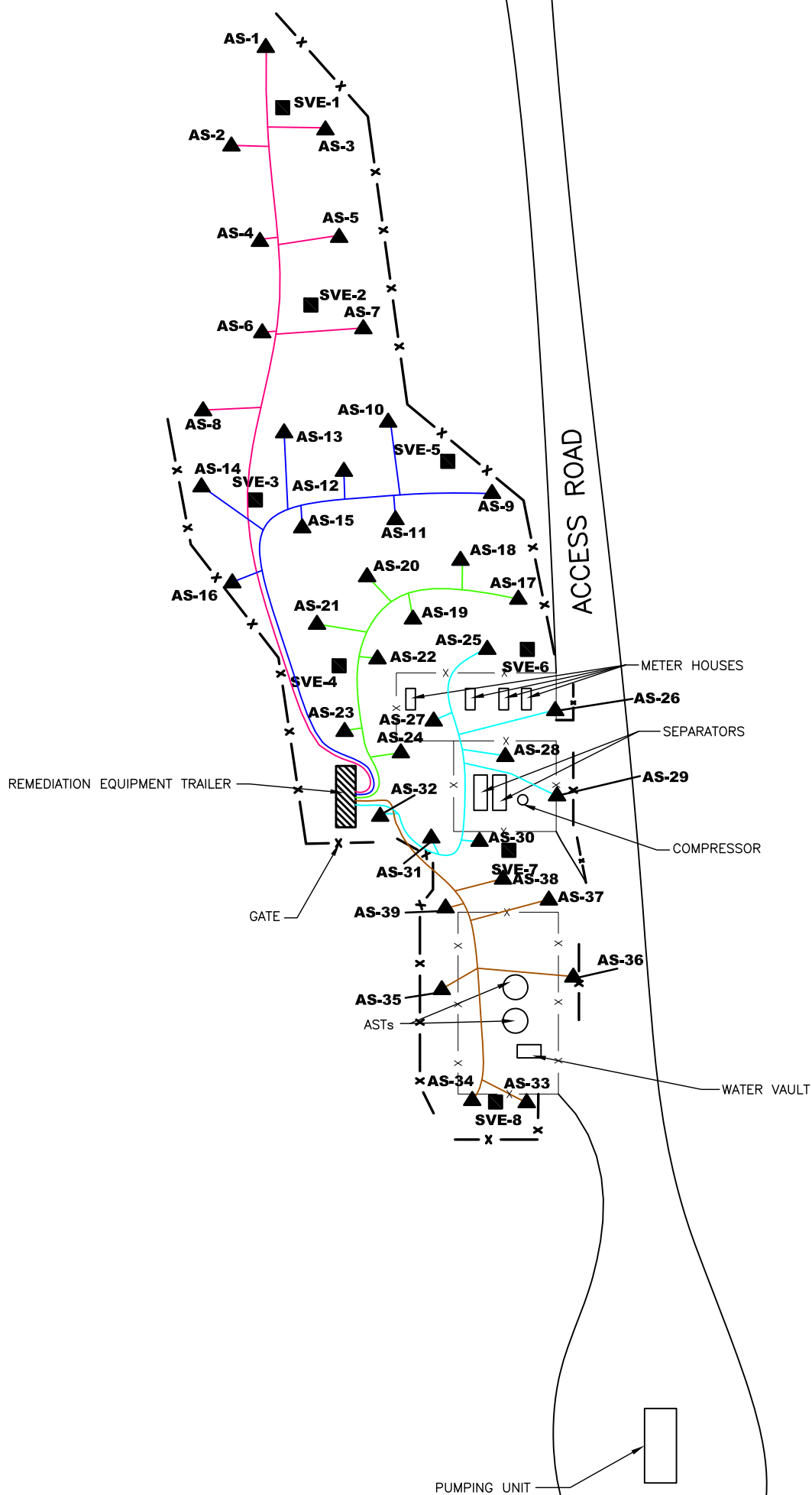
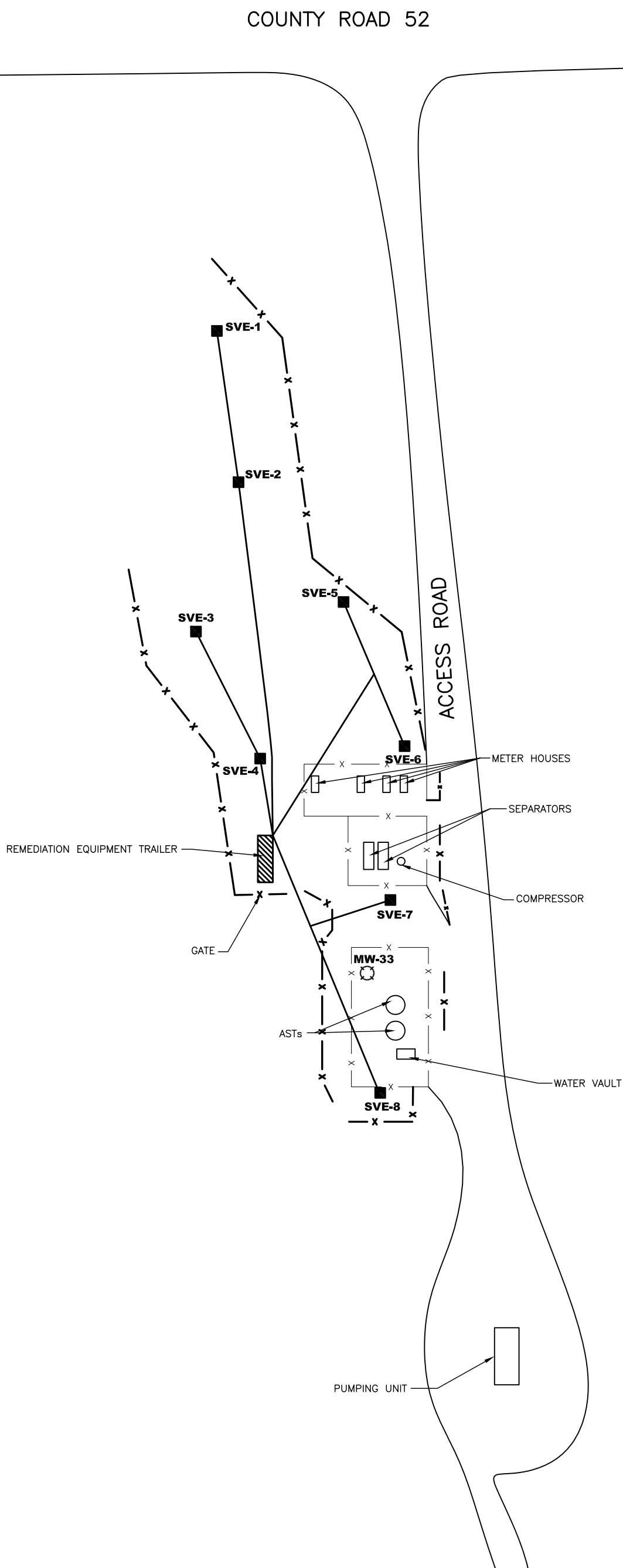

FIGURE 2
AIR SPARGING SYSTEM LAYOUT
BECKY #2-6
WELD COUNTY, COLORADO
NOBLE ENERGY, INC.



LEGEND

- x — EXISTING FENCE
- x — NEW FENCE
- SVE-1** ■ SOIL VAPOR EXTRACTION WELL LOCATION
- SYSTEM PIPING
- AST ABOVEGROUND STORAGE TANK

SOURCE:
LTE SITE SKETCH

FIGURE 3
SOIL VAPOR EXTRACTION SYSTEM LAYOUT
BECKY #2-6
WELD COUNTY, COLORADO
NOBLE ENERGY, INC.

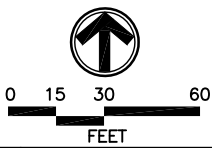

2/09\NEP082601

COUNTY ROAD 52

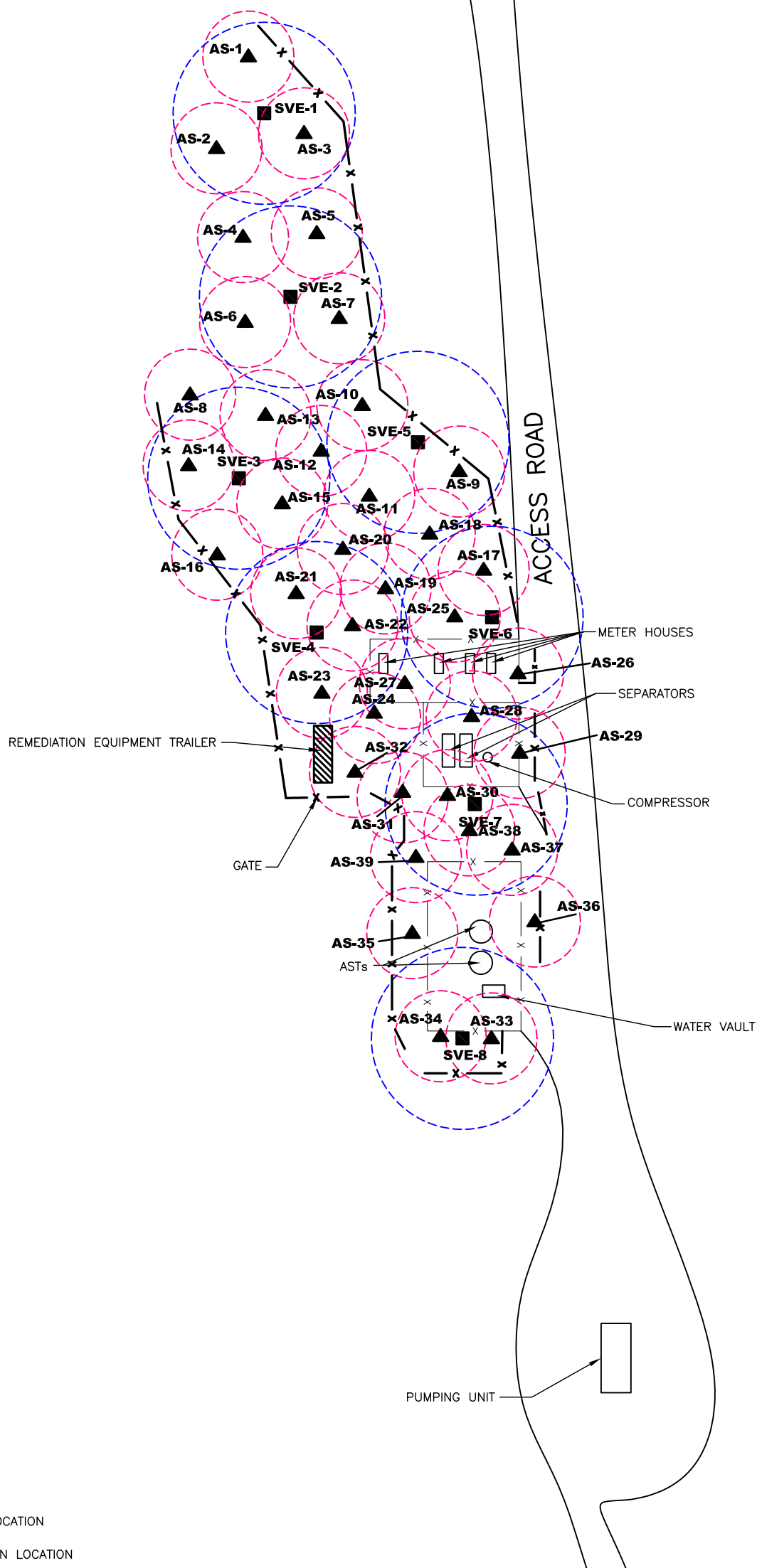

LEGEND

- x — EXISTING FENCE
- x — NEW FENCE
- AS-1 ▲ AIR SPARGING WELL LOCATION
- SVE-1 ■ SOIL VAPOR EXTRACTION LOCATION
- AIR SPARGING RADIUS OF INFLUENCE (20 FEET)
- SOIL VAPOR RADIUS OF INFLUENCE (40 FEET)
- AST ABOVEGROUND STORAGE TANK

SOURCE:
LTE SITE SKETCH

FIGURE 4
RADIUS OF INFLUENCE MAP
BECKY #2-6
WELD COUNTY, COLORADO
NOBLE ENERGY, INC.

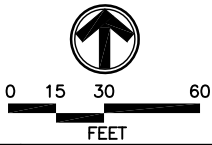

COUNTY ROAD 52

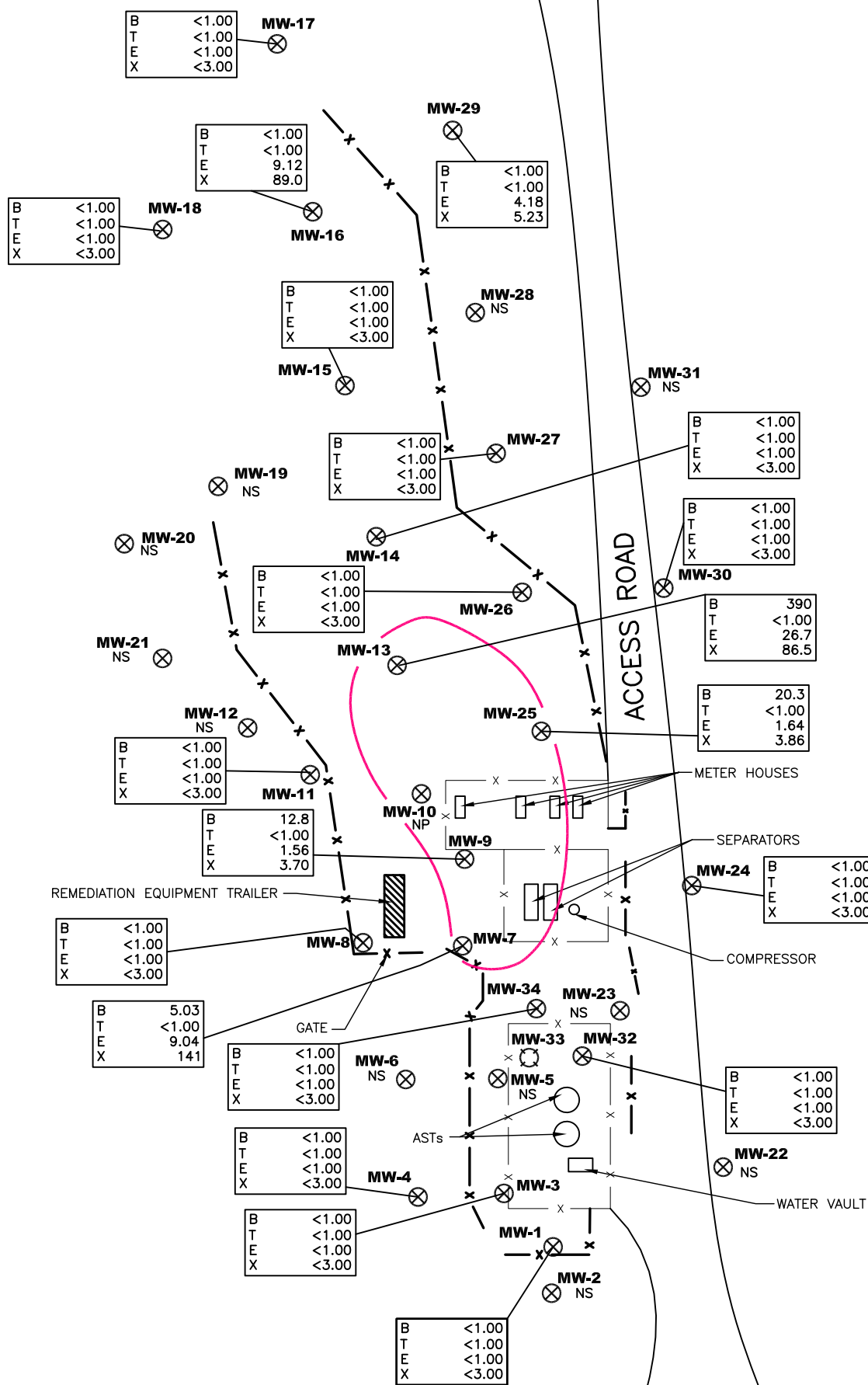

LEGEND

MW-1 ⊗ MONITORING WELL LOCATION (FORMERLY SOIL BORING LOCATION (SB-1))

MW-33 ⊗ DESTROYED MONITORING WELL LOCATION

— x — EXISTING FENCE

— x — NEW FENCE

AST ABOVEGROUND STORAGE TANK

— 5.0 MICROGRAMS PER LITER (µg/L) BENZENE ISOCONCENTRATION LINE

B	BENZENE
T	TOLUENE
E	ETHYLBENZENE
X	TOTAL XYLENES

ANALYTICAL RESULTS ARE REPORTED IN µg/L

NS NOT SAMPLED

NP NOT SAMPLED DUE TO FREE PRODUCT

SOURCE:
LTE SITE SKETCH

FIGURE 5
GROUNDWATER ANALYTICAL RESULTS
FEBRUARY 23, 2009
BECKY #2-6
WELD COUNTY, COLORADO
NOBLE ENERGY, INC.

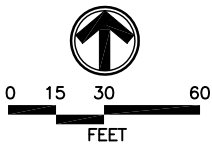

COUNTY ROAD 52

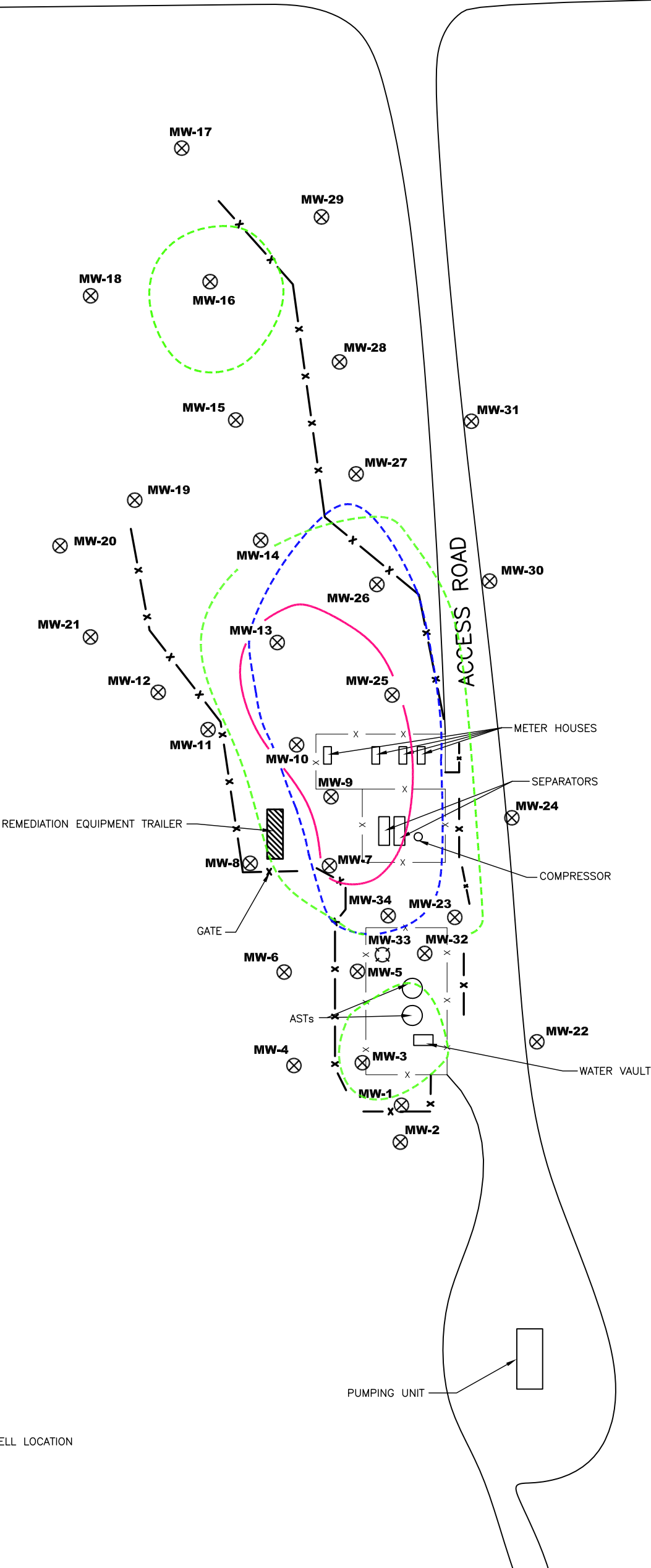

MW-33 DESTROYED MONITORING WELL LOCATION
— x — EXISTING FENCE
— x — NEW FENCE

0.1/L BENZENE ISOCONCENTRATION LINE
JUNE 2008

SOURCE:
LTE SITE SKETCH

FIGURE 6
GROUNDWATER ANALYTICAL SUMMARY
BECKY #2-6
WELD COUNTY, COLORADO
NOB

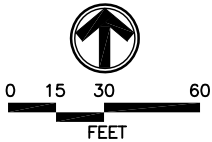

ATTACHMENT
LABORATORY ANALYTICAL REPORT





4640 Pecos Street | Unit C | Denver, Colorado 80211
303.433.1322 Phone 303.265.9645 Fax

February 26, 2009

LT Environmental, Inc.
4600 West 60th Avenue
Arvada CO 80003

Matt Vielhaber
Project Number: NEP0826.01
Project: Noble – Becky #2–6

Attached are the analytical results for Noble – Becky #2–6 received by Origins Laboratory, Inc. 2/23/2009 4:53:00PM. Please let us know if you have any questions, or if we can help with anything at all.

Laboratory Manager
Noelle E Doyle

The analytical results in the following report were analyzed under the guidelines of EPA Methods specified in SW-846. The analytical results apply specifically to the samples and analyses specified per the attached Chain of Custody. This laboratory report is intended solely for the above addressee and it is only to be used and or reproduced in its entirety.

4640 Pecos Street | Unit C
Denver, Colorado 80211
303.433.1322 | Laboratory
303.265.9645 | Fax



LT Environmental, Inc.
4600 West 60th Avenue
Arvada CO 80003

Matt Vielhaber
Project Number: NEP0826.01
Project: Noble – Becky #2–6

CROSS REFERENCE REPORT

Sample ID	Laboratory ID	Matrix	Sampled	Date Received
MW-1	X902081-01	Water	2/23/2009 9:30:00AM	02/23/2009 16:53
MW-3	X902081-02	Water	2/23/2009 9:50:00AM	02/23/2009 16:53
MW-4	X902081-03	Water	2/23/2009 10:00:00AM	02/23/2009 16:53
MW-7	X902081-04	Water	2/23/2009 10:50:00AM	02/23/2009 16:53
MW-8	X902081-05	Water	2/23/2009 10:55:00AM	02/23/2009 16:53
MW-9	X902081-06	Water	2/23/2009 11:10:00AM	02/23/2009 16:53
MW-11	X902081-07	Water	2/23/2009 11:55:00AM	02/23/2009 16:53
MW-13	X902081-08	Water	2/23/2009 11:45:00AM	02/23/2009 16:53
MW-14	X902081-09	Water	2/23/2009 12:20:00PM	02/23/2009 16:53
MW-15	X902081-10	Water	2/23/2009 12:30:00PM	02/23/2009 16:53
MW-16	X902081-11	Water	2/23/2009 12:40:00PM	02/23/2009 16:53
MW-17	X902081-12	Water	2/23/2009 1:20:00PM	02/23/2009 16:53
MW-18	X902081-13	Water	2/23/2009 12:50:00PM	02/23/2009 16:53
MW-24	X902081-14	Water	2/23/2009 1:55:00PM	02/23/2009 16:53
MW-25	X902081-15	Water	2/23/2009 12:10:00PM	02/23/2009 16:53
MW-26	X902081-16	Water	2/23/2009 12:15:00PM	02/23/2009 16:53
MW-27	X902081-17	Water	2/23/2009 1:40:00PM	02/23/2009 16:53

Origins Laboratory, Inc.

Noelle E Doyle, Laboratory Manager

The results in this report apply to the samples analyzed in accordance with the chain of custody document. This analytical report must be reproduced in its entirety.

4640 Pecos Street | Unit C
Denver, Colorado 80211
303.433.1322 | Laboratory
303.265.9645 | Fax



LT Environmental, Inc.
4600 West 60th Avenue
Arvada CO 80003

Matt Vielhaber
Project Number: NEP0826.01
Project: Noble – Becky #2–6

CROSS REFERENCE REPORT

Sample ID	Laboratory ID	Matrix	Sampled	Date Received
MW-29	X902081-18	Water	2/23/2009 1:30:00PM	02/23/2009 16:53
MW-30	X902081-19	Water	2/23/2009 1:50:00PM	02/23/2009 16:53
MW-32	X902081-20	Water	2/23/2009 2:00:00PM	02/23/2009 16:53
MW-34	X902081-21	Water	2/23/2009 10:30:00AM	02/23/2009 16:53

Origins Laboratory, Inc.

Noelle E Doyle, Laboratory Manager

The results in this report apply to the samples analyzed in accordance with the chain of custody document. This analytical report must be reproduced in its entirety.

4640 Pecos Street | Unit C
Denver, Colorado 80211
303.433.1322 | Laboratory
303.265.9645 | Fax



LT Environmental, Inc.
4600 West 60th Avenue
Arvada CO 80003

Matt Vielhaber
Project Number: NEP0826.01
Project: Noble - Becky #2-6

902081
page 1 of 3



originslaboratory.com
Project Manager: Matt Vielhaber
Project Name: Becky #2-6
Project Number: NEP0826
Samples Collected by: JVTD
Client: LT Environmental
Address: 4600 W 60th Ave
Arvada, CO 80003
Telephone Number: 303 433 9788
E-Mail Address: mviehaber@ltenv.com

Sample ID - Description	Date Sampled	Time Sampled	Number of Containers	Preservative				Matrix		Analysis	Sample Instructions
				Unpreserved	HCl	HNO ₃	Other	Groundwater	Soil		
MW01	2/23/09	9:30	3								
MW03	2/23/09	9:50	3								
MW04	2/23/09	10:00	3								
MW07	2/23/09	10:50	3								
MW08	2/23/09	10:55	3								
MW09	2/23/09	11:10	3								
MW11	2/23/09	11:55	3								
MW13	2/23/09	11:45	3								
MW14	2/23/09	12:20	3								
MW15	2/23/09	12:30	3								
Relinquished by: <i>Julia Banks</i>	Date: 2/23/09	Time: 9:30 AM	Received by: <i>JVTD</i>	Date: 2/23/09	Time: 10:55	Temperature Upon Receipt: <input checked="" type="checkbox"/> Same Day <input type="checkbox"/> 24-hr <input type="checkbox"/> 72-hr					

4640 North Pecos Street | Unit C | Denver, Colorado 80211 | Laboratory - 303.433.1322 | Fax - 303.265.9645

Origins Laboratory, Inc.

Noelle E Doyle

Noelle E Doyle, Laboratory Manager

The results in this report apply to the samples analyzed in accordance with the chain of custody document. This analytical report must be reproduced in its entirety.

4640 Pecos Street | Unit C
Denver, Colorado 80211
303.433.1322 | Laboratory
303.265.9645 | Fax



LT Environmental, Inc.
4600 West 60th Avenue
Arvada CO 80003

Matt Vielhaber
Project Number: NEP0826.01
Project: Noble - Becky #2-6

X902081
page 2 of 3

ORIGINS
LABORATORY, INC.

originslaboratory.com

Project Manager: Matt Vielhaber
Project Name: Becky #2-6
Project Number: NEP0826
Samples Collected by: JV/TD

Client: LT Environmental
Address: 4600 W 60th Ave
Arvada, CO 80003
Telephone Number: 303 433 9788
E-Mail Address: mviehaber@ltenv.com

Sample ID - Description	Date Sampled	Time Sampled	Number of Containers	Preservative				Matrix			Analysis	Sample Instructions
				Unpreserved	HCl	HNO ₃	Other -	Groundwater	Soil	Air - Summa Canister #		
MW16	2/21/09	1240	3	X	X	X	X	X	X	X	X	1
MW17	2/21/09	1320	2	X	X	X	X	X	X	X	X	2
MW18	2/21/09	1250	3	X	X	X	X	X	X	X	X	3
MW24	2/21/09	1355	3	X	X	X	X	X	X	X	X	4
MW25	2/21/09	1215	3	X	X	X	X	X	X	X	X	5
MW26	2/21/09	1215	3	X	X	X	X	X	X	X	X	6
MW27	2/21/09	1340	3	X	X	X	X	X	X	X	X	7
MW29	2/21/09	1330	3	X	X	X	X	X	X	X	X	8
MW30	2/21/09	1350	3	X	X	X	X	X	X	X	X	9
MW32	2/21/09	1400	3	X	X	X	X	X	X	X	X	10

Relinquished by: John Ventres Date: 2/23/09 Time: 8:45
Received by: Matt Vielhaber Date: 2/23/09 Time: 16:05

Turn Around Time
Same Day
24-hr
48-hr
72-hr
Standard X

4640 North Pecos Street | Unit C | Denver, Colorado 80211 | Laboratory - 303.433.1322 | Fax - 303.265.9645

Origins Laboratory, Inc.

Noelle E Doyle, Laboratory Manager

The results in this report apply to the samples analyzed in accordance with the chain of custody document. This analytical report must be reproduced in its entirety.

4640 Pecos Street | Unit C
Denver, Colorado 80211
303.433.1322 | Laboratory
303.265.9645 | Fax



LT Environmental, Inc.
4600 West 60th Avenue
Arvada CO 80003

Matt Vielhaber
Project Number: NEP0826.01
Project: Noble - Becky #2-6

originslaboratory.com

Client: LT Environmental
Address: 4600 W 60th Ave
Arvada, CO 80003
Telephone Number: 303 433 9788
E-Mail Address: mviehaber@ltenv.com

Project Manager: Matt Vielhaber
Project Name: Becky #2-6
Project Number: NEP0826
Samples Collected by: JV/TD

page 3 of 3

Sample ID - Description	Date Sampled	Time Sampled	Number of Containers	Preservative				Matrix			Analysis		Sample Instructions
				Unpreserved	HCl	HNO ₃	Other -	Groundwater	Soil	Air - Summa Canister #	Other -		
MW34	2/23/09	1030	3	X				X				X BTEX by 2260	1
													2
													3
													4
													5
													6
													7
													8
													9
													10

Relinquished by:	Date:	Received by:	Date:	Time:	Temperature Upon Receipt:
Jenna Vetter	2/23/09	Origins	2/23/09	16:55	

Turn Around Time:
24-hr
48-hr
72-hr
Standard

4640 North Pecos Street | Unit C | Denver, Colorado 80211 | Laboratory - 303.433.1322 | Fax - 303.265.9645

Origins Laboratory, Inc.

Noelle E Doyle, Laboratory Manager

The results in this report apply to the samples analyzed in accordance with the chain of custody document. This analytical report must be reproduced in its entirety.

4640 Pecos Street | Unit C
Denver, Colorado 80211
303.433.1322 | Laboratory
303.265.9645 | Fax



LT Environmental, Inc.
4600 West 60th Avenue
Arvada CO 80003

Matt Vielhaber
Project Number: NEP0826.01
Project: Noble – Becky #2–6

MW-1
X902081-01 (Water)

Analyte	Result	Reporting		Units	Dilution	Batch	Prepared	Analyzed	Notes
		Limit							

Origins Laboratory, Inc.

BTEX by EPA 8260B

Benzene	ND	0.00100	mg/L	1	9B25002	02/25/2009	02/25/2009
Toluene	ND	0.00100	"	"	"	"	"
Ethylbenzene	ND	0.00100	"	"	"	"	"
o-Xylene	ND	0.00100	"	"	"	"	"
m,p-Xylene	ND	0.00200	"	"	"	"	"

Surrogate: 1,2-Dichloroethane-d4	110 %	70.3-123	"	"	"
Surrogate: Toluene-d8	103 %	75.9-123	"	"	"
Surrogate: 4-Bromofluorobenzene	101 %	83-123	"	"	"

Origins Laboratory, Inc.

Noelle E Doyle, Laboratory Manager

The results in this report apply to the samples analyzed in accordance with the chain of custody document. This analytical report must be reproduced in its entirety.

4640 Pecos Street | Unit C
Denver, Colorado 80211
303.433.1322 | Laboratory
303.265.9645 | Fax



LT Environmental, Inc.
4600 West 60th Avenue
Arvada CO 80003

Matt Vielhaber
Project Number: NEP0826.01
Project: Noble – Becky #2–6

MW-3
X902081-02 (Water)

Analyte	Result	Reporting		Units	Dilution	Batch	Prepared	Analyzed	Notes
		Limit							

Origins Laboratory, Inc.

BTEX by EPA 8260B

Benzene	ND	0.00100	mg/L	1	9B25002	02/25/2009	02/25/2009
Toluene	ND	0.00100	"	"	"	"	"
Ethylbenzene	ND	0.00100	"	"	"	"	"
o-Xylene	ND	0.00100	"	"	"	"	"
m,p-Xylene	ND	0.00200	"	"	"	"	"

Surrogate: 1,2-Dichloroethane-d4	112 %	70.3-123	"	"	"
Surrogate: Toluene-d8	101 %	75.9-123	"	"	"
Surrogate: 4-Bromofluorobenzene	101 %	83-123	"	"	"

Origins Laboratory, Inc.

Noelle E Doyle, Laboratory Manager

The results in this report apply to the samples analyzed in accordance with the chain of custody document. This analytical report must be reproduced in its entirety.

4640 Pecos Street | Unit C
Denver, Colorado 80211
303.433.1322 | Laboratory
303.265.9645 | Fax



LT Environmental, Inc.
4600 West 60th Avenue
Arvada CO 80003

Matt Vielhaber
Project Number: NEP0826.01
Project: Noble – Becky #2-6

MW-4

X902081-03 (Water)

Analyte	Result	Reporting		Units	Dilution	Batch	Prepared	Analyzed	Notes
		Limit							

Origins Laboratory, Inc.

BTEX by EPA 8260B

Benzene	ND	0.00100	mg/L	1	9B25002	02/25/2009	02/25/2009
Toluene	ND	0.00100	"	"	"	"	"
Ethylbenzene	ND	0.00100	"	"	"	"	"
o-Xylene	ND	0.00100	"	"	"	"	"
m,p-Xylene	ND	0.00200	"	"	"	"	"

Surrogate: 1,2-Dichloroethane-d4	113 %	70.3-123	"	"	"
Surrogate: Toluene-d8	101 %	75.9-123	"	"	"
Surrogate: 4-Bromofluorobenzene	107 %	83-123	"	"	"

Origins Laboratory, Inc.

The results in this report apply to the samples analyzed in accordance with the chain of custody document. This analytical report must be reproduced in its entirety.

Noelle E Doyle, Laboratory Manager

4640 Pecos Street | Unit C
Denver, Colorado 80211
303.433.1322 | Laboratory
303.265.9645 | Fax



LT Environmental, Inc.
4600 West 60th Avenue
Arvada CO 80003

Matt Vielhaber
Project Number: NEP0826.01
Project: Noble – Becky #2-6

MW-7

X902081-04 (Water)

Analyte	Result	Reporting		Units	Dilution	Batch	Prepared	Analyzed	Notes
		Limit							

Origins Laboratory, Inc.

BTEX by EPA 8260B

Benzene	0.00503	0.00100	mg/L	1	9B25002	02/25/2009	02/26/2009
Toluene	ND	0.00100	"	"	"	"	"
Ethylbenzene	0.00904	0.00100	"	"	"	"	"
o-Xylene	ND	0.00100	"	"	"	"	"
m,p-Xylene	0.141	0.00200	"	"	"	"	"

Surrogate: 1,2-Dichloroethane-d4	120 %	70.3-123	"	"	"
Surrogate: Toluene-d8	93.4 %	75.9-123	"	"	"
Surrogate: 4-Bromofluorobenzene	118 %	83-123	"	"	"

Origins Laboratory, Inc.

The results in this report apply to the samples analyzed in accordance with the chain of custody document. This analytical report must be reproduced in its entirety.

Noelle E Doyle, Laboratory Manager

4640 Pecos Street | Unit C
Denver, Colorado 80211
303.433.1322 | Laboratory
303.265.9645 | Fax



LT Environmental, Inc.
4600 West 60th Avenue
Arvada CO 80003

Matt Vielhaber
Project Number: NEP0826.01
Project: Noble – Becky #2–6

MW-8

X902081-05 (Water)

Analyte	Result	Reporting		Units	Dilution	Batch	Prepared	Analyzed	Notes
		Limit							

Origins Laboratory, Inc.

BTEX by EPA 8260B

Benzene	ND	0.00100	mg/L	1	9B25002	02/25/2009	02/26/2009
Toluene	ND	0.00100	"	"	"	"	"
Ethylbenzene	ND	0.00100	"	"	"	"	"
o-Xylene	ND	0.00100	"	"	"	"	"
m,p-Xylene	ND	0.00200	"	"	"	"	"

Surrogate: 1,2-Dichloroethane-d4	112 %	70.3-123	"	"	"
Surrogate: Toluene-d8	104 %	75.9-123	"	"	"
Surrogate: 4-Bromofluorobenzene	101 %	83-123	"	"	"

Origins Laboratory, Inc.

The results in this report apply to the samples analyzed in accordance with the chain of custody document. This analytical report must be reproduced in its entirety.

Noelle E Doyle, Laboratory Manager

4640 Pecos Street | Unit C
Denver, Colorado 80211
303.433.1322 | Laboratory
303.265.9645 | Fax



LT Environmental, Inc.
4600 West 60th Avenue
Arvada CO 80003

Matt Vielhaber
Project Number: NEP0826.01
Project: Noble – Becky #2-6

MW-9

X902081-06 (Water)

Analyte	Result	Reporting		Units	Dilution	Batch	Prepared	Analyzed	Notes
		Limit							

Origins Laboratory, Inc.

BTEX by EPA 8260B

Benzene	0.0128	0.00100	mg/L	1	9B25002	02/25/2009	02/26/2009
Toluene	ND	0.00100	"	"	"	"	"
Ethylbenzene	0.00156	0.00100	"	"	"	"	"
o-Xylene	ND	0.00100	"	"	"	"	"
m,p-Xylene	0.00370	0.00200	"	"	"	"	"

Surrogate: 1,2-Dichloroethane-d4	114 %	70.3-123	"	"	"
Surrogate: Toluene-d8	98.9 %	75.9-123	"	"	"
Surrogate: 4-Bromofluorobenzene	108 %	83-123	"	"	"

Origins Laboratory, Inc.

The results in this report apply to the samples analyzed in accordance with the chain of custody document. This analytical report must be reproduced in its entirety.

Noelle E Doyle, Laboratory Manager

4640 Pecos Street | Unit C
Denver, Colorado 80211
303.433.1322 | Laboratory
303.265.9645 | Fax



LT Environmental, Inc.
4600 West 60th Avenue
Arvada CO 80003

Matt Vielhaber
Project Number: NEP0826.01
Project: Noble – Becky #2-6

MW-11
X902081-07 (Water)

Analyte	Result	Reporting		Units	Dilution	Batch	Prepared	Analyzed	Notes
		Limit							

Origins Laboratory, Inc.

BTEX by EPA 8260B

Benzene	ND	0.00100	mg/L	1	9B25002	02/25/2009	02/26/2009
Toluene	ND	0.00100	"	"	"	"	"
Ethylbenzene	ND	0.00100	"	"	"	"	"
o-Xylene	ND	0.00100	"	"	"	"	"
m,p-Xylene	ND	0.00200	"	"	"	"	"

Surrogate: 1,2-Dichloroethane-d4	111 %	70.3-123	"	"	"
Surrogate: Toluene-d8	99.9 %	75.9-123	"	"	"
Surrogate: 4-Bromofluorobenzene	105 %	83-123	"	"	"

Origins Laboratory, Inc.

The results in this report apply to the samples analyzed in accordance with the chain of custody document. This analytical report must be reproduced in its entirety.

Noelle E Doyle, Laboratory Manager

4640 Pecos Street | Unit C
Denver, Colorado 80211
303.433.1322 | Laboratory
303.265.9645 | Fax



LT Environmental, Inc.
4600 West 60th Avenue
Arvada CO 80003

Matt Vielhaber
Project Number: NEP0826.01
Project: Noble – Becky #2-6

MW-13

X902081-08 (Water)

Analyte	Result	Reporting		Units	Dilution	Batch	Prepared	Analyzed	Notes
		Limit							

Origins Laboratory, Inc.

BTEX by EPA 8260B

Benzene	0.390	0.0100	mg/L	10	9B25002	02/25/2009	02/26/2009
Toluene	ND	0.00100	"	1	"	"	02/26/2009
Ethylbenzene	0.0267	0.0100	"	10	"	"	02/26/2009
o-Xylene	ND	0.00100	"	1	"	"	02/26/2009
m,p-Xylene	0.0865	0.0200	"	10	"	"	02/26/2009

Surrogate: 1,2-Dichloroethane-d4	113 %	70.3-123	"	"	"
Surrogate: Toluene-d8	99.6 %	75.9-123	"	"	"
Surrogate: 4-Bromofluorobenzene	104 %	83-123	"	"	"

Origins Laboratory, Inc.

The results in this report apply to the samples analyzed in accordance with the chain of custody document. This analytical report must be reproduced in its entirety.

Noelle E Doyle, Laboratory Manager

4640 Pecos Street | Unit C
Denver, Colorado 80211
303.433.1322 | Laboratory
303.265.9645 | Fax



LT Environmental, Inc.
4600 West 60th Avenue
Arvada CO 80003

Matt Vielhaber
Project Number: NEP0826.01
Project: Noble – Becky #2–6

MW-14
X902081-09 (Water)

Analyte	Result	Reporting		Units	Dilution	Batch	Prepared	Analyzed	Notes
		Limit							

Origins Laboratory, Inc.

BTEX by EPA 8260B

Benzene	ND	0.00100	mg/L	1	9B25002	02/25/2009	02/26/2009
Toluene	ND	0.00100	"	"	"	"	"
Ethylbenzene	ND	0.00100	"	"	"	"	"
o-Xylene	ND	0.00100	"	"	"	"	"
m,p-Xylene	ND	0.00200	"	"	"	"	"

Surrogate: 1,2-Dichloroethane-d4	115 %	70.3-123	"	"	"
Surrogate: Toluene-d8	99.6 %	75.9-123	"	"	"
Surrogate: 4-Bromofluorobenzene	114 %	83-123	"	"	"

Origins Laboratory, Inc.

The results in this report apply to the samples analyzed in accordance with the chain of custody document. This analytical report must be reproduced in its entirety.

Noelle E Doyle, Laboratory Manager

4640 Pecos Street | Unit C
Denver, Colorado 80211
303.433.1322 | Laboratory
303.265.9645 | Fax



LT Environmental, Inc.
4600 West 60th Avenue
Arvada CO 80003

Matt Vielhaber
Project Number: NEP0826.01
Project: Noble – Becky #2–6

MW-15
X902081-10 (Water)

Analyte	Result	Reporting		Units	Dilution	Batch	Prepared	Analyzed	Notes
		Limit							

Origins Laboratory, Inc.

BTEX by EPA 8260B

Benzene	ND	0.00100	mg/L	1	9B25002	02/25/2009	02/26/2009
Toluene	ND	0.00100	"	"	"	"	"
Ethylbenzene	ND	0.00100	"	"	"	"	"
o-Xylene	ND	0.00100	"	"	"	"	"
m,p-Xylene	ND	0.00200	"	"	"	"	"

Surrogate: 1,2-Dichloroethane-d4	113 %	70.3-123	"	"	"
Surrogate: Toluene-d8	100 %	75.9-123	"	"	"
Surrogate: 4-Bromofluorobenzene	103 %	83-123	"	"	"

Origins Laboratory, Inc.

The results in this report apply to the samples analyzed in accordance with the chain of custody document. This analytical report must be reproduced in its entirety.

Noelle E Doyle, Laboratory Manager

4640 Pecos Street | Unit C
Denver, Colorado 80211
303.433.1322 | Laboratory
303.265.9645 | Fax



LT Environmental, Inc.
4600 West 60th Avenue
Arvada CO 80003

Matt Vielhaber
Project Number: NEP0826.01
Project: Noble – Becky #2-6

MW-16
X902081-11 (Water)

Analyte	Result	Reporting		Units	Dilution	Batch	Prepared	Analyzed	Notes
		Limit							

Origins Laboratory, Inc.

BTEX by EPA 8260B

Benzene	ND	0.00100	mg/L	1	9B25002	02/25/2009	02/26/2009
Toluene	ND	0.00100	"	"	"	"	"
Ethylbenzene	0.00912	0.00100	"	"	"	"	"
o-Xylene	ND	0.00100	"	"	"	"	"
m,p-Xylene	0.0890	0.00200	"	"	"	"	"

Surrogate: 1,2-Dichloroethane-d4	114 %	70.3-123	"	"	"
Surrogate: Toluene-d8	100 %	75.9-123	"	"	"
Surrogate: 4-Bromofluorobenzene	112 %	83-123	"	"	"

Origins Laboratory, Inc.

The results in this report apply to the samples analyzed in accordance with the chain of custody document. This analytical report must be reproduced in its entirety.

Noelle E Doyle, Laboratory Manager

4640 Pecos Street | Unit C
Denver, Colorado 80211
303.433.1322 | Laboratory
303.265.9645 | Fax



LT Environmental, Inc.
4600 West 60th Avenue
Arvada CO 80003

Matt Vielhaber
Project Number: NEP0826.01
Project: Noble – Becky #2–6

MW-17
X902081-12 (Water)

Analyte	Result	Reporting		Units	Dilution	Batch	Prepared	Analyzed	Notes
		Limit							

Origins Laboratory, Inc.

BTEX by EPA 8260B

Benzene	ND	0.00100	mg/L	1	9B25002	02/25/2009	02/26/2009
Toluene	ND	0.00100	"	"	"	"	"
Ethylbenzene	ND	0.00100	"	"	"	"	"
o-Xylene	ND	0.00100	"	"	"	"	"
m,p-Xylene	ND	0.00200	"	"	"	"	"

Surrogate: 1,2-Dichloroethane-d4	110 %	70.3-123	"	"	"
Surrogate: Toluene-d8	102 %	75.9-123	"	"	"
Surrogate: 4-Bromofluorobenzene	103 %	83-123	"	"	"

Origins Laboratory, Inc.

The results in this report apply to the samples analyzed in accordance with the chain of custody document. This analytical report must be reproduced in its entirety.

Noelle E Doyle, Laboratory Manager

4640 Pecos Street | Unit C
Denver, Colorado 80211
303.433.1322 | Laboratory
303.265.9645 | Fax



LT Environmental, Inc.
4600 West 60th Avenue
Arvada CO 80003

Matt Vielhaber
Project Number: NEP0826.01
Project: Noble – Becky #2–6

MW-18
X902081-13 (Water)

Analyte	Result	Reporting		Units	Dilution	Batch	Prepared	Analyzed	Notes
		Limit							

Origins Laboratory, Inc.

BTEX by EPA 8260B

Benzene	ND	0.00100	mg/L	1	9B25002	02/25/2009	02/26/2009
Toluene	ND	0.00100	"	"	"	"	"
Ethylbenzene	ND	0.00100	"	"	"	"	"
o-Xylene	ND	0.00100	"	"	"	"	"
m,p-Xylene	ND	0.00200	"	"	"	"	"

Surrogate: 1,2-Dichloroethane-d4	111 %	70.3-123	"	"	"
Surrogate: Toluene-d8	102 %	75.9-123	"	"	"
Surrogate: 4-Bromofluorobenzene	108 %	83-123	"	"	"

Origins Laboratory, Inc.

The results in this report apply to the samples analyzed in accordance with the chain of custody document. This analytical report must be reproduced in its entirety.

Noelle E Doyle, Laboratory Manager

4640 Pecos Street | Unit C
Denver, Colorado 80211
303.433.1322 | Laboratory
303.265.9645 | Fax



LT Environmental, Inc.
4600 West 60th Avenue
Arvada CO 80003

Matt Vielhaber
Project Number: NEP0826.01
Project: Noble – Becky #2-6

MW-24
X902081-14 (Water)

Analyte	Result	Reporting		Units	Dilution	Batch	Prepared	Analyzed	Notes
		Limit							

Origins Laboratory, Inc.

BTEX by EPA 8260B

Benzene	ND	0.00100	mg/L	1	9B25002	02/25/2009	02/26/2009
Toluene	ND	0.00100	"	"	"	"	"
Ethylbenzene	ND	0.00100	"	"	"	"	"
o-Xylene	ND	0.00100	"	"	"	"	"
m,p-Xylene	ND	0.00200	"	"	"	"	"

Surrogate: 1,2-Dichloroethane-d4	111 %	70.3-123	"	"	"
Surrogate: Toluene-d8	102 %	75.9-123	"	"	"
Surrogate: 4-Bromofluorobenzene	102 %	83-123	"	"	"

Origins Laboratory, Inc.

The results in this report apply to the samples analyzed in accordance with the chain of custody document. This analytical report must be reproduced in its entirety.

Noelle E Doyle, Laboratory Manager

4640 Pecos Street | Unit C
Denver, Colorado 80211
303.433.1322 | Laboratory
303.265.9645 | Fax



LT Environmental, Inc.
4600 West 60th Avenue
Arvada CO 80003

Matt Vielhaber
Project Number: NEP0826.01
Project: Noble – Becky #2–6

MW-25
X902081-15 (Water)

Analyte	Result	Reporting		Units	Dilution	Batch	Prepared	Analyzed	Notes
		Limit							

Origins Laboratory, Inc.

BTEX by EPA 8260B

Benzene	0.0203	0.00100	mg/L	1	9B25002	02/25/2009	02/26/2009
Toluene	ND	0.00100	"	"	"	"	"
Ethylbenzene	0.00164	0.00100	"	"	"	"	"
o-Xylene	ND	0.00100	"	"	"	"	"
m,p-Xylene	0.00386	0.00200	"	"	"	"	"

Surrogate: 1,2-Dichloroethane-d4	112 %	70.3-123	"	"	"
Surrogate: Toluene-d8	102 %	75.9-123	"	"	"
Surrogate: 4-Bromofluorobenzene	102 %	83-123	"	"	"

Origins Laboratory, Inc.

The results in this report apply to the samples analyzed in accordance with the chain of custody document. This analytical report must be reproduced in its entirety.

Noelle E Doyle, Laboratory Manager

4640 Pecos Street | Unit C
Denver, Colorado 80211
303.433.1322 | Laboratory
303.265.9645 | Fax



LT Environmental, Inc.
4600 West 60th Avenue
Arvada CO 80003

Matt Vielhaber
Project Number: NEP0826.01
Project: Noble – Becky #2-6

MW-26
X902081-16 (Water)

Analyte	Result	Reporting		Units	Dilution	Batch	Prepared	Analyzed	Notes
		Limit							

Origins Laboratory, Inc.

BTEX by EPA 8260B

Benzene	ND	0.00100	mg/L	1	9B25002	02/25/2009	02/26/2009
Toluene	ND	0.00100	"	"	"	"	"
Ethylbenzene	ND	0.00100	"	"	"	"	"
o-Xylene	ND	0.00100	"	"	"	"	"
m,p-Xylene	ND	0.00200	"	"	"	"	"

Surrogate: 1,2-Dichloroethane-d4	114 %	70.3-123	"	"	"
Surrogate: Toluene-d8	101 %	75.9-123	"	"	"
Surrogate: 4-Bromofluorobenzene	106 %	83-123	"	"	"

Origins Laboratory, Inc.

The results in this report apply to the samples analyzed in accordance with the chain of custody document. This analytical report must be reproduced in its entirety.

Noelle E Doyle, Laboratory Manager

4640 Pecos Street | Unit C
Denver, Colorado 80211
303.433.1322 | Laboratory
303.265.9645 | Fax



LT Environmental, Inc.
4600 West 60th Avenue
Arvada CO 80003

Matt Vielhaber
Project Number: NEP0826.01
Project: Noble – Becky #2–6

MW-27
X902081-17 (Water)

Analyte	Result	Reporting		Units	Dilution	Batch	Prepared	Analyzed	Notes
		Limit							

Origins Laboratory, Inc.

BTEX by EPA 8260B

Benzene	ND	0.00100	mg/L	1	9B25002	02/25/2009	02/26/2009
Toluene	ND	0.00100	"	"	"	"	"
Ethylbenzene	ND	0.00100	"	"	"	"	"
o-Xylene	ND	0.00100	"	"	"	"	"
m,p-Xylene	ND	0.00200	"	"	"	"	"

Surrogate: 1,2-Dichloroethane-d4	115 %	70.3-123	"	"	"
Surrogate: Toluene-d8	98.7 %	75.9-123	"	"	"
Surrogate: 4-Bromofluorobenzene	104 %	83-123	"	"	"

Origins Laboratory, Inc.

The results in this report apply to the samples analyzed in accordance with the chain of custody document. This analytical report must be reproduced in its entirety.

Noelle E Doyle, Laboratory Manager

4640 Pecos Street | Unit C
Denver, Colorado 80211
303.433.1322 | Laboratory
303.265.9645 | Fax



LT Environmental, Inc.
4600 West 60th Avenue
Arvada CO 80003

Matt Vielhaber
Project Number: NEP0826.01
Project: Noble – Becky #2-6

MW-29
X902081-18 (Water)

Analyte	Result	Reporting		Units	Dilution	Batch	Prepared	Analyzed	Notes
		Limit							

Origins Laboratory, Inc.

BTEX by EPA 8260B

Benzene	ND	0.00100	mg/L	1	9B25002	02/25/2009	02/26/2009
Toluene	ND	0.00100	"	"	"	"	"
Ethylbenzene	0.00418	0.00100	"	"	"	"	"
o-Xylene	ND	0.00100	"	"	"	"	"
m,p-Xylene	0.00523	0.00200	"	"	"	"	"

Surrogate: 1,2-Dichloroethane-d4	114 %	70.3-123	"	"	"
Surrogate: Toluene-d8	99.0 %	75.9-123	"	"	"
Surrogate: 4-Bromofluorobenzene	104 %	83-123	"	"	"

Origins Laboratory, Inc.

The results in this report apply to the samples analyzed in accordance with the chain of custody document. This analytical report must be reproduced in its entirety.

Noelle E Doyle, Laboratory Manager

4640 Pecos Street | Unit C
Denver, Colorado 80211
303.433.1322 | Laboratory
303.265.9645 | Fax



LT Environmental, Inc.
4600 West 60th Avenue
Arvada CO 80003

Matt Vielhaber
Project Number: NEP0826.01
Project: Noble – Becky #2–6

MW-30
X902081-19 (Water)

Analyte	Result	Reporting		Units	Dilution	Batch	Prepared	Analyzed	Notes
		Limit							

Origins Laboratory, Inc.

BTEX by EPA 8260B

Benzene	ND	0.00100	mg/L	1	9B25002	02/25/2009	02/26/2009
Toluene	ND	0.00100	"	"	"	"	"
Ethylbenzene	ND	0.00100	"	"	"	"	"
o-Xylene	ND	0.00100	"	"	"	"	"
m,p-Xylene	ND	0.00200	"	"	"	"	"

Surrogate: 1,2-Dichloroethane-d4	115 %	70.3-123	"	"	"
Surrogate: Toluene-d8	99.1 %	75.9-123	"	"	"
Surrogate: 4-Bromofluorobenzene	105 %	83-123	"	"	"

Origins Laboratory, Inc.

The results in this report apply to the samples analyzed in accordance with the chain of custody document. This analytical report must be reproduced in its entirety.

Noelle E Doyle, Laboratory Manager

4640 Pecos Street | Unit C
Denver, Colorado 80211
303.433.1322 | Laboratory
303.265.9645 | Fax



LT Environmental, Inc.
4600 West 60th Avenue
Arvada CO 80003

Matt Vielhaber
Project Number: NEP0826.01
Project: Noble – Becky #2–6

MW-32
X902081–20 (Water)

Analyte	Result	Reporting		Units	Dilution	Batch	Prepared	Analyzed	Notes
		Limit							

Origins Laboratory, Inc.

BTEX by EPA 8260B

Benzene	ND	0.00100	mg/L	1	9B25002	02/25/2009	02/26/2009
Toluene	ND	0.00100	"	"	"	"	"
Ethylbenzene	ND	0.00100	"	"	"	"	"
o-Xylene	ND	0.00100	"	"	"	"	"
m,p-Xylene	ND	0.00200	"	"	"	"	"

Surrogate: 1,2-Dichloroethane-d4	118 %	70.3–123	"	"	"
Surrogate: Toluene-d8	100 %	75.9–123	"	"	"
Surrogate: 4-Bromofluorobenzene	101 %	83–123	"	"	"

Origins Laboratory, Inc.

The results in this report apply to the samples analyzed in accordance with the chain of custody document. This analytical report must be reproduced in its entirety.

Noelle E Doyle, Laboratory Manager

4640 Pecos Street | Unit C
Denver, Colorado 80211
303.433.1322 | Laboratory
303.265.9645 | Fax



LT Environmental, Inc.
4600 West 60th Avenue
Arvada CO 80003

Matt Vielhaber
Project Number: NEP0826.01
Project: Noble – Becky #2–6

MW-34

X902081–21 (Water)

Analyte	Result	Reporting		Units	Dilution	Batch	Prepared	Analyzed	Notes
		Limit							

Origins Laboratory, Inc.

BTEX by EPA 8260B

Benzene	ND	0.00100	mg/L	1	9B25002	02/25/2009	02/26/2009
Toluene	ND	0.00100	"	"	"	"	"
Ethylbenzene	ND	0.00100	"	"	"	"	"
o-Xylene	ND	0.00100	"	"	"	"	"
m,p-Xylene	ND	0.00200	"	"	"	"	"

Surrogate: 1,2-Dichloroethane-d4	114 %	70.3–123	"	"	"
Surrogate: Toluene-d8	98.8 %	75.9–123	"	"	"
Surrogate: 4-Bromofluorobenzene	108 %	83–123	"	"	"

Origins Laboratory, Inc.

The results in this report apply to the samples analyzed in accordance with the chain of custody document. This analytical report must be reproduced in its entirety.

Noelle E Doyle, Laboratory Manager



LT Environmental, Inc.
 4600 West 60th Avenue
 Arvada CO 80003

Matt Vielhaber
 Project Number: NEP0826.01
 Project: Noble – Becky #2-6

Volatile Organic Compounds by EPA Method 8260B – Quality Control
Origins Laboratory, Inc.

Analyte	Result	Reporting Limit	Units	Spike Level	Source Result	%REC	%REC Limits	RPD	RPD Limit	Notes
---------	--------	-----------------	-------	-------------	---------------	------	-------------	-----	-----------	-------

Batch 9B25002 – EPA 5030B

Blank (9B25002-BLK1)

Prepared: 02/25/2009 Analyzed: 02/25/2009

Benzene	ND	0.001	mg/L							
Toluene	ND	0.001	"							
Ethylbenzene	ND	0.001	"							
o-Xylene	ND	0.001	"							
m,p-Xylene	ND	0.002	"							
Surrogate: 1,2-Dichloroethane-d4	63.4		ug/L	62.5		101	70.3-123			
Surrogate: Toluene-d8	67.0		"	62.5		107	75.9-123			
Surrogate: 4-Bromofluorobenzene	61.5		"	62.5		98.4	83-123			

Blank (9B25002-BLK2)

Prepared: 02/25/2009 Analyzed: 02/25/2009

Benzene	ND	0.001	mg/L							
Toluene	ND	0.001	"							
Ethylbenzene	ND	0.001	"							
o-Xylene	ND	0.001	"							
m,p-Xylene	ND	0.002	"							
Surrogate: 1,2-Dichloroethane-d4	65.9		ug/L	62.5		105	70.3-123			
Surrogate: Toluene-d8	65.7		"	62.5		105	75.9-123			
Surrogate: 4-Bromofluorobenzene	63.2		"	62.5		101	83-123			

LCS (9B25002-BS1)

Prepared: 02/25/2009 Analyzed: 02/25/2009

Benzene	0.06	0.001	mg/L	0.0500		112	64.2-124			
Toluene	0.06	0.001	"	0.0500		112	63.9-119			
Surrogate: 1,2-Dichloroethane-d4	66.3		ug/L	62.5		106	70.3-123			
Surrogate: Toluene-d8	64.7		"	62.5		104	75.9-123			
Surrogate: 4-Bromofluorobenzene	61.9		"	62.5		99.0	83-123			

LCS (9B25002-BS2)

Prepared: 02/25/2009 Analyzed: 02/25/2009

Benzene	0.06	0.001	mg/L	0.0500		112	64.2-124			
Toluene	0.06	0.001	"	0.0500		111	63.9-119			

Origins Laboratory, Inc.

The results in this report apply to the samples analyzed in accordance with the chain of custody document. This analytical report must be reproduced in its entirety.

Noelle E Doyle, Laboratory Manager



LT Environmental, Inc.
 4600 West 60th Avenue
 Arvada CO 80003

Matt Vielhaber
 Project Number: NEP0826.01
 Project: Noble – Becky #2-6

Volatile Organic Compounds by EPA Method 8260B – Quality Control
Origins Laboratory, Inc.

Analyte	Result	Reporting Limit	Units	Spike Level	Source Result	%REC	%REC Limits	RPD	RPD Limit	Notes
Batch 9B25002 – EPA 5030B										
LCS (9B25002-BS2)					Prepared: 02/25/2009 Analyzed: 02/25/2009					
Surrogate: 1,2-Dichloroethane-d4	68.7		ug/L	62.5		110	70.3-123			
Surrogate: Toluene-d8	64.8		"	62.5		104	75.9-123			
Surrogate: 4-Bromofluorobenzene	61.3		"	62.5		98.1	83-123			
Matrix Spike (9B25002-MS1)					Source: X902065-03 Prepared: 02/25/2009 Analyzed: 02/25/2009					
Benzene	0.05	0.001	mg/L	0.0500	ND	109	64.2-124			
Toluene	0.05	0.001	"	0.0500	ND	107	63.9-119			
Surrogate: 1,2-Dichloroethane-d4	68.3		ug/L	62.5		109	70.3-123			
Surrogate: Toluene-d8	64.1		"	62.5		103	75.9-123			
Surrogate: 4-Bromofluorobenzene	61.8		"	62.5		98.9	83-123			
Matrix Spike (9B25002-MS2)					Source: X902065-05 Prepared: 02/25/2009 Analyzed: 02/25/2009					
Benzene	0.13	0.001	mg/L	0.0500	0.07	109	64.2-124			
Toluene	0.05	0.001	"	0.0500	0.001	105	63.9-119			
Surrogate: 1,2-Dichloroethane-d4	67.2		ug/L	62.5		108	70.3-123			
Surrogate: Toluene-d8	64.1		"	62.5		103	75.9-123			
Surrogate: 4-Bromofluorobenzene	68.8		"	62.5		110	83-123			
Matrix Spike Dup (9B25002-MSD1)					Source: X902065-03 Prepared: 02/25/2009 Analyzed: 02/25/2009					
Benzene	0.05	0.001	mg/L	0.0500	ND	107	64.2-124	1.72	25	
Toluene	0.05	0.001	"	0.0500	ND	108	63.9-119	1.43	25	
Surrogate: 1,2-Dichloroethane-d4	67.0		ug/L	62.5		107	70.3-123			
Surrogate: Toluene-d8	65.1		"	62.5		104	75.9-123			
Surrogate: 4-Bromofluorobenzene	61.6		"	62.5		98.6	83-123			
Matrix Spike Dup (9B25002-MSD2)					Source: X902065-05 Prepared: 02/25/2009 Analyzed: 02/25/2009					
Benzene	0.13	0.001	mg/L	0.0500	0.07	107	64.2-124	0.663	25	
Toluene	0.05	0.001	"	0.0500	0.001	107	63.9-119	1.30	25	
Surrogate: 1,2-Dichloroethane-d4	65.7		ug/L	62.5		105	70.3-123			

Origins Laboratory, Inc.

The results in this report apply to the samples analyzed in accordance with the chain of custody document. This analytical report must be reproduced in its entirety.

Noelle E Doyle, Laboratory Manager

4640 Pecos Street | Unit C
Denver, Colorado 80211
303.433.1322 | Laboratory
303.265.9645 | Fax



LT Environmental, Inc.
4600 West 60th Avenue
Arvada CO 80003

Matt Vielhaber
Project Number: NEP0826.01
Project: Noble – Becky #2–6

Volatile Organic Compounds by EPA Method 8260B – Quality Control
Origins Laboratory, Inc.

Analyte	Result	Reporting Limit	Units	Spike Level	Source Result	%REC	%REC Limits	RPD	RPD Limit	Notes
---------	--------	--------------------	-------	----------------	------------------	------	----------------	-----	--------------	-------

Batch 9B25002 – EPA 5030B

Matrix Spike Dup (9B25002–MSD2)

Source: X902065–05

Prepared: 02/25/2009 Analyzed: 02/25/2009

Surrogate: Toluene-d8	64.5	ug/L	62.5	103	75.9–123
Surrogate: 4–Bromofluorobenzene	69.3	"	62.5	111	83–123

Origins Laboratory, Inc.

Noelle E Doyle, Laboratory Manager

*The results in this report apply to the samples analyzed
in accordance with the chain of custody document. This
analytical report must be reproduced in its entirety.*

4640 Pecos Street | Unit C
Denver, Colorado 80211
303.433.1322 | Laboratory
303.265.9645 | Fax



LT Environmental, Inc.
4600 West 60th Avenue
Arvada CO 80003

Matt Vielhaber
Project Number: NEP0826.01
Project: Noble – Becky #2–6

Notes and Definitions

ND Analyte NOT DETECTED at or above the reporting limit
RPD Relative Percent Difference

Origins Laboratory, Inc.

The results in this report apply to the samples analyzed in accordance with the chain of custody document. This analytical report must be reproduced in its entirety.

Noelle E Doyle, Laboratory Manager