

VISIBLE IMPROVEMENTS LAJCO NE-17 MULTI-WELL PAD

SECTION: 17
TOWNSHIP: 4N
RANGE: 67W

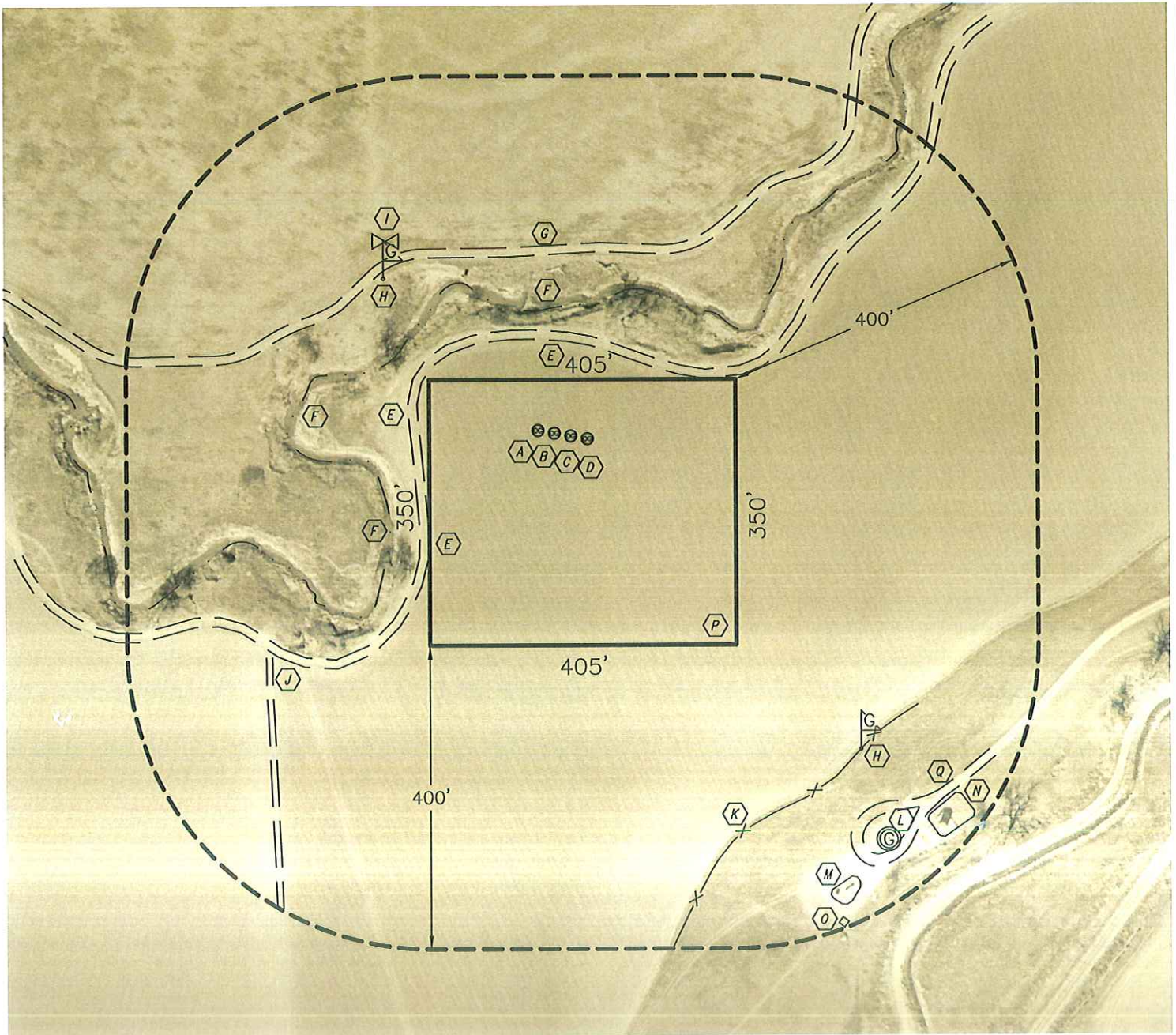

IMPROVEMENTS:

- | | |
|--|--|
| (A) LAJCO 17ND | (L) EX WELL-COMING 17-3 685'SE |
| (B) LAJCO 17C | (M) FENCE AROUND SEPARATORS & METER HOUSE 696'SE |
| (C) LAJCO 17RD | (N) FENCE AROUND TANK BATTERY 699'SE |
| (D) LAJCO 17SD | (O) BURNER 736'SE |
| (E) DIRT ROAD 130'N, 197'W, 220'SW | (P) DISTURBED AREA |
| (F) LITTLE THOMPSON RIVER 173'N, 365'W, 261'SW | (Q) GRAVEL ROAD 688'SE |
| (G) DIRT ROAD 243'N | |
| (H) GAS MARKER 314'NW, 572'SE | |
| (I) IRRIGATION VALVE 347'NW | |
| (J) DIRT ROAD 488'SW | |
| (K) BARBED-WIRE FENCE 572'SE | |

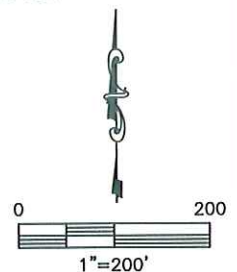

PROJECT#: 2010132