

# LOCATION DRAWING

Steil Surveying Services, LLC

1102 West 19th Street P.O. BOX 2073

Cheyenne, Wyoming 82009

VISIBLE IMPROVEMENTS

THIS MAP DOES NOT REPRESENT A BOUNDARY SURVEY

DATE: 06/15/2010

SECTION 16  
TOWNSHIP 7 NORTH  
RANGE 64 WEST

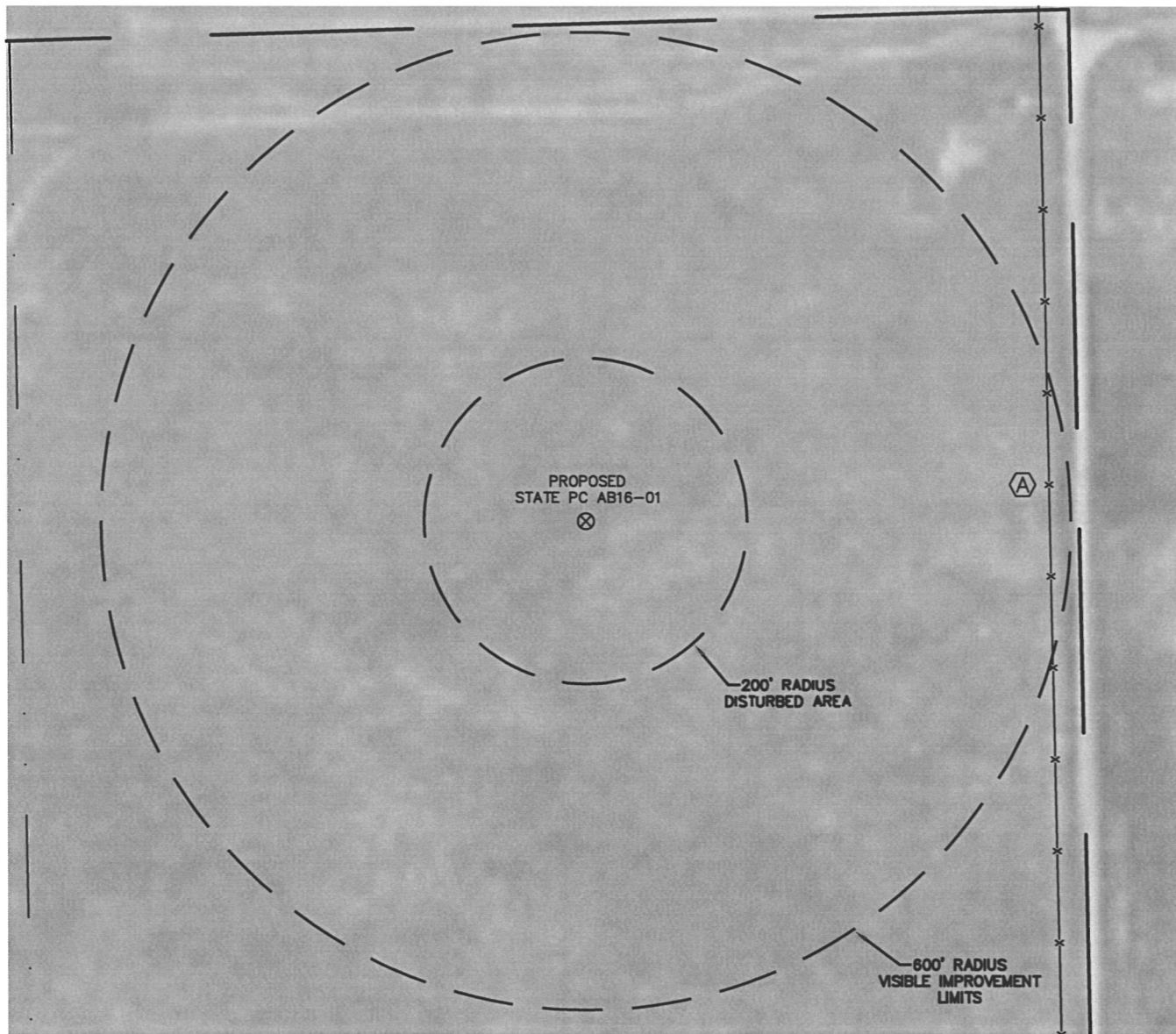

## IMPROVEMENTS:



BARBED WIRE FENCE - 574' EAST

THE NEAREST OVERHEAD POWER LINE IS 5900' NORTH.

NOTICE: According to Colorado law you MUST commence any legal action based upon any defect in this W.L.C. within three years after you first discover such defect. In no event may any action based upon any defect in this W.L.C. be commenced more than ten years from this sold date of the certification shown hereon.



0 200

Scale: 1" = 200'