

HYDROLOGY MAP  
BUCKSHOT 36-9-64

THERE IS NO SURFACE  
WATER OR WATER WELLS  
WITHIN 1,000' OF THE  
DISTURBED PERIMETER

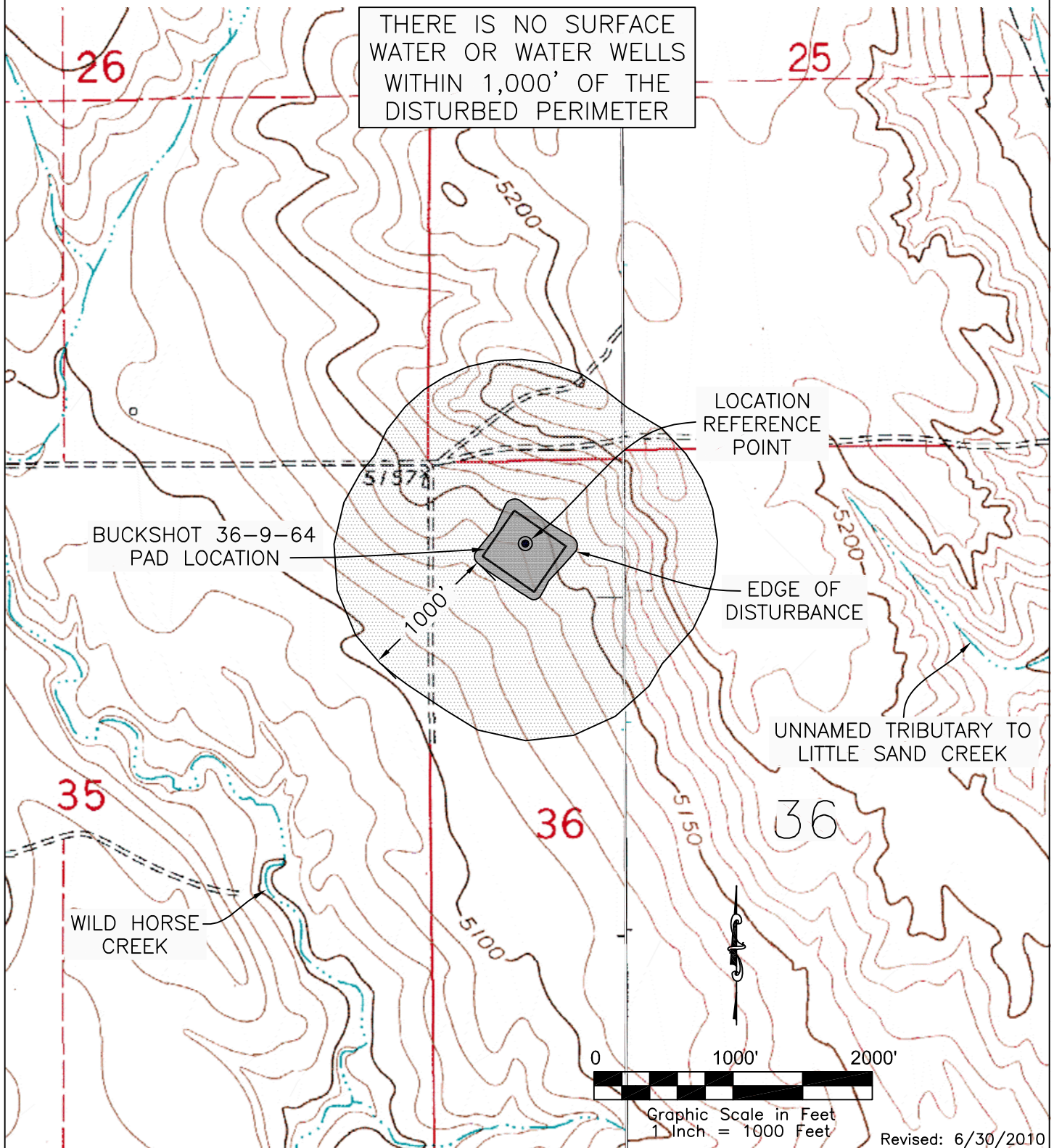

Revised: 6/30/2010

  
**WESTERN LAND SERVICES**  
Sheridan, WY 82801 (307)673-1817

DP: L:\Slawson\Permitting\_Booklets\Buckshot Date: 6/08/2010

SLAWSON EXPLORATION COMPANY, INC  
BUCKSHOT 36-9-64

SL: NW1/4 NW1/4, SECTION 36, T9N R64W  
BL: SE1/4 SW1/4, SECTION 36, T9N R64W  
6TH PM, WELD COUNTY, COLORADO