

Facilities and Construction Layout Drawing Porter B Pad Section 17, Township 6 South, Range 90 West

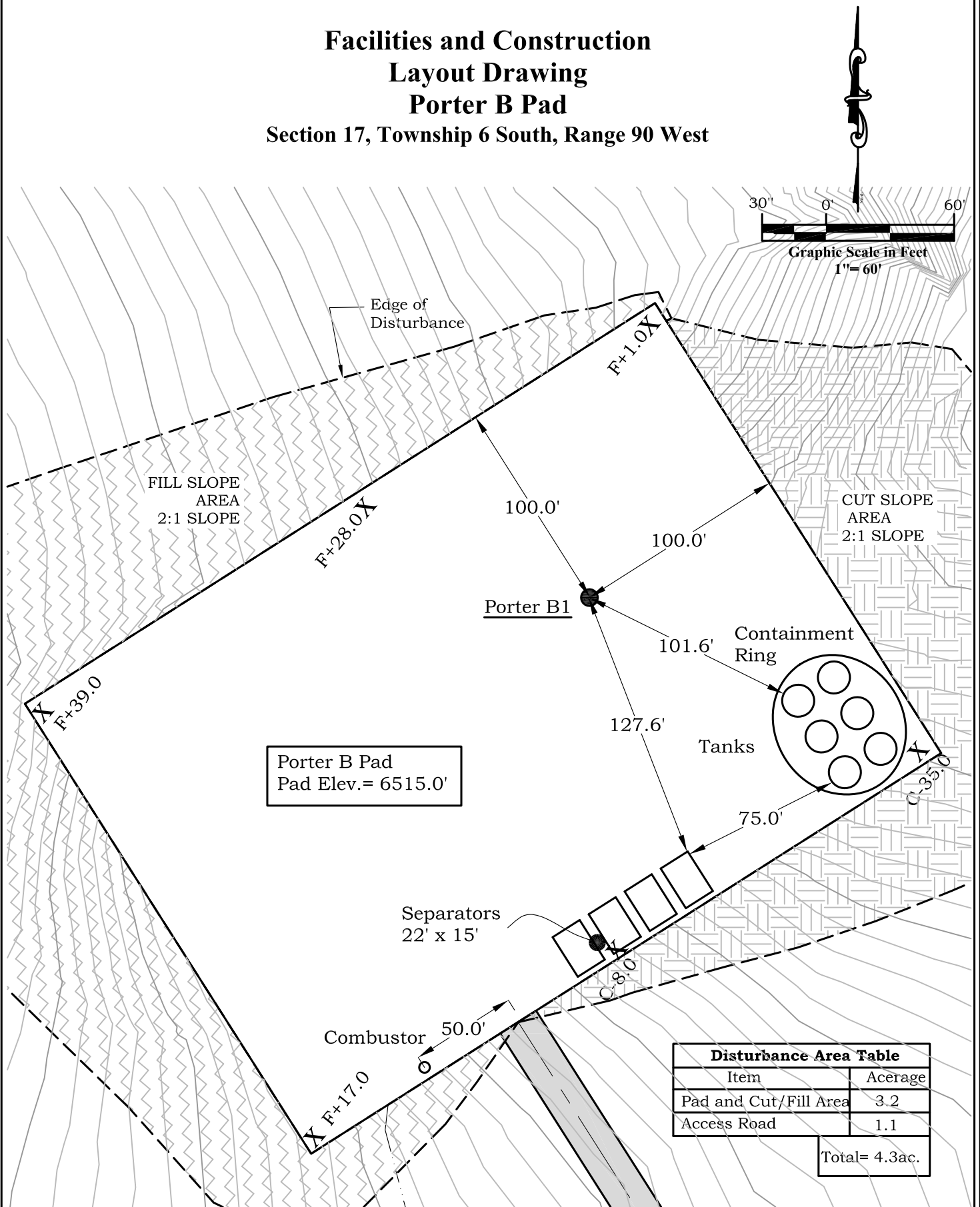

River Valley Survey, Inc.
110 East 3rd. Street, Suite 213
Rifle, Colorado 81650
Ph: 970-379-7846

Project: Porter B Pad

Field Date: 06-08-10

Date: 06-21-2010

Scale: 1"= 60'

Sheet: 4 of 13

Well Location Plat
Prepared For Antero Resources

Situate In:
SW 1/4 Section 17, T6S., R. 90 W. of the
6th P.M., Garfield County, Colorado



B PAD ACCESS ROAD PLAN & PROFILE, BMP Section 17, Township 6 South, Range 90 West

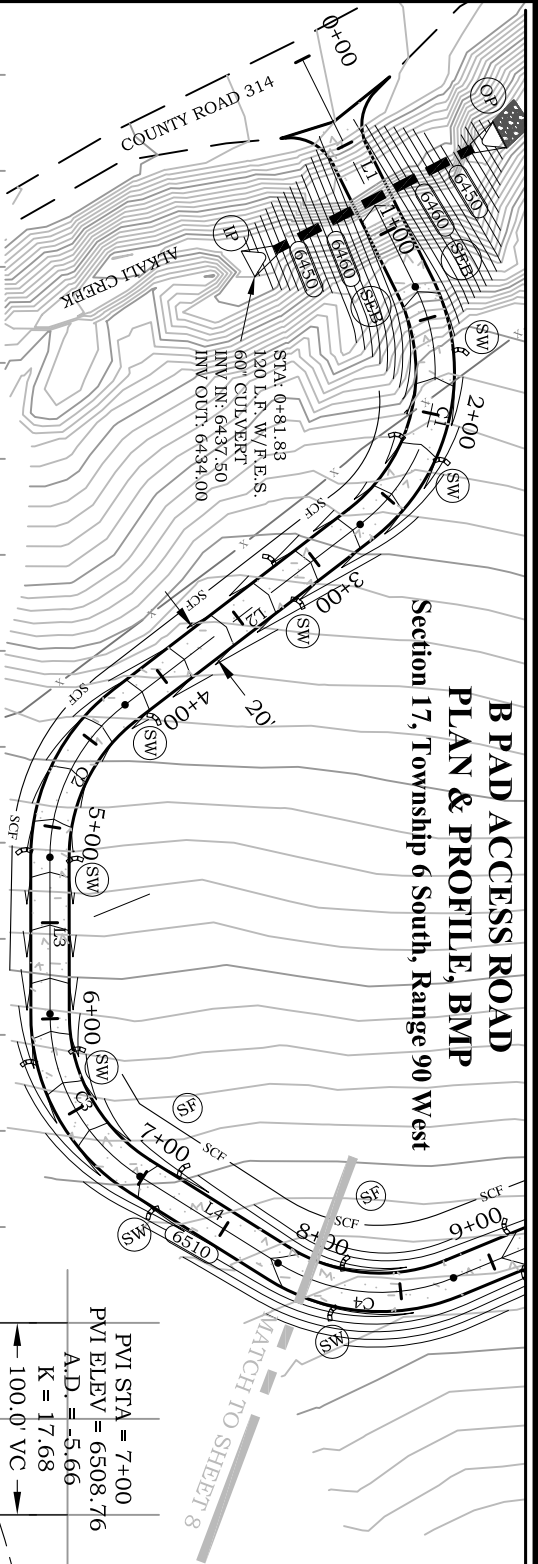

NOTE:
1. CENTERLINE LINE AND CURVE DATA ON SHEET 8
2. ALL SUGGESTED DESIGN CUT AND FILL SLOPES ARE TO BE ANALYZED AND APPROVED FOR STABILITY AND SAFETY BY A REGISTERED PROFESSIONAL GEOTECHNICAL ENGINEER. ROAD SOIL, COMPACTION DESIGN AND FIELD MONITORING AND TESTING TO BE CONDUCTED AND APPROVED BY A REGISTERED PROFESSIONAL GEOTECHNICAL ENGINEER

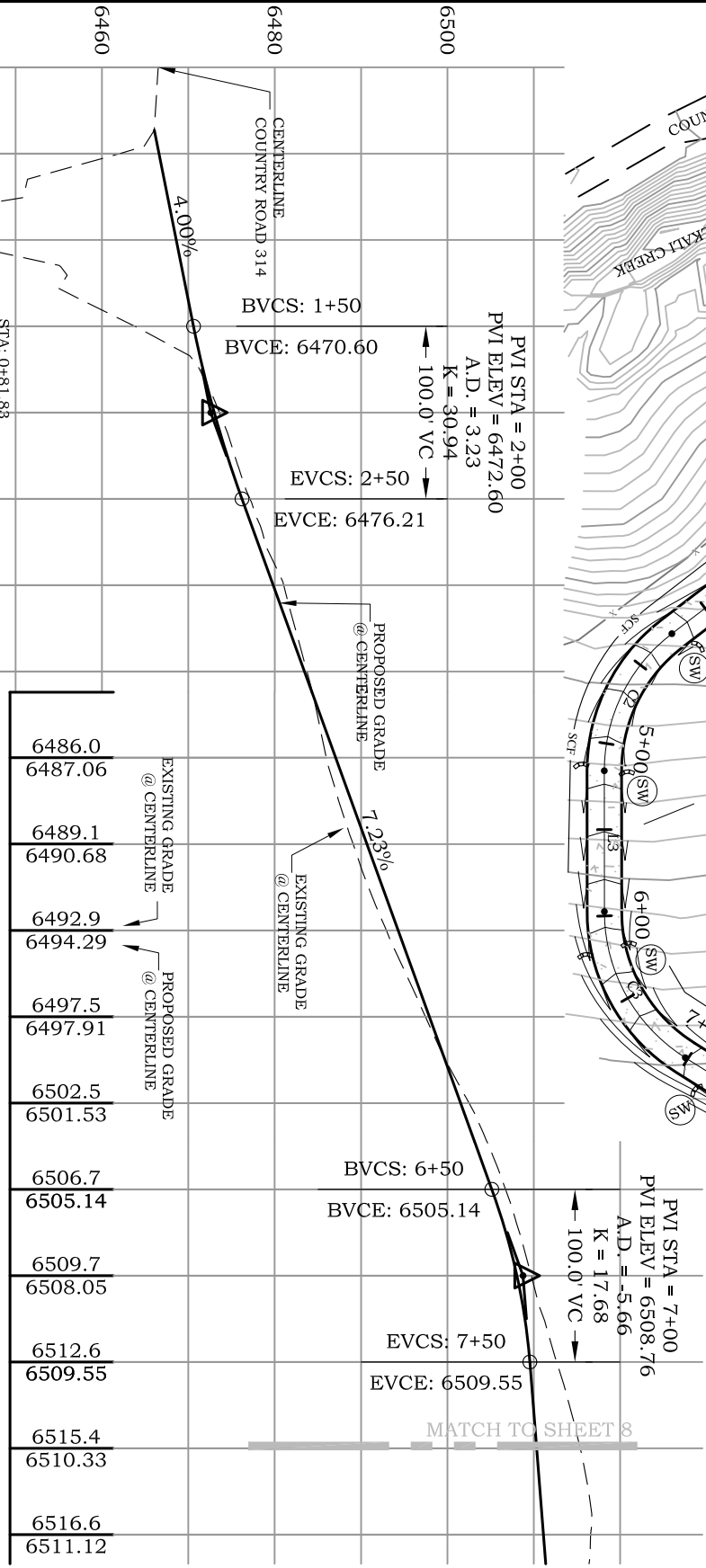

0+00	6466.5
1+00	6462.1 6466.60
2+00	6441.6 6468.60
3+00	6463.8 6470.60
4+00	6473.6 6473.00
5+00	6477.1 6476.21
6+00	6481.0 6479.83
7+00	6483.7 6483.44



River Valley Survey, Inc.
110 East 3rd. Street, Suite 213
Rifle, Colorado 81650
Ph: 970-379-7846

Well Pad Access Road Plan
Prepared For Antero Resources
Sittate In:
SW 1/4 Section 17, T6S, R. 90 W. of the
6th P.M., Garfield County, Colorado



Project: Porter B Pad
Field Date: 06-10-10
Date: 06-21-2010

Scale: 1"=100'
Sheet: 7 of 13

B PAD ACCESS ROAD PLAN & PROFILE, BMP Section 17, Township 6 South, Range 90 West

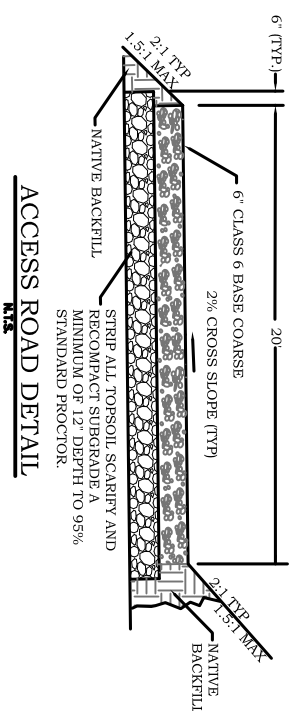
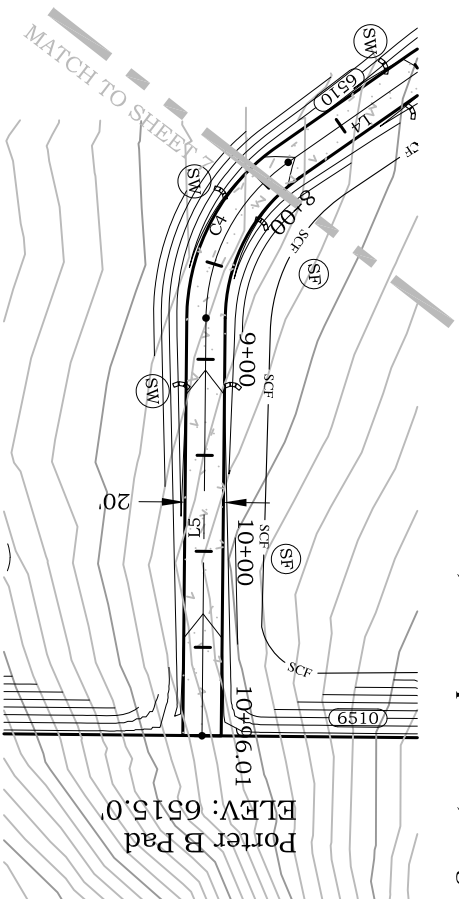

NOTE:
1. ALL SUGGESTED DESIGN CUT AND FILL SLOPES ARE TO BE ANALYZED AND APPROVED FOR STABILITY AND SAFETY BY A REGISTERED PROFESSIONAL GEOTECHNICAL ENGINEER.
ROAD SOIL COMPACTION DESIGN AND FIELD MONITORING AND TESTING TO BE CONDUCTED AND APPROVED BY A REGISTERED PROFESSIONAL GEOTECHNICAL ENGINEER.

LINE TABLE		
LINE	LENGTH	BEARING
L1	132.27	N53°37'07"E
L2	154.28	S47°30'52"E
L3	81.59	N79°57'55"E
L4	84.83	N22°06'43"E
L5	217.51	N32°27'20"W

CURVE TABLE					
CURVE	LENGTH	RADIUS	TANGENT	DELTA	CHORD
C1	137.65	100.00	82.24	78°52'01"	N86°56'53"W
C2	91.66	100.00	49.34	52°31'13"	S73°46'28"E
C3	100.97	100.00	55.26	57°51'12"	N51°02'19"E
C4	95.24	100.00	51.58	54°34'03"	N05°10'18"W

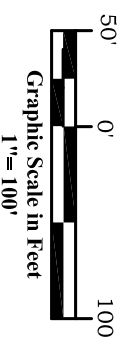

8+00	6515.4	6510.33
9+00	6516.6	6511.12
10+00	6515.4	6511.91
	6513.9	6512.70
	6512.1	6513.49
	6512.9	6514.27
	6514.8	6515.00

EXISTING GRADE @ CENTERLINE
PROPOSED GRADE @ CENTERLINE

PROPOSED GRADE @ CENTERLINE
EXISTING GRADE @ CENTERLINE
1.58%

MATCH TO SHEET 7



River Valley Survey, Inc.
110 East 3rd. Street, Suite 213
Rifle, Colorado 81650
Ph: 970-379-7846

Well Pad Access Road Plan
Prepared For Antero Resources
Situate in:
SW 1/4 Section 17, T6S., R. 90 W. of the
6th P.M., Garfield County, Colorado

Project: Porter B Pad

Field Date: 06-10-10

Date: 06-21-2010

Scale: 1"= 100'

Sheet: 8 of 13

CROSS SECTION

Porter B1

Section 17, Township 6 South, Range 90 West

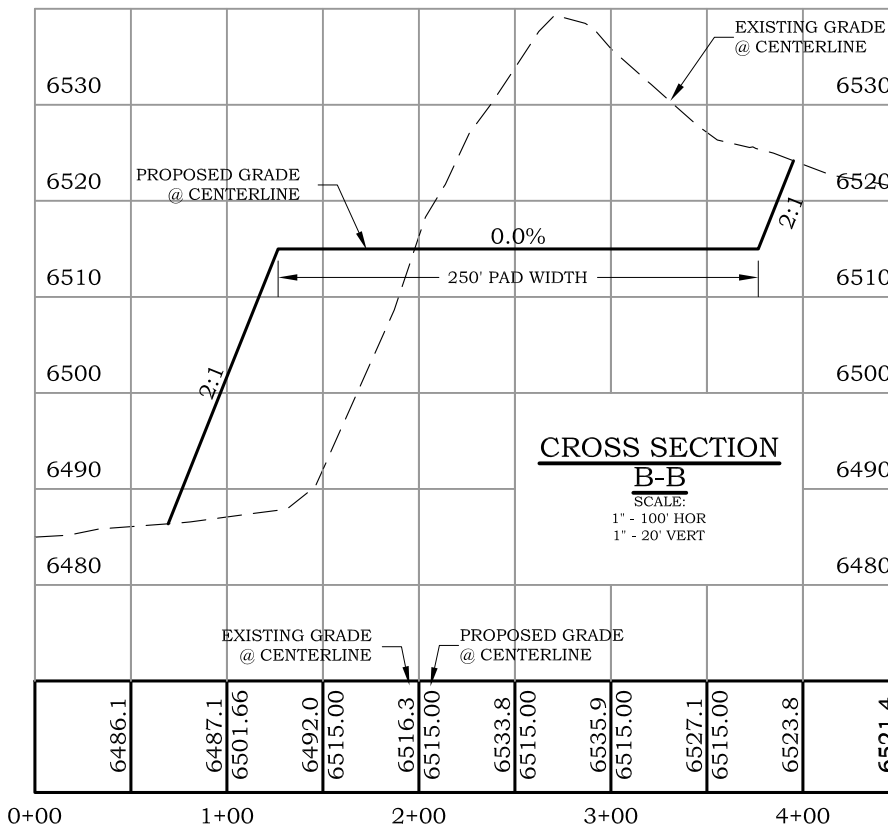
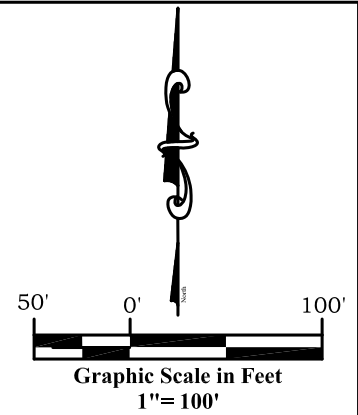
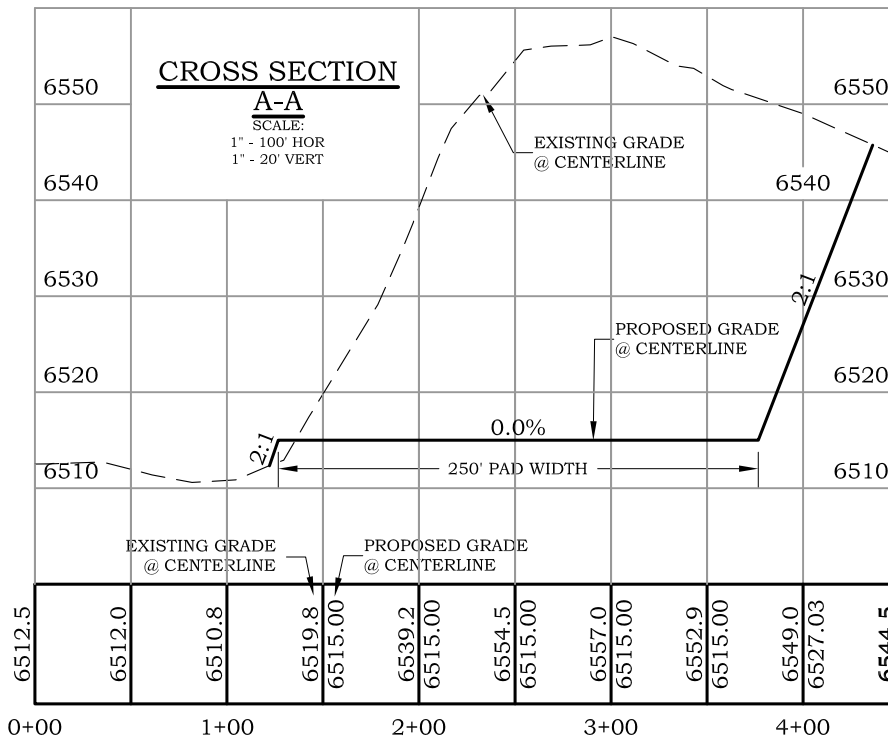

TOTAL PAD GRADING
56,667 cu. yd. CUT
53,958 cu. yd. FILL

*ASSUMES 15% COMPACTION RATE

NOTE:
1. SEE CROSS SECTION
LOCATIONS ON GRADING PLAN
SHEET



River Valley Survey, Inc.
110 East 3rd. Street, Suite 213
Rifle, Colorado 81650
Ph: 970-379-7846

Project: Porter B Pad

Field Date: 06-08-10

Date: 06-21-2010

Scale: 1" = 100'

Sheet: 10 of 13

Well Location Plat
Prepared For Antero Resources

Situate In:
SW 1/4 Section 17, T6S., R. 90 W. of the
6th P.M., Garfield County, Colorado



CROSS SECTION Porter B1 Section 17, Township 6 South, Range 90 West

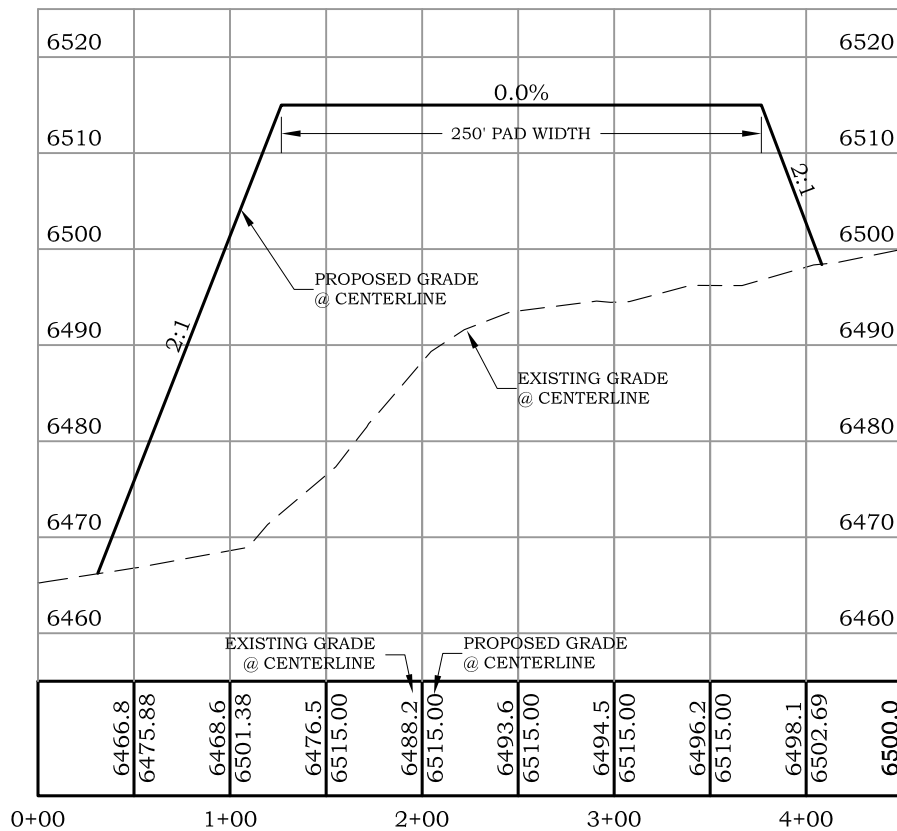
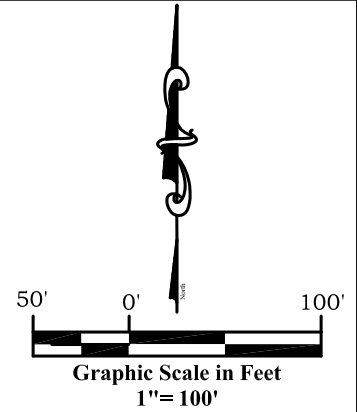

CROSS SECTION C-C

SCALE:
1" = 100' HOR
1" = 20' VERT

TOTAL PAD GRADING
56,667 cu. yd. CUT
53,958 cu. yd. FILL

*ASSUMES 15% COMPACTION RATE

NOTE:
1. SEE CROSS SECTION
LOCATIONS ON GRADING PLAN
SHEET



River Valley Survey, Inc.
110 East 3rd. Street, Suite 213
Rifle, Colorado 81650
Ph: 970-379-7846

Project: Porter B Pad

Field Date: 06-08-10

Date: 06-21-2010

Scale: 1" = 100'

Sheet: 11 of 13

Well Location Plat
Prepared For Antero Resources

Situate In:
SW 1/4 Section 17, T6S., R. 90 W. of the
6th P.M., Garfield County, Colorado

