

# CSF Q Pad

## Facilities and Construction Layout Drawing

### Section 10, Township 7 South, Range 91 West

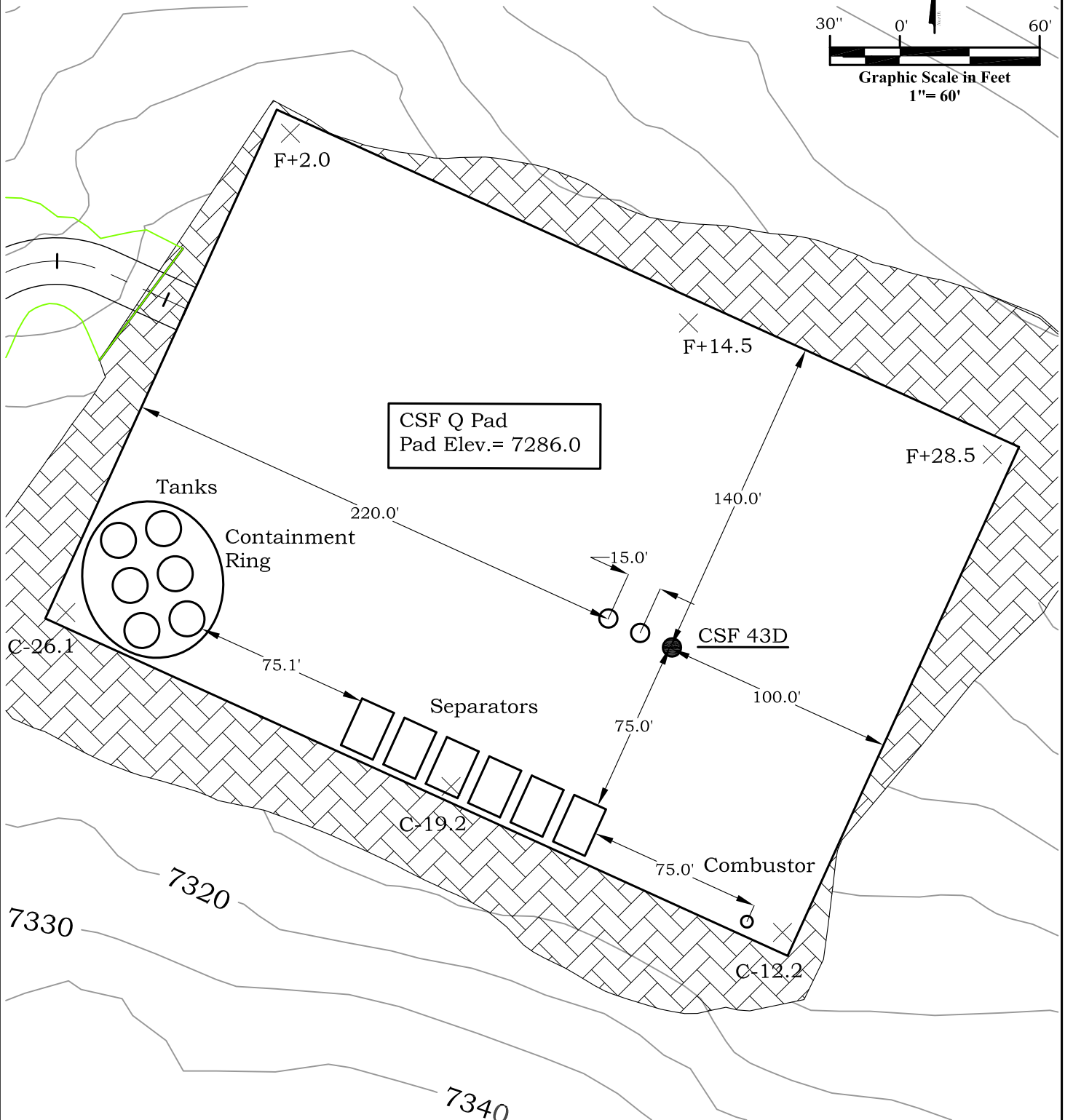
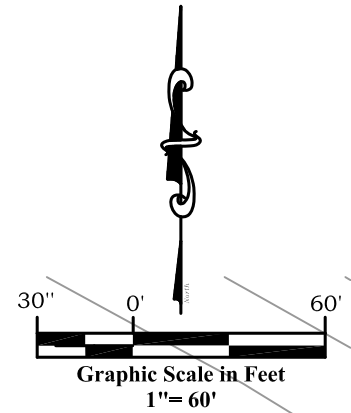

**River Valley Survey, Inc.**  
110 East 3rd. Street, Suite 213  
Rifle, Colorado 81650  
Ph: 970-379-7846

**Project:** CASTLE SPRINGS FEDERAL Q PAD

**Field Date:** 06-09-10

**Date:** 06-16-2010

**Scale:** 1" = 60'

**Sheet:** 4 of 13

**Well Location Plat**  
**Prepared For Antero Resources**

**Situate In:**  
SE 1/4 Section 10, T7S., R. 91 W. of the  
6th P.M., Garfield County, Colorado





# Q PAD ACCESS ROAD PLAN & PROFILE, BMP

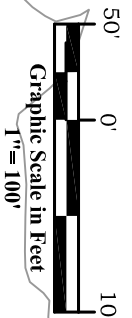
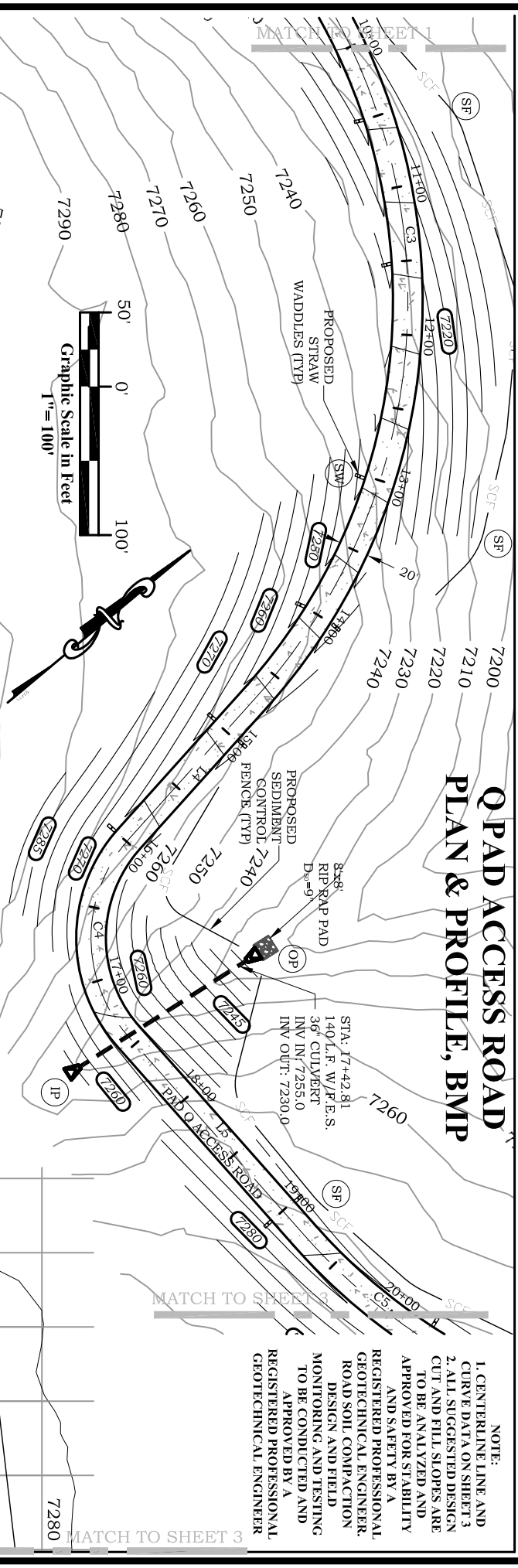

NOTE:  
1. CENTERLINE AND CURVE DATA ON SHEET 3  
2. ALL SUGGESTED DESIGN CUT AND FILL SLOPES ARE TO BE ANALYZED AND APPROVED FOR STABILITY AND SAFETY BY A REGISTERED PROFESSIONAL GEOTECHNICAL ENGINEER  
ROAD SOIL COMPACTION DESIGN AND FIELD MONITORING AND TESTING TO BE CONDUCTED AND APPROVED BY A REGISTERED PROFESSIONAL GEOTECHNICAL ENGINEER

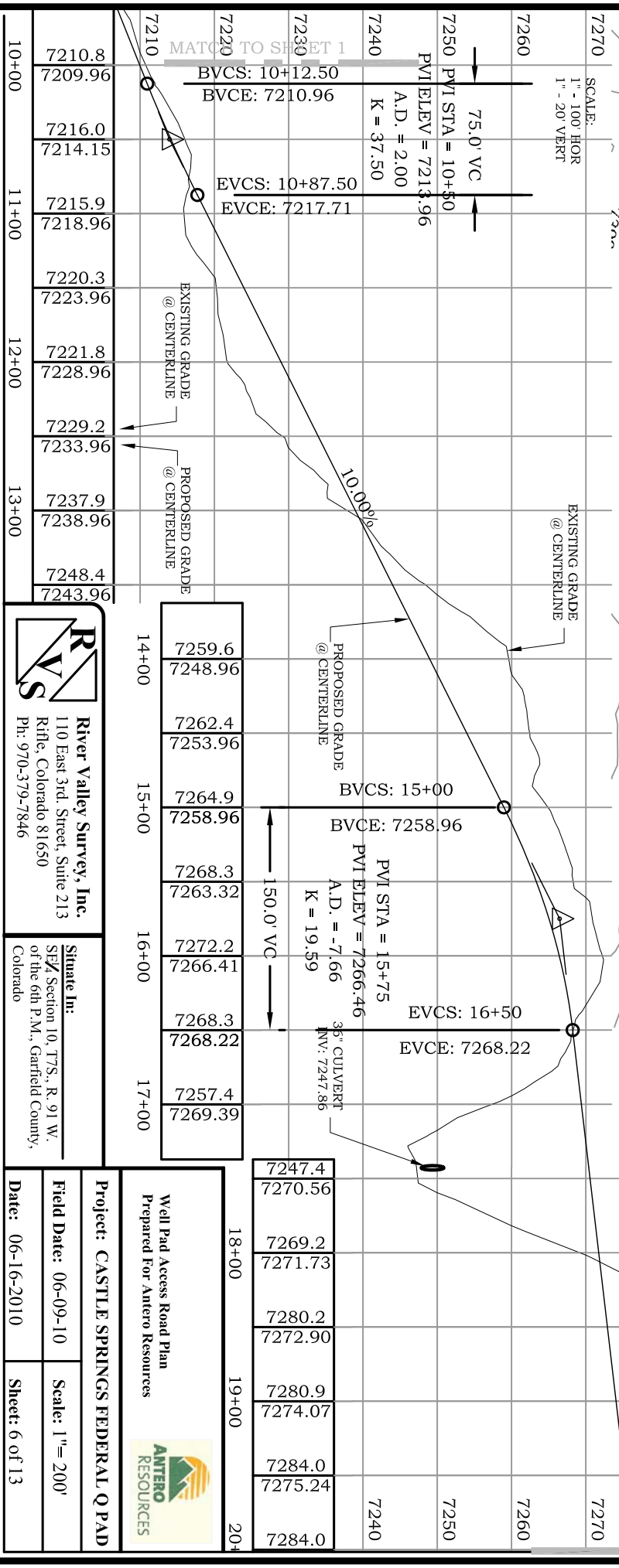

7259.6	7248.96
7262.4	7253.96
7264.9	7258.96
7268.3	7263.32
7272.2	7266.41
7268.3	7268.22
7257.4	7269.39

7247.4	7270.56
7269.2	7271.73
7280.2	7272.90
7280.9	7274.07
7284.0	7275.24
7284.0	



**River Valley Survey, Inc.**  
110 East 3rd. Street, Suite 213  
Rifle, Colorado 81650  
Ph: 970-379-7846

**Situate In:**  
SE 1/4 Section 10, T7S, R 91 W,  
of the 6th P.M., Garfield County,  
Colorado

Well Pad Access Road Plan  
Prepared For Antero Resources



**Project: CASTLE SPRINGS FEDERAL Q PAD**

**Field Date:** 06-09-10 **Scale:** 1" = 200'

**Date:** 06-16-2010 **Sheet:** 6 of 13

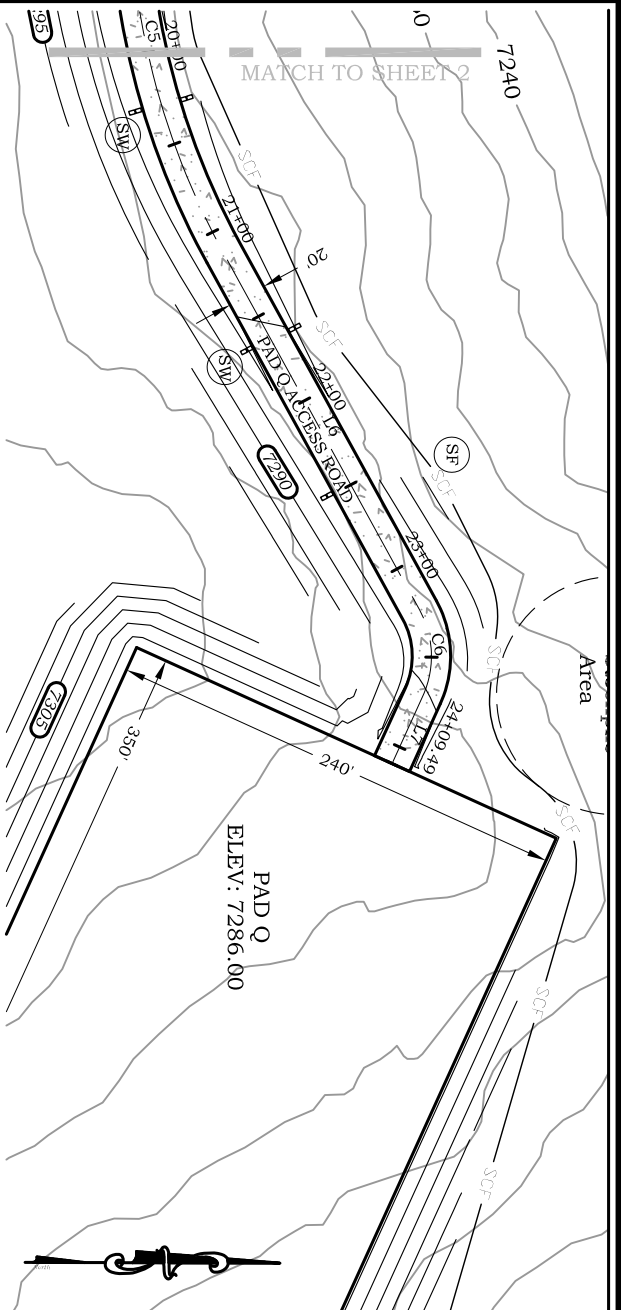

LINE TABLE		
LINE	LENGTH	BEARING
L1	45.26	S86°37'20"E
L2	13.80	S53°33'25"E
L3	100.84	N77°05'07"E
L4	127.88	S08°05'11"E
L5	179.20	N88°28'29"E
L6	211.77	N61°13'51"E
L7	38.68	S65°33'03"E

CURVE TABLE						
CURVE	LENGTH	RADIUS	TANGENT	DELTA	CHORD	CHORD
C1	346.26	600.00	178.10	33°03'55"	N70°05'23"W	341.47
C2	301.51	350.00	160.83	49°21'28"	S78°14'09"E	292.27
C3	662.03	400.00	435.21	94°49'43"	N55°30'02"W	589.01
C4	145.63	100.00	89.16	83°26'21"	S49°48'21"E	133.10
C5	190.20	400.00	96.93	27°14'37"	N74°51'10"E	188.41
C6	46.44	50.00	25.05	53°13'06"	S87°50'24"W	44.79

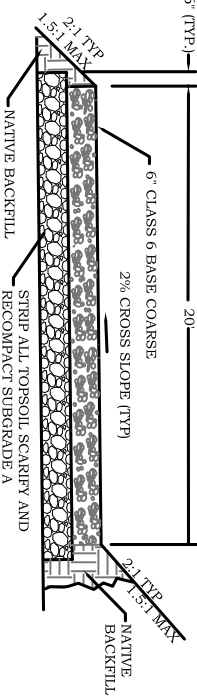
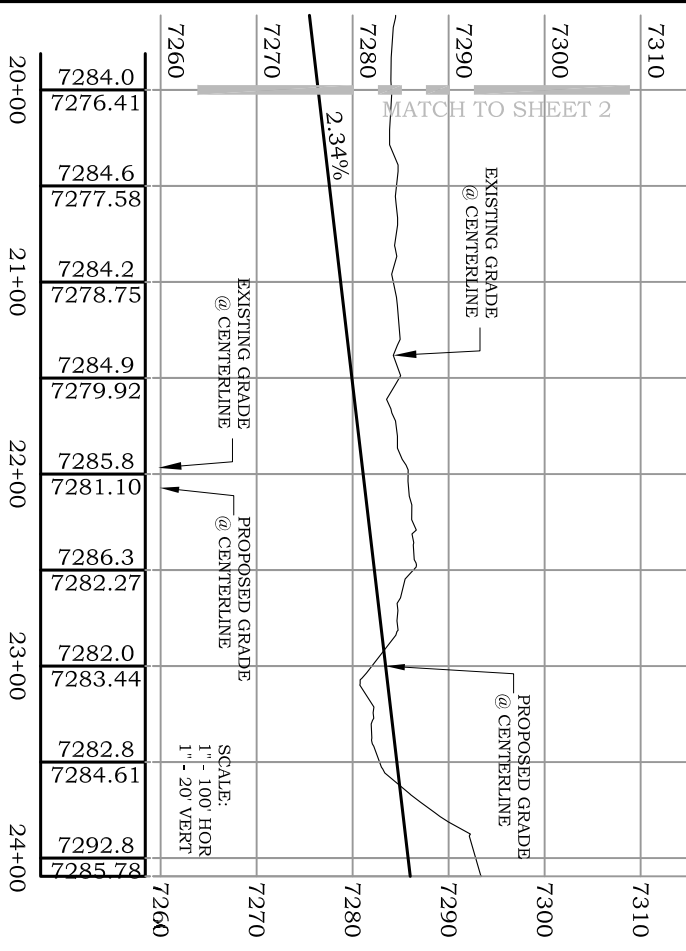

NOTE:  
1. CENTERLINE LINE AND CURVE DATA ON SHEET 3  
2. ALL SUGGESTED DESIGN CUT AND FILL SLOPES ARE TO BE ANALYZED AND APPROVED FOR STABILITY AND SAFETY BY A REGISTERED PROFESSIONAL GEOTECHNICAL ENGINEER. ROAD SOIL, COMPACTION DESIGN AND FIELD MONITORING AND TESTING TO BE CONDUCTED AND APPROVED BY A REGISTERED PROFESSIONAL GEOTECHNICAL ENGINEER

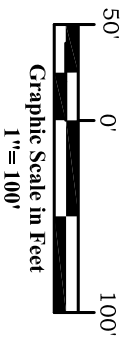

# Q PAD ACCESS ROAD PLAN & PROFILE, BMP



River Valley Survey, Inc.  
110 East 3rd. Street, Suite 213  
Rifle, Colorado 81650  
Ph: 970-379-7846

Well Pad Access Road Plan  
Prepared For Antero Resources  
Situated In:  
SE 1/4 Section 10, T7S., R. 91 W., of the  
6th P.M., Garfield County, Colorado

Project: Castle Springs

Field Date: 06-10-10

Date: 06-14-10

Well Pad Access Road Plan  
Prepared For Antero Resources

Scale: 1" = 100'

Sheet: 7 of 13

# CSF Q Pad

## Pad Cross-Sections

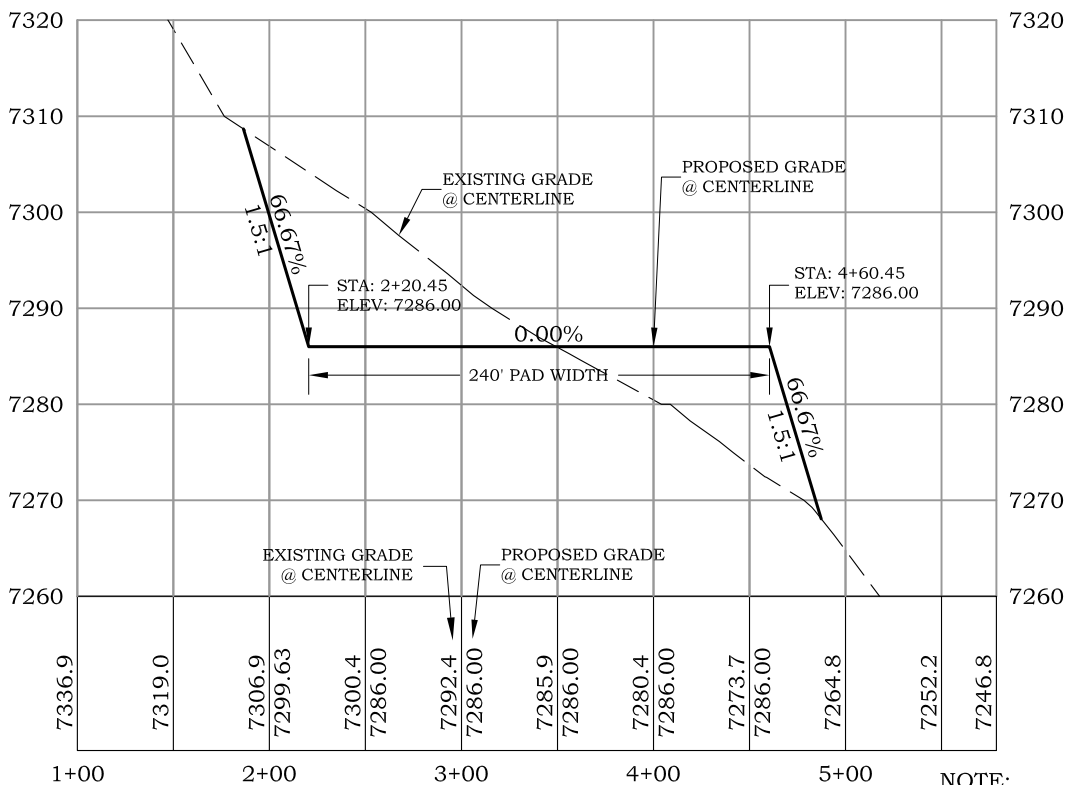
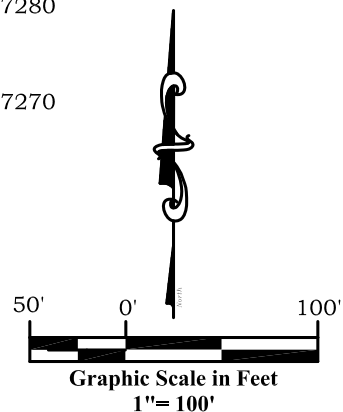
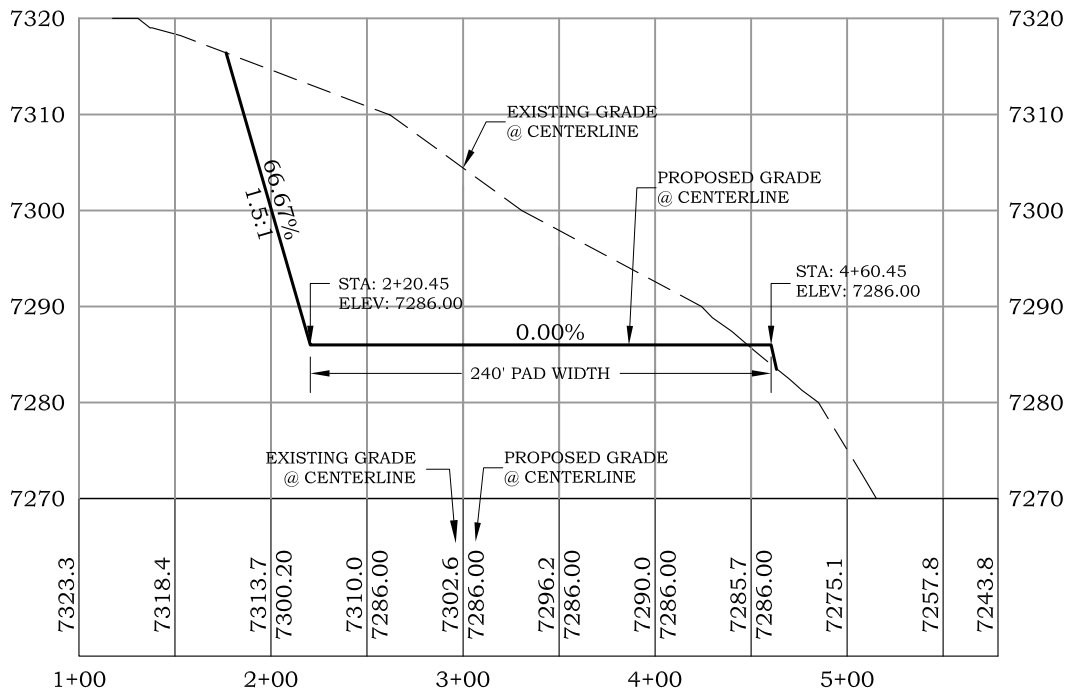

NOTE:  
1. SEE CROSS SECTION LOCATIONS ON GRADING PLAN SHEET 8



**River Valley Survey, Inc.**  
110 East 3rd. Street, Suite 213  
Rifle, Colorado 81650  
Ph: 970-379-7846

**Project: CASTLE SPRINGS FEDERAL Q PAD**

**Field Date: 06-09-10**

**Date: 06-16-2010**

**Scale: 1" = 100'**

**Sheet: 9 of 13**

**Well Location Plat**  
**Prepared For Antero Resources**

**Situate In:**  
SE 1/4 Section 10, T7S., R. 91 W. of the  
6th P.M., Garfield County, Colorado



# CSF Q Pad Pad Cross-Sections

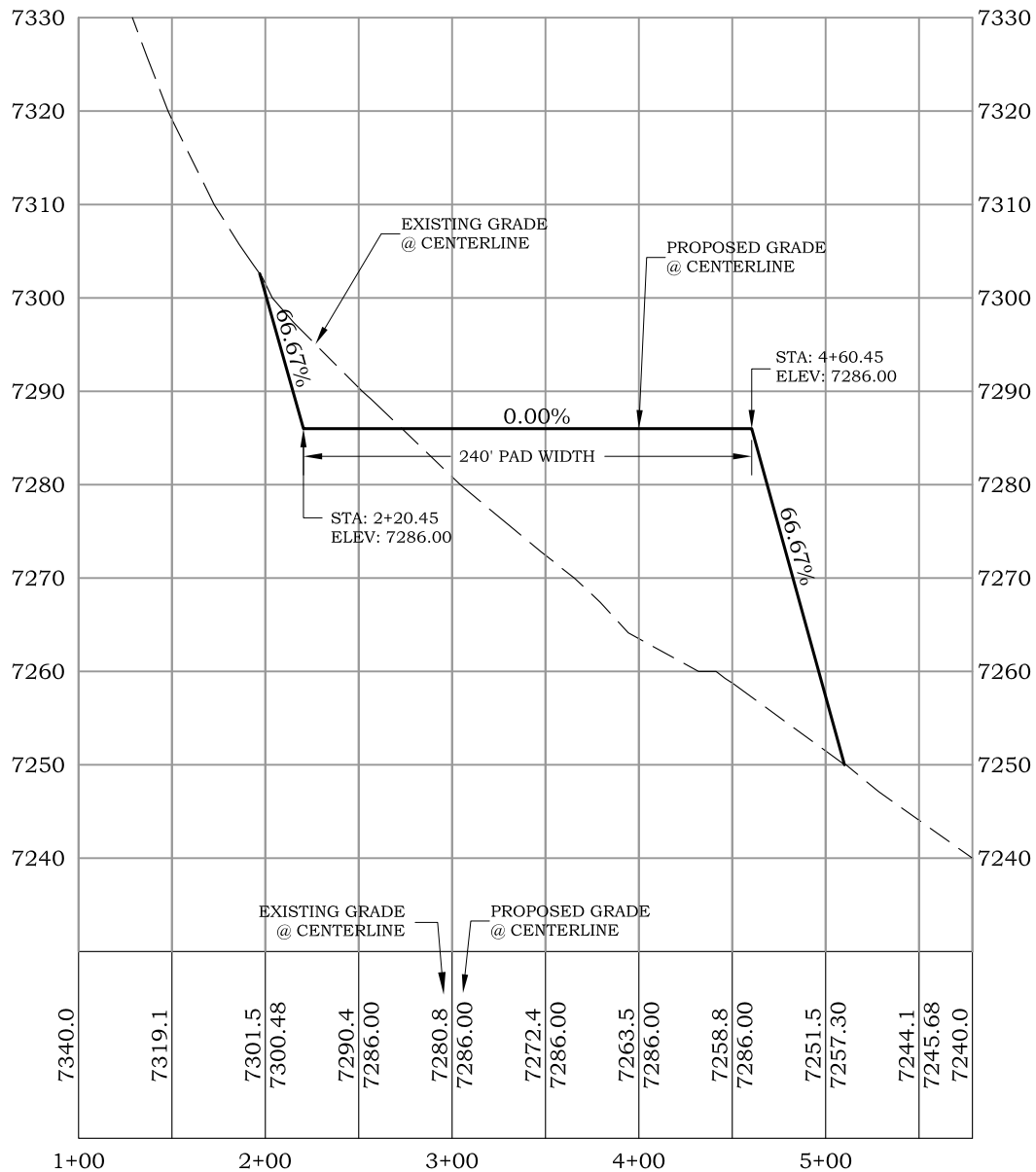
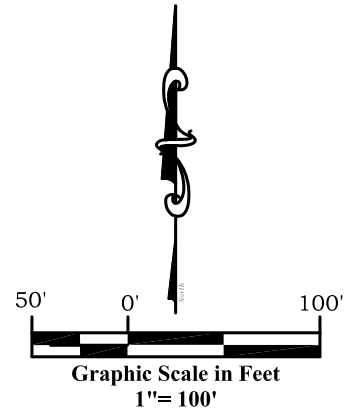

## CROSS SECTION C-C

SCALE:  
1" = 100' HOR  
1" = 20' VERT

NOTE:  
1. SEE CROSS SECTION LOCATIONS ON  
GRADING PLAN SHEET 8



**River Valley Survey, Inc.**  
110 East 3rd. Street, Suite 213  
Rifle, Colorado 81650  
Ph: 970-379-7846

**Project: CASTLE SPRINGS FEDERAL Q PAD**

**Field Date: 06-09-10**

**Scale: 1"= 100'**

**Date: 06-16-2010**

**Sheet: 10 of 13**

**Well Location Plat**  
**Prepared For Antero Resources**

**Situate In:**  
SE 1/4 Section 10, T7S., R. 91 W. of the  
6th P.M., Garfield County, Colorado

