

LOCATION DRAWING

VEGETATION:
PASTURE--GRASSES

SURFACE USE:
AGRICULTURAL
UNIMPROVED PASTURE

GROUND SLOPE <10%

PAWNEE 10-67-5-1

LATITUDE: 40.856362

LONGITUDE: -104.922046

FOOTAGE: 300 FSL 700 FWL

GROUND ELEVATION: 5743.9

PDOP: 2.0 DATE: 5/6/2010

INSTRUMENT OPERATOR: DJM

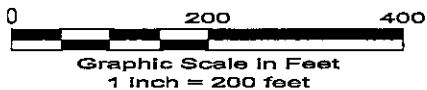
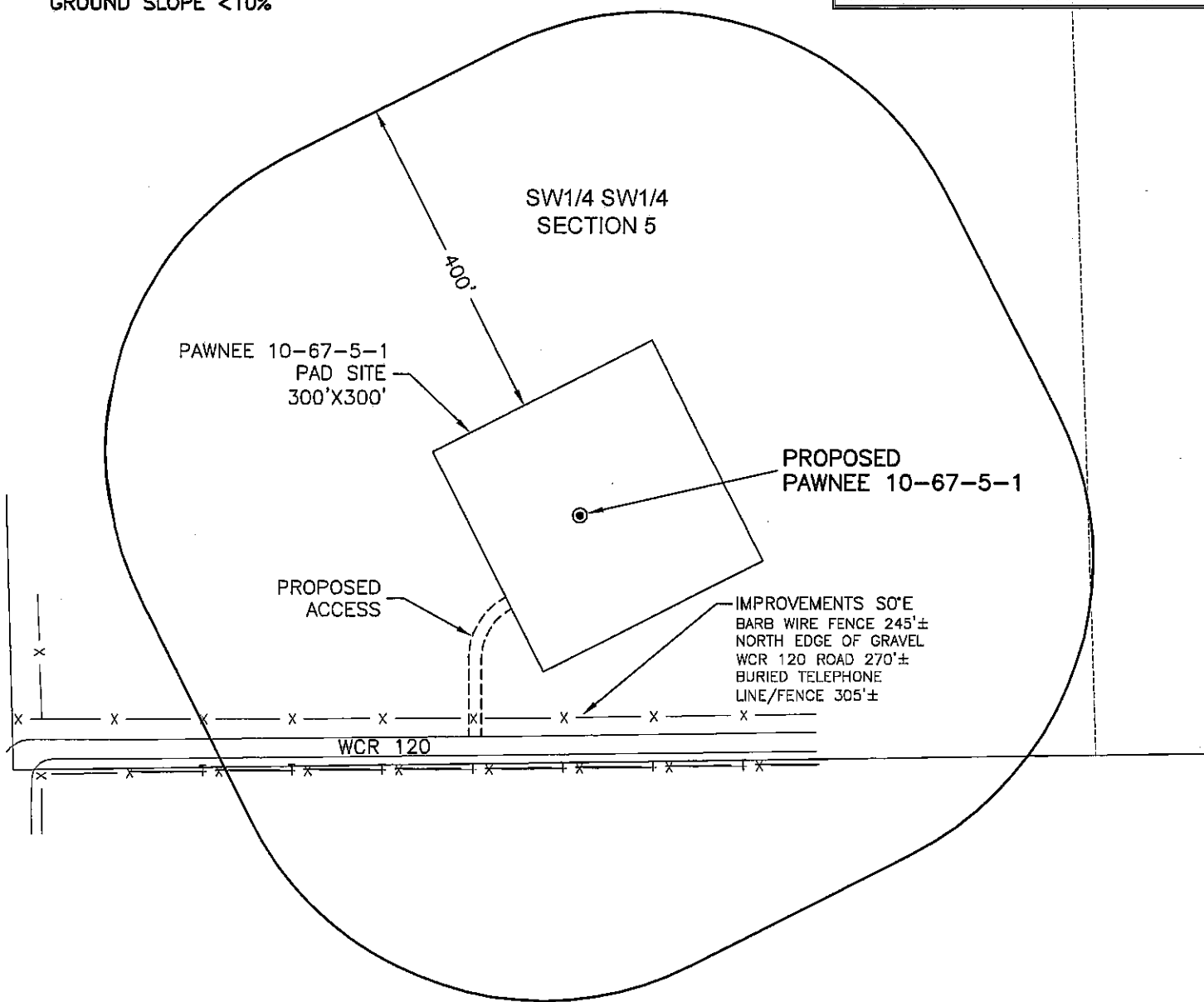

DISTURBANCE ACREAGE:
3.5± DRILLING OPERATIONS
1.5± INTERIM RECLAIM

5/11/10

GEO SURV

LAND SURVEYING AND MAPPING
LAFAYETTE - WINTER PARK
Ph 303 666 0379 Fx 303 665 6320

RUBICON OIL & GAS LLC
PAWNEE 10-67-5-1

SW1/4 SW1/4 SEC. 5 T10N R67W
6th PM WELD COUNTY COLORADO