

PRODUCTION FACILITY VISIBLE IMPROVEMENTS

THIS MAP DOES NOT REPRESENT A BOUNDARY SURVEY

SECTION 1
TOWNSHIP 10 NORTH
RANGE 62 WEST

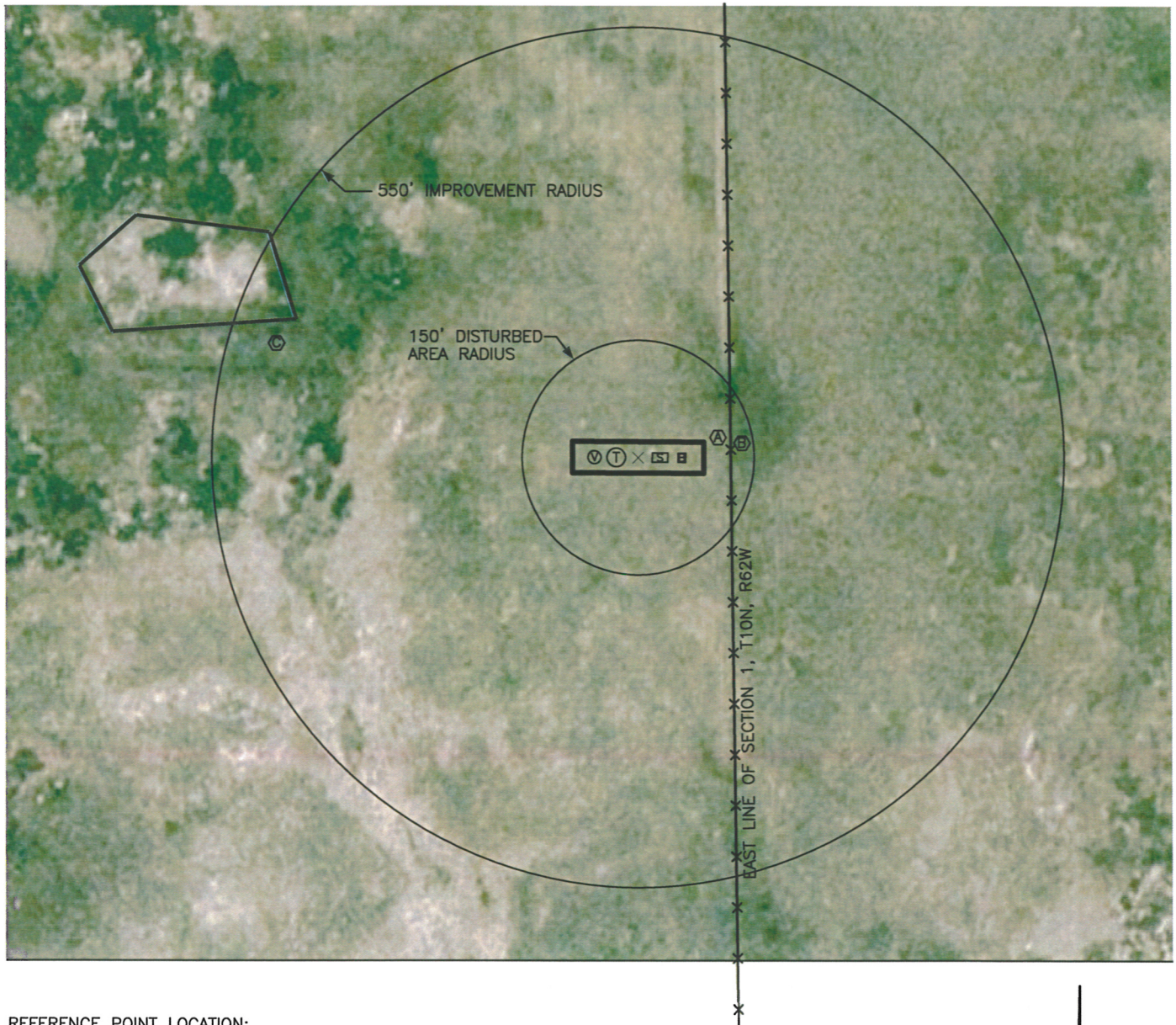

REFERENCE POINT LOCATION:

LATITUDE: 40.86778N

LONGITUDE: 104.25863W

PDOP: 2.5

DATE: 5/25/10

NE1/4

FNL: 1411'

FEL: 120'

DISTANCE TO WELL: 932' NW

ASSOCIATED NEW WELLS:

HAYNES 1062-1-11

ASSOCIATED EXISTING WELLS:

NONE

IMPROVEMENTS:

Ⓐ PROPERTY LINE 120' EAST

Ⓑ FENCE LINE 120' EAST

Ⓒ STANDING WATER 476' NW

THE NEAREST OVERHEAD POWER LINE IS 1381' NORTH

LEGEND:

- × REFERENCE POINT
- ① PROPOSED TANK
- ⓪ PROPOSED WATER VAULT
- ⓧ PROPOSED SEPARATOR
- PROPOSED BURNER

ALL DISTANCES ARE APPROXIMATE

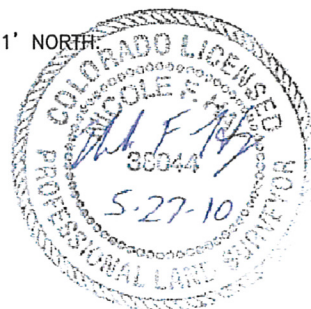

SCALE: 1"=200'

0 100 200

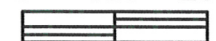

SCALE IN FEET