

MDP Pad 15
Lease Boundary Map

CO 10276

T. 6 S., R. 91 W, 6th P.M.
Sec. 29; N2SW, SWNE, NWSE
160 Acres

USA COC 46972

T. 6 S., R. 91 W, 6th P.M.
Sec. 29; E2E2, NWNE, SWSE
Sec. 32; E2, NENW
600 Acres

• Bottom Hole Location

Gibson Gulch Fed Unit

29

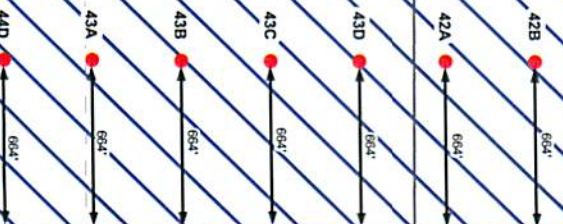

6S/91W

Gibson Gulch Unit

Map showing the Gibson Gulch Unit, a large area outlined in pink, situated within a grid of sections 19, 20, 21, 28, 29, 30, 31, and 32. The unit is bounded by a thick black dashed line. Numerous wells are marked with symbols and labels, including gas wells (orange starburst), private water wells (blue triangle), and private water wells with specific spot data (red triangle). Well labels include 13-20A, 14B, 13-20, 14A, 11D, 11C, 11B, 11A, 21C, 21B, 21A, 12B, 12A, 12-28, 13A, 13-28, 14A, 14B, 14C, 14D, 14E, 14F, 14G, 14H, 14I, 14J, 14K, 14L, 14M, 14N, 14O, 14P, 14Q, 14R, 14S, 14T, 14U, 14V, 14W, 14X, 14Y, 14Z, 15-29, 16-29, 17-29, 18-29, 19-29, 20-29, 21-29, 22-29, 23-29, 24-29, 25-29, 26-29, 27-29, 28-29, 29-29, 30-29, 31-29, 32-29, 33-29, 34-29, 35-29, 36-29, 37-29, 38-29, 39-29, 40-29, 41-29, 42-29, 43-29, 44-29, 45-29, 46-29, 47-29, 48-29, 49-29, 50-29, 51-29, 52-29, 53-29, 54-29, 55-29, 56-29, 57-29, 58-29, 59-29, 60-29, 61-29, 62-29, 63-29, 64-29, 65-29, 66-29, 67-29, 68-29, 69-29, 70-29, 71-29, 72-29, 73-29, 74-29, 75-29, 76-29, 77-29, 78-29, 79-29, 80-29, 81-29, 82-29, 83-29, 84-29, 85-29, 86-29, 87-29, 88-29, 89-29, 90-29, 91-29, 92-29, 93-29, 94-29, 95-29, 96-29, 97-29, 98-29, 99-29, 100-29, 101-29, 102-29, 103-29, 104-29, 105-29, 106-29, 107-29, 108-29, 109-29, 110-29, 111-29, 112-29, 113-29, 114-29, 115-29, 116-29, 117-29, 118-29, 119-29, 120-29, 121-29, 122-29, 123-29, 124-29, 125-29, 126-29, 127-29, 128-29, 129-29, 130-29, 131-29, 132-29, 133-29, 134-29, 135-29, 136-29, 137-29, 138-29, 139-29, 140-29, 141-29, 142-29, 143-29, 144-29, 145-29, 146-29, 147-29, 148-29, 149-29, 150-29, 151-29, 152-29, 153-29, 154-29, 155-29, 156-29, 157-29, 158-29, 159-29, 160-29, 161-29, 162-29, 163-29, 164-29, 165-29, 166-29, 167-29, 168-29, 169-29, 170-29, 171-29, 172-29, 173-29, 174-29, 175-29, 176-29, 177-29, 178-29, 179-29, 180-29, 181-29, 182-29, 183-29, 184-29, 185-29, 186-29, 187-29, 188-29, 189-29, 190-29, 191-29, 192-29, 193-29, 194-29, 195-29, 196-29, 197-29, 198-29, 199-29, 200-29, 201-29, 202-29, 203-29, 204-29, 205-29, 206-29, 207-29, 208-29, 209-29, 210-29, 211-29, 212-29, 213-29, 214-29, 215-29, 216-29, 217-29, 218-29, 219-29, 220-29, 221-29, 222-29, 223-29, 224-29, 225-29, 226-29, 227-29, 228-29, 229-29, 230-29, 231-29, 232-29, 233-29, 234-29, 235-29, 236-29, 237-29, 238-29, 239-29, 240-29, 241-29, 242-29, 243-29, 244-29, 245-29, 246-29, 247-29, 248-29, 249-29, 250-29, 251-29, 252-29, 253-29, 254-29, 255-29, 256-29, 257-29, 258-29, 259-29, 260-29, 261-29, 262-29, 263-29, 264-29, 265-29, 266-29, 267-29, 268-29, 269-29, 270-29, 271-29, 272-29, 273-29, 274-29, 275-29, 276-29, 277-29, 278-29, 279-29, 280-29, 281-29, 282-29, 283-29, 284-29, 285-29, 286-29, 287-29, 288-29, 289-29, 290-29, 291-29, 292-29, 293-29, 294-29, 295-29, 296-29, 297-29, 298-29, 299-29, 300-29, 301-29, 302-29, 303-29, 304-29, 305-29, 306-29, 307-29, 308-29, 309-29, 310-29, 311-29, 312-29, 313-29, 314-29, 315-29, 316-29, 317-29, 318-29, 319-29, 320-29, 321-29, 322-29, 323-29, 324-29, 325-29, 326-29, 327-29, 328-29, 329-29, 330-29, 331-29, 332-29, 333-29, 334-29, 335-29, 336-29, 337-29, 338-29, 339-29, 340-29, 341-29, 342-29, 343-29, 344-29, 345-29, 346-29, 347-29, 348-29, 349-29, 350-29, 351-29, 352-29, 353-29, 354-29, 355-29, 356-29, 357-29, 358-29, 359-29, 360-29, 361-29, 362-29, 363-29, 364-29, 365-29, 366-29, 367-29, 368-29, 369-29, 370-29, 371-29, 372-29, 373-29, 374-29, 375-29, 376-29, 377-29, 378-29, 379-29, 380-29, 381-29, 382-29, 383-29, 384-29, 385-29, 386-29, 387-29, 388-29, 389-29, 390-29, 391-29, 392-29, 393-29, 394-29, 395-29, 396-29, 397-29, 398-29, 399-29, 400-29, 401-29, 402-29, 403-29, 404-29, 405-29, 406-29, 407-29, 408-29, 409-29, 410-29, 411-29, 412-29, 413-29, 414-29, 415-29, 416-29, 417-29, 418-29, 419-29, 420-29, 421-29, 422-29, 423-29, 424-29, 425-29, 426-29, 427-29, 428-29, 429-29, 430-29, 431-29, 432-29, 433-29, 434-29, 435-29, 436-29, 437-29, 438-29, 439-29, 440-29, 441-29, 442-29, 443-29, 444-29, 445-29, 446-29, 447-29, 448-29, 449-29, 450-29, 451-29, 452-29, 453-29, 454-29, 455-29, 456-29, 457-29, 458-29, 459-29, 460-29, 461-29, 462-29, 463-29, 464-29, 465-29, 466-29, 467-29, 468-29, 469-29, 470-29, 471-29, 472-29, 473-29, 474-29, 475-29, 476-29, 477-29, 478-29, 479-29, 480-29, 481-29, 482-29, 483-29, 484-29, 485-29, 486-29, 487-29, 488-29, 489-29, 490-29, 491-29, 492-29,

March 23, 2010

MDP Pad 15
Fed Unit Boundary Map

- Bottom Hole Location
- ▭ Gibson Gulch Fed Unit

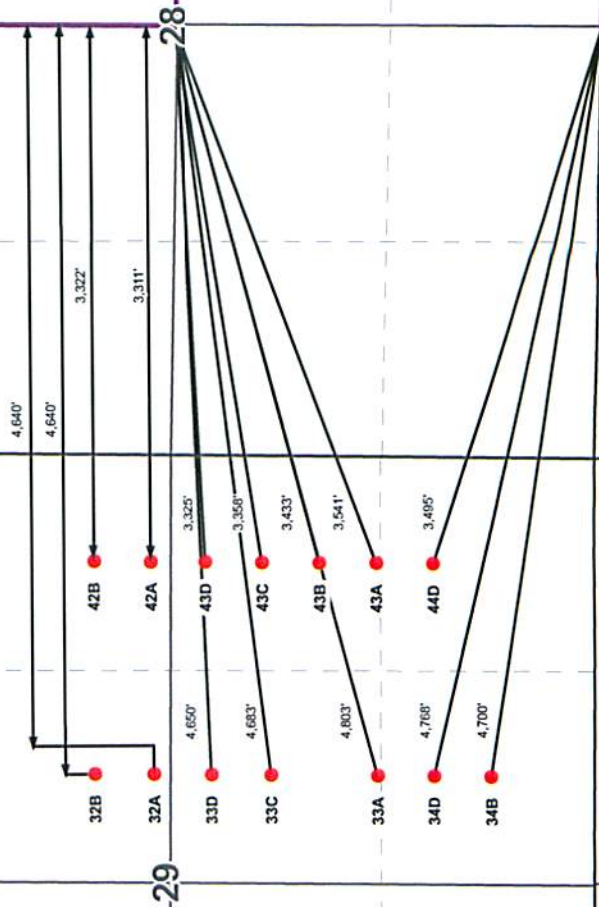

6S/91W