

# Location Drawing

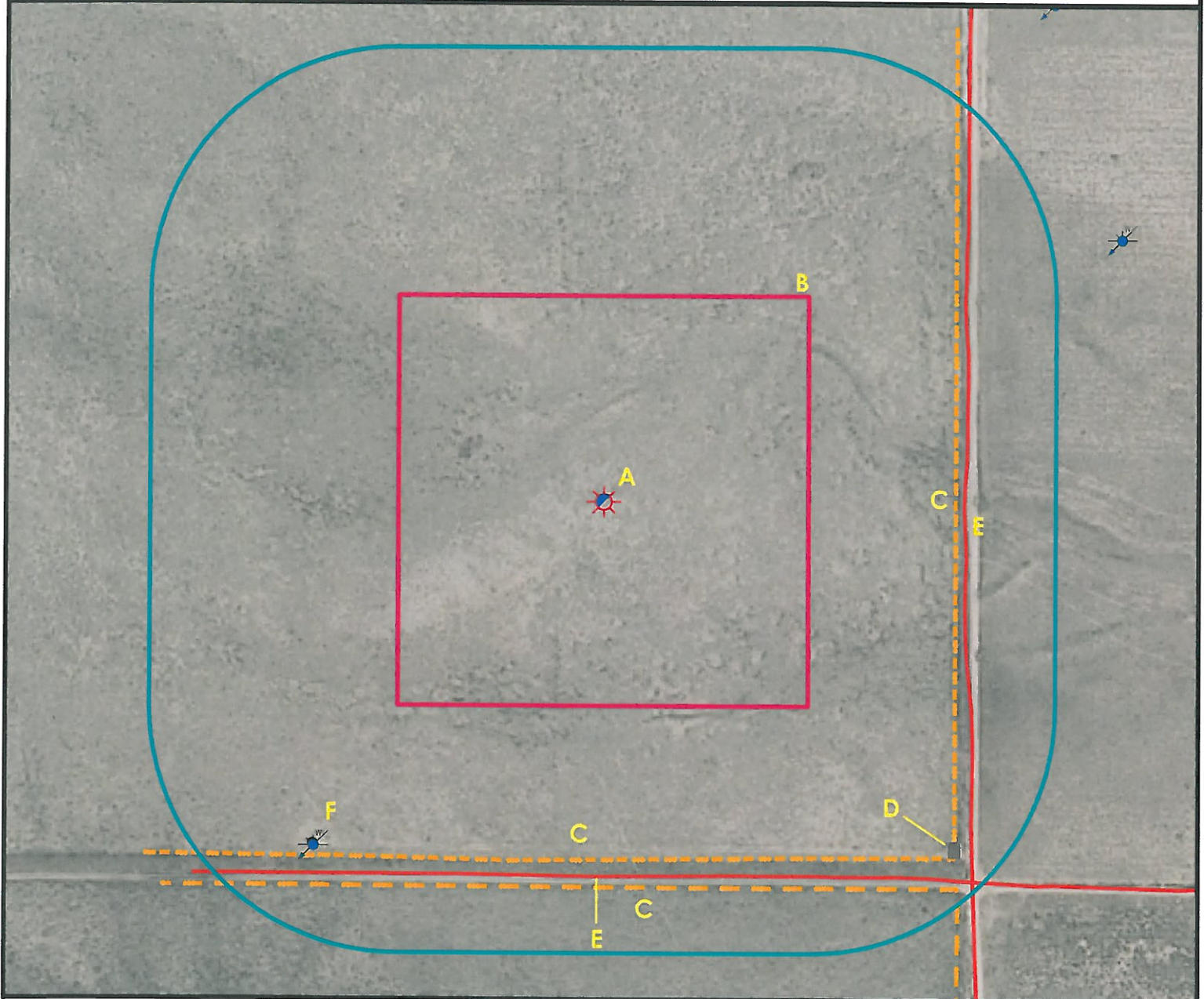

A. Proposed Well HUTCHISON 9-67-3-16H (SESE).

D. Cattle Guard is 796' SE.

B. Operational Disturbance Area.

E. Existing Roads are 582' E and 605' S.

C. Fences are 567' E, 582' S and 623' S.

F. Water Well (Permit #278893) is 725' SW.

**\*\* Operational Disturbance Area is 660' X 660' \*\***



## Legend

	Proposed Well		Building/Residence
	Existing Well		Disturbance Area
	Plugged Well		Water Body
	Water Well		Utility Box
	CattleGuard/Gate		Railroad
	Bridge		Fence
	ECD		Overhead Power Line
	400' Radius		Pipeline
	Facilities Enclosure		Private Road
			Ditch/Canal
			Concrete Ditch

## 400ft Radius Map HUTCHISON 9-67-3-16H (SESE)

Surface Location: T9N R67W S3  
Description of surface uses : Open Field

Field Date: 05/13/2010  
Drawing Date: 05/17/2010  
Drafter: DMM  
Checked By: BHF

Aerial Photo supplied by NAIP - 2009

Prepared for:  
**ANADARKO E&P  
COMPANY LP**



Use our resources to find yours!  
[www.petro-fs.com](http://www.petro-fs.com)

1801 W. 13th Ave Suite 207  
Denver, CO 80204  
(303) 928-7128  
111 E. Third Street  
Rifle, CO 81650  
(970) 625-4740