

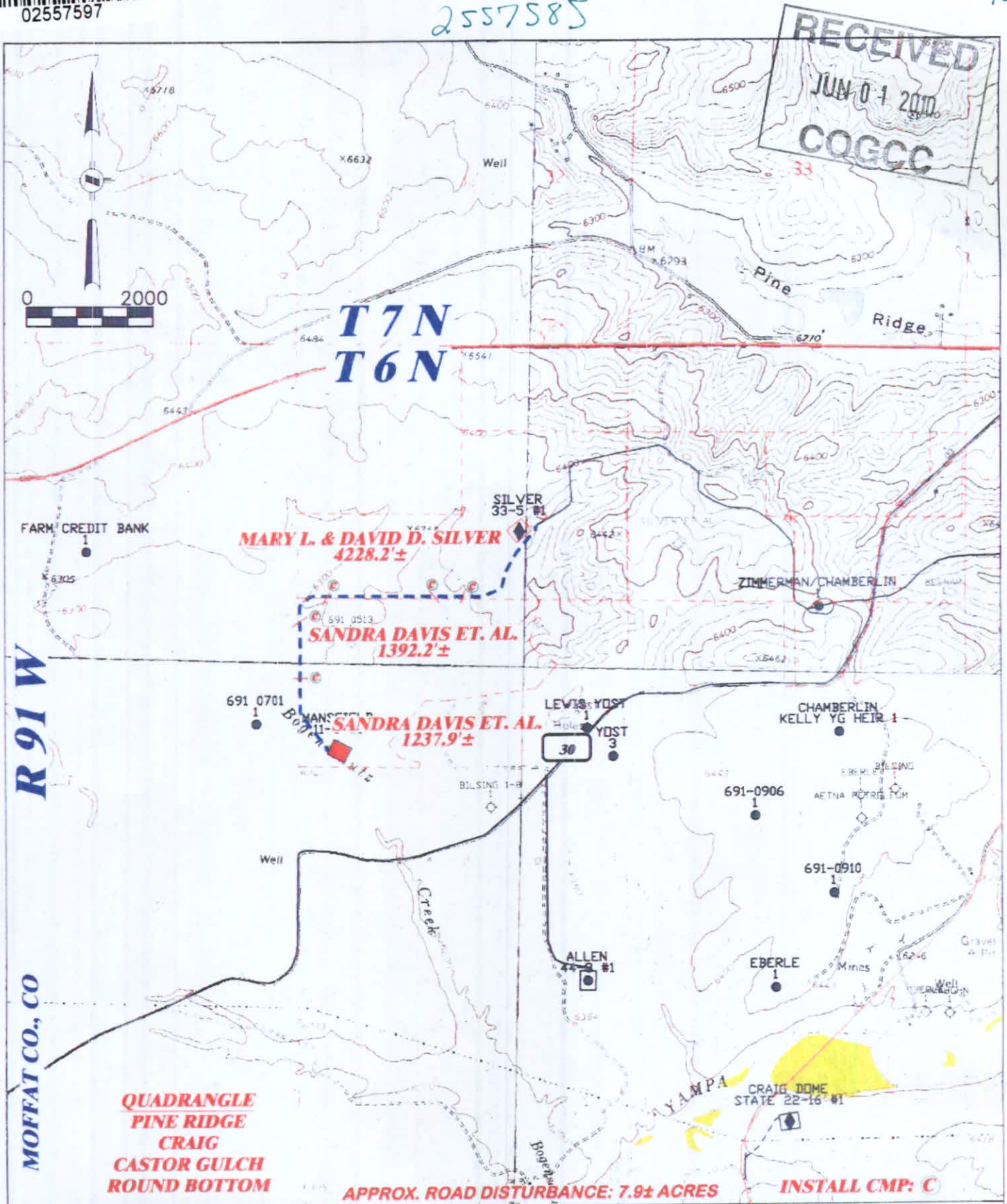

Access Road Map
2557585

1/2



DRG RIFFIN & ASSOCIATES, INC.

1414 ELK ST., ROCK SPRINGS, WY 82901

(307) 362-5028

DRAWN: 8/19/08 - MML

SCALE: 1" = 2000'

REVISED: NA

DRG JOB No. 16800

EXHIBIT 4

**PROPOSED ROAD FOR
SAMSON RESOURCES COMPANY
MANSFIELD 11-8 #1**

TOTAL PROPOSED LENGTH: 6,858.3±

PROPOSED ROAD - - - - -

EXISTING ROAD —————

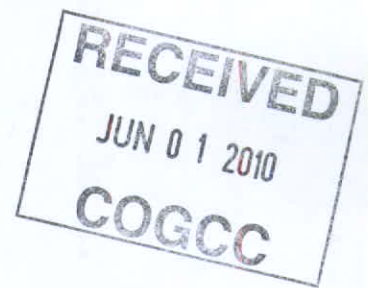

MANSFIELD 11-8 #1
SAMSON RESOURCES COMPANY
SEC. 8, T6N, R91W
MOFFAT, CO., COLORADO

Begin at the town of Craig, Colorado and drive westerly on State Highway 40 for 2.6 miles. Turn left onto County Road 30 and drive southwesterly for 1.0 mile. Turn right onto dirt road and drive westerly for 0.1 mile. Turn left onto proposed access road for Silver 33-5 #1 and bypass the Zimmerman/Chamberlin well. Drive northwesterly and then southwesterly for 1.4 miles. Drive past the Silver 33-5 #1 well onto the proposed access road for Mansfield 11-8 #1 and drive southwesterly for 1.3 miles to reach the proposed well site for Mansfield 11-8 #1