

# TOPOGRAPHIC LOCATION ROUNDTREE 24-27 1N46W

SECTION 27, TOWNSHIP 1 NORTH, RANGE 46 WEST, 6TH P.M.

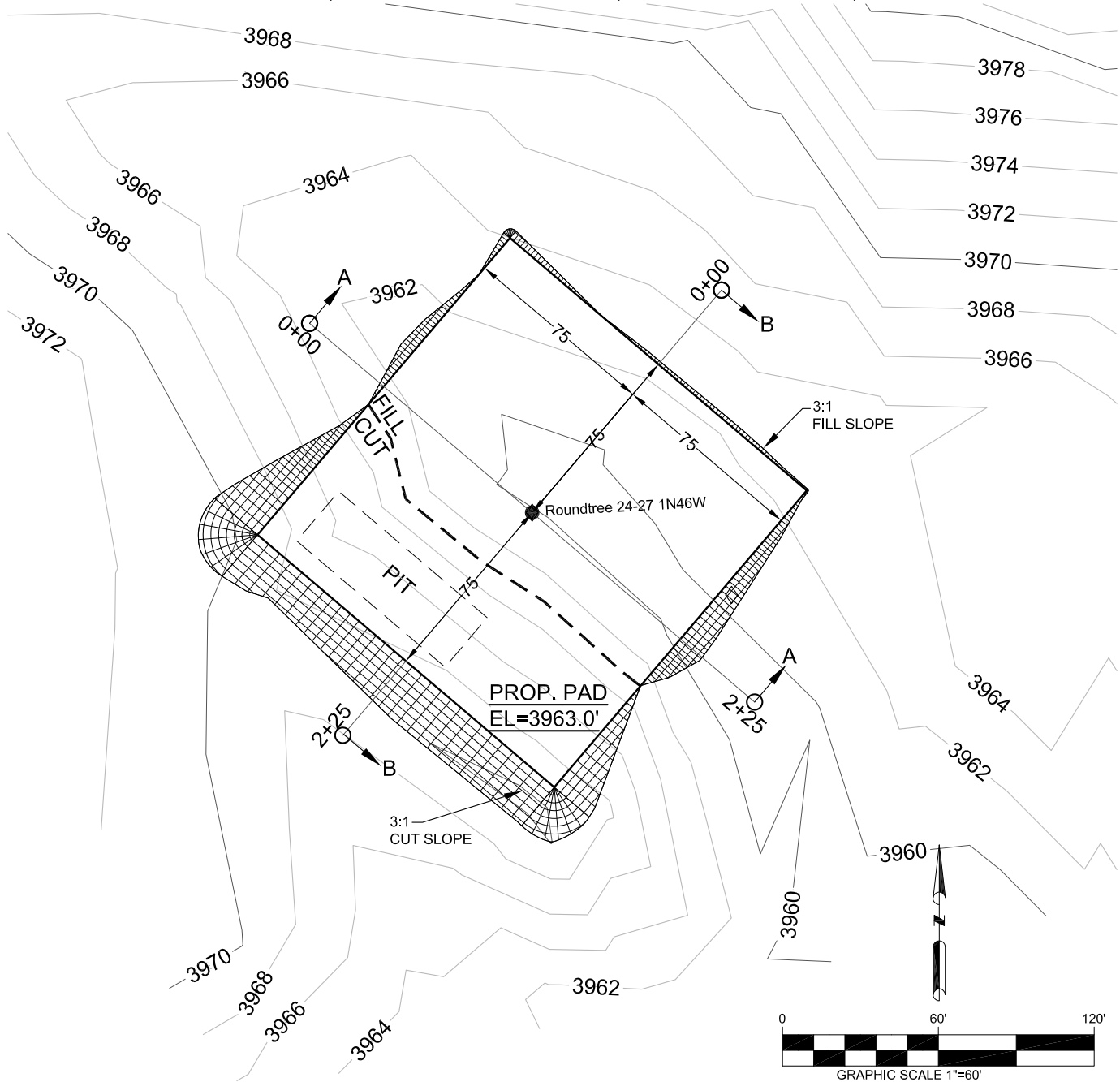

## WELL PAD LEGEND

- EXISTING CONTOUR
- PROPOSED CONTOUR
- EXISTING WELLHEAD
- PROPOSED WELLHEAD

## GENERAL NOTES:

1. ACCESS ROAD TO BE LOCATED IN THE FIELD AT DIRECTION OF THE FIELD REPRESENTATIVE.
2. EXCESS MATERIAL WILL BE STOCKPILED ON SITE IN A LOCATION SUITABLE TO THE FIELD REPRESENTATIVE.
3. EROSION CONTROL IS NOT A PART OF THIS SITE PLAN.
4. TOPSOIL SHALL BE STOCKPILED SEPARATELY UNTIL REPLACED AFTER WELL COMPLETION

PREPARED BY:



FIELD DATE:  
05-20-10

DRAWING DATE:  
05-25-10

BY:  
TBS

WELL NAME:  
ROUNDTREE 24-27 1N46W

SURFACE LOCATION:  
YUMA COUNTY, COLORADO  
SE 1/4, SW 1/4, SEC. 27, T1N, R46W

# PAD CROSS SECTIONS

## ROUNDTREE 24-27 1N46W

SECTION 27, TOWNSHIP 1 NORTH, RANGE 46 WEST, 6TH P.M.

### Roundtree 24-27 1N46W Cross Section A

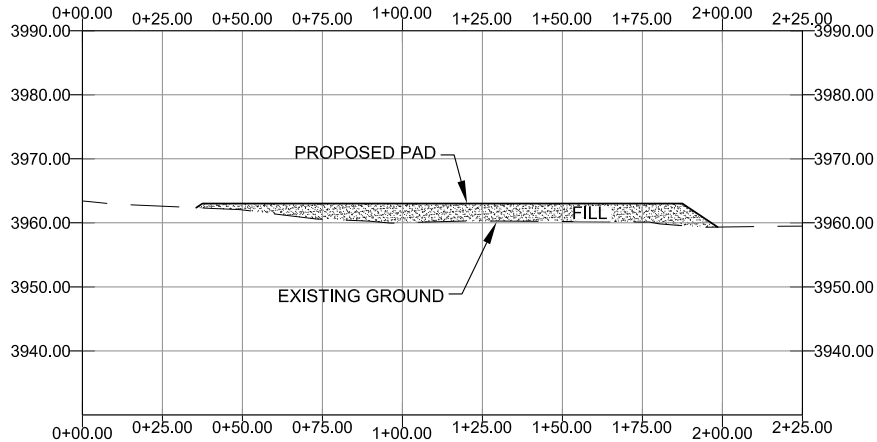

SCALES:  
HORIZONTAL: 1"=60'  
VERTICAL: 1"=30'

### Roundtree 24-27 1N46W Cross Section B

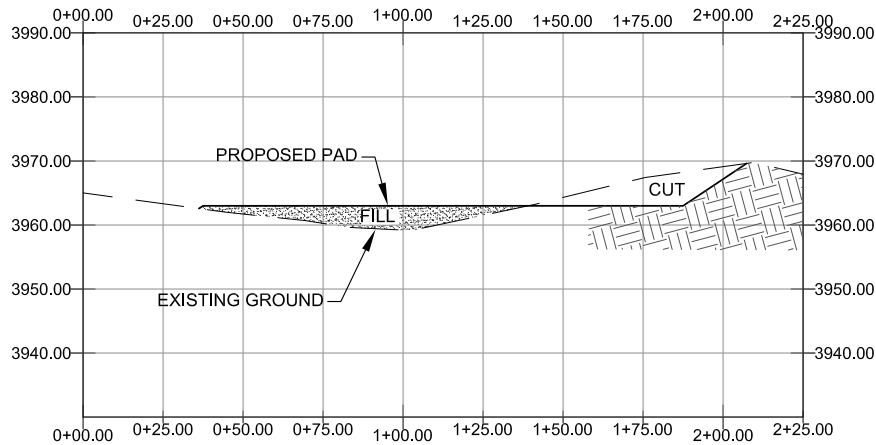

PREPARED BY:



FIELD DATE:  
05-20-10

DRAWING DATE:  
05-25-10

BY:  
TBS

WELL NAME:  
ROUNDTREE 24-27 1N46W

SURFACE LOCATION:  
YUMA COUNTY, COLORADO  
SE 1/4, SW 1/4, SEC. 27, T1N, R46W