

MINERAL RESOURCES
 RE-1 X7 4-6-31
 SURFACE LOCATION: SENW SEC. 31 T5N-R65W
 BOTTOM-HOLE LOCATION: SESW SEC 31 T5N-R65W

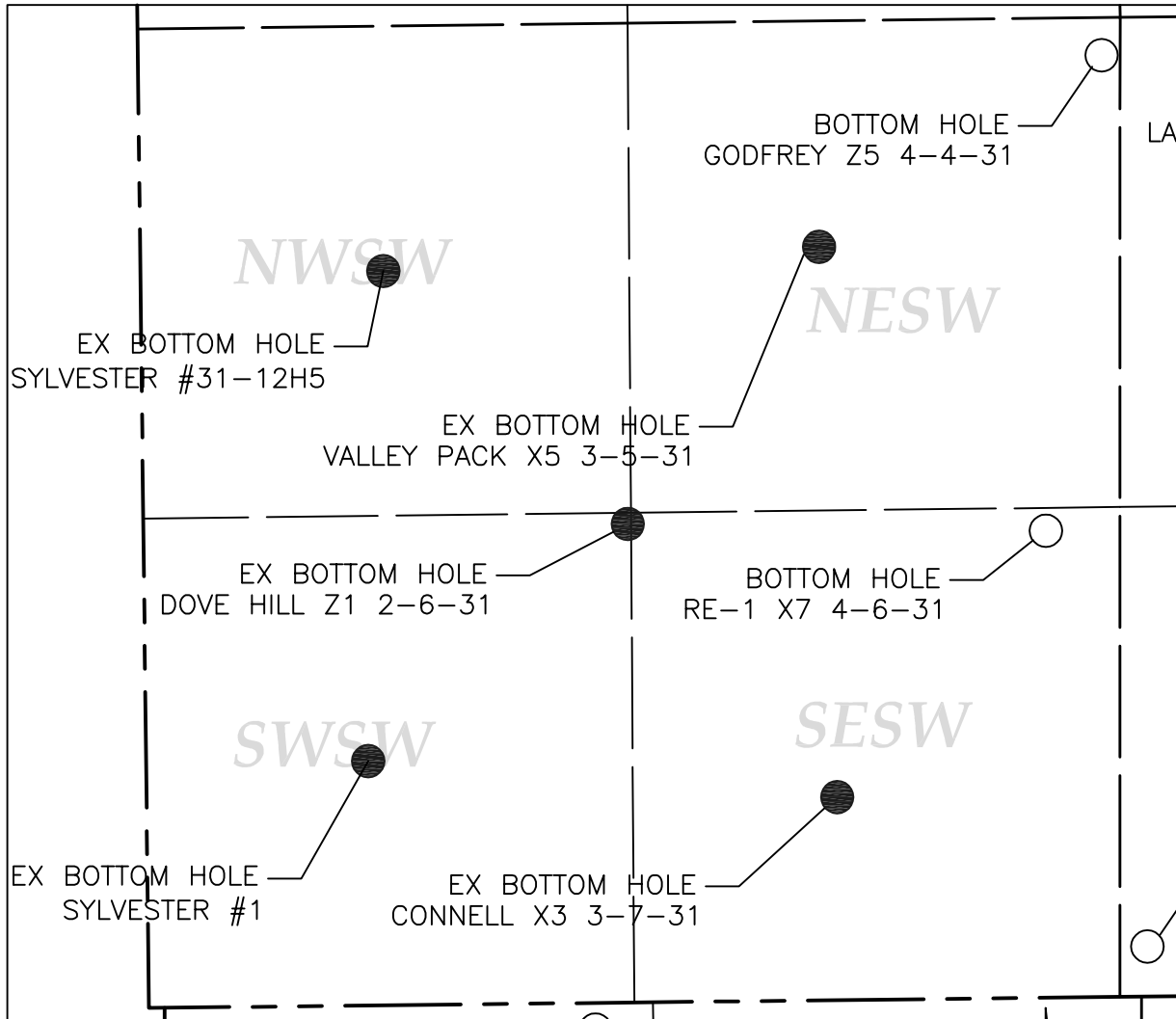

LAMP RYNEARSON
 & ASSOCIATES

4715 Innovation Drive 970.226.0342 | P
 Fort Collins, CO 80525 970.226.0879 | F
www.LRA-Inc.com

- BOTTOM HOLE LOCATIONS FOR EXISTING WELLS
- BOTTOM HOLE LOCATIONS FOR PROPOSED WELLS