

ECLIPSE
surveying

111 E. THIRD ST., SUITE 208, RIFLE, CO 81650
(970) 625-3048

SCALE: 1" = 80'
DATE: 02/19/10
SHEET: 3 OF 7
PROJECT: KAUF7
DFT: JAK

B Bill Barrett Corporation

KAUFMAN PAD 7 PHASE II
GRADING PLAN & PAD LAYOUT

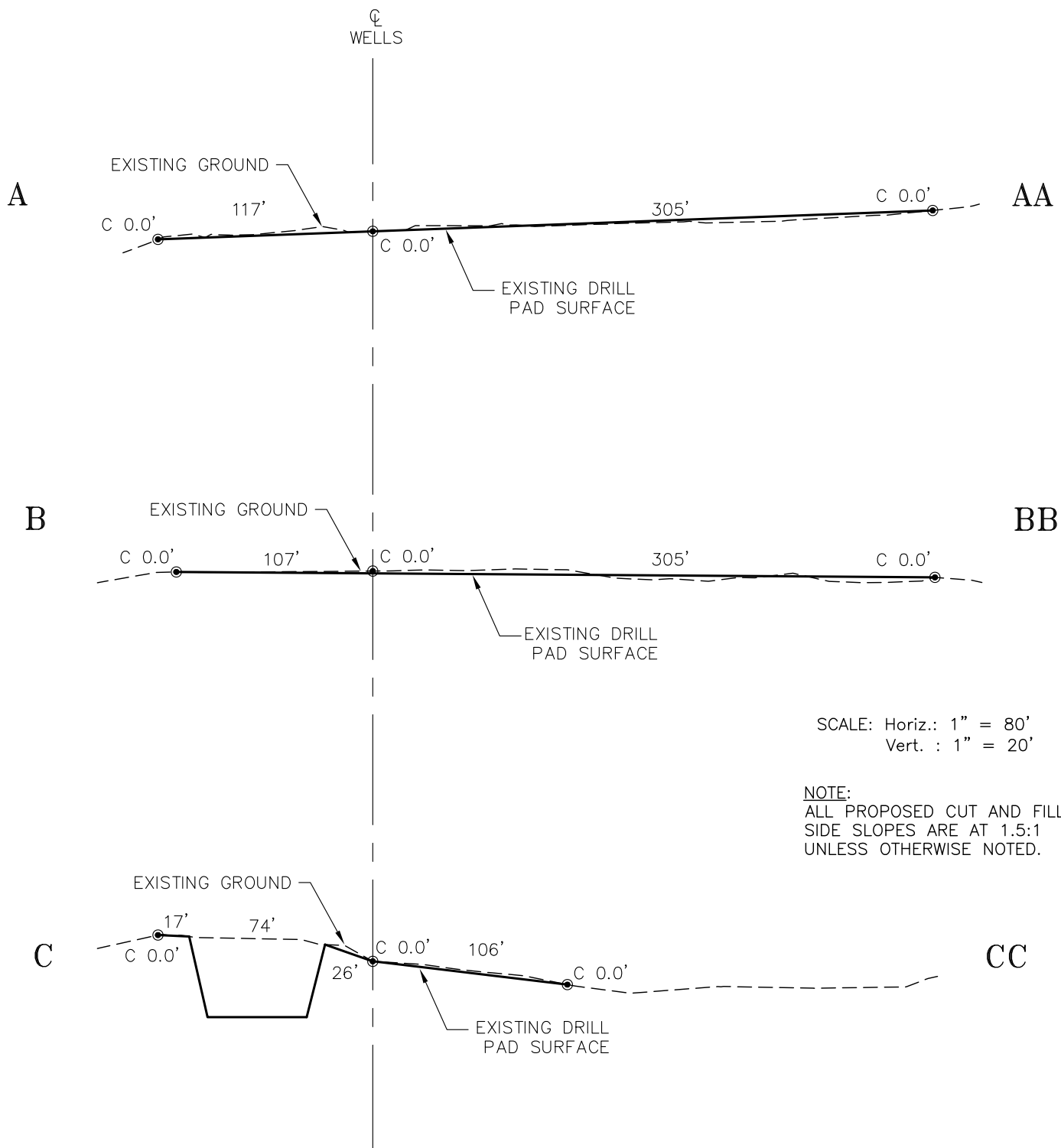

ECLIPSE
surveying

111 E. THIRD ST., SUITE 208, RIFLE, CO 81650
(970) 625-3048

SCALE: AS NOTED
DATE: 02/19/10
SHEET: 4 OF 7
PROJECT: KAUF7
DFT: JAK

B Bill Barrett Corporation

*KAUFMAN PAD 7 PHASE II
DRILL PAD CROSS SECTIONS*



111 E. THIRD ST., SUITE 208, RIFLE, CO 81650
(970) 625-3048

SCALE:	<u>1" = 80'</u>
DATE:	<u>02/19/10</u>
SHEET:	<u>5 OF 7</u>
PROJECT:	<u>KAUF7</u>
DFT:	<u>JAK</u>



Bill Barrett Corporation

KAUFMAN PAD 7 PHASE II
DRILL RIG LAYOUT

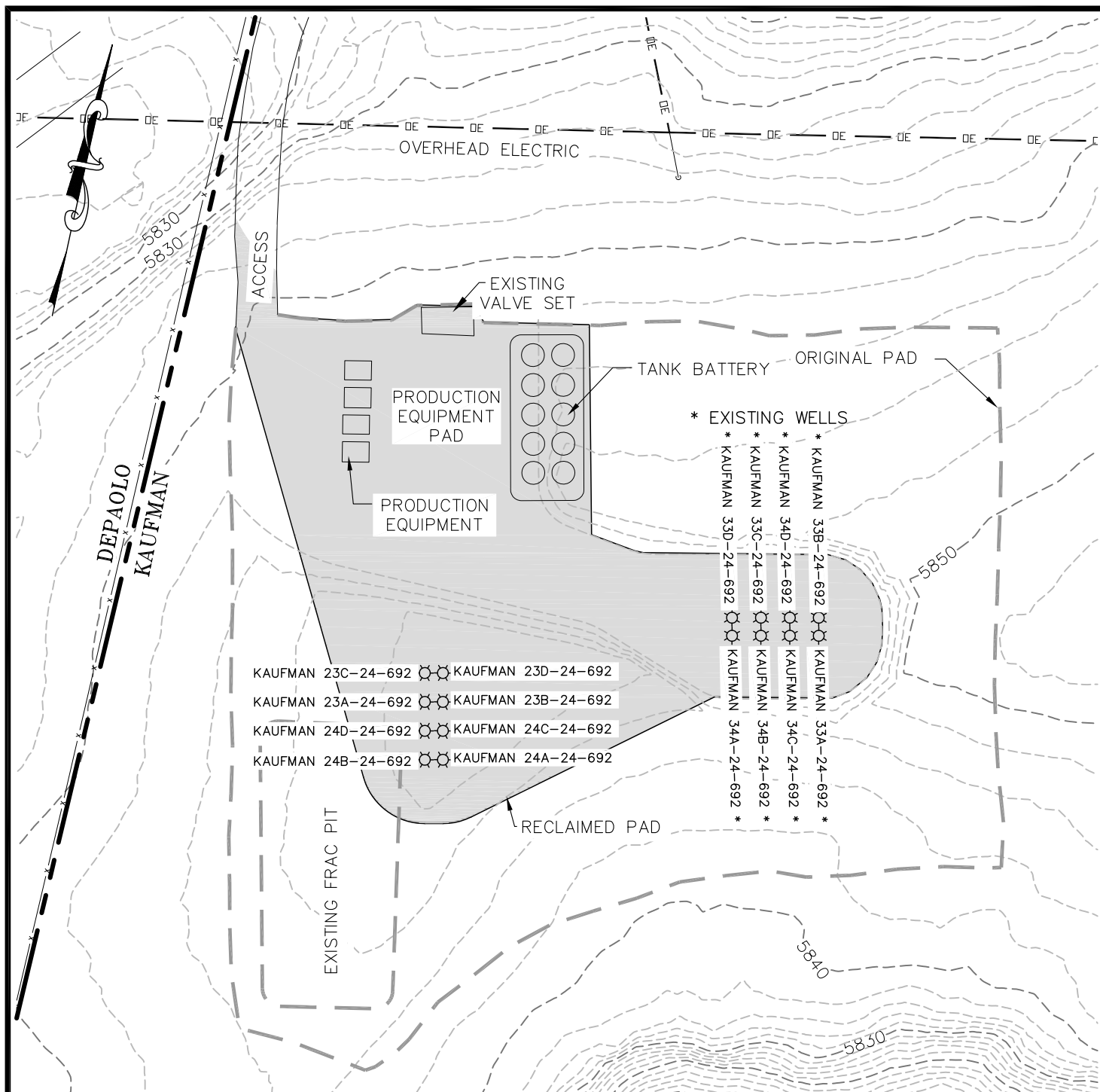

NOTES:

- 1) THIS IS A TYPICAL LAYOUT FOR THE PRODUCTION EQUIPMENT AND IS SUBJECT TO CHANGE DUE TO WELL PRODUCTION AND OPERATOR'S NEEDS.
- 2) PRODUCTION EQUIPMENT LAYOUT MUST MEET COGCC OFFSET REQUIREMENTS
- 3) TOTAL DISTURBED AREA INCLUDES TOPSOIL AND EXCESS MATERIAL STOCKPILE AREAS.
- 4) RECLAIMED SLOPES ARE VARIABLE.

TOTAL DISTURBED AREA = 495 AC.
 RECLAIMED AREA = 4.15 AC.
 UN-RECLAIMED AREA = 0.80 AC.
 (SHADED AREA)



ECLIPSE
 surveying

111 E. THIRD ST., SUITE 208, RIFLE, CO 81650
 (970) 625-3048

SCALE: 1" = 80'
 DATE: 02/19/10
 SHEET: 7 OF 7
 PROJECT: KAUF7
 DFT: JAK



Bill Barrett Corporation

*KAUFMAN PAD 7 PHASE II
 RECLAIMED PAD &
 PRODUCTION EQUIPMENT*