

ESTIMATED DIRT QUANTITIES

ITEM	CUT	FILL	TOPSOIL	EXCESS
PAD	0	0	0	0
TOTALS	0	0	0	0

NOTES:

1) NO ADDITIONAL EXCAVATION
WILL BE DONE FOR PHASE II
WELLS.



ECLIPSE
surveying

111 E. THIRD ST., SUITE 208, RIFLE, CO 81650
(970) 625-3048

SCALE:

1" = 100'

DATE:

03/15/10

SHEET:

1 OF 7

PROJECT:

08001

DFT:

JAK



Bill Barrett Corporation

KAUFMAN PAD 1 PHASE II
GRADING PLAN & PAD LAYOUT

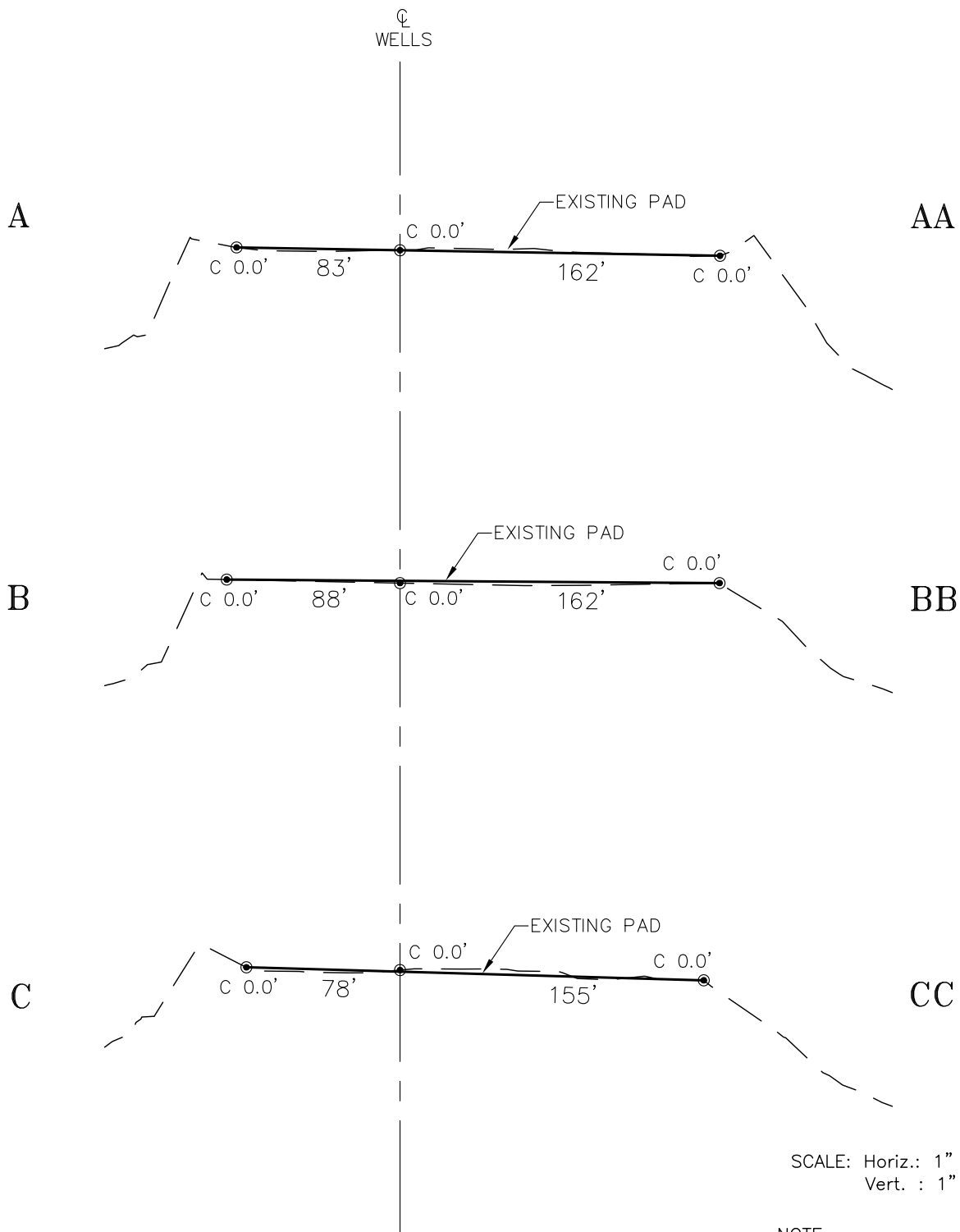

SCALE: Horiz.: 1" = 80'
 Vert. : 1" = 20'

NOTE:
 ALL PROPOSED CUT AND FILL
 SIDE SLOPES ARE AT 1.5:1
 UNLESS OTHERWISE NOTED.



ECLIPSE
 surveying

111 E. THIRD ST., SUITE 208, RIFLE, CO 81650
 (970) 625-3048

SCALE: AS NOTED
 DATE: 03/15/10
 SHEET: 2 OF 7
 PROJECT: 08001
 DFT: JAK

B Bill Barrett Corporation

*KAUFMAN PAD 1 PHASE II
 DRILL PAD CROSS SECTIONS*

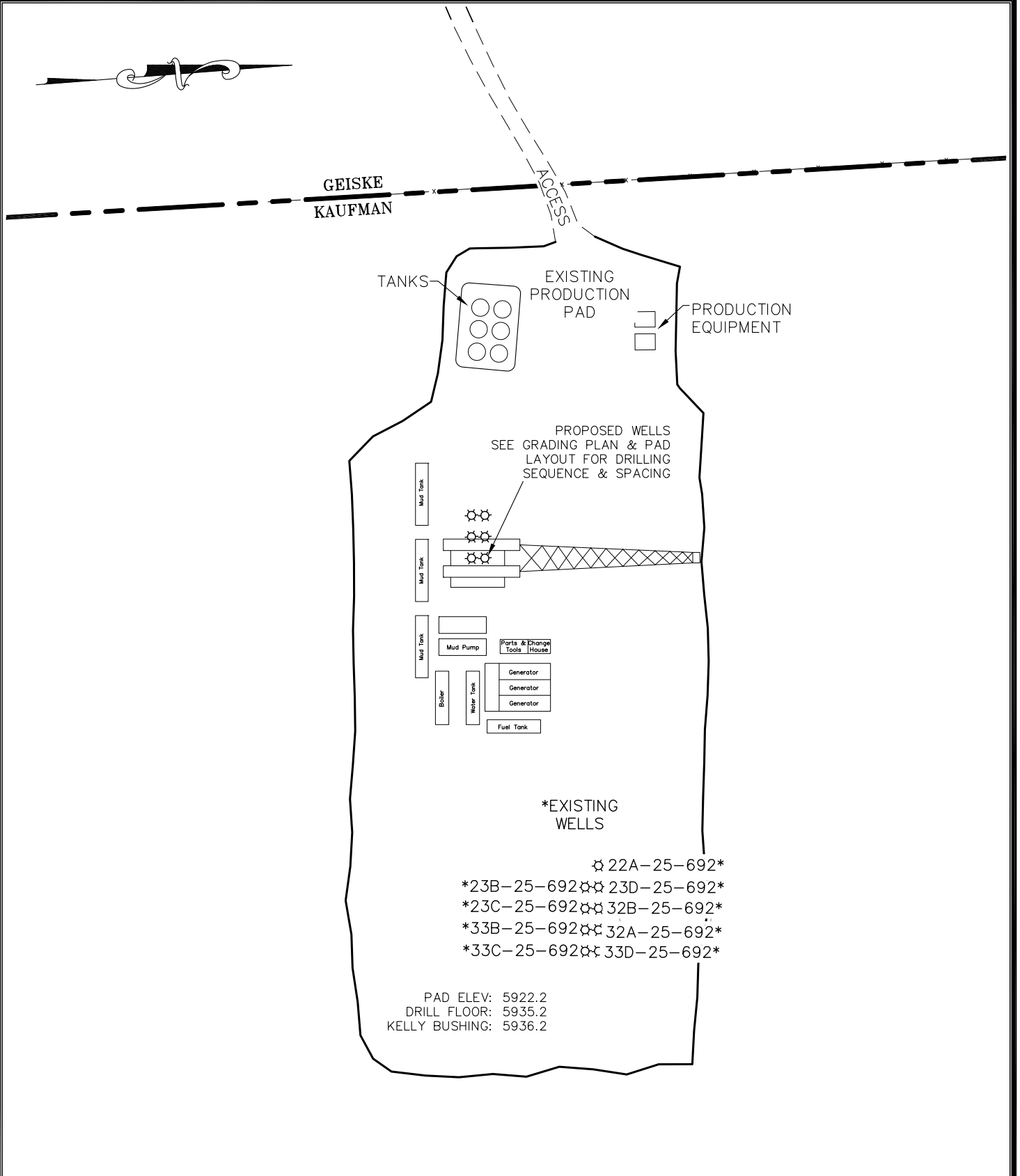

ECLIPSE
surveying

111 E. THIRD ST., SUITE 208, RIFLE, CO 81650
(970) 625-3048

SCALE: 1" = 100'
DATE: 03/15/10
SHEET: 3 OF 7
PROJECT: 08001
DFT: JAK

B Bill Barrett Corporation

*KAUFMAN PAD 1 PHASE II
DRILL RIG LAYOUT*

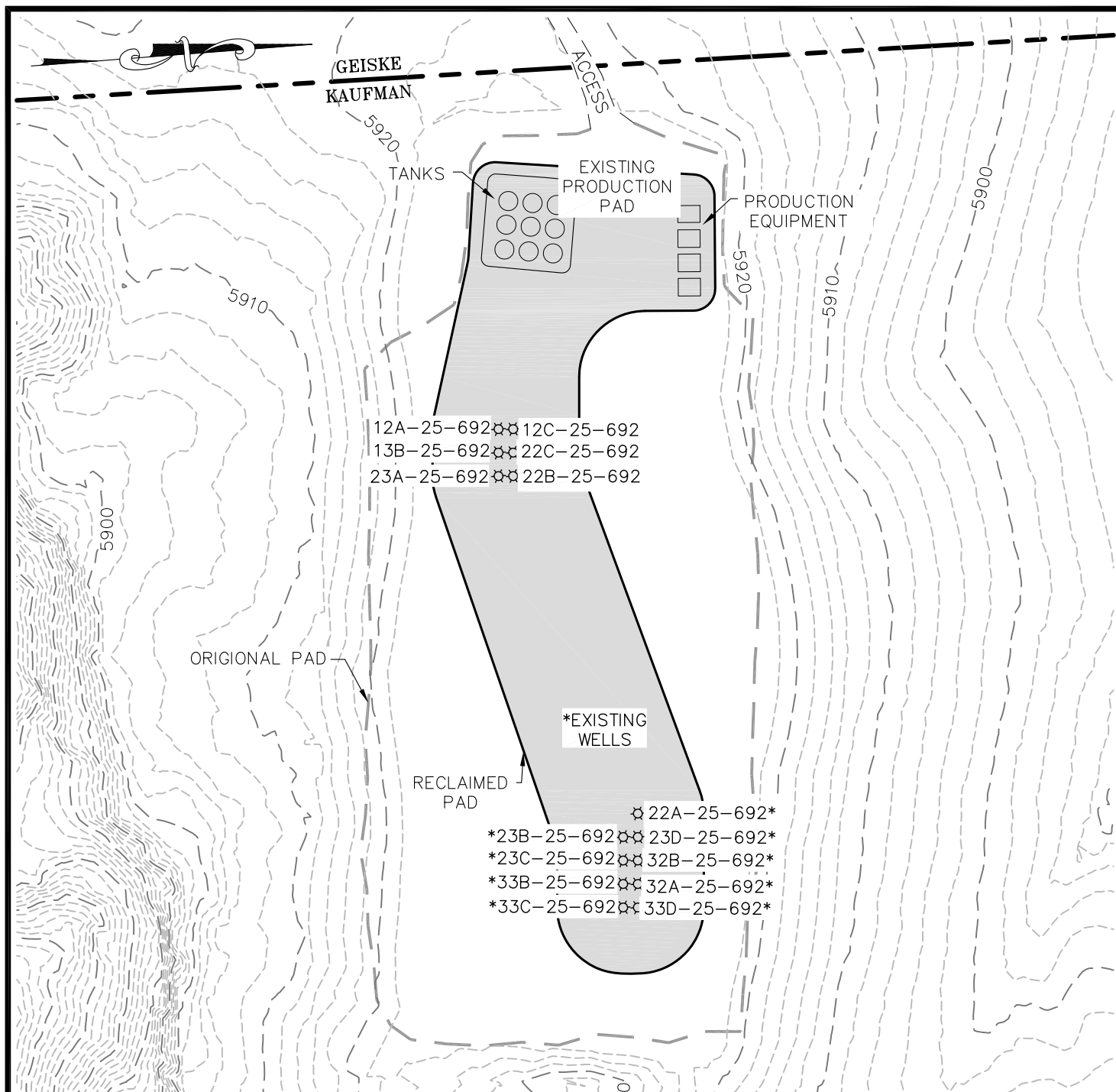

NOTES:

- 1) THIS IS A TYPICAL LAYOUT FOR THE PRODUCTION EQUIPMENT AND IS SUBJECT TO CHANGE DUE TO WELL PRODUCTION AND OPERATOR'S NEEDS.
- 2) PRODUCTION EQUIPMENT LAYOUT MUST MEET COGCC OFFSET REQUIREMENTS
- 3) TOTAL DISTURBED AREA INCLUDES TOPSOIL AND EXCESS MATERIAL STOCKPILE AREAS.
- 4) RECLAIMED SLOPES ARE 1:6 UNLESS OTHERWISE NOTED.

TOTAL DISTURBED AREA = 5.15 ac.
 RECLAIMED AREA = 3.72 ac.
 UN-RECLAIMED AREA = 1.43 ac.
 (SHADED AREA)



ECLIPSE
 surveying

111 E. THIRD ST., SUITE 208, RIFLE, CO 81650
 (970) 625-3048

SCALE: 1" = 100'
 DATE: 03/15/10
 SHEET: 5 OF 7
 PROJECT: 08001
 DFT: JAK



Bill Barrett Corporation

*KAUFMAN PAD 1 PHASE II
 RECLAIMED PAD &
 PRODUCTION EQUIPMENT*