

Longhorn B5-36H
Section 36 T12N R63W
Weld County, CO

Project: DJ - Hereford Ranch
Site: Longhorn B5-36H
Well: Longhorn B5-36H
Plan: APD

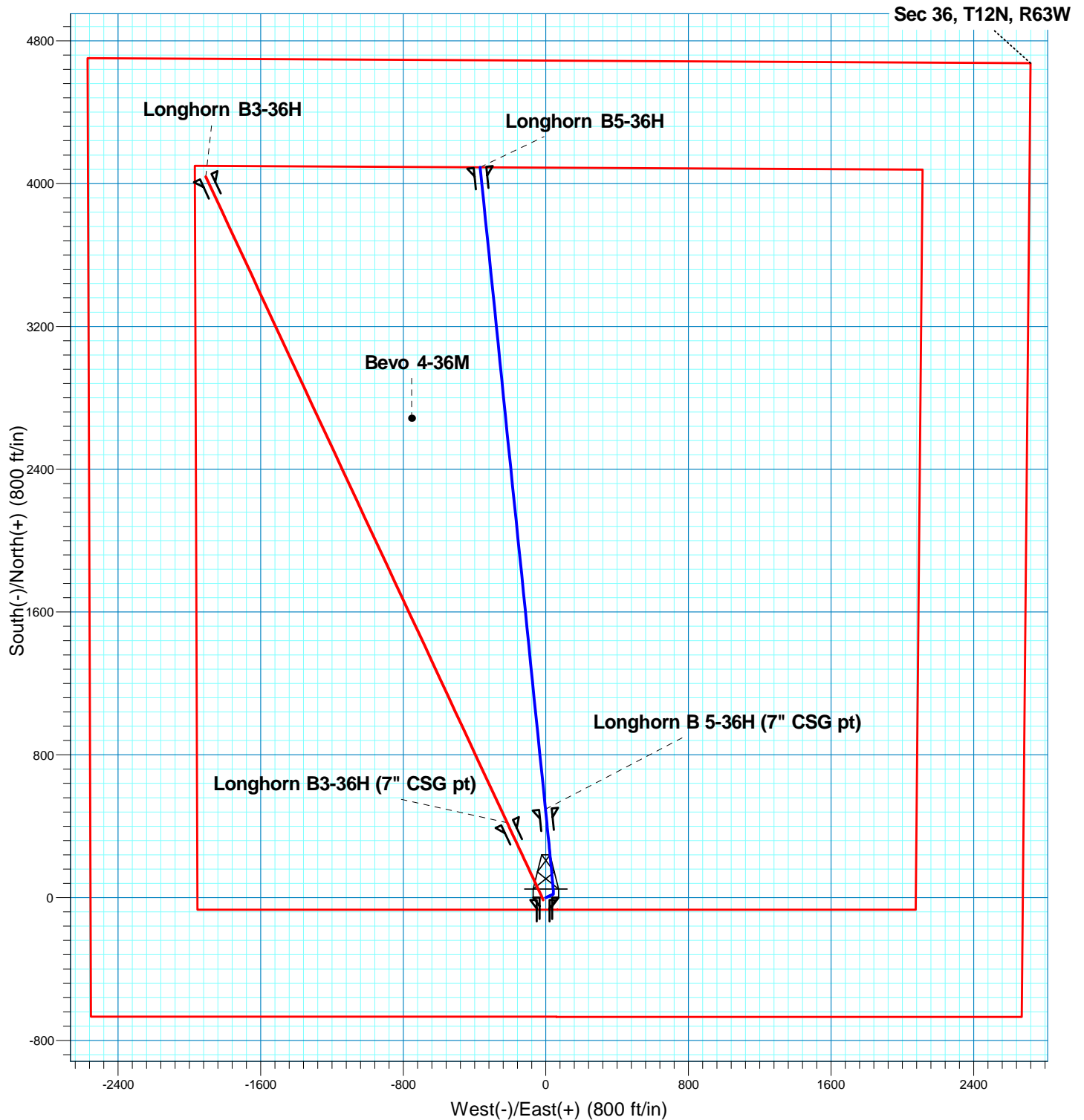

Wellbore Center to Center Distances
B3-36H CSG pt to B5-36H CSG pt = 227'
B3-36H BHL to B5-36H BHL = 1540'
Bevo 4-36M to B3-36H = 475'
Bevo 4-36M to B5-36H = 523'



Azimuths to True North
Magnetic North: 8.83°

Magnetic Field
Strength: 53606.0snT
Dip Angle: 67.62°
Date: 3/29/2010
Model: IGRF200510