

### Well Name: Ryland 42-20D

Surface Location: EEE 21-21DU/Ryland Pad Sec.21-T4N-R67W  
 North American Datum 1983 , US State Plane 1983 , Colorado Northern Zone  
 Ground Elevation: 4922.0

+N/-S+E/-W Northing Easting Latitude Longitude Slot  
 0.0 0.0 1353668.22 3166017.22 40° 18' 9.684 N 104° 54' 17.136 W  
 Original Well Elev WELL @ 4935.0ft (Original Well Elev)

### PETROLEUM DEVELOPMENT CORP Weld County CO

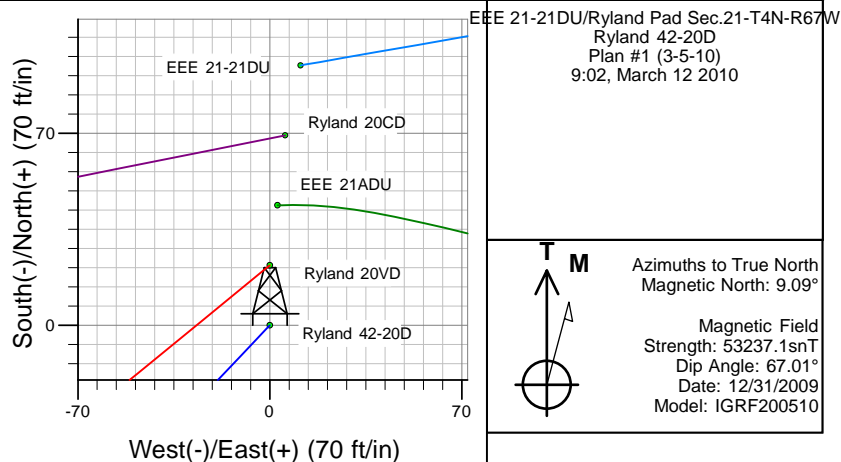
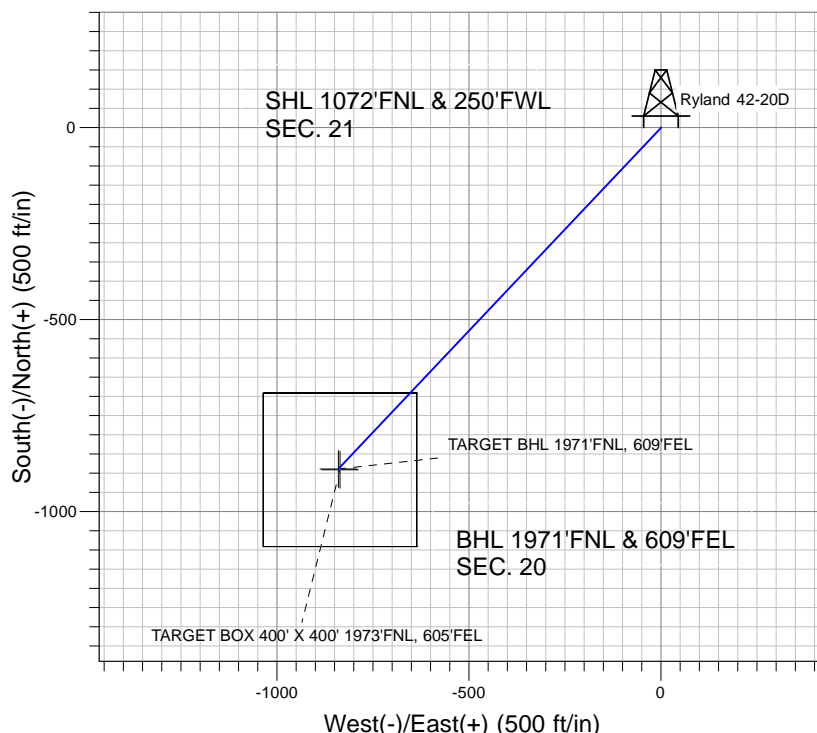
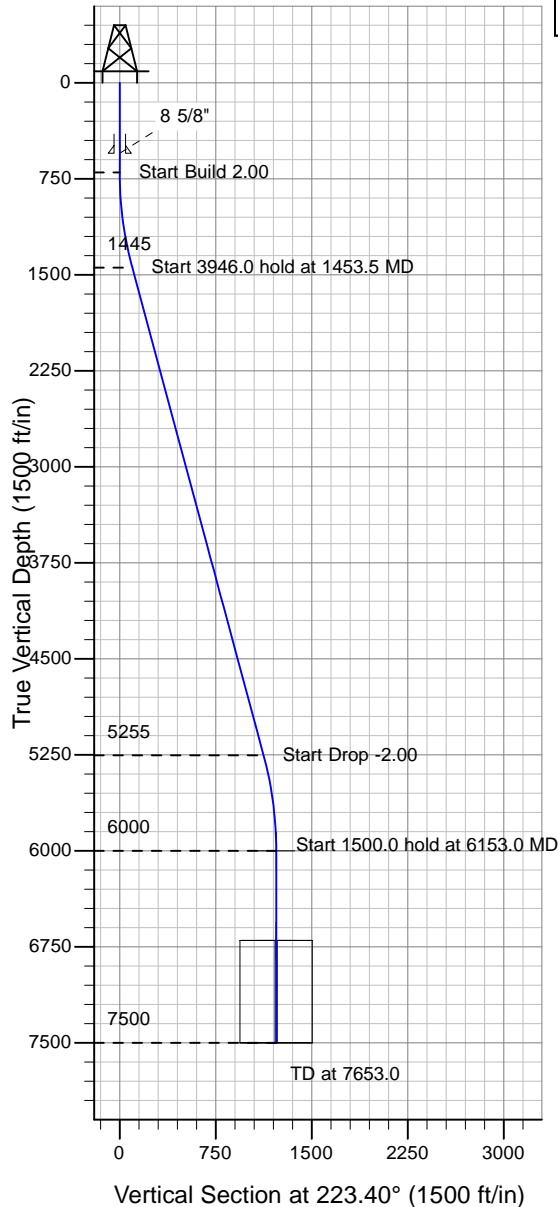

Azimuths to True North  
 Magnetic North: 9.09°  
 Magnetic Field  
 Strength: 53237.1snT  
 Dip Angle: 67.01°  
 Date: 12/31/2009  
 Model: IGRF200510

#### WELLBORE TARGET DETAILS (LAT/LONG)

Name	TVD	+N/-S	+E/-W	Latitude	Longitude	Shape
TARGET BHL 1971'FNL, 609'FEL	6000.0	-888.6	-840.3	40° 18' 0.903 N	104° 54' 27.981 W	Point
TARGET BOX 400' X 400' 1973'FNL, 605'FEL	6700.0	-890.6	-836.3	40° 18' 0.883 N	104° 54' 27.930 W	Rectangle (Sides: L400.0 W400.0)

#### SECTION DETAILS

Sec	MD	Inc	Azi	TVD	+N/-S	+E/-W	DLeg	TFace	VSec	Target
1	0.0	0.00	0.00	0.0	0.0	0.0	0.00	0.00	0.0	
2	700.0	0.00	0.00	700.0	0.0	0.0	0.00	0.00	0.0	
3	1453.5	15.07	223.40	1444.8	-71.6	-67.7	2.00	223.40	98.5	
4	5399.5	15.07	223.40	5255.2	-817.0	-772.6	0.00	0.00	1124.5	
5	6153.0	0.00	0.00	6000.0	-888.6	-840.3	2.00	180.00	1223.0	TARGET BHL 1971'FNL, 609'FEL
6	7653.0	0.00	0.00	7500.0	-888.6	-840.3	0.00	0.00	1223.0	