

ESTIMATED DIRT QUANTITIES				
ITEM	CUT	FILL	TOPSOIL	EXCESS
PAD	18541	12700	5914	73
TOTALS	18541	12700	5914	73

NOTES:

- 1) TOPSOIL VOLUME BASED ON 12" TOPSOIL DEPTH.
- 2) USE EXCESS MATERIAL TO BUILD BERMS FOR NOISE AND VISUAL MITIGATION.
- 3) 1-1/2:1 SIDESLOPES UNLESS OTHERWISE NOTED



ECLIPSE
surveying

111 E. THIRD ST., SUITE 208, RIFLE, CO 81650
(970) 625-3048

SCALE: 1" = 100'
DATE: 02/10/10
SHEET: 3 OF 7
PROJECT: 08001
DFT: JAK

Bill Barrett Corporation

GGU 14-19
GRADING PLAN & PAD LAYOUT

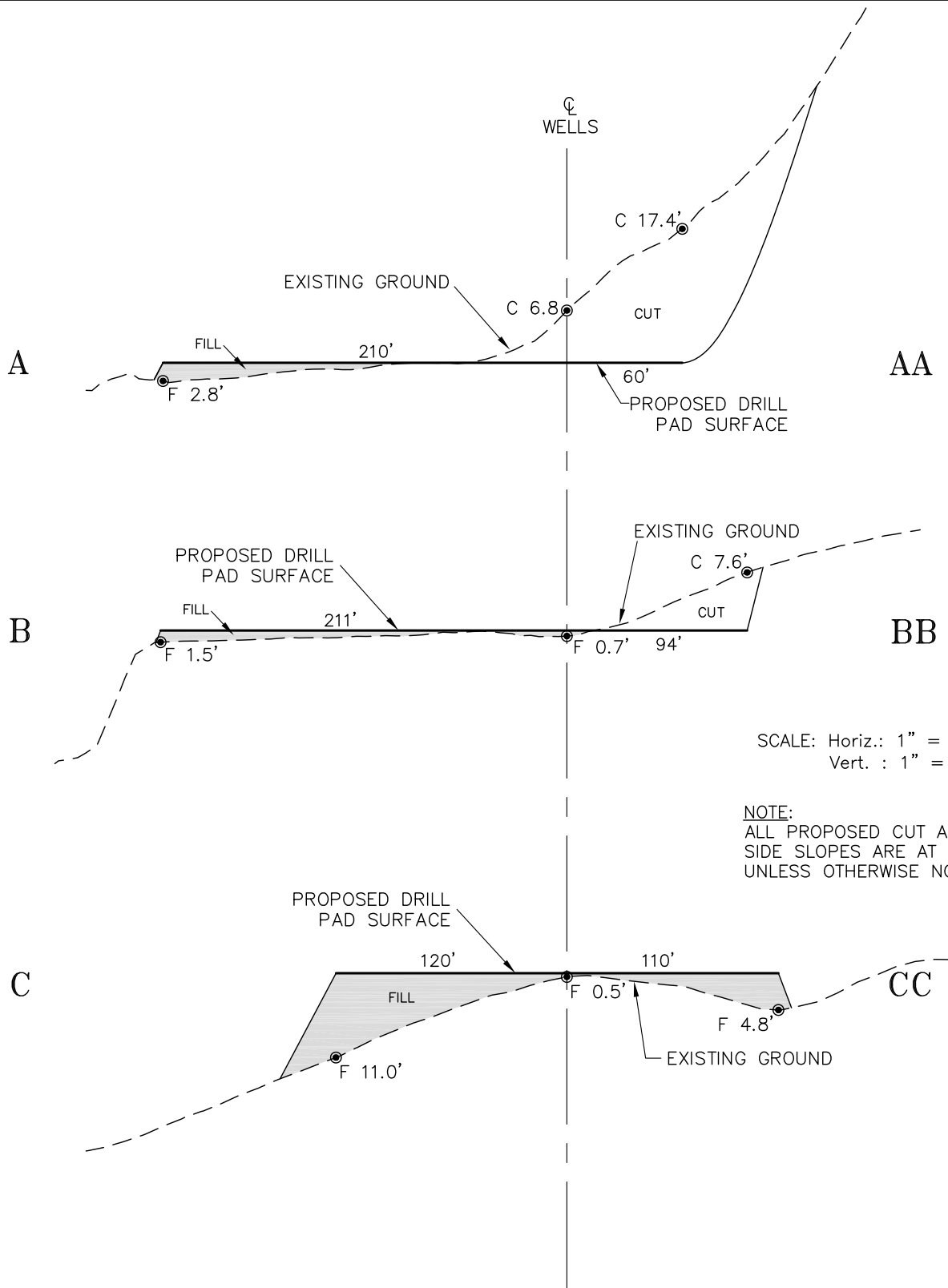

ECLIPSE
surveying

111 E. THIRD ST., SUITE 208, RIFLE, CO 81650
(970) 625-3048

SCALE: AS NOTED
DATE: 02/03/10
SHEET: 4 OF 7
PROJECT: 08001
DFT: JAK

Bill Barrett Corporation

GGU 14-19
DRILL PAD CROSS SECTIONS

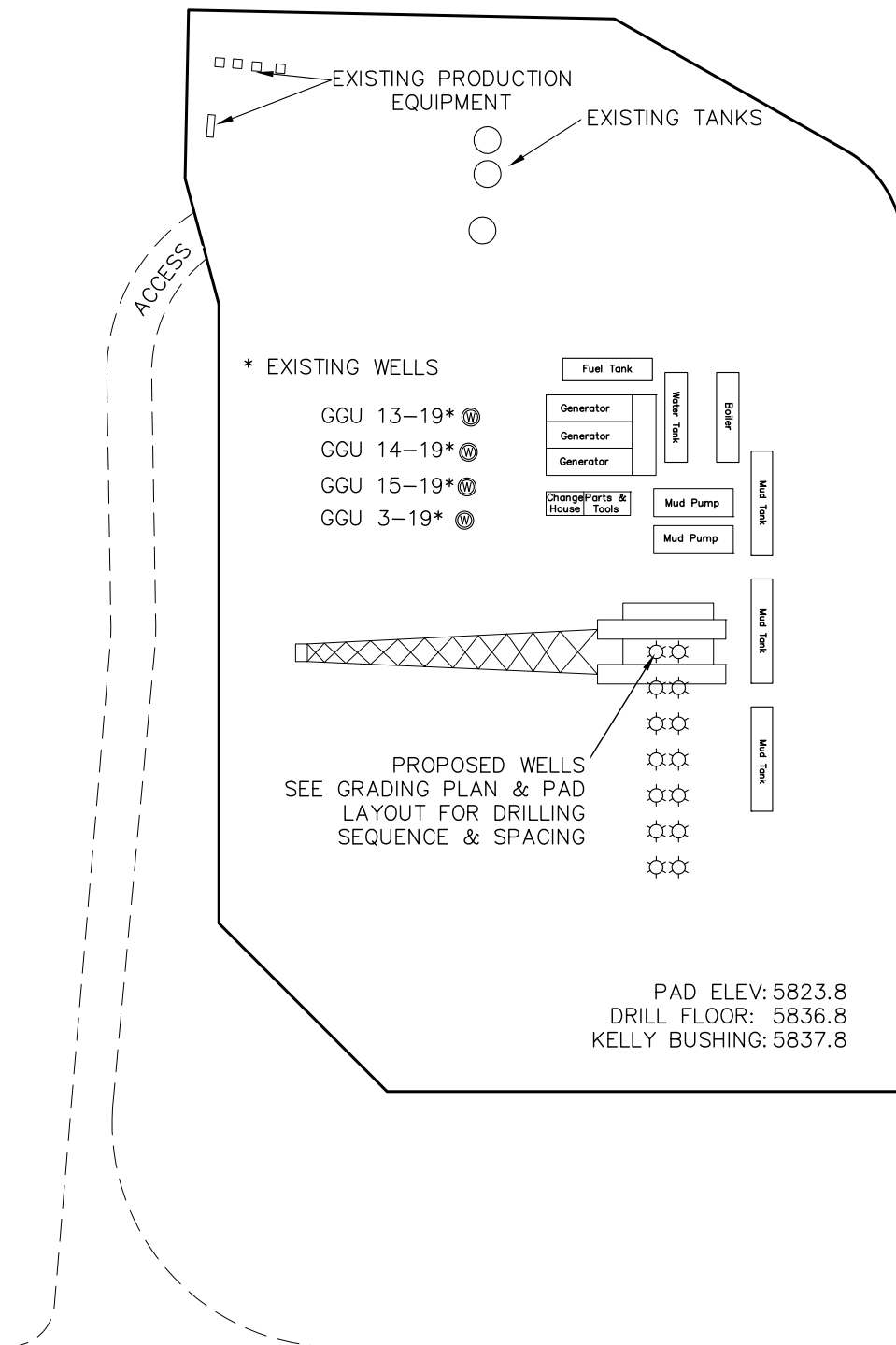

ECLIPSE
surveying

111 E. THIRD ST., SUITE 208, RIFLE, CO 81650
(970) 625-3048

SCALE: 1" = 80'
DATE: 02/10/10
SHEET: 5 OF 7
PROJECT: 08001
DFT: JAK

B Bill Barrett Corporation

GGU 14-19
DRILL RIG LAYOUT

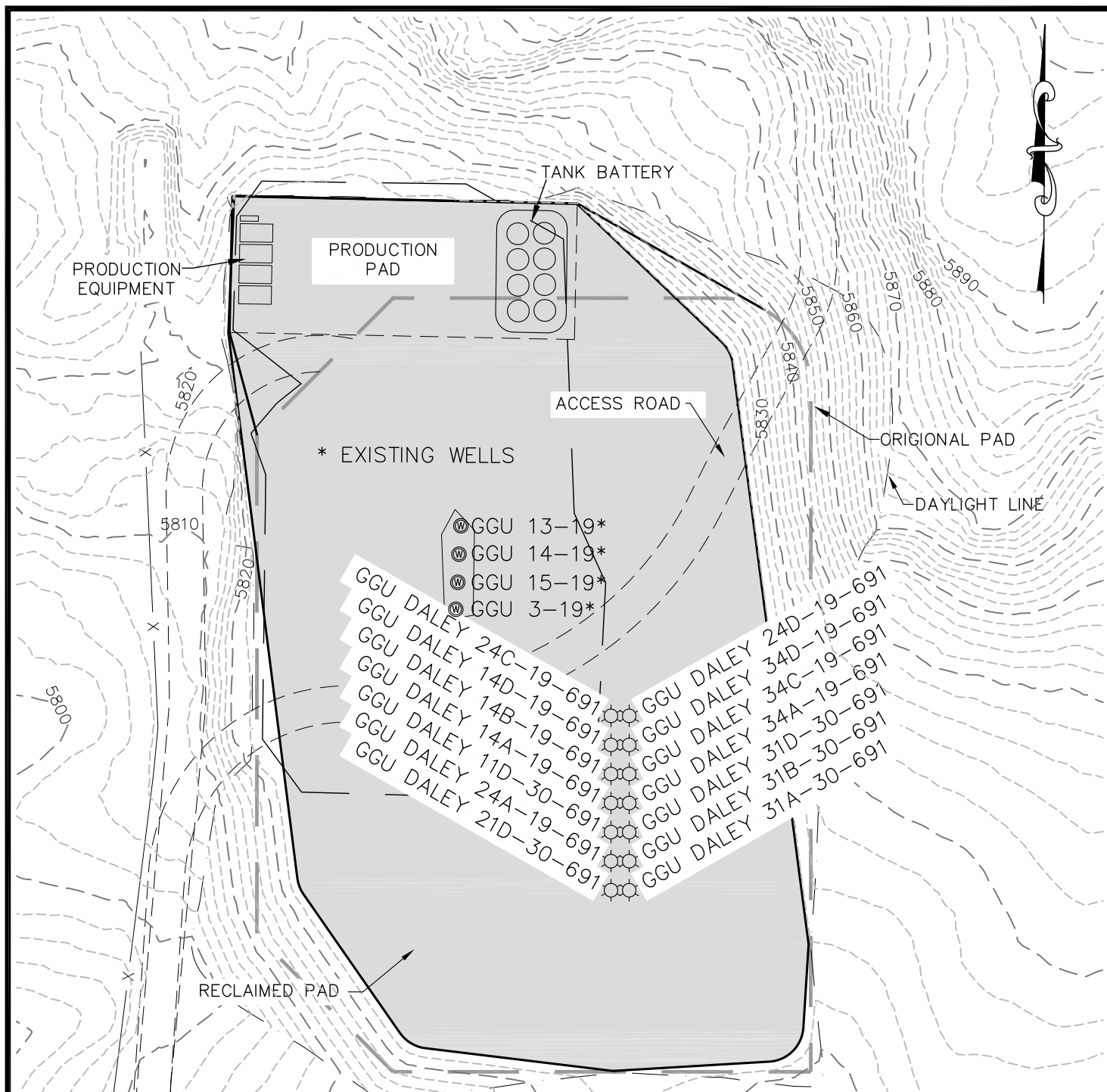

NOTES:

- 1) THIS IS A TYPICAL LAYOUT FOR THE PRODUCTION EQUIPMENT AND IS SUBJECT TO CHANGE DUE TO WELL PRODUCTION AND OPERATOR'S NEEDS.
- 2) PRODUCTION EQUIPMENT LAYOUT MUST MEET COGCC OFFSET REQUIREMENTS
- 3) TOTAL DISTURBED AREA INCLUDES TOPSOIL AND EXCESS MATERIAL STOCKPILE AREAS.
- 4) RECLAIMED SLOPES ARE VARIABLE.

TOTAL DISTURBED AREA = 4.58 ac.
 RECLAIMED AREA = 1.70 ac.
 UN-RECLAIMED AREA = 2.86 ac.
 (SHADED AREA)



ECLIPSE
 surveying

111 E. THIRD ST., SUITE 208, RIFLE, CO 81650
 (970) 625-3048

SCALE: 1" = 80'
 DATE: 02/10/10
 SHEET: 7 OF 7
 PROJECT: 08001
 DFT: JAK

B Bill Barrett Corporation

GGU 14-19
 RECLAIMED PAD &
 PRODUCTION EQUIPMENT