

# Federal DOE 3-W-29

PA 523-29, PA 423-29, PA 513-29, PA 12-29, PA 312-29, PA 412-29,  
PA 512-29, PA 323-29, PA 314-29, PA 414-29, PA 514-29, PA 614-29,  
PA 13-29, PA 313-29, PA 413-29



PHOTO: VIEW OF EXISTING DRILL PAD AND EQUIPMENT

CAMERA ANGLE: WEST

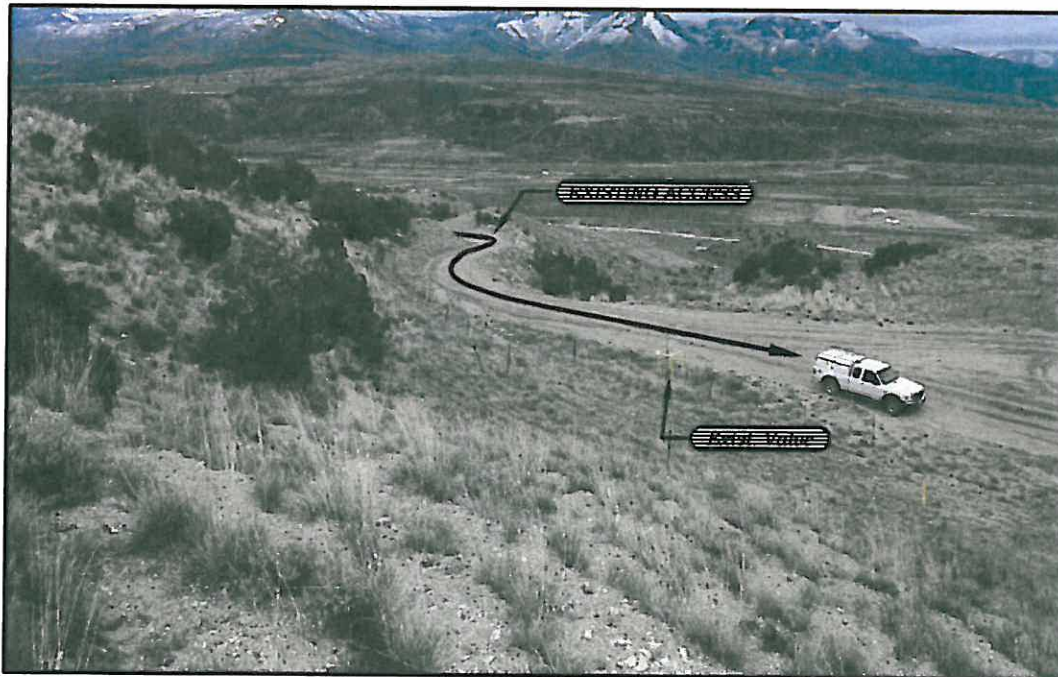

PHOTO: VIEW OF EXISTING ACCESS ROAD TO DRILL PAD

CAMERA ANGLE: SOUTHEAST

## LOCATION PHOTOS Prepared for:



Williams Production, RMT

SE1/4 SW1/4, SECTION 29  
T. 6 S., R. 95 W. of the 6th. P.M.  
GARFIELD COUNTY, COLORADO

136 East Third Street  
Rifle, Colorado 81650  
Ph. (970) 625-1330  
Fax (970) 625-2773



**BOOKCLIFF**  
Survey Services, Inc.

PHOTO DATE: 4/17/09  
TAKEN BY: DPM  
DRAWN BY: DPM  
SHEET: 1 of 3  
PROJECT: Williams



# Federal DOE 3-W-29

PA 523-29, PA 423-29, PA 513-29, PA 12-29, PA 312-29, PA 412-29,  
PA 512-29, PA 323-29, PA 314-29, PA 414-29, PA 514-29, PA 614-29,  
PA 13-29, PA 313-29, PA 413-29

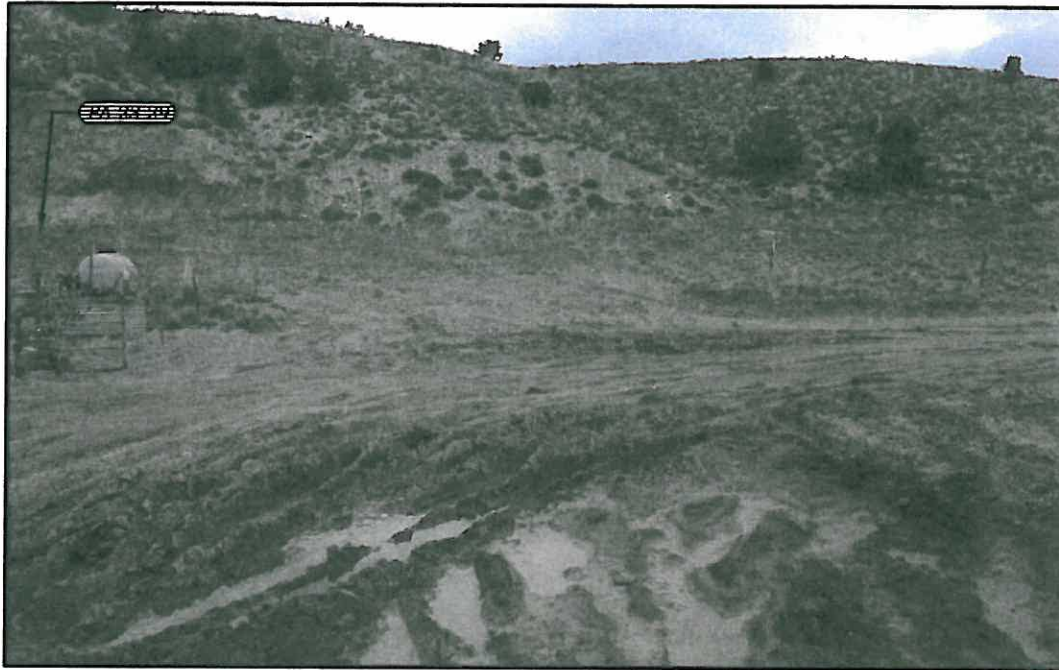

PHOTO: VIEW OF EXISTING DRILL PAD

CAMERA ANGLE: NORTH



PHOTO: VIEW OF EXISTING DRILL PAD

CAMERA ANGLE: SOUTH

136 East Third Street  
Rifle, Colorado 81650  
Ph. (970) 625-1330  
Fax (970) 625-2773



**BOOKCLIFF**  
Survey Services, Inc.

PHOTO DATE: 4/17/09  
TAKEN BY: DPM  
DRAWN BY: DPM  
SHEET: 2 of 3  
PROJECT: Williams



**LOCATION PHOTOS Prepared for:**

Williams Production, RMT

SE1/4 SW1/4, SECTION 29  
T. 6 S., R. 95 W. of the 6th. P.M.  
GARFIELD COUNTY, COLORADO



# Federal DOE 3-W-29

PA 523-29, PA 423-29, PA 513-29, PA 12-29, PA 312-29, PA 412-29,  
PA 512-29, PA 323-29, PA 314-29, PA 414-29, PA 514-29, PA 614-29,  
PA 13-29, PA 313-29, PA 413-29



PHOTO: VIEW OF EXISTING DRILL PAD

CAMERA ANGLE: EAST

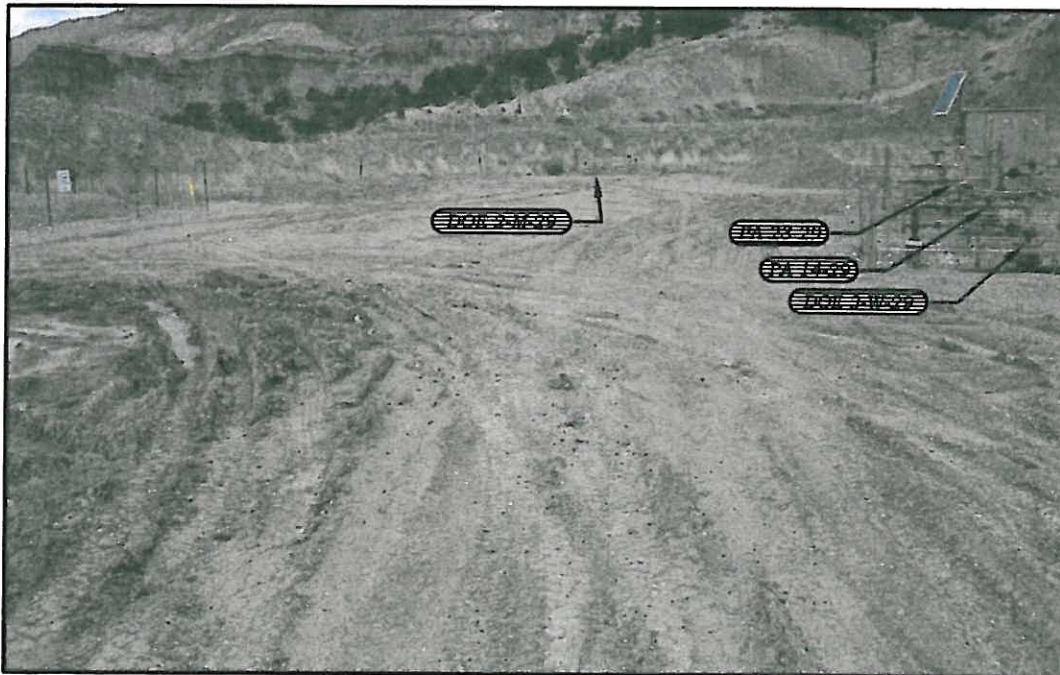

PHOTO: VIEW OF EXISTING DRILL PAD

CAMERA ANGLE: WEST

136 East Third Street  
Rifle, Colorado 81650  
Ph. (970) 625-1330  
Fax (970) 625-2773



**BOOKCLIFF**  
Survey Services, Inc.

PHOTO DATE: 4/17/09  
TAKEN BY: DPM  
DRAWN BY: DPM  
SHEET: 3 of 3  
PROJECT: Williams

**LOCATION PHOTOS Prepared for:**  
**Williams.** Williams Production, RMT

SE1/4 SW1/4, SECTION 29  
T. 6 S., R. 95 W. of the 6th. P.M.  
GARFIELD COUNTY, COLORADO