

Power Surveying Co., Inc. of Frederick, Colorado has in accordance with a request from SHERRY GLASS for KP KAUFFMAN

determined the location of KAMMERZELL 7-7-24

to be 2031' FNL & 1829' FEL Section 7, Township 4 NORTH

Range 66 WEST of the Sixth Principal Meridian,
WELD County, Colorado

LOCATION NOTES

LOCATION FALLS IN: PASTURE

IMPROVEMENTS: EXISTING WELL 50' NW OF LOCATION,
SEPARATOR 145' NORTH OF LOCATION, E-W FENCE 121' NORTH OF LOCATION

ELEVATION DETERMINED FROM NAVD 1988 DATUM.
GROUND ELEVATION = 4730'

DISTANCES AND BEARINGS ARE FIELD MEASURED
UNLESS OTHERWISE NOTED.

LEGEND

- SECTION CORNER (AS NOTED)
- ▼ PROPOSED WELL LOCATION
- ⊗ BOTTOM OF HOLE LOCATION.

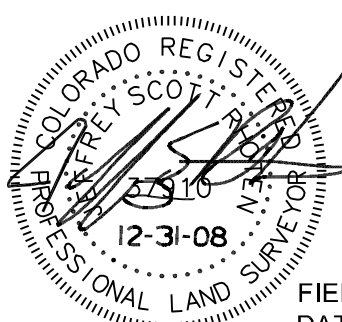

7800 MILLER DRIVE UNIT C
FREDERICK, COLORADO 80504
303-702-1617

Jeffery Scott Rhoten
COLORADO P.L.S. #37910

FIELD DATE: 12-18-06 WO# 501-06-1120A
DATE OF COMPLETION: 12-31-08