

SURFACE USE AGREEMENT

THIS SURFACE USE AGREEMENT ("Agreement"), dated effective this 16th day of December, 2009, is made by and between the undersigned, Lyle Dickens and Sandra Dickens, whose address is 19607 WCR 50.5, LaSalle, Colorado 80645 herein called "Owner", and Noble Energy, Inc., 1625 Broadway, Suite 2200, Denver, Colorado 80202, herein called "Noble";

WHEREAS, Owner represents that they are the surface owners and in possession of an interest in part or all of the surface estate for the following described lands in Weld County, Colorado, said land herein called "Lands", to wit;

Township 5 North, Range 65 West, 6th P.M.
 Section 32: SW/4NE/4
 DICKENS F32-7X
 DICKENS F32-17D
 DICKENS F32-27D
 DICKENS F32-28D

WHEREAS, Owner recognizes that Noble has the right to conduct operations on the Lands pursuant to Oil & Gas Lease(s) covering the Lands and Owner and Noble desire to minimize any surface damage to the Lands and to reach an agreement regarding such surface damage;

NOW, THEREFORE, in consideration and other valuable consideration, the sufficiency of which is hereby acknowledged, Owner and Noble agree as follows:

1. Payment to Owner. Prior to commencement of drilling operations on the Lands, Noble shall pay Owner the following sum as full settlement and satisfaction of all damages growing out of, incident to, or in connection with the usual and customary exploration, drilling, completion, deepening, refracing, recompletion, reworking, equipping and production operations, unless otherwise specifically provided herein:

A. for the proposed wellsite DICKENS F32-7X, —
 for the proposed wellsite DICKENS F32-17D,
 for the proposed wellsite DICKENS F32-27D, and
 for the proposed wellsite DICKENS F32-28D, located on the Lands in which Owner owns the entire surface estate, together with any lands used for road purposes, production facilities, pipelines, flowlines or other necessary facilities in connection with the wellsite.

B. If, by reasons directly resulting from the operations of Noble, there is damage to real or personal property upon the Lands which is not associated with usual

and customary operations, including, but not limited to, damage to livestock, structures, buildings, fences, culverts, cement ditches, irrigation systems, and natural water ways, such damage will be repaired or replaced by Noble, or Noble will pay reasonable compensation to Owner for such additional actual damage or an amount equal to the reasonable costs to repair such actual damages.

C. Owner agrees to notify any surface tenant that may be affected by Noble's operations on the Lands and Owner may allocate the payments made hereunder with such surface tenant as they shall mutually determine between themselves and Noble shall have no liability therefor.

2. Consultation. If requested by Owner, prior to heavy equipment operations on each wellsite, Noble's representative will meet and consult with Owner (or Owner's representative) as to the location of the wellsite, access road, flowlines, tank batteries and other associated production facilities.

3. Noble Obligations. In conducting operations on the Lands, Noble shall:

A. Locate the wellsite, access road, flowlines, tank batteries and other associated production facilities as depicted on Exhibit "A" attached hereto and by this reference made a part of this Agreement.

B. Limit the size of each wellsite to approximately 350 feet by 400 feet during any drilling, completion, recompletion or workover operations and shall be no more than 1/4 acre in size during other periods. The area required for any tank battery location associated with each well shall be limited to approximately one-half acre in size upon completion of construction. Access roads shall be limited to approximately 30 feet in width during drilling, completion, deepening, refracing, recompletion, reworking, equipping and production operations. The permanent access roads to the wellhead and tank battery location shall be limited to 15 feet in width.

C. Separate the topsoil at the time of excavation of pits so that the topsoil and subsurface soil can be placed back in proper order as nearly as possible.

D. Reclaim the wellsite as nearly as practicable to its original condition and if the location is in pasture, reseed the location with native grasses. Weather permitting, reclamation operations shall be completed within three months following drilling and subsequent related operations, unless Noble and Owner mutually agree to postponement because of crop or other considerations.

E. Use reasonable efforts to keep the well, Lands, and production facilities free of weeds and debris.

F. Regarding a wellsite that is located in alfalfa fields, the Surface Owner shall have the option to either have Noble reseed the affected area at Noble sole cost, risk and expense, or reseed the affected area itself and receive payment from Noble in the

NOBLE ENERGY, INC.



By:  PNM BB
P. David Padgett
Manager of Lands, D.J. Basin 

Exhibit "A"

Attached to and by reference made a part of that certain Surface Use Agreement dated December 16, 2009, by and between Noble Energy, Inc. as "Noble" and Lyle Dickens and Sandra Dickens, as "Surface Owner" covering the following lands:

Township 5 North, Range 65 West, 6th P.M.
Section 32: SW/4NE/4
Weld County, Colorado

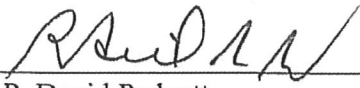

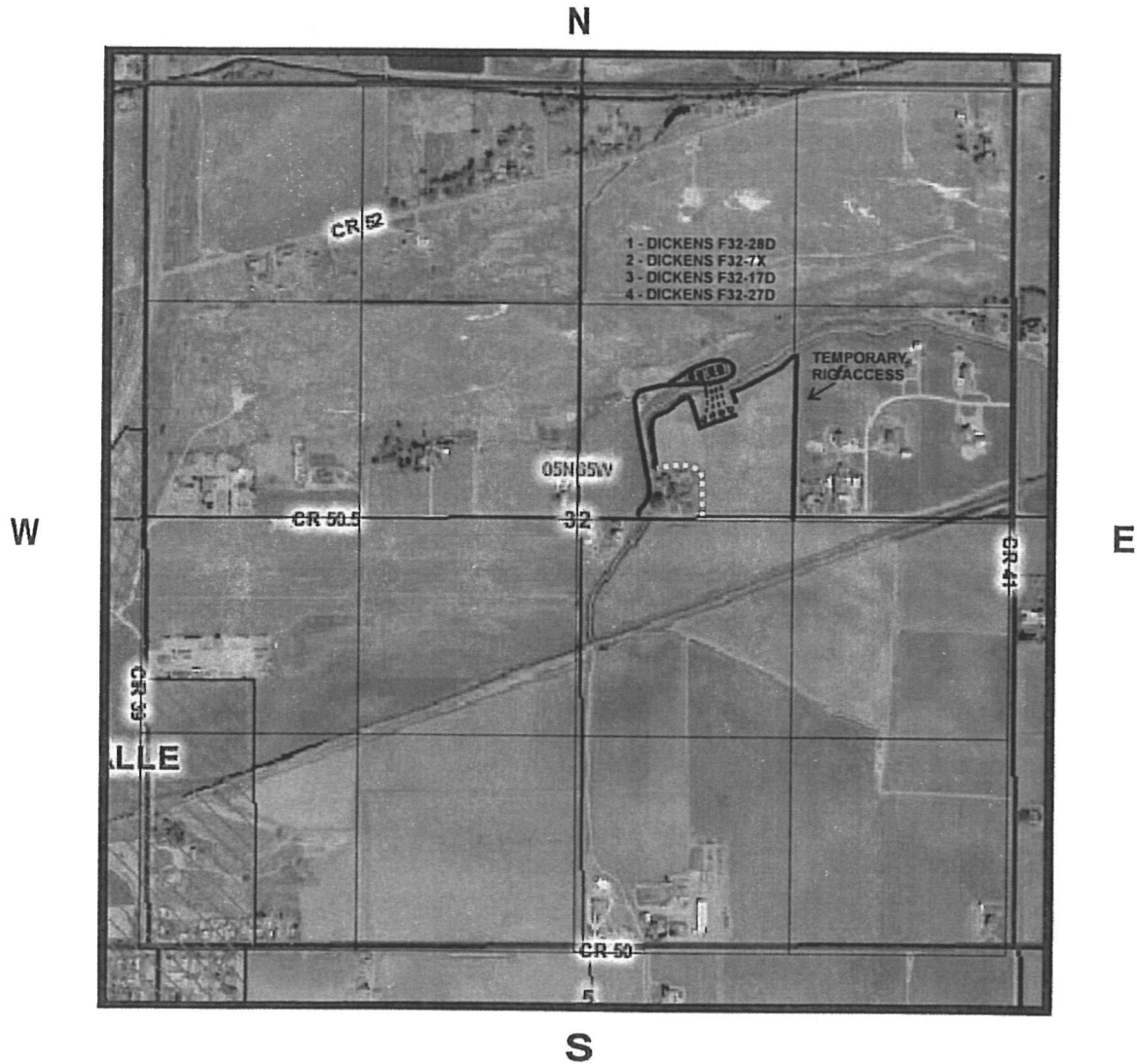
Road Access improved by
Base Material

Road Access

Flowline

Tank Battery

