

SHIVLEY #34-29 5S-43W REFERENCE AREA MAP

YUMA COUNTY, COLORADO
JANUARY 20, 2010

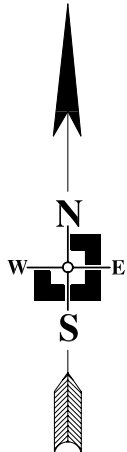
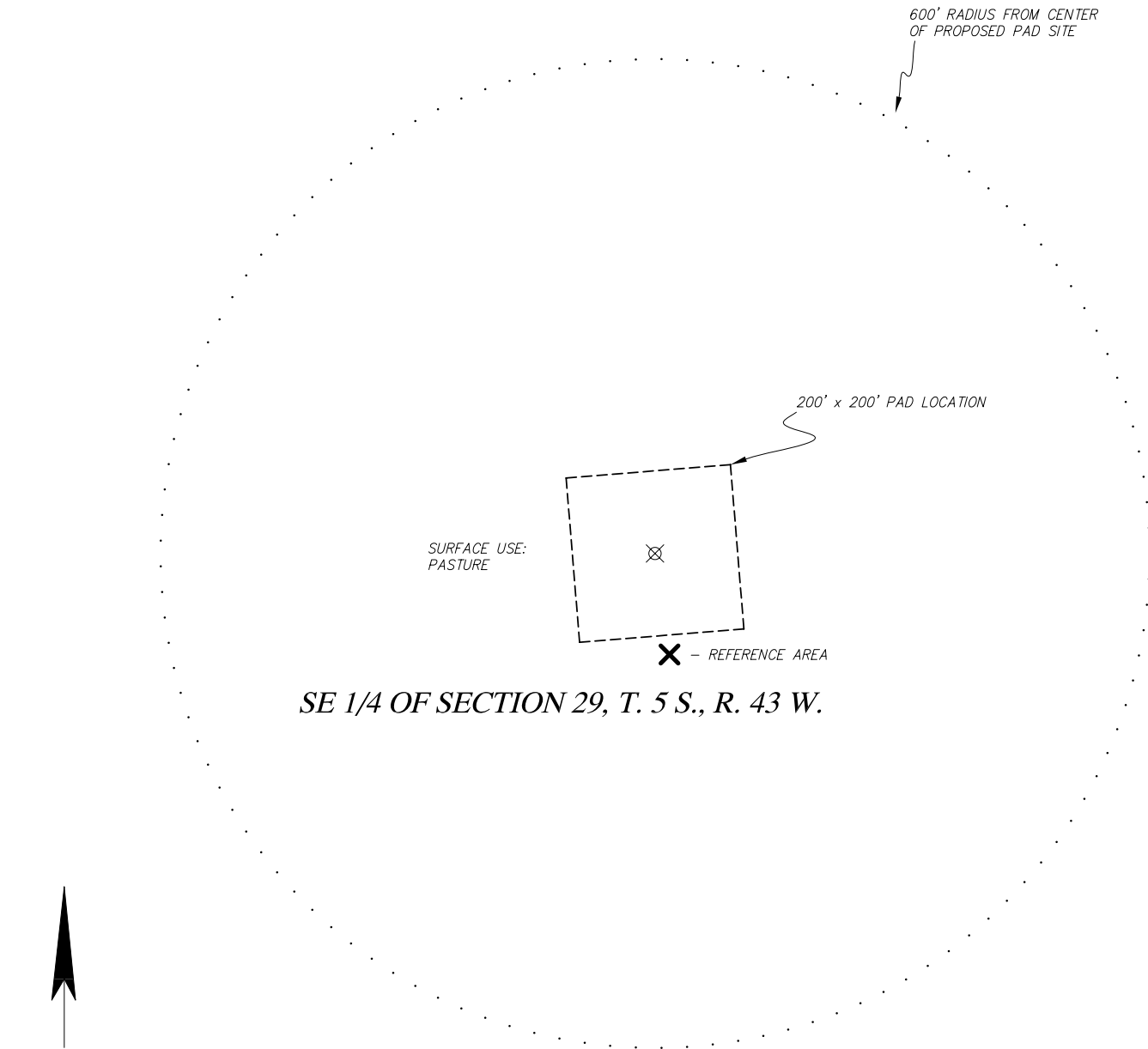

SCALE 1" = 200'

LEGEND

⊗ PROPOSED WELL LOCATION

NOTE:

- NEAREST RAILROAD - 19 +/- MILES TO SOUTH
- NEAREST RIVER - SOUTH FORK REPUBLICAN RIVER - 2.8 +/- MILES NORTHEAST
- NEAREST BODY OF WATER - BONNY RESERVOIR - 0.7 +/- MILES NORTHWEST, NORTH AND NORTHEAST



THREE CORNERS SURVEYING AND MAPPING, LLC

PO Box 463; 312 Main Street
Wray, CO 80758

970-332-4133
3cornerssurveying@centurytel.net

