

State of Colorado
Oil and Gas Conservation Commission

1120 Lincoln Street, Suite 801, Denver, Colorado 80203 Phone: (303)894-2100 Fax: (303)894-2109



DE	ET	GE	ES

SUNDRY NOTICE

Submit original plus one copy. This form is to be used for general, technical and environmental sundry Information. For proposed or completed operations, describe in full on Technical Information Page (Page 2 of this form.) Identify well or other facility by API Number or by OGCC Facility ID. Operator shall send an informational copy of all sundry notices for wells located in High Density Areas to the Local Government Designee (Rule 603b.)

1. OGCC Operator Number: 100322	4. Contact Name Brandon Danforth	Complete the Attachment Checklist OP OGCC
2. Name of Operator: Noble Energy, Inc.	Phone: 970.420.5184	
3. Address: 1625 Broadway, Suite 2200 City: Denver State: CO Zip: 80202	Fax:	
5. API Number 05- see pg 2	OGCC Facility ID Number	Survey Plat
6. Well/Facility Name: BM 26N/34F Well Pads	7. Well/Facility Number	Directional Survey
8. Location (QtrQtr, Sec, Twp, Rng, Meridian): SESW Sec 26 (26N), SENW Sec 34(34F), T7S R95W, 6PM		Surface Eqpm Diagram
9. County: Garfield	10. Field Name: Rulison(#75400)	Technical Info Page
11. Federal, Indian or State Lease Number:		Other

General Notice

<input type="checkbox"/> CHANGE OF LOCATION: Attach New Survey Plat (a change of surface qtr/qtr is substantive and requires a new permit)																
Change of Surface Footage from Exterior Section Lines:	<table border="1"><tr><td></td><td>FNL/FSL</td><td>FEL/FWL</td></tr><tr><td></td><td></td><td></td></tr><tr><td>Change of Surface Footage to Exterior Section Lines:</td><td></td><td></td></tr><tr><td>Change of Bottomhole Footage from Exterior Section Lines:</td><td></td><td></td></tr><tr><td>Change of Bottomhole Footage to Exterior Section Lines:</td><td></td><td></td></tr></table>		FNL/FSL	FEL/FWL				Change of Surface Footage to Exterior Section Lines:			Change of Bottomhole Footage from Exterior Section Lines:			Change of Bottomhole Footage to Exterior Section Lines:		
	FNL/FSL	FEL/FWL														
Change of Surface Footage to Exterior Section Lines:																
Change of Bottomhole Footage from Exterior Section Lines:																
Change of Bottomhole Footage to Exterior Section Lines:																
Bottomhole location Qtr/Qtr, Sec, Twp, Rng, Mer																
Latitude	Distance to nearest property line															
Longitude	Distance to nearest bldg, public rd, utility or RR															
Ground Elevation	Distance to nearest lease line															
	Is location in a High Density Area (rule 603b)? Yes/No															
	Distance to nearest well same formation															
	Surface owner consultation date:															
GPS DATA:																
Date of Measurement	PDOP Reading															
	Instrument Operator's Name															
<input type="checkbox"/> CHANGE SPACING UNIT	<input type="checkbox"/> Remove from surface bond															
Formation	Signed surface use agreement attached															
Formation Code																
Spacing order number																
Unit Acreage																
Unit configuration																
<input type="checkbox"/> CHANGE OF OPERATOR (prior to drilling):	<input type="checkbox"/> CHANGE WELL NAME															
Effective Date:	From:															
Plugging Bond: <input type="checkbox"/> Blanket <input type="checkbox"/> Individual	To:															
	Effective Date:															
<input type="checkbox"/> ABANDONED LOCATION:	<input type="checkbox"/> NOTICE OF CONTINUED SHUT IN STATUS															
Was location ever built? <input type="checkbox"/> Yes <input type="checkbox"/> No	Date well shut in or temporarily abandoned:															
Is site ready for inspection? <input type="checkbox"/> Yes <input type="checkbox"/> No	Has Production Equipment been removed from site? <input type="checkbox"/> Yes <input type="checkbox"/> No															
Date Ready for Inspection:	MIT required if shut in longer than two years. Date of last MIT															
<input type="checkbox"/> SPUD DATE:	<input type="checkbox"/> REQUEST FOR CONFIDENTIAL STATUS (6 mos from date casing set)															
<input type="checkbox"/> SUBSEQUENT REPORT OF STAGE, SQUEEZE OR REMEDIAL CEMENT WORK																
*submit cbl and cement job summaries																
Method used	Cementing tool setting/perf depth															
Cement volume	Cement top															
Cement bottom	Date															
<input type="checkbox"/> RECLAMATION: Attach technical page describing final reclamation procedures per Rule 1004.																
Final reclamation will commence on approximately																
<input type="checkbox"/> Final reclamation is completed and site is ready for inspection.																

Technical Engineering/Environmental Notice

<input type="checkbox"/> Notice of Intent	<input type="checkbox"/> Report of Work Done	
Approximate Start Date:	Date Work Completed:	
Details of work must be described in full on Technical Information Page (Page 2 must be submitted.)		
<input type="checkbox"/> Intent to Recomplete (submit form 2)	<input type="checkbox"/> Request to Vent or Flare	<input type="checkbox"/> E&P Waste Disposal
<input type="checkbox"/> Change Drilling Plans	<input type="checkbox"/> Repair Well	<input type="checkbox"/> Beneficial Reuse of E&P Waste
<input type="checkbox"/> Gross Interval Changed?	<input type="checkbox"/> Rule 502 variance requested	<input type="checkbox"/> Status Update/Change of Remediation Plans
<input type="checkbox"/> Casing/Cementing Program Change	<input checked="" type="checkbox"/> Other: Frac containment notice	for Spills and Releases

I hereby certify that the statements made in this form are, to the best of my knowledge, true, correct and complete.

Signed: Brandon Danforth Date: 3/31/2010 Email: bdanforth@nobleenergyinc.com
Print Name: Brandon Danforth Title: Environmental Specialist

COGCC Approved: Title: Date:

CONDITIONS OF APPROVAL, IF ANY:

TECHNICAL INFORMATION PAGE



FOR OGCC USE ONLY

1.	OGCC Operator Number:	100-322	API Number:	see below
2.	Name of Operator:	Noble Energy Inc	OGCC Facility ID #	
3.	Well/Facility Name:	BM 26N/34F Well Pads	Well/Facility Number:	
4.	Location (QtrQtr, Sec, Twp, Rng, Meridian): SESW Sec 26 (26N), SENW Sec 34(34F), T7S R95W, 6PM			

This form is to be completed whenever a Sundry Notice is submitted requiring detailed report of work to be performed or completed. This form shall be transmitted within 30 days of work completed as a "subsequent" report and must accompany Form 4, page 1.

5. DESCRIBE PROPOSED OR COMPLETED OPERATIONS

1. Per the COA's attached to the APDs for Noble Energy, Inc. wells drilled in accordance with the Rulison SAP (within 3 miles of the Rulison Test Site), secondary and tertiary containment will be maintained during flowback for all wells on the Noble 26N pad. As the frac tanks are isolated using valves, containment on this pad is sized to contain at least 110% of the capacity of the largest vessel within the bermed area after accommodating for displacement.

Wells being frac'ed on the Battlement Mesa 26N pad that will utilize this secondary/tertiary containment plan are listed below:
BATTLEMENT MESA 26-33B, API# 05-045-15743
BATTLEMENT MESA 26-33D, API# 05-045-15739
BATTLEMENT MESA 26-34B, API# 05-045-15745
BATTLEMENT MESA 26-34C, API# 05-045-15741

The frac tanks utilized for frac'ing the above-listed wells will be stationed on both Noble Energy's Battlement Mesa (BM) 26N and 34F pads. Water will be transported to and from tanks stationed on the BM 34F pad to the frac'ing operations on the BM 26N pad via existing buried water lines.

On the pad surfaces, water will be transported from buried lines to and from the frac tanks and equipment with steel flex pipe. A pump will be stationed on the BM 34F to move water to and from the BM 26N pad. The pump will be contained within secondary and tertiary containment.

Please refer to the attached site diagrams for the layout of frac tanks, pump, water lines and secondary/tertiary containment.

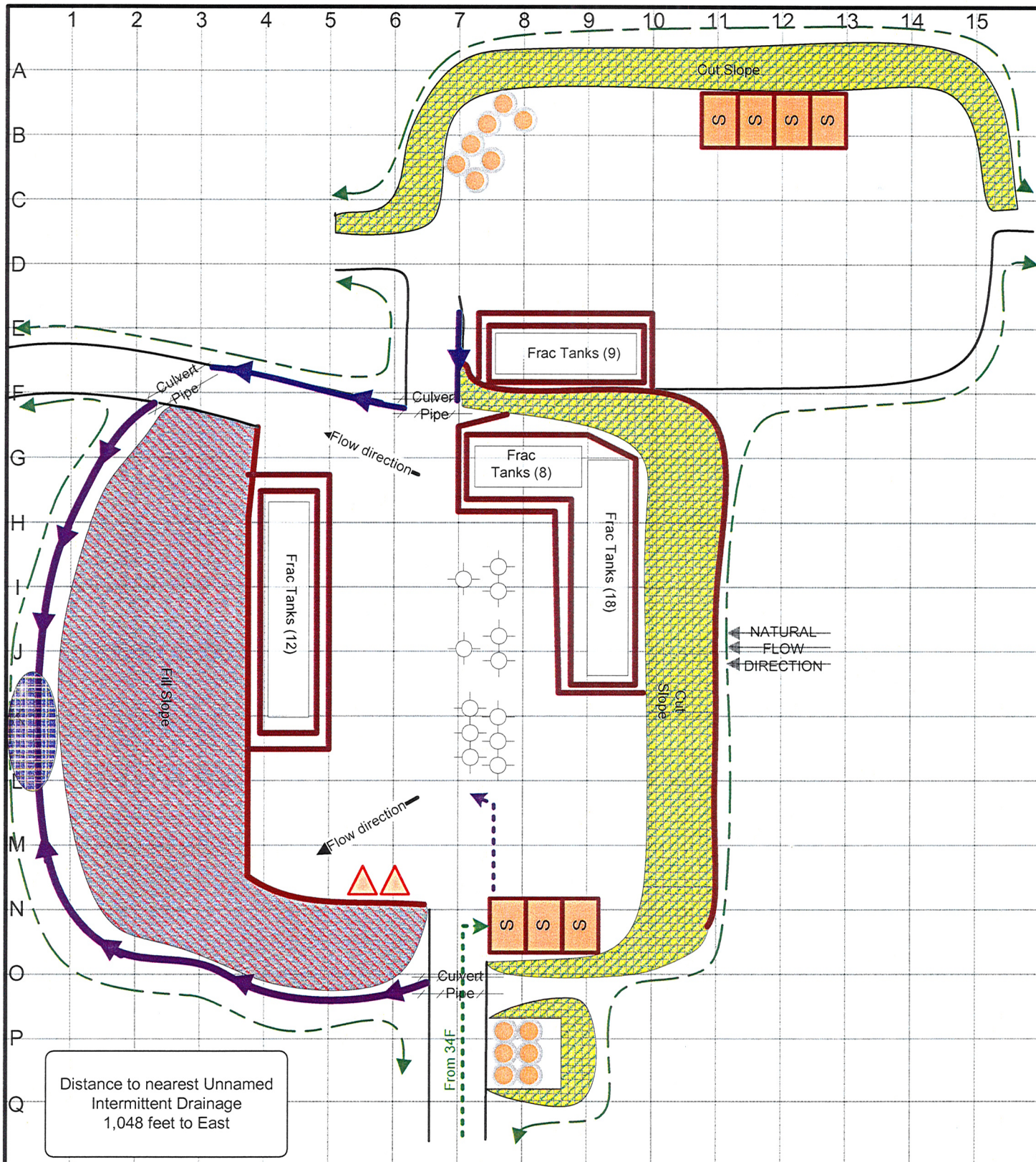

LEGEND			
	Earthen Berm		Tank w/ Steel Containment
	Bar Ditch		Sediment Trap
	Diversion Ditch		Latrine
	Straw Wattle		Wellhead
	Culvert		Steel Flex Pipe (above ground)
			4" Poly Pipe (buried)
			Construction Site Boundary
			FGM/Hydromulched Area

SITE MAP
ND-00007
Battlement Mesa 26-42 (26N)
Noble Energy, Inc.
GARFIELD COUNTY, COLORADO

SITE LEGAL LOCATION:
 SECTION 26, TOWNSHIP 7S, RANGE 95W

Not to Scale

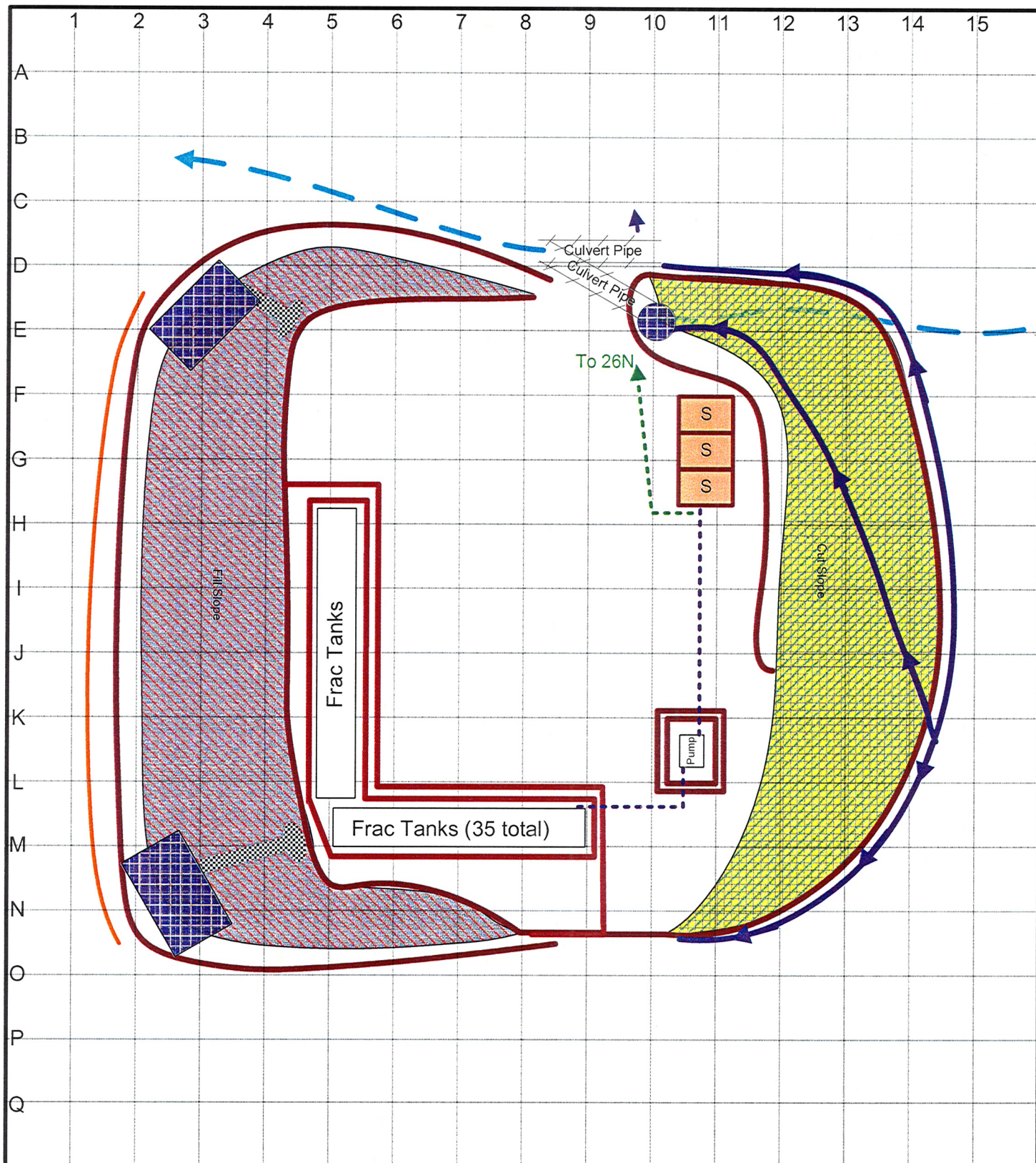

LEGEND



Armored Sediment Trap



Pipe Slope Drain



Steel Flex Pipe (above ground)



Berm



Ditch



4" Poly Pipe (buried)



Excelsior Log



Culvert



Disturbance Boundary

SITE MAP
ND-00050
Battlement Mesa 34F
Noble Energy, Inc.
GARFIELD COUNTY, COLORADO



Not to Scale

SITE LEGAL LOCATION:
 SECTION 26, TOWNSHIP 7S, RANGE 95W