

Noble Energy (Rockies)

Garfield County, CO

Sec. 35-T7S-R95W (SGV 35D2 PAD)

BM 34-42C - B10

Wellbore #1

Plan: Plan #1 Proposal

Sperry Drilling Services Proposal Report

20 October, 2009

Well Coordinates: 579,130.86 N, 1,301,225.83 E (39° 23' 50.62" N, 107° 58' 22.58" W)

Ground Level: 8,846.00 ft

Local Coordinate Origin:

Centered on Well BM 34-42C - Slot B10

Viewing Datum:

RKB - 24' @ 8870.00ft

TVDs to System:

N

North Reference:

Grid

Unit System:

API - US Survey Feet - Custom

Geodetic Scale Factor Applied

Version: 2003.16 Build: 431

HALLIBURTON

Plan Report for BM 34-42C - Plan #1 Proposal

Measured Depth (ft)	Inclination (°)	Azimuth (°)	Vertical Depth (ft)	+N/-S (ft)	+E/-W (ft)	Vertical Section (ft)	Dogleg Rate (°/100ft)	Build Rate (°/100ft)	Turn Rate (°/100ft)	Toolface Azimuth (°)
0.00	0.00	0.00	0.00	0.00	0.00	0.00	0.00	0.00	0.00	0.00
100.00	0.00	0.00	100.00	0.00	0.00	0.00	0.00	0.00	0.00	0.00
200.00	0.00	0.00	200.00	0.00	0.00	0.00	0.00	0.00	0.00	0.00
225.00	0.00	0.00	225.00	0.00	0.00	0.00	0.00	0.00	0.00	0.00
Kickoff at 225.00ft										
300.00	1.50	226.92	299.99	-0.67	-0.72	0.98	2.00	2.00	0.00	226.92
400.00	3.50	226.92	399.89	-3.65	-3.90	5.34	2.00	2.00	0.00	0.00
440.00	4.30	226.92	439.80	-5.51	-5.89	8.06	2.00	2.00	0.00	0.00
Build Rate = 2.00°/100ft										
500.00	5.50	226.92	499.58	-9.01	-9.63	13.19	2.00	2.00	0.00	0.00
600.00	7.50	226.92	598.93	-16.74	-17.90	24.51	2.00	2.00	0.00	0.00
700.00	9.50	226.92	697.83	-26.83	-28.70	39.29	2.00	2.00	0.00	0.00
775.61	11.01	226.92	772.23	-36.03	-38.53	52.75	2.00	2.00	0.00	0.00
End Build at 775.61ft										
800.00	11.01	226.92	796.17	-39.21	-41.93	57.40	0.00	0.00	0.00	0.00
900.00	11.01	226.92	894.33	-52.26	-55.89	76.50	0.00	0.00	0.00	0.00
1,000.00	11.01	226.92	992.48	-65.30	-69.84	95.60	0.00	0.00	0.00	0.00
1,100.00	11.01	226.92	1,090.64	-78.35	-83.79	114.70	0.00	0.00	0.00	0.00
1,200.00	11.01	226.92	1,188.80	-91.40	-97.74	133.80	0.00	0.00	0.00	0.00
1,300.00	11.01	226.92	1,286.96	-104.44	-111.70	152.90	0.00	0.00	0.00	0.00
1,400.00	11.01	226.92	1,385.12	-117.49	-125.65	172.00	0.00	0.00	0.00	0.00
1,500.00	11.01	226.92	1,483.28	-130.54	-139.60	191.10	0.00	0.00	0.00	0.00
1,600.00	11.01	226.92	1,581.44	-143.58	-153.55	210.20	0.00	0.00	0.00	0.00
1,700.00	11.01	226.92	1,679.60	-156.63	-167.50	229.30	0.00	0.00	0.00	0.00
1,800.00	11.01	226.92	1,777.75	-169.68	-181.46	248.40	0.00	0.00	0.00	0.00
1,900.00	11.01	226.92	1,875.91	-182.72	-195.41	267.50	0.00	0.00	0.00	0.00
2,000.00	11.01	226.92	1,974.07	-195.77	-209.36	286.60	0.00	0.00	0.00	0.00
2,100.00	11.01	226.92	2,072.23	-208.81	-223.31	305.71	0.00	0.00	0.00	0.00
2,200.00	11.01	226.92	2,170.39	-221.86	-237.27	324.81	0.00	0.00	0.00	0.00
2,300.00	11.01	226.92	2,268.55	-234.91	-251.22	343.91	0.00	0.00	0.00	0.00
2,380.00	11.01	226.92	2,347.07	-245.34	-262.38	359.19	0.00	0.00	0.00	0.00
8 5/8" Casing Pt.										
2,400.00	11.01	226.92	2,366.71	-247.95	-265.17	363.01	0.00	0.00	0.00	0.00
2,500.00	11.01	226.92	2,464.86	-261.00	-279.12	382.11	0.00	0.00	0.00	0.00
2,600.00	11.01	226.92	2,563.02	-274.05	-293.08	401.21	0.00	0.00	0.00	0.00
2,700.00	11.01	226.92	2,661.18	-287.09	-307.03	420.31	0.00	0.00	0.00	0.00
2,800.00	11.01	226.92	2,759.34	-300.14	-320.98	439.41	0.00	0.00	0.00	0.00
2,900.00	11.01	226.92	2,857.50	-313.19	-334.93	458.51	0.00	0.00	0.00	0.00
3,000.00	11.01	226.92	2,955.66	-326.23	-348.89	477.61	0.00	0.00	0.00	0.00
3,100.00	11.01	226.92	3,053.82	-339.28	-362.84	496.71	0.00	0.00	0.00	0.00
3,200.00	11.01	226.92	3,151.97	-352.33	-376.79	515.81	0.00	0.00	0.00	0.00
3,300.00	11.01	226.92	3,250.13	-365.37	-390.74	534.91	0.00	0.00	0.00	0.00
3,400.00	11.01	226.92	3,348.29	-378.42	-404.69	554.01	0.00	0.00	0.00	0.00
3,470.00	11.01	226.92	3,417.00	-387.55	-414.46	567.38	0.00	0.00	0.00	0.00
11.01 Inclination										
3,500.00	11.01	226.92	3,446.45	-391.47	-418.65	573.11	0.00	0.00	0.00	0.00
3,600.00	11.01	226.92	3,544.61	-404.51	-432.60	592.21	0.00	0.00	0.00	0.00
3,700.00	11.01	226.92	3,642.77	-417.56	-446.55	611.31	0.00	0.00	0.00	0.00
3,800.00	11.01	226.92	3,740.93	-430.60	-460.50	630.41	0.00	0.00	0.00	0.00
3,900.00	11.01	226.92	3,839.09	-443.65	-474.46	649.51	0.00	0.00	0.00	0.00
4,000.00	11.01	226.92	3,937.24	-456.70	-488.41	668.61	0.00	0.00	0.00	0.00
4,100.00	11.01	226.92	4,035.40	-469.74	-502.36	687.71	0.00	0.00	0.00	0.00
4,200.00	11.01	226.92	4,133.56	-482.79	-516.31	706.81	0.00	0.00	0.00	0.00
4,300.00	11.01	226.92	4,231.72	-495.84	-530.27	725.91	0.00	0.00	0.00	0.00
4,400.00	11.01	226.92	4,329.88	-508.88	-544.22	745.01	0.00	0.00	0.00	0.00
4,500.00	11.01	226.92	4,428.04	-521.93	-558.17	764.11	0.00	0.00	0.00	0.00
4,600.00	11.01	226.92	4,526.20	-534.98	-572.12	783.21	0.00	0.00	0.00	0.00
4,700.00	11.01	226.92	4,624.35	-548.02	-586.08	802.31	0.00	0.00	0.00	0.00

Plan Report for BM 34-42C - Plan #1 Proposal

Measured Depth (ft)	Inclination (°)	Azimuth (°)	Vertical Depth (ft)	+N/-S (ft)	+E/-W (ft)	Vertical Section (ft)	Dogleg Rate (°/100ft)	Build Rate (°/100ft)	Turn Rate (°/100ft)	Toolface Azimuth (°)
4,800.00	11.01	226.92	4,722.51	-561.07	-600.03	821.41	0.00	0.00	0.00	0.00
4,900.00	11.01	226.92	4,820.67	-574.12	-613.98	840.51	0.00	0.00	0.00	0.00
5,000.00	11.01	226.92	4,918.83	-587.16	-627.93	859.61	0.00	0.00	0.00	0.00
5,100.00	11.01	226.92	5,016.99	-600.21	-641.89	878.71	0.00	0.00	0.00	0.00
5,200.00	11.01	226.92	5,115.15	-613.26	-655.84	897.81	0.00	0.00	0.00	0.00
5,300.00	11.01	226.92	5,213.31	-626.30	-669.79	916.91	0.00	0.00	0.00	0.00
5,400.00	11.01	226.92	5,311.47	-639.35	-683.74	936.01	0.00	0.00	0.00	0.00
5,500.00	11.01	226.92	5,409.62	-652.39	-697.69	955.11	0.00	0.00	0.00	0.00
5,600.00	11.01	226.92	5,507.78	-665.44	-711.65	974.21	0.00	0.00	0.00	0.00
5,700.00	11.01	226.92	5,605.94	-678.49	-725.60	993.31	0.00	0.00	0.00	0.00
5,800.00	11.01	226.92	5,704.10	-691.53	-739.55	1,012.41	0.00	0.00	0.00	0.00
5,900.00	11.01	226.92	5,802.26	-704.58	-753.50	1,031.51	0.00	0.00	0.00	0.00
5,979.57	11.01	226.92	5,880.36	-714.96	-764.61	1,046.70	0.00	0.00	0.00	0.00
Begin Drop at 5979.57ft										
6,000.00	10.71	226.92	5,900.43	-717.59	-767.42	1,050.55	1.50	-1.50	0.00	180.00
6,100.00	9.21	226.92	5,998.92	-729.40	-780.05	1,067.84	1.50	-1.50	0.00	180.00
6,200.00	7.71	226.92	6,097.83	-739.44	-790.79	1,082.54	1.50	-1.50	0.00	180.00
6,300.00	6.21	226.92	6,197.09	-747.71	-799.63	1,094.65	1.50	-1.50	0.00	180.00
6,400.00	4.71	226.92	6,296.63	-754.21	-806.58	1,104.16	1.50	-1.50	0.00	180.00
6,440.00	4.11	226.92	6,336.52	-756.30	-808.82	1,107.23	1.50	-1.50	0.00	-180.00
Drop Rate = 1.50°/100ft										
6,500.00	3.21	226.92	6,396.39	-758.92	-811.61	1,111.06	1.50	-1.50	0.00	180.00
6,600.00	1.71	226.92	6,496.30	-761.84	-814.74	1,115.34	1.50	-1.50	0.00	180.00
6,700.00	0.21	226.92	6,596.28	-762.98	-815.96	1,117.01	1.50	-1.50	0.00	180.00
6,713.72	0.00	0.00	6,610.00	-763.00	-815.98	1,117.03	1.50	-1.50	970.07	180.00
End Drop at 6713.72ft - Williams Fork - BM 34-42C Plan #1 Driller's Tgt										
6,713.75	0.00	243.43	6,610.03	-763.00	-815.98	1,117.03	0.01	0.00	-346,188.83	-148.29
BM 34-42C Plan #1 Zone Tgt										
6,800.00	0.07	243.43	6,696.28	-763.02	-816.03	1,117.08	0.08	0.08	0.00	0.00
6,900.00	0.15	243.43	6,796.28	-763.11	-816.20	1,117.27	0.08	0.08	0.00	0.00
7,000.00	0.23	243.43	6,896.28	-763.26	-816.49	1,117.58	0.08	0.08	0.00	0.00
7,100.00	0.31	243.43	6,996.28	-763.47	-816.91	1,118.04	0.08	0.08	0.00	0.00
7,200.00	0.39	243.43	7,096.28	-763.74	-817.46	1,118.62	0.08	0.08	0.00	0.00
7,300.00	0.47	243.43	7,196.28	-764.07	-818.13	1,119.34	0.08	0.08	0.00	0.00
7,400.00	0.55	243.43	7,296.27	-764.47	-818.92	1,120.20	0.08	0.08	0.00	0.00
7,500.00	0.63	243.43	7,396.27	-764.93	-819.84	1,121.19	0.08	0.08	0.00	0.00
7,600.00	0.71	243.43	7,496.26	-765.45	-820.88	1,122.31	0.08	0.08	0.00	0.00
7,695.75	0.79	243.43	7,592.00	-766.01	-822.00	1,123.51	0.08	0.08	0.00	0.00
Top of Gas										
7,700.00	0.79	243.43	7,596.25	-766.04	-822.05	1,123.57	0.08	0.08	0.00	0.00
7,800.00	0.87	243.43	7,696.24	-766.68	-823.35	1,124.96	0.08	0.08	0.00	0.00
7,900.00	0.95	243.43	7,796.23	-767.39	-824.77	1,126.49	0.08	0.08	0.00	0.00
8,000.00	1.03	243.43	7,896.21	-768.17	-826.31	1,128.15	0.08	0.08	0.00	0.00
8,100.00	1.11	243.43	7,996.20	-769.00	-827.98	1,129.95	0.08	0.08	0.00	0.00
8,200.00	1.19	243.43	8,096.17	-769.90	-829.77	1,131.88	0.08	0.08	0.00	0.00
8,300.00	1.27	243.43	8,196.15	-770.86	-831.69	1,133.94	0.08	0.08	0.00	0.00
8,400.00	1.35	243.43	8,296.13	-771.88	-833.73	1,136.14	0.08	0.08	0.00	0.00
8,500.00	1.43	243.43	8,396.10	-772.96	-835.90	1,138.47	0.08	0.08	0.00	0.00
8,600.00	1.51	243.43	8,496.06	-774.11	-838.20	1,140.94	0.08	0.08	0.00	0.00
8,689.71	1.58	243.43	8,585.75	-775.19	-840.36	1,143.27	0.08	0.08	0.00	0.00
8,700.00	1.57	243.43	8,596.03	-775.32	-840.61	1,143.54	0.08	-0.08	0.00	180.00
8,800.00	1.50	243.43	8,695.99	-776.52	-843.01	1,146.12	0.08	-0.08	0.00	180.00
8,900.00	1.42	243.43	8,795.96	-777.66	-845.28	1,148.57	0.08	-0.08	0.00	180.00
9,000.00	1.34	243.43	8,895.93	-778.73	-847.44	1,150.89	0.08	-0.08	0.00	180.00
9,100.00	1.27	243.43	8,995.90	-779.75	-849.48	1,153.09	0.08	-0.08	0.00	180.00
9,200.00	1.19	243.43	9,095.88	-780.72	-851.40	1,155.15	0.08	-0.08	0.00	180.00
9,257.13	1.15	243.43	9,153.00	-781.24	-852.45	1,156.28	0.08	-0.08	0.00	180.00
Cameo										
9,300.00	1.12	243.43	9,195.86	-781.62	-853.20	1,157.09	0.08	-0.08	0.00	-180.00

Plan Report for BM 34-42C - Plan #1 Proposal

Measured Depth (ft)	Inclination (°)	Azimuth (°)	Vertical Depth (ft)	+N/-S (ft)	+E/-W (ft)	Vertical Section (ft)	Dogleg Rate (°/100ft)	Build Rate (°/100ft)	Turn Rate (°/100ft)	Toolface Azimuth (°)
9,400.00	1.04	243.43	9,295.84	-782.46	-854.89	1,158.90	0.08	-0.08	0.00	180.00
9,500.00	0.96	243.43	9,395.83	-783.24	-856.45	1,160.59	0.08	-0.08	0.00	180.00
9,600.00	0.89	243.43	9,495.81	-783.96	-857.90	1,162.14	0.08	-0.08	0.00	180.00
9,630.19	0.86	243.43	9,526.00	-784.17	-858.31	1,162.59	0.08	-0.08	0.00	180.00
Rollins										
9,700.00	0.81	243.43	9,595.80	-784.63	-859.22	1,163.57	0.08	-0.08	0.00	-180.00
9,800.00	0.74	243.43	9,695.79	-785.23	-860.43	1,164.87	0.08	-0.08	0.00	180.00
9,900.00	0.66	243.43	9,795.79	-785.77	-861.52	1,166.04	0.08	-0.08	0.00	180.00
9,978.22	0.60	243.43	9,874.00	-786.16	-862.29	1,166.87	0.08	-0.08	0.00	-180.00
Cozzette										
10,000.00	0.58	243.43	9,895.78	-786.26	-862.49	1,167.09	0.08	-0.08	0.00	180.00
10,100.00	0.51	243.43	9,995.78	-786.69	-863.34	1,168.00	0.08	-0.08	0.00	180.00
10,200.00	0.43	243.43	10,095.77	-787.05	-864.07	1,168.79	0.08	-0.08	0.00	180.00
10,275.23	0.37	243.43	10,171.00	-787.29	-864.54	1,169.30	0.08	-0.08	0.00	-180.00
Corcora										
10,300.00	0.35	243.43	10,195.77	-787.36	-864.69	1,169.45	0.08	-0.08	0.00	180.00
10,400.00	0.28	243.43	10,295.77	-787.61	-865.18	1,169.98	0.08	-0.08	0.00	180.00
10,500.00	0.20	243.43	10,395.77	-787.79	-865.56	1,170.39	0.08	-0.08	0.00	180.00
10,516.23	0.19	243.43	10,412.00	-787.82	-865.61	1,170.44	0.08	-0.08	0.00	-180.00
Mancos										
10,600.00	0.13	243.43	10,495.77	-787.92	-865.81	1,170.66	0.08	-0.08	0.00	180.00
10,700.00	0.05	243.43	10,595.77	-787.99	-865.95	1,170.81	0.08	-0.08	0.00	180.00
10,766.23	0.00	0.00	10,662.00	-788.00	-865.98	1,170.84	0.08	-0.08	176.01	180.00
Total Depth = 10766.23ft - BM 34-42C Plan #1 BH Tgt										

Plan Annotations

Measured Depth (ft)	Vertical Depth (ft)	Local Coordinates		Comment
		+N/-S (ft)	+E/-W (ft)	
225.00	225.00	0.00	0.00	Kickoff at 225.00ft
440.00	439.80	-5.51	-5.89	Build Rate = 2.00°/100ft
775.61	772.23	-36.03	-38.53	End Build at 775.61ft
3,470.00	3,417.00	-387.55	-414.46	11.01 Inclination
5,979.57	5,880.36	-714.96	-764.61	Begin Drop at 5979.57ft
6,440.00	6,336.52	-756.30	-808.82	Drop Rate = 1.50°/100ft
6,713.72	6,610.00	-763.00	-815.98	End Drop at 6713.72ft
10,766.23	10,662.00	-788.00	-865.98	Total Depth = 10766.23ft

Vertical Section Information

Angle Type	Target	Azimuth (°)	Origin Type	Origin +N/-S (ft)	Origin +E/-W (ft)	Start TVD (ft)
Target	BM 34-42C Plan #1 BH Tgt	227.70	Slot	0.00	0.00	0.00

Survey tool program

From (ft)	To (ft)	Survey/Plan	Survey Tool
0.00	10,766.23	Plan #1 Proposal	MWD

Plan Report for BM 34-42C - Plan #1 Proposal

Casing Details

Measured Depth (ft)	Vertical Depth (ft)	Name	Casing Diameter (")	Hole Diameter (")
2,380.00	2,347.07	8 5/8" Casing Pt.	8-5/8	11

Formation Details

Measured Depth (ft)	Vertical Depth (ft)	Name	Lithology	Dip (°)	Dip Direction (°)
6,713.72	6,610.00	Williams Fork		0.00	
7,695.75	7,592.00	Top of Gas		0.00	
9,257.13	9,153.00	Cameo		0.00	
9,630.19	9,526.00	Rollins		0.00	
9,978.22	9,874.00	Cozzette		0.00	
10,275.23	10,171.00	Corcora		0.00	
10,516.23	10,412.00	Mancos		0.00	

Targets associated with this wellbore

Target Name	TVD (ft)	+N/-S (ft)	+E/-W (ft)	Shape
BM 34-42C Plan #1 Zone Tgt	6,610.00	-788.00	-865.98	Rectangle
BM 34-42C Plan #1 Driller's Tgt	6,610.00	-763.00	-815.98	Rectangle
BM 34-42C Plan #1 BH Tgt	10,662.00	-788.00	-865.98	Point

North Reference Sheet for Sec. 35-T7S-R95W (SGV 35D2 PAD) - BM 34-42C - Wellbore #1

All data is in US Feet unless otherwise stated. Directions and Coordinates are relative to Grid North Reference.

Vertical Depths are relative to RKB - 24' @ 8870.00ft. Northing and Easting are relative to BM 34-42C - Slot B10

Coordinate System is US State Plane 1927 (Exact solution), Colorado Central 502 using datum NAD 1927 (NADCON CONUS), ellipsoid Clarke 1866

Projection method is Lambert Conformal Conic (2 parallel)

Central Meridian is -105.50°, Longitude Origin:0° 0' 0.000 E°, Latitude Origin:39° 45' 0.000 N°

False Easting: 2,000,000.00ft, False Northing: 0.00ft, Scale Reduction: 0.99994926

Grid Coordinates of Well: 579,130.86 ft N, 1,301,225.83 ft E

Geographical Coordinates of Well: 39° 23' 50.62" N, 107° 58' 22.58" W

Grid Convergence at Surface is: -1.56°

Based upon Minimum Curvature type calculations, at a Measured Depth of 10,766.23ft

the Bottom Hole Displacement is 1,170.84ft in the Direction of 227.70° (Grid).

Magnetic Convergence at surface is: -12.08° (12 November 2009, , BGGM2008)

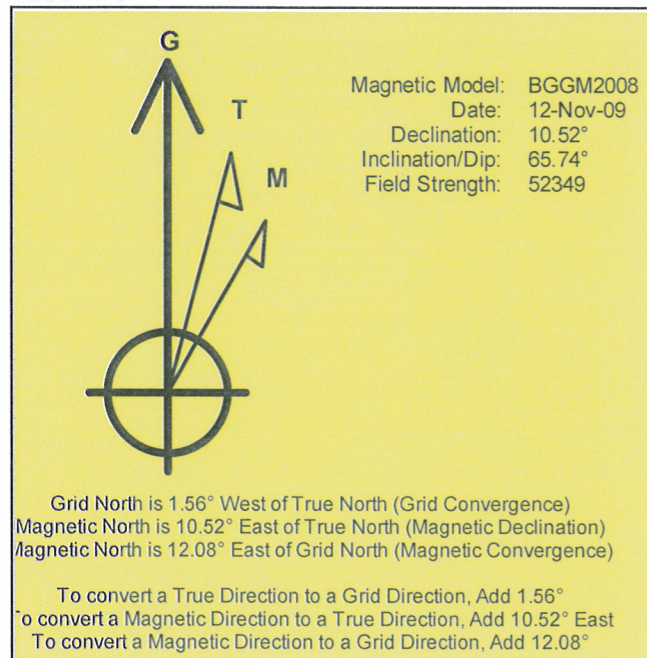

Project: Garfield County, CO
 Site: Sec. 35-T7S-R95W (SGV 35D2 PAD)
 Well: BM 34-42C
 Wellbore: Wellbore #1
 Plan: Plan #1 Proposal

Noble Energy (Rockies)

HALLIBURTON

SECTION DETAILS

MD	Inc	Azi	TVD	+N/-S	+E/-W	DLeg	TFace	VSec
0.00	0.00	0.00	0.00	0.00	0.00	0.00	0.00	0.00
225.00	0.00	0.00	225.00	0.00	0.00	0.00	0.00	0.00
775.61	11.01	226.92	772.23	-36.03	-38.53	2.00	226.92	52.75
5979.57	11.01	226.92	5880.36	-714.96	-764.61	0.00	0.00	1046.71
6713.72	0.00	0.00	6610.00	-763.00	-815.98	1.50	180.00	1117.03
8689.71	1.58	243.43	8585.75	-775.19	-840.36	0.08	243.43	1143.27
10766.23	0.00	360.00	10662.00	-788.00	-865.98	0.08	180.00	1170.84

BM 34-42C Plan #1 Driller's Tgt
 BM 34-42C Plan #1 BH Tgt

WELL DETAILS: BM 34-42C

Ground Level: 8846.00
 Northing 579130.86 Easting 1301225.83 Latitude 39° 23' 50.619 N Longitude 107° 58' 22.583 W B10

WELLBORE TARGET DETAILS

Name	TVD	+N/-S	+E/-W	Shape
BM 34-42C Plan #1 Driller's Tgt	6610.00	-763.00	-815.98	Rectangle (Sides: L25.00 W25.00)
BM 34-42C Plan #1 Zone Tgt	6610.00	-788.00	-865.98	Rectangle (Sides: L100.00 W200.00)
BM 34-42C Plan #1 BH Tgt	10662.00	-788.00	-865.98	Point

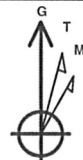

Azimuths to Grid North
 True North: 1.56°
 Magnetic North: 12.08°
 Magnetic Field
 Strength: 52348.7snT
 Dip Angle: 65.74°
 Date: 11/12/2009
 Model: BGGM2008

FORMATION TOP DETAILS

TVDPath	MDPath	Formation
6610.00	6713.72	Williams Fork
7592.00	7695.75	Top of Gas
9153.00	9257.13	Cameo
9526.00	9630.19	Rollins
9874.00	9978.22	Cozzette
10171.00	10275.23	Corcora
10412.00	10516.23	Mancos

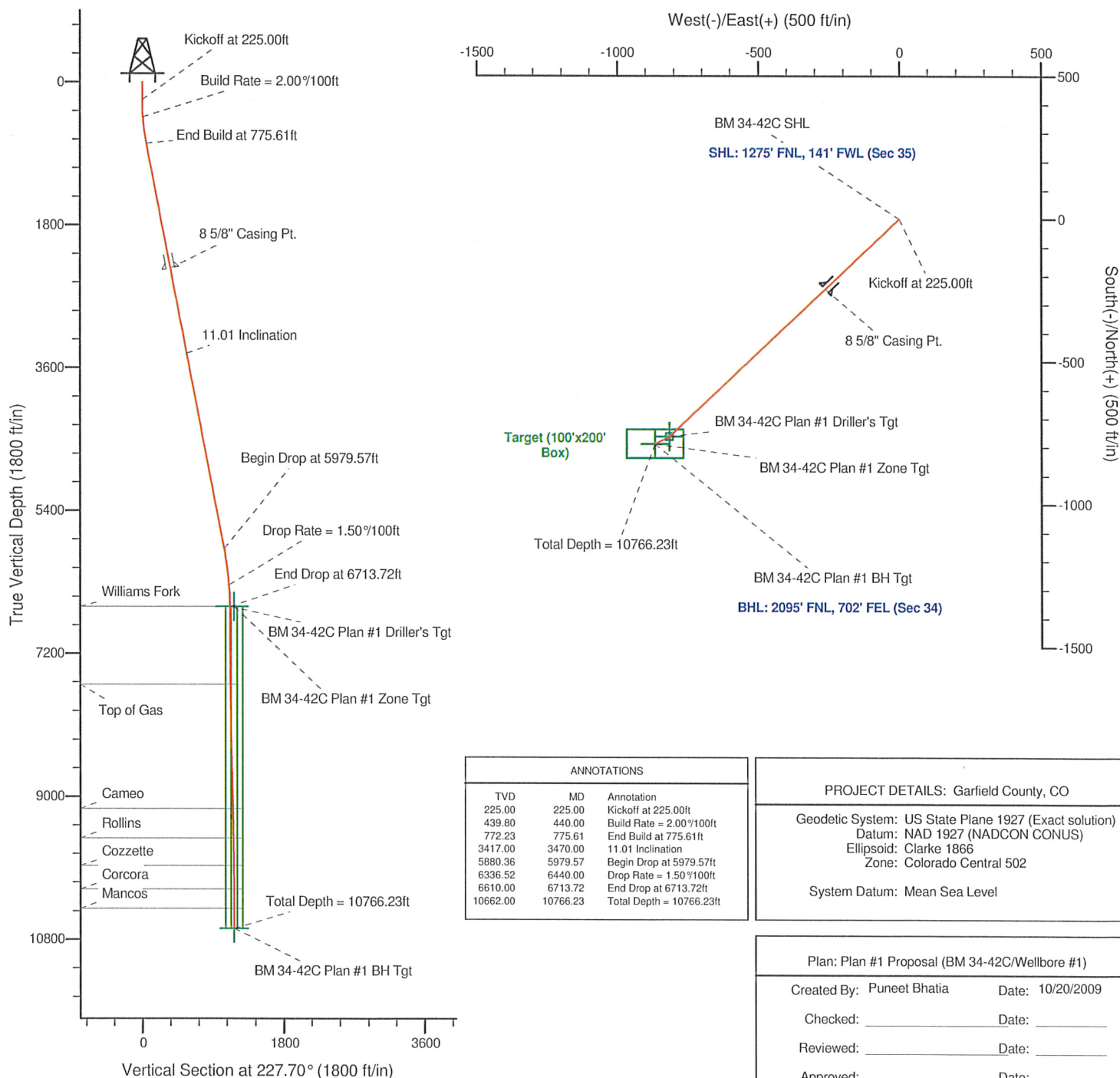

ANNOTATIONS

TVD	MD	Annotation
225.00	225.00	Kickoff at 225.00ft
439.80	440.00	Build Rate = 2.00°/100ft
772.23	775.61	End Build at 775.61ft
3417.00	3470.00	11.01 Inclination
5880.36	5979.57	Begin Drop at 5979.57ft
6336.52	6440.00	Drop Rate = 1.50°/100ft
6610.00	6713.72	End Drop at 6713.72ft
10662.00	10766.23	Total Depth = 10766.23ft

PROJECT DETAILS: Garfield County, CO

Geodetic System: US State Plane 1927 (Exact solution)
 Datum: NAD 1927 (NADCON CONUS)
 Ellipsoid: Clarke 1866
 Zone: Colorado Central 502
 System Datum: Mean Sea Level

Plan: Plan #1 Proposal (BM 34-42C/Wellbore #1)

Created By: Puneet Bhatia Date: 10/20/2009
 Checked: _____ Date: _____
 Reviewed: _____ Date: _____
 Approved: _____ Date: _____