

BERRY PETROLEUM COMPANY

LOCATION LAYOUT FOR

WELL PAD I21 697
SECTION 21, T6S, R97W, 6th P.M.
NE 1/4 SE 1/4

50 25 0 50
SCALE
Sheet 2 of 12

DATE: 08-12-09
Drawn By: C.H.
REV: 09-10-09
REV: 09-17-09

NOTE:
Flare Pit is to be located a min. of 100' from the Well Head.

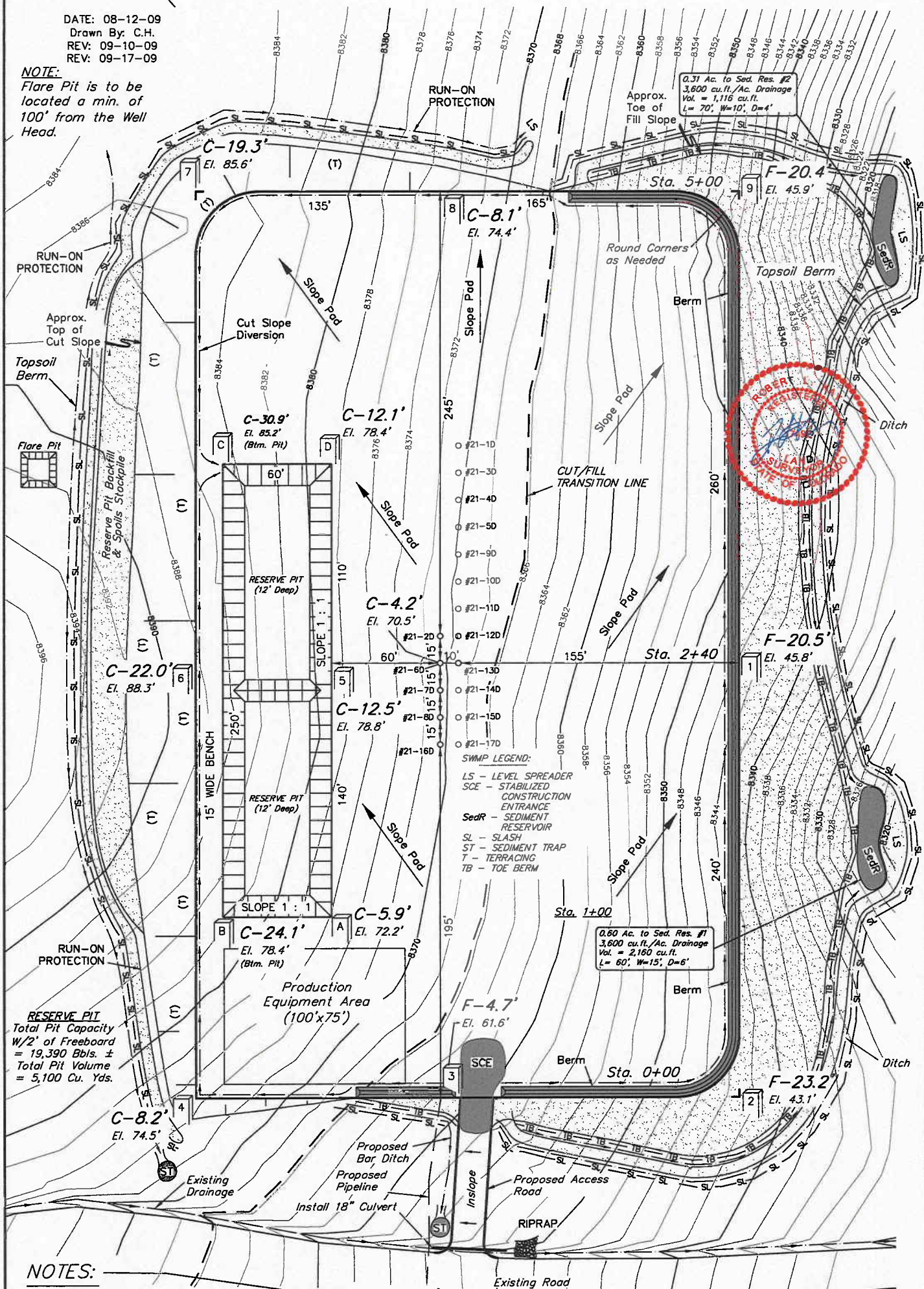

NOTES:

Elev. Ungraded Ground At #21-6D Loc. Stake = 8370.5'
FINISHED GRADE ELEV. AT #21-6D LOC. STAKE = 8366.3'

UINTAH ENGINEERING & LAND SURVEYING
85 So. 200 East * Vernal, Utah 84078 * (435) 789-1017