

BERRY PETROLEUM COMPANY

CURRENT FOOTAGE

WELL PAD I21 697
SECTION 21, T6S, R97W, 6th P.M.
NE 1/4 SE 1/4

Sheet 6a of 12

DATE: 08-12-09
Drawn By: C.H.
REV: 10-01-09

NE Cor. Sec. 21
1917 Brass Cap
1.0' High, Steel
Post
Lat: 39.515730
Long: 108.215446

1938 Brass Cap
1.7' High, Mound
of Stones
Lat: 39.508483
Long: 108.215437



21

N72°00'00"W - 3590.00'
(To Public Road)

N59°51'41"E - 2377.00'
(To Surface Water)

S80°17'15"E - 9742.00'
(To Building)

S40°00'00"E - 48500.00'
(To Public Road)

N00°00'36"E - 2640.50' (Meas.)
N00°00'37"E - 2640.51' (Meas.)

1917 Brass Cap
1.5' High
Lat: 39.501242
Long: 108.224778

N89°52'44"W - 2638.89' (Meas.)

1917 Brass Cap
2.0' High
Lat: 39.501236
Long: 108.215428

CURRENT LAND USE		
<input type="checkbox"/> CROP LAND	<input checked="" type="checkbox"/> NON CROP LAND	<input type="checkbox"/> SUBDIVIDED
<input type="checkbox"/> IRRIGATED	<input checked="" type="checkbox"/> RANGELAND	<input type="checkbox"/> INDUSTRIAL
<input type="checkbox"/> DRY LAND	<input type="checkbox"/> TIMBER	<input type="checkbox"/> COMMERCIAL
<input type="checkbox"/> IMPROVE PASTURE	<input type="checkbox"/> RECREATIONAL	<input type="checkbox"/> RESIDENTIAL
<input type="checkbox"/> HAY MEADOW	<input type="checkbox"/> OTHER (Desc.):	
<input type="checkbox"/> CRP		

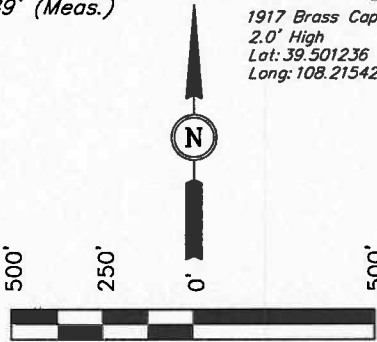

UINTAH ENGINEERING & LAND SURVEYING
85 So. 200 East * Vernal, Utah 84078 * (435) 789-1017