

LOCATION DRAWING

DALEY LAND SURVEYING, INC. PARKER, CO. 80134 303 953 9841

VISIBLE IMPROVEMENTS SKETCH MCGUCKIN H32-31

SECTION 32, TOWNSHIP 3 NORTH, RANGE 65 WEST OF THE 6TH PRINCIPAL MERIDIAN

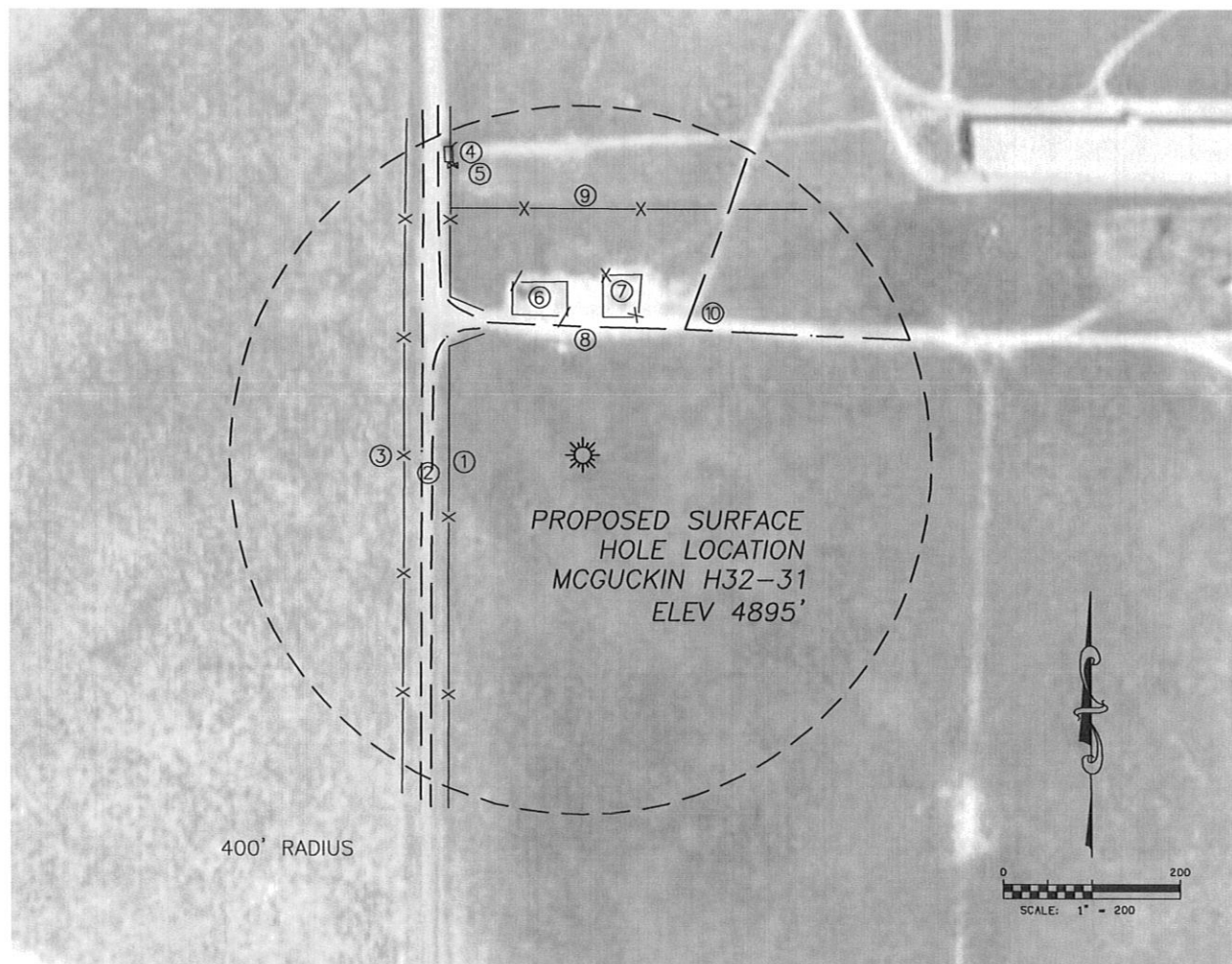

- | | | | | | | |
|---|------------------------------------|--|--|------------------------------|---|--|
| ①
FENCELINE
151' W | ②
EDGE ROAD
171' W
183' W | ③
FENCELINE
204' W | ④
CONC. PAD
UNLOAD RAMP
362' NW | ⑤
WATER SPIGOT
358' NW | ⑥
WIRE FENCE
TANK BATTERY
164' N | ⑦
WIRE FENCE
SEPARATOR
160' N |
| ⑧
CENTERLINE
FIELD ROAD
145' N | ⑨
FENCELINE
278' N | ⑩
CENTERLINE
FIELD ROAD
184' NE | | | | |