

EOG RESOURCES, INC.
RANDALL CREEK #04-32H
SECTION 32, T12N, R62W, 6th P.M.

PROCEED IN A WESTERLY DIRECTION FROM HEREFORD, COLORADO ON COUNTY ROAD 136 APPROXIMATELY 1.8 MILES TO THE BEGINNING OF THE PROPOSED ACCESS ROAD TO THE SOUTH; FOLLOW ROAD FLAGS IN A SOUTHERLY DIRECTION APPROXIMATELY 300' TO THE PROPOSED LOCATION.

TOTAL DISTANCE FROM HEREFORD, COLORADO TO THE PROPOSED LOCATION IS APPROXIMATELY 1.8 MILES.

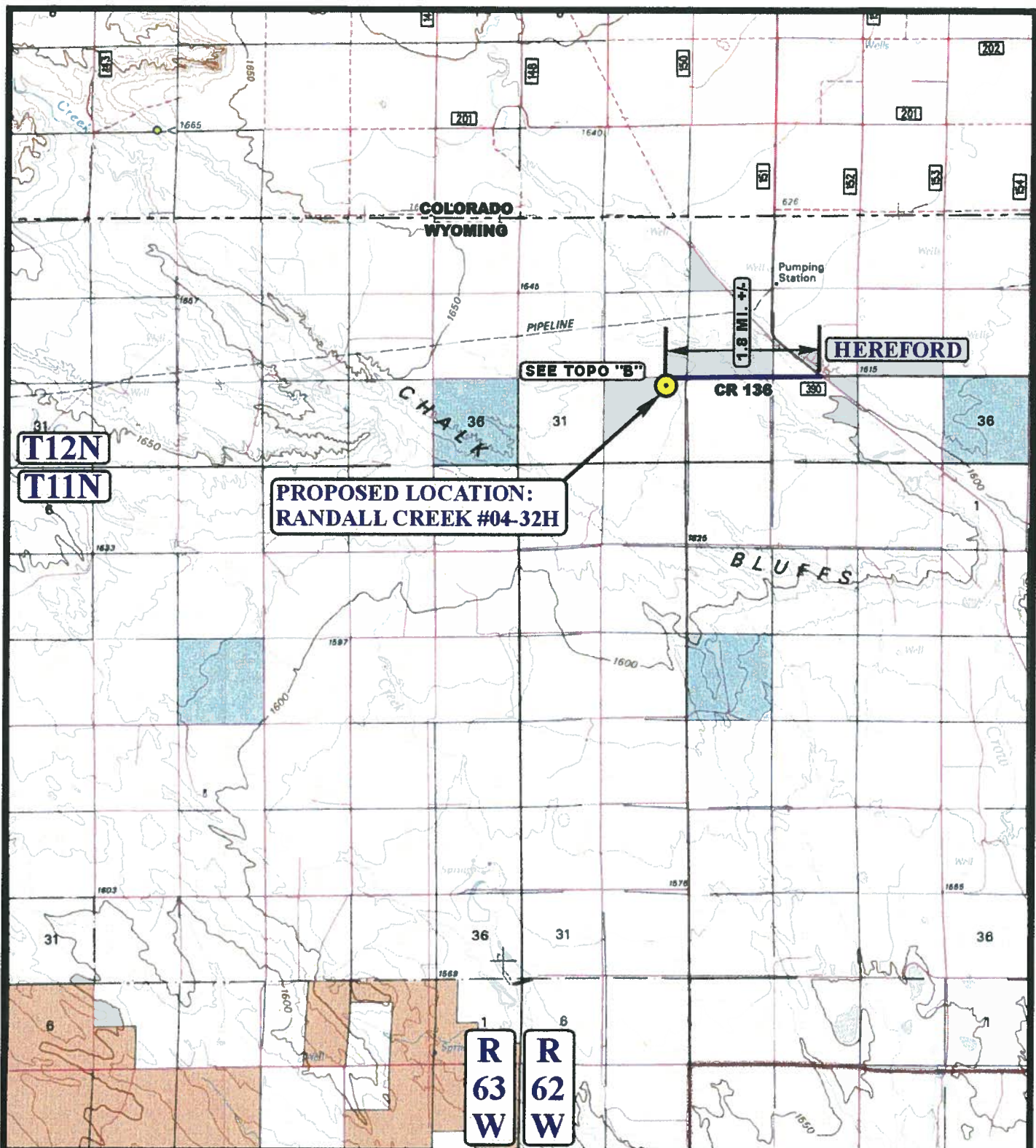

LEGEND:

● PROPOSED LOCATION



EOG RESOURCES, INC.

RANDALL CREEK #04-32H
SECTION 32, T12N, R62W, 6th P.M.
501' FNL 1200' FEL



Utah Engineering & Land Surveying
85 South 200 East Vernal, Utah 84078
(435) 789-1017 * FAX (435) 789-1813

ACCESS ROAD
MAP

01 21 10
MONTH DAY YEAR

SCALE: 1:100,000 DRAWN BY: J.H. REVISED: 00-00-00



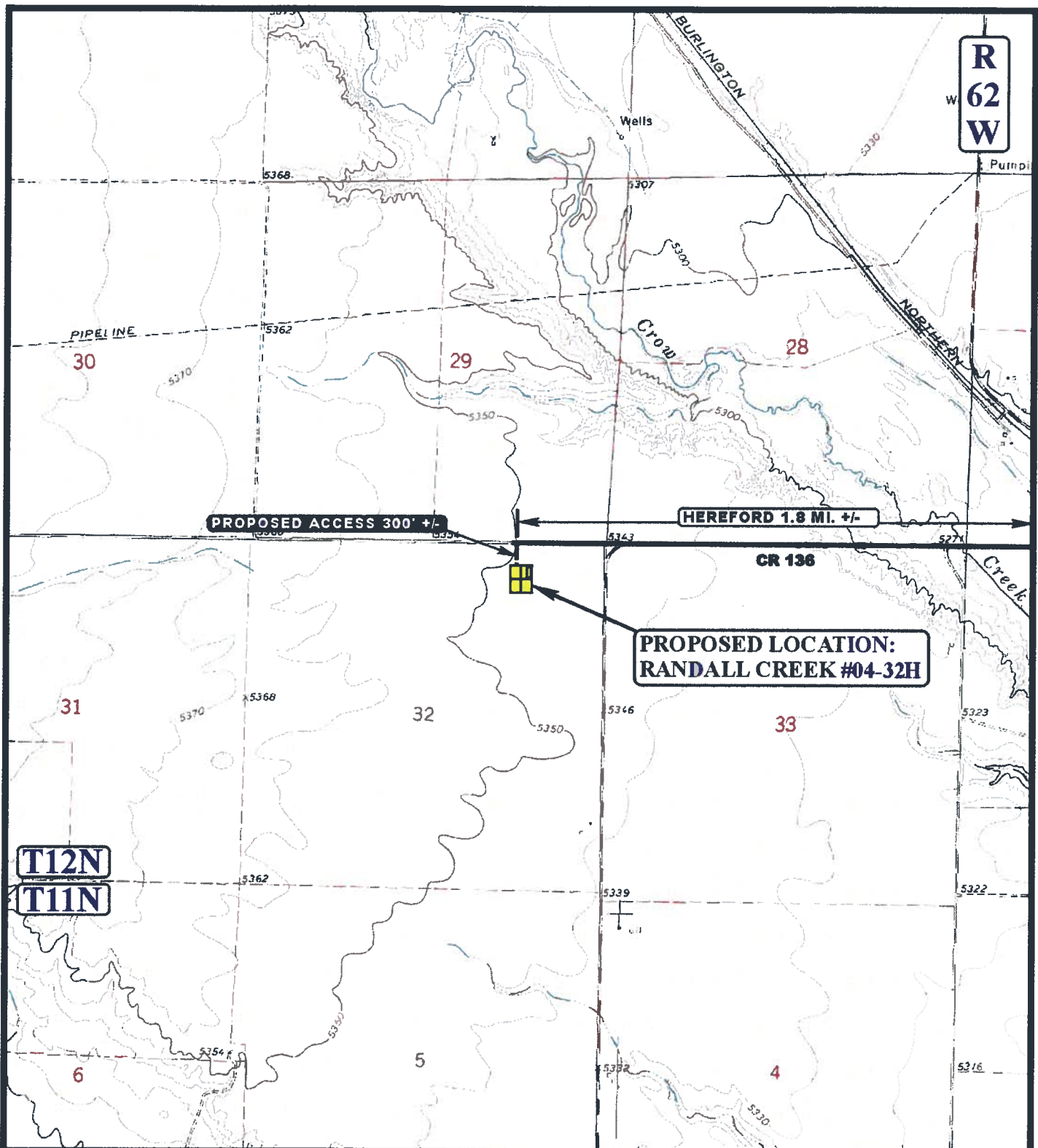

LEGEND:

- EXISTING ROAD
- PROPOSED ACCESS ROAD



EOG RESOURCES, INC.

RANDALL CREEK #04-32H
SECTION 32, T12N, R62W, 6th P.M.
501' FNL 1200' FEL



Utah Engineering & Land Surveying
 85 South 200 East Vernal, Utah 84078
 (435) 789-1017 * FAX (435) 789-1813

ACCESS ROAD
MAP

01 21 10
 MONTH DAY YEAR

B
 TOPO

SCALE: 1" = 2000' DRAWN BY: J.H. REVISED: 00-00-00