

EOG RESOURCES, INC.
FOX CREEK #04-27H
SECTION 27, T12N, R63W, 6th P.M.

PROCEED IN A WESTERLY DIRECTION FROM HEREFORD, COLORADO ON COUNTY ROAD #136 APPROXIMATELY 4.5 MILES TO THE JUNCTION OF COUNTY ROAD #136 AND COUNTY ROAD #71 TO THE NORTH; TURN RIGHT AND PROCEED IN A NORTHERLY DIRECTION APPROXIMATELY 0.5 MILES TO THE JUNCTION OF COUNTY ROAD #71 AND COUNTY ROAD #136.5 TO THE WEST; TURN LEFT AND PROCEED IN A WESTERLY, THEN SOUTHWESTERLY DIRECTION APPROXIMATELY 1.3 MILES TO THE BEGINNING OF THE PROPOSED ACCESS TO THE SOUTHEAST; FOLLOW ROAD FLAGS IN A SOUTHEASTERLY DIRECTION APPROXIMATELY 0.1 MILES TO THE PROPOSED LOCATION.

TOTAL DISTANCE FROM HEREFORD, COLORADO TO THE PROPOSED LOCATION IS APPROXIMATELY 6.4 MILES.

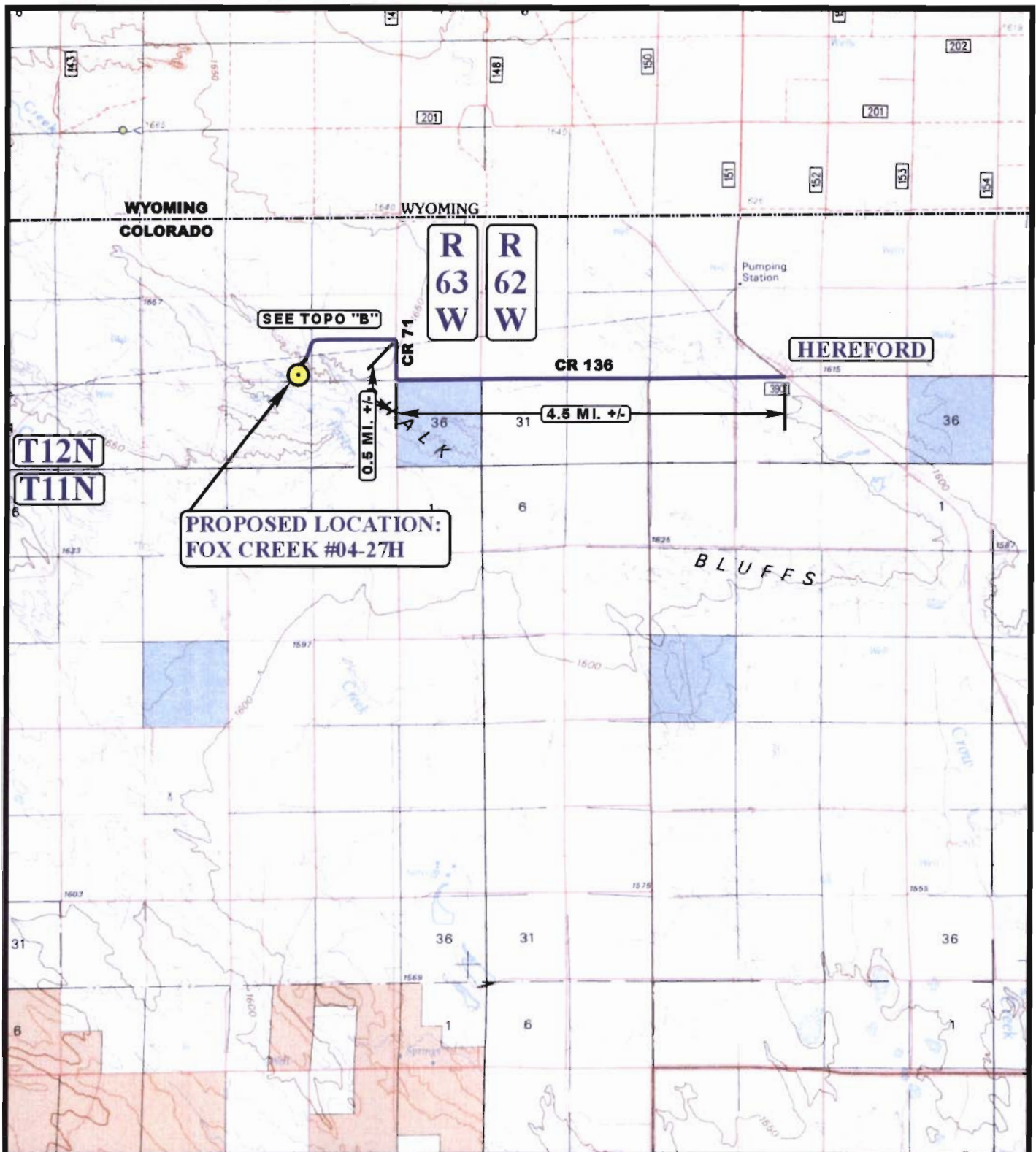

LEGEND:

PROPOSED LOCATION



EOG RESOURCES, INC.

FOX CREEK #04-27H
SECTION 27, T12N, R63W, 6th P.M.
501' FSL 750' FEL



Utah Engineering & Land Surveying
 85 South 200 East Vernal, Utah 84078
 (435) 789-1017 * FAX (435) 789-1813

ACCESS ROAD
 MAP

01 18 10
 MONTH DAY YEAR

SCALE: 1:100,000

DRAWN BY: J.H.

REVISED: 00-00-00



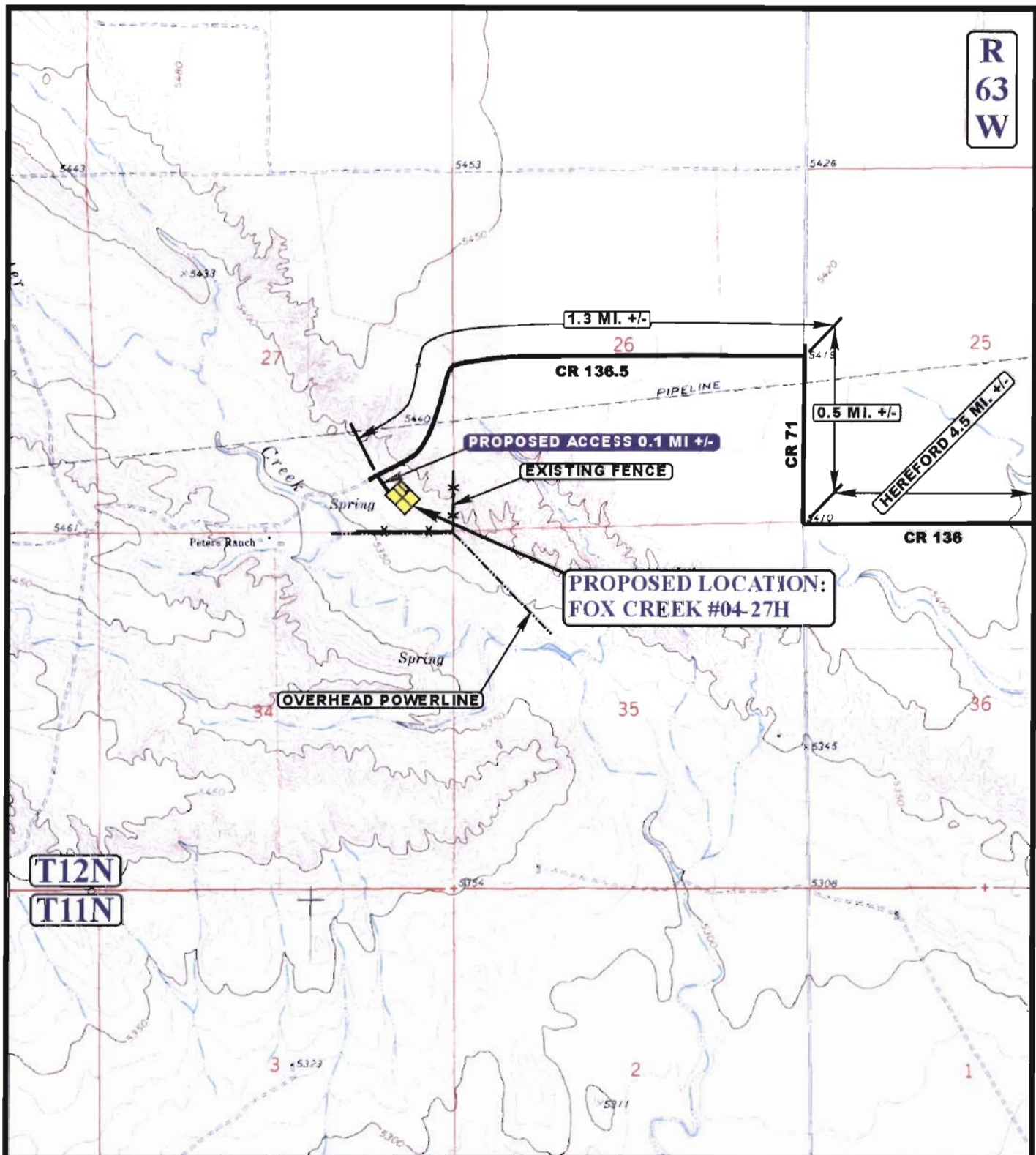

LEGEND:

- EXISTING ROAD
- PROPOSED ACCESS ROAD
- OVERHEAD POWERLINE
- EXISTING FENCE



EOG RESOURCES, INC.

FOX CREEK #04-27H
SECTION 27, T12N, R63W, 6th P.M.
501' FSL 750' FEL



Utah Engineering & Land Surveying
 85 South 200 East Vernal, Utah 84078
 (435) 789-1017 * FAX (435) 789-1813

ACCESS ROAD
MAP

01 18 10
 MONTH DAY YEAR



SCALE: 1" = 2000' DRAWN BY: J.H. REVISED: 06-00-00