

EOG RESOURCES, INC.
RANDALL CREEK #02-29H
SECTION 29, T12N, R62W, 6th P.M.

PROCEED IN A WESTERLY DIRECTION FROM HEREFORD, COLORADO ON COUNTY ROAD 136 APPROXIMATELY 1.6 MILES TO THE BEGINNING OF THE PROPOSED ACCESS ROAD TO THE NORTH; FOLLOW ROAD FLAGS IN A NORTHERLY DIRECTION APPROXIMATELY 300' TO THE PROPOSED LOCATION.

TOTAL DISTANCE FROM HEREFORD, COLORADO TO THE PROPOSED LOCATION IS APPROXIMATELY 1.6 MILES.

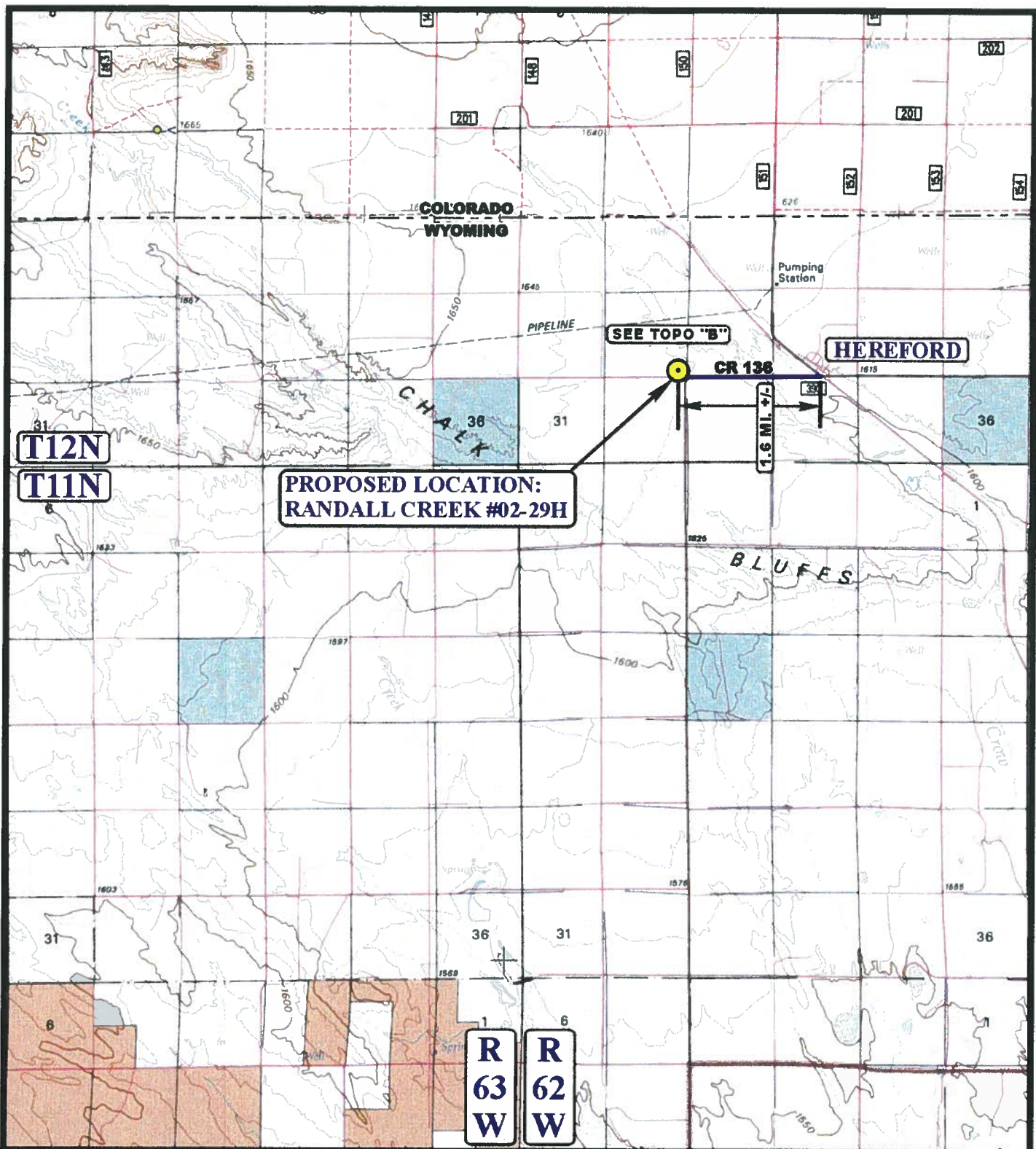

LEGEND:

 **PROPOSED LOCATION**

N

EOG RESOURCES, INC.

**RANDALL CREEK #02-29H
SECTION 29, T12N, R62W, 6th P.M.
501' FSL 501' FEL**

UEIS

Uintah Engineering & Land Surveying
85 South 200 East Vernal, Utah 84078
(435) 789-1017 * FAX (435) 789-1813

**ACCESS ROAD
MAP**

01 19 10
MONTH DAY YEAR

**A
TOPO**

SCALE: 1:100,000 DRAWN BY: J.H. REVISED: 00-00-00

