

Consultation Form Rule 306

On November 7, 2009, the undersigned met with the Surface Owner regarding good faith consultation pursuant to COGCC Rule 306.

The parties discussed proposed well locations, proposed dimensions of well site, proposed flowline route, proposed access route, and proposed tank battery locations.

Initial Consultation was completed for the following wells described below; a copy of the attached map(s) was provided to the Surface Owner.

SRC STATE 14-16D : T4N, R67W, Section 16: SWSW (*Directional Well*)
SRC STATE 16HD : T4N, R67W, Section 16: West Border of SW/4 (*Directional Well*)
SRC STATE 16LD : T4N, R67W, Section 16: South Border of SW/4 (*Directional Well*)
SRC STATE 16P : T4N, R67W, Section 16: East Border of SW/4 (*Vertical Well*)
SRC STATE 16B : T4N, R67W, Section 16: C/SW (*Vertical Well*)

By:



Craig Rasmuson
Land Consultant

Attached to and made a part of that Consultation
Form dated November 7, 2009

Township 4 North Range 67 West Sec 16: SW/4

Well Name(s): SRC STATE 14-16D, 16HD, 16LD, 16P and 16B

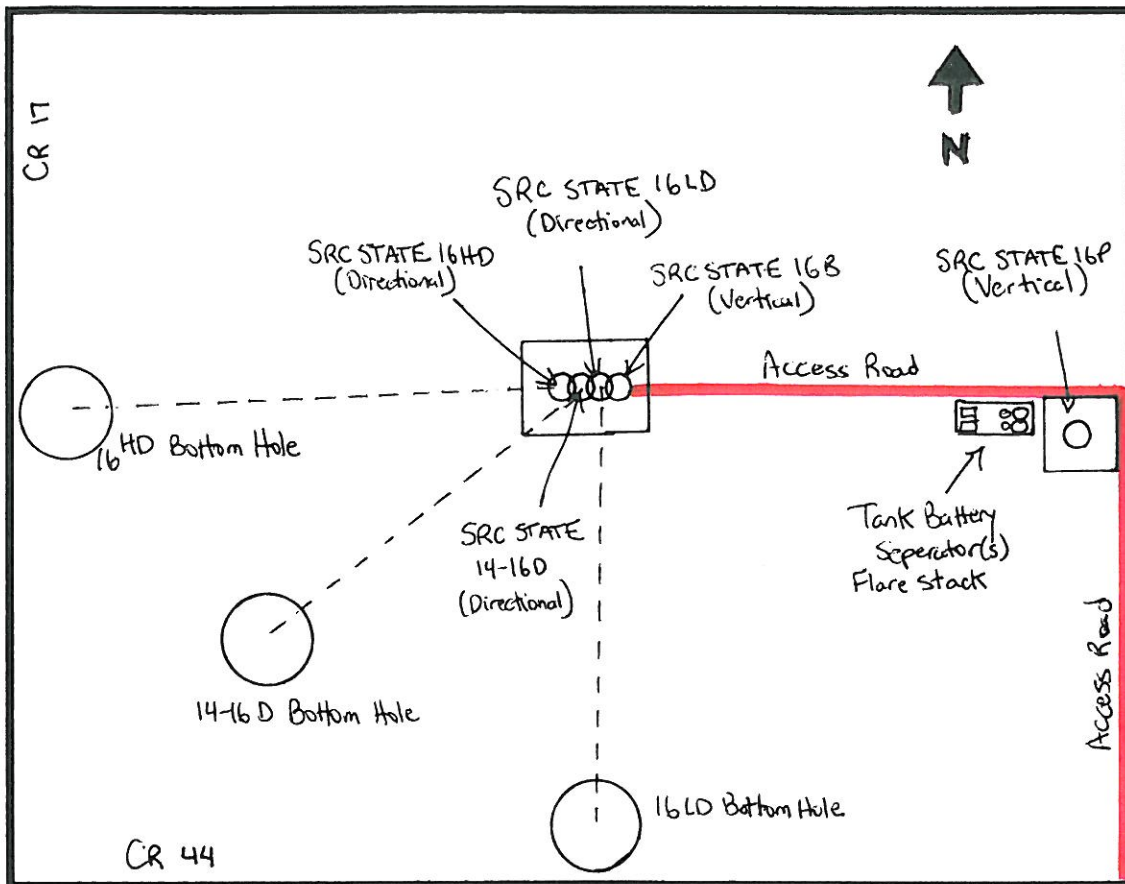

County Roads: 44 & 17

Weld County, Colorado

Attached to and made a part of that Consultation
Form dated November 7, 2009

Township 4 North Range 67 West Sec 16: SW/4

Well Name(s): SRC STATE 14-16D, 16HD, 16LD, 16P and 16B

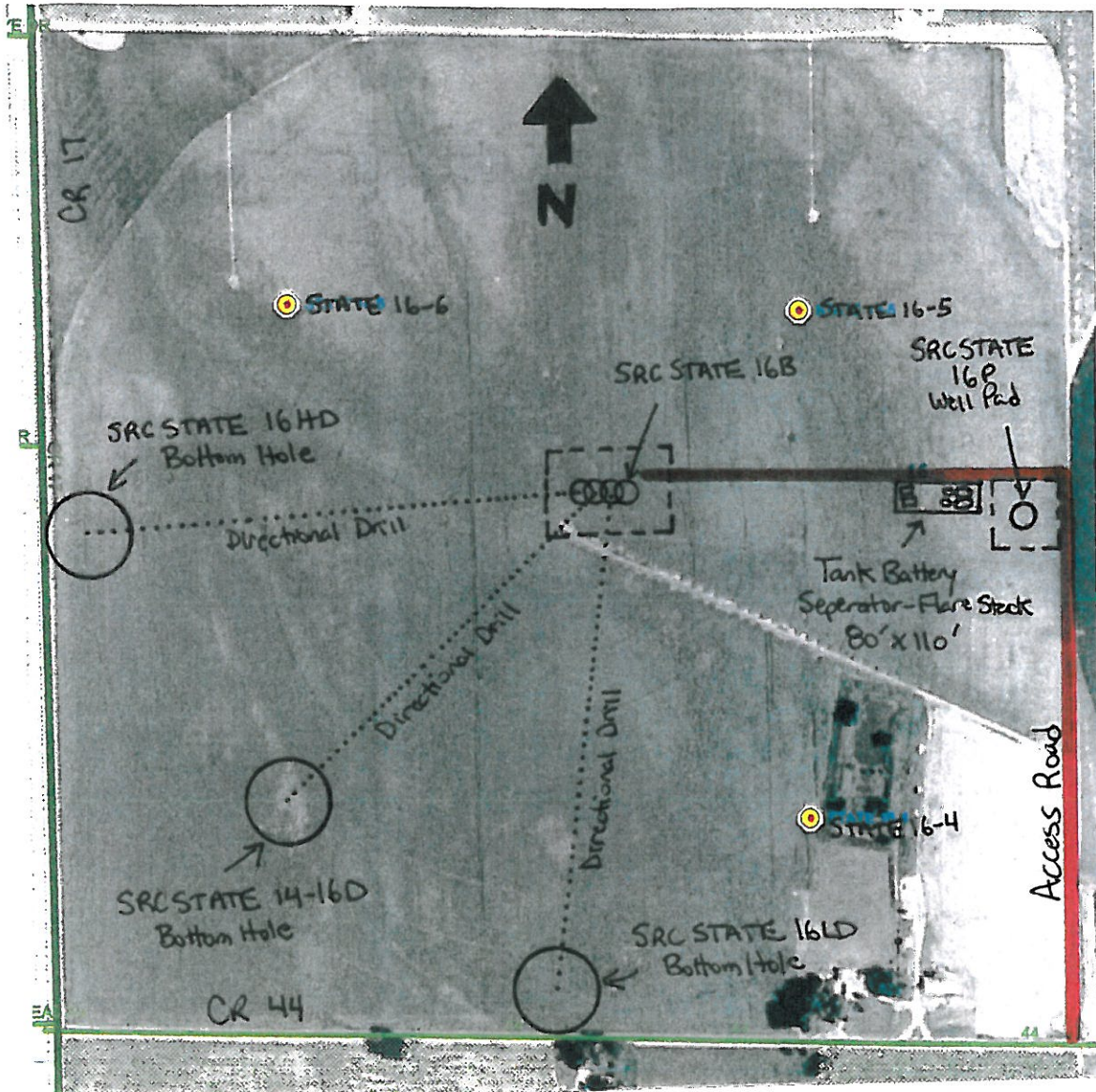

County Roads: 44 & 17

Weld County, Colorado